

F.A.U. RTE.	SECTION	COUNTY	TOTAL SHEETS	SHEET NO.
1441	00-00059-00-BR	KANE	154	62#
STA. 8+00		TO STA. 12+00		
FED. ROAD DIST. NO.		ILLINOIS FED. AID PROJECT		

TEMPORARY TRAFFIC SIGNAL LEGEND

- ▲ TEMPORARY TRAFFIC SIGNAL HEAD SPAN WIRE MOUNTED ORIGINAL LOCATION
- ▲ TEMPORARY TRAFFIC SIGNAL HEAD SPAN WIRE MOUNTED SECONDARY LOCATION
- ⊗ TEMPORARY WOOD POLE (CLASS 5 OR BETTER) 45 FOOT (13.7m) MINIMUM
- ⊠ TEMPORARY CONTROLLER CABINET
- TEMPORARY SPAN WIRE, TETHER WIRE, AND CABLE
- ⊞ TEMPORARY SERVICE INSTALLATION
- TEMPORARY PEDESTRIAN SIGNAL HEAD, BRACKET MOUNTED
- VIDEO DETECTION
- ⊙ PEDESTRIAN PUSHBUTTON DETECTOR
- ▽ EMERGENCY VEHICLE LIGHT DETECTOR
- ▽ CONFIRMATION BEACON
- VEHICLE DETECTOR, INDUCTION LOOP
- UD UNIT DUCT
- G.S. CONDUIT IN TRENCH (T) OR PUSHED (P)
- HANDHOLE
- ⊞ HEAVY DUTY HANDHOLE
- CT COMMON TRENCH

REMOVAL NOTES

THE FOLLOWING EXISTING TRAFFIC SIGNAL EQUIPMENT SHALL BE REMOVED BY THE CONTRACTOR, SHALL REMAIN THE PROPERTY OF THE STATE AND SHALL BE DELIVERED BY THE CONTRACTOR TO THE STATE'S TRAFFIC SIGNAL MAINTENANCE CONTRACTOR'S MAIN FACILITY AS PER THE TRAFFIC SIGNAL SPECIFICATIONS.

(ALL EXISTING EQUIPMENT SHALL REMAIN)

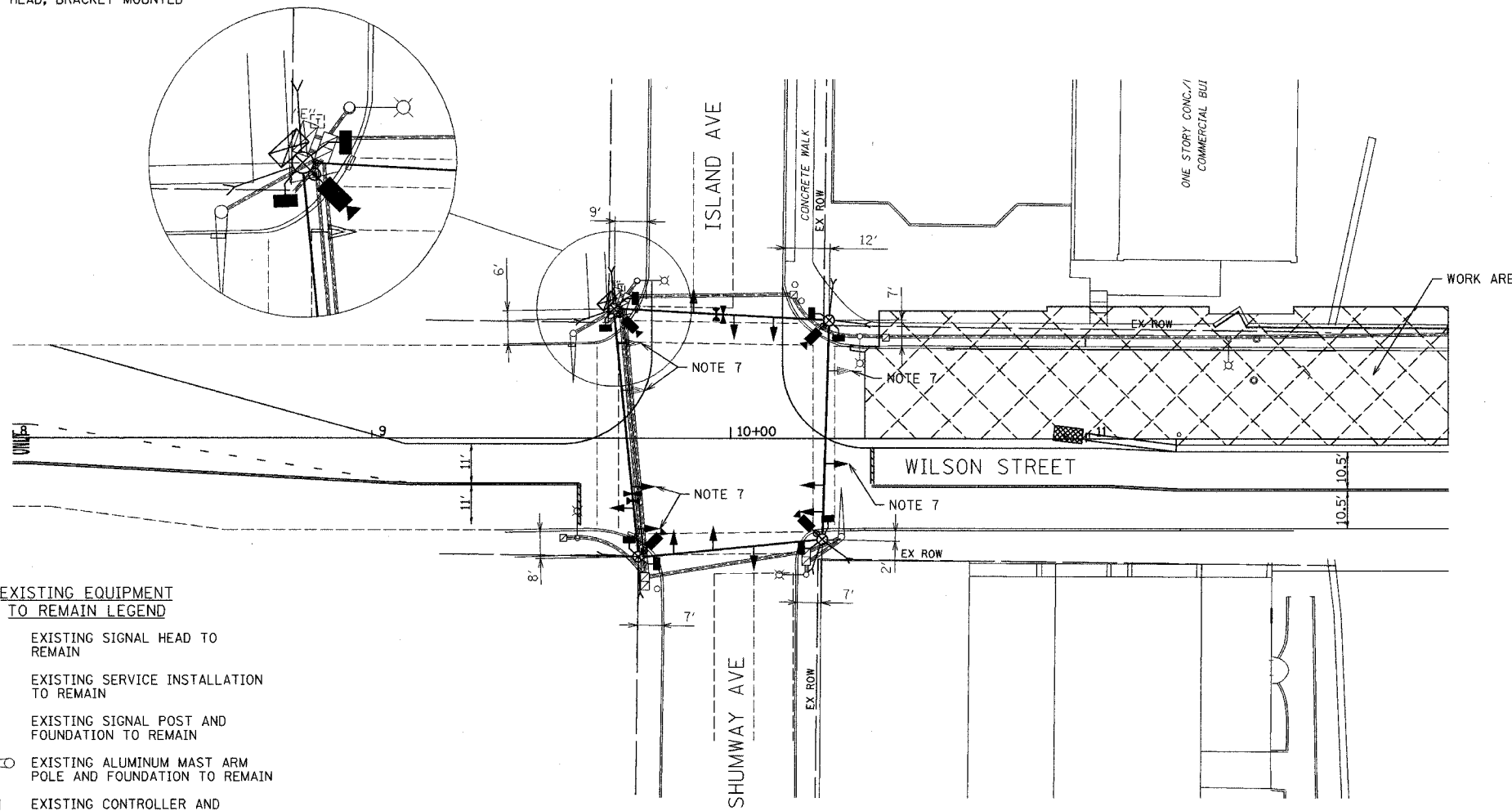
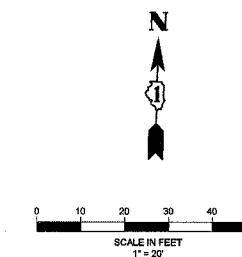

EXISTING EQUIPMENT TO REMAIN LEGEND

- ▲ EXISTING SIGNAL HEAD TO REMAIN
- EXISTING SERVICE INSTALLATION TO REMAIN
- EXISTING SIGNAL POST AND FOUNDATION TO REMAIN
- ▲ EXISTING ALUMINUM MAST ARM POLE AND FOUNDATION TO REMAIN
- ⊠ EXISTING CONTROLLER AND FOUNDATION TO REMAIN
- ⊞ EXISTING HANDHOLE TO REMAIN
- ⊞ EXISTING PEDESTRIAN SIGNAL HEAD TO REMAIN
- ⊙ EXISTING PEDESTRIAN PUSHBUTTON TO REMAIN
- ▽ EMERGENCY VEHICLE LIGHT DETECTOR TO REMAIN
- ▽ CONFIRMATION BEACON TO REMAIN
- ⊞ EXISTING HEAVY-DUTY HANDHOLE TO REMAIN
- EXISTING STEEL MAST ARM POLE AND FOUNDATION TO REMAIN

NOTES FOR TEMPORARY TRAFFIC SIGNALS

1. ALL CONTROL EQUIPMENT INCLUDING EMERGENCY PRE-EMPTION AND COMMUNICATION DEVICES FOR THE TEMPORARY TRAFFIC SIGNAL(S) SHALL BE FURNISHED BY THE CONTRACTOR.
2. ONLY CONTROLLERS SUPPLIED BY ONE OF THE DISTRICT APPROVED CLOSED LOOP EQUIPMENT MANUFACTURERS WILL BE APPROVED FOR USE AT TEMPORARY SIGNAL LOCATIONS. ALL CONTROLLERS USED FOR TEMPORARY TRAFFIC SIGNALS SHALL BE FULLY ACTUATED NEMA MICROPROCESSOR BASED WITH RS232 DATA ENTRY PORTS COMPATIBLE WITH EXISTING MONITORING SOFTWARE APPROVED BY IDOT DISTRICT 1. INSTALLED IN A NEMA TS1 OR TS2 CABINET. ONLY ONE BRAND OF CONTROLLER WILL BE ACCEPTED FOR ANY ONE CONTRACT.
3. ALL TRAFFIC SIGNAL SECTIONS AND PEDESTRIAN SIGNAL SECTIONS SHALL BE 12" (300mm). HEADS SHALL BE PLACED AS INDICATED ON THE TEMPORARY TRAFFIC SIGNAL PLAN OR AS DIRECTED BY THE ENGINEER. THE CONTRACTOR SHALL FURNISH ENOUGH CABLE SLACK TO RELOCATE HEADS TO ANY POSITION ON THE SPAN WIRE OR AT LOCATIONS ILLUSTRATED ON THE PLANS FOR CONSTRUCTION STAGING. THE TEMPORARY TRAFFIC SIGNAL SHALL REMAIN IN OPERATION DURING ALL SIGNAL HEAD RELOCATIONS. EACH TEMPORARY TRAFFIC SIGNAL HEAD SHALL HAVE ITS OWN CABLE FROM THE CONTROLLER CABINET TO THE SIGNAL HEAD.
4. ALL EXISTING STREET NAME AND INTERSECTION REGULATORY SIGNS SHALL BE REMOVED FROM EXISTING POLES, RELOCATED AND SECURELY FASTENED TO THE SIGNAL SPAN WIRE OR WOOD POLE AS DIRECTED BY THE ENGINEER.
5. ANY TEMPORARY SIGNAL WITHIN AN EXISTING CLOSED LOOP TRAFFIC SIGNAL SYSTEM SHALL BE INTERCONNECTED TO THAT SYSTEM USING SIMILAR BRAND CONTROL EQUIPMENT.
6. THE TEMPORARY TRAFFIC SIGNAL SHALL HAVE THE SIGNAL HEAD DISPLAYS, SIGNAL HEAD PLACEMENTS AND CONTROLLER PHASING MATCH THE EXISTING TRAFFIC SIGNAL, AT THE TIME OF THE TURN ON, IF NO TRAFFIC STAGING IS IN PLACE OR WILL NOT BE STAGED ON THE DAY OF THE TURN ON.
7. CONTRACTOR SHALL DEENERGIZE AND BAG ALL SIGNAL HEADS FOR WESTBOUND TRAFFIC DURING THE TIME THAT THE BRIDGE IS CLOSED TO TRAFFIC.

THE TRAFFIC SIGNAL CONTROL EQUIPMENT FOR THIS PROJECT SHALL BE ECONOLITE TO MATCH THE EXISTING ADJACENT SYSTEM

REVISIONS	
NAME	DATE

ILLINOIS DEPARTMENT OF TRANSPORTATION
WILSON STREET
 TEMPORARY TRAFFIC SIGNAL INSTALLATION
 AND EXISTING TRAFFIC SIGNAL REMOVAL
 WILSON ST. AT ISLAND / SHUMWAY AVE.
 STAGE 2
 SCALE: 1"=20'
 DATE 07/28/2006
 DRAWN BY JW
 CHECKED BY AKK

PLOT DATE * 08/13/2006
 FILE NAME * I:\2005\kennel\p01\temp\temp01b.dgn
 PLOT SCALE * #SCALE#
 USER NAME * #USER#