

F.A.U. RTE.	SECTION	COUNTY	TOTAL SHEETS	SHEET NO.
1441	00-00059-00-BR	KANE	154	71
STA. N/A		TO STA. N/A		
FED. ROAD DIST. NO.	ILLINOIS	FED. AID PROJECT		

INTERCONNECT SCHEMATIC LEGEND

- EXISTING INTERSECTION CONTROLLER
- PROPOSED INTERSECTION CONTROLLER
- EXISTING MASTER CONTROLLER
- PROPOSED MASTER CONTROLLER
- MASTER MASTER CONTROLLER
- EXISTING INTERSECTION & SAMPLING (SYSTEM) DETECTORS
- PROPOSED INTERSECTION & SAMPLING (SYSTEM) DETECTORS
- EXISTING INTERSECTION LOOP DETECTORS
- PROPOSED SAMPLING (SYSTEM) DETECTORS
- EXISTING SAMPLING (SYSTEM) DETECTORS: PROPOSED INTERSECTION AND SAMPLING (SYSTEM) DETECTORS.
- EXISTING SAMPLING (SYSTEM) DETECTORS. PROPOSED SAMPLING (SYSTEM) DETECTORS.
- EXISTING PREFORMED INTERSECTION & SAMPLING (SYSTEM) DETECTORS
- PROPOSED PREFORMED INTERSECTION & SAMPLING (SYSTEM) DETECTORS
- EXISTING SAMPLING (SYSTEM) PREFORMED DETECTORS
- PROPOSED SAMPLING (SYSTEM) PREFORMED DETECTORS
- EXISTING FIBER OPTIC CABLE IN CONDUIT, NO. 62.5/1 25. MM 12F SM12F
- PROPOSED FIBER OPTIC CABLE IN CONDUIT, NO. 62. 5/125, MM 12F SM12F
- EXISTING INTERCONNECT CABLE - NO. 62.5/125 12F FIBER OPTIC CABLE
- PROPOSED INTERCONNECT CABLE - NO. 62.5/125 12F FIBER OPTIC CABLE
- EXISTING INTERCONNECT CABLE - NO. 18 3 PAIR TWISTED, SHIELDED
- PROPOSED INTERCONNECT CABLE - NO. 18 3 PAIR TWISTED, SHIELDED
- EXISTING LOOP DETECTOR CABLE 2/C TWISTED, SHIELDED
- PROPOSED LOOP DETECTOR CABLE 2/C TWISTED, SHIELDED
- EXISTING ELECTRIC CABLE. 1/C (AS SPECIFIED)
- PROPOSED ELECTRIC CABLE, 1/C (AS SPECIFIED).
- EXISTING TELEPHONE CONNECTION
- PROPOSED TELEPHONE CONNECTION

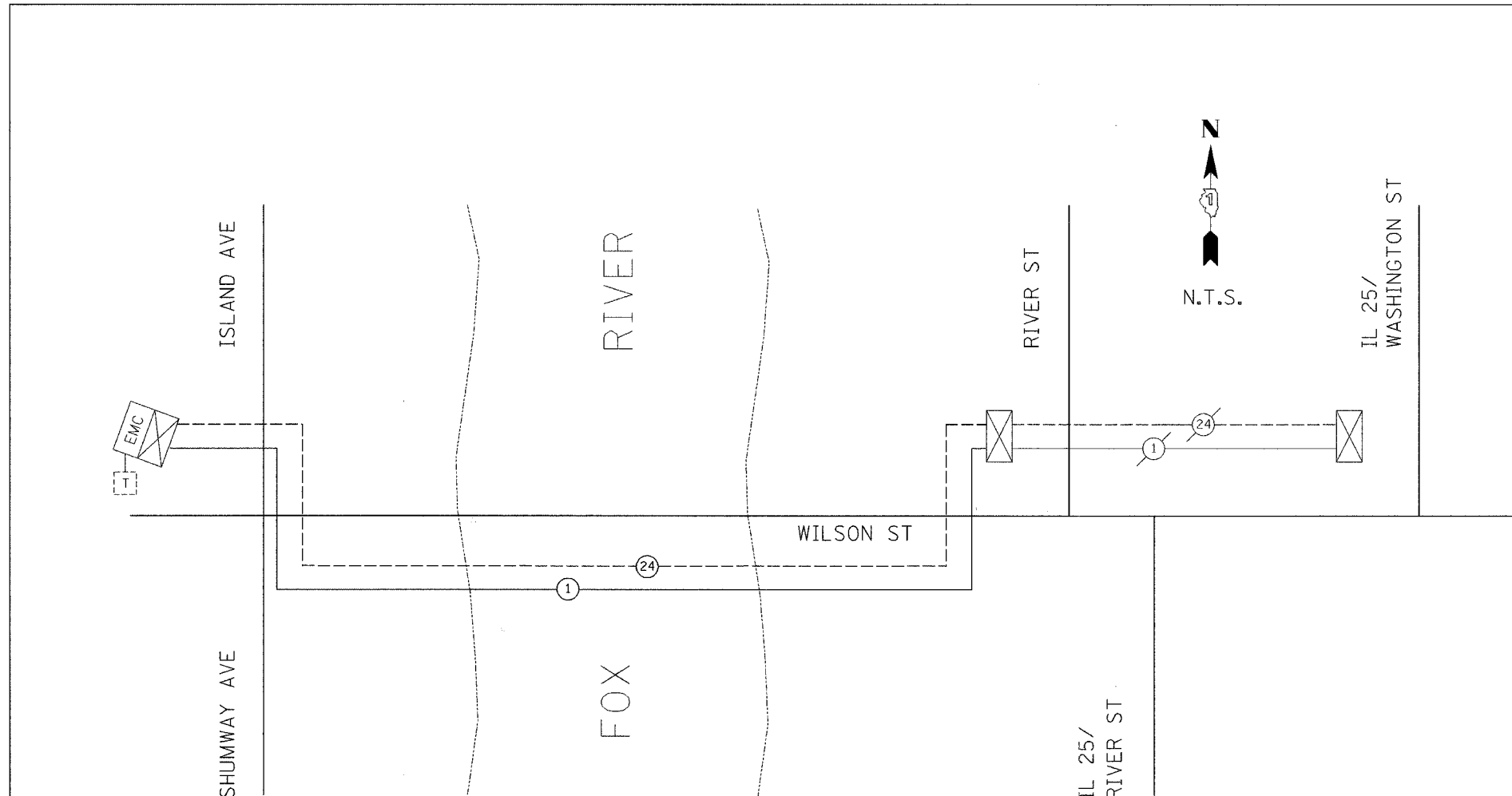

TRAFFIC SIGNAL SCHEDULE OF QUANTITIES

CONDUIT IN TRENCH, 2" DIA., GALVANIZED STEEL	FOOT	325
CONDUIT PUSHED, 2" DIA., GALVANIZED STEEL	FOOT	60
CONDUIT EMBEDDED IN STRUCTURE, 2" DIA., GALVANIZED STEEL	FOOT	240
CONCRETE HANDHOLE	EACH	3
TRENCH AND BACKFILL FOR ELECTRICAL WORK	FOOT	325
MAINTENANCE OF EXISTING TRAFFIC SIGNAL INSTALLATION	EACH	2
TEMPORARY TRAFFIC SIGNAL INSTALLATION	EACH	2
ELECTRIC CABLE IN CONDUIT, TRACER, NO. 14 1C	FOOT	870
FIBER OPTIC CABLE IN CONDUIT, NO. 62.5/125, MM12F SM12F	FOOT	870
TEMPORARY TRAFFIC SIGNAL INTERCONNECT	EACH	1
REMOVE AND REINSTALL ELECTRIC CABLE FROM CONDUIT	FOOT	1296

REVISIONS	
NAME	DATE

ILLINOIS DEPARTMENT OF TRANSPORTATION
 WILSON STREET
 INTERCONNECT SCHEMATIC
 AND SCHEDULE OF QUANTITIES

SCALE: NTS
 DATE: 07/28/2006
 DRAWN BY: JW
 CHECKED BY: AKK

PLOT DATE: 08/13/2006
 FILE NAME: \\s0009\vol1\gdnet\trf\sig\temp\sig05f.dgn
 USER: MUSEN

\\s0009\vol1\gdnet\trf\sig\temp\sig05f.dgn 08/13/2006 08:17:35 PM