

STATE OF ILLINOIS
DEPARTMENT OF TRANSPORTATION

ROUTE NO.	SECTION	COUNTY	TOTAL SHEETS	SHEET NO.
FAU 1441	00-00059-00-BR	KANE	154	93
FED. ROAD DIST. NO. 7		ILLINOIS	FED. AID PROJECT	

Contract # 83869

SHEET NO. S22
of S52 SHEETS

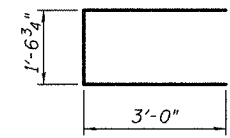

BAR a12(E)

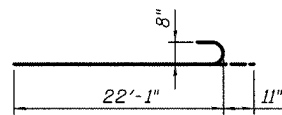

BAR a23(E)

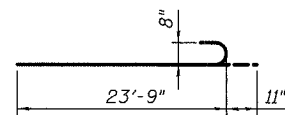

BAR a24(E)

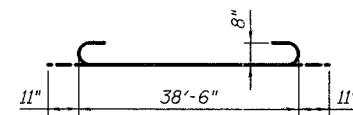

BAR a25(E)

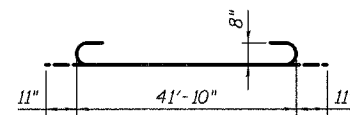

BAR a26(E)

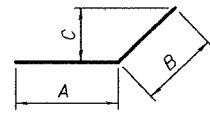

BARS b15(E) &
b40(E) thru b48(E)

Bar	A	B	C
b15(E)	1'-6"	1'-6"	1'-0 3/4"
b40(E)	4'-3"	2'-0"	1'-5"
b41(E)	4'-8"	2'-0"	1'-5"
b42(E)	5'-0"	2'-0"	1'-5"
b43(E)	5'-5"	2'-0"	1'-5"
b44(E)	5'-11"	2'-0"	1'-5"
b45(E)	6'-3"	2'-0"	1'-5"
b46(E)	6'-8"	2'-0"	1'-5"
b47(E)	7'-0"	2'-0"	1'-5"
b48(E)	7'-6"	2'-0"	1'-5"

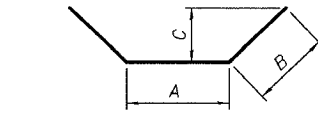

BARS b50(E) thru b58(E)

Bar	A	B	C
b50(E)	2'-0"	2'-0"	1'-5"
b51(E)	2'-10"	2'-10"	2'-0"
b52(E)	3'-8"	3'-8"	2'-7"
b53(E)	4'-6"	4'-6"	3'-2"
b54(E)	5'-4"	5'-4"	3'-9"
b55(E)	6'-1"	6'-1"	4'-3"
b56(E)	6'-11"	6'-11"	4'-10"
b57(E)	7'-9"	7'-9"	5'-5"
b58(E)	8'-6"	8'-6"	6'-0"

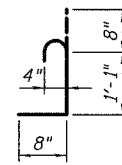

BAR c(E)

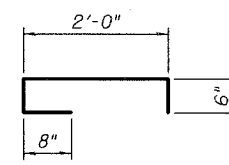

BAR c2(E)

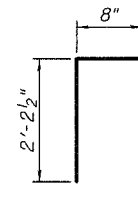

BAR c3(E)

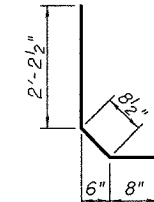

BAR c4(E)

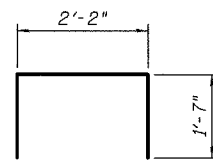

BAR c6(E)

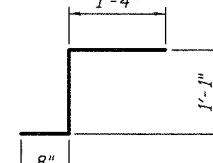

BAR c7(E)

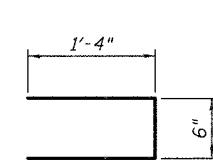

BAR c8(E)

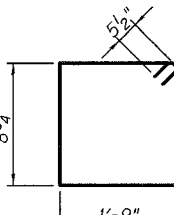

BAR s1(E)

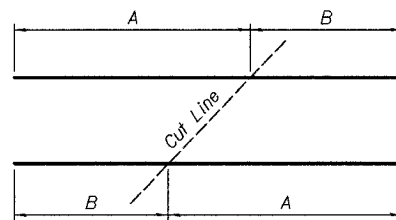

CUTTING DIAGRAM

Bar	A	B
a25(E)	23'-0"	17'-4"
a26(E)	24'-8"	19'-0"
b12(E)	21'-8"	8'-9"
b21(E)	20'-10"	8'-5"
c9(E)	22'-5"	15'-11"

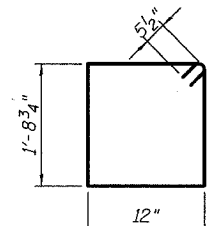

BAR s2(E)

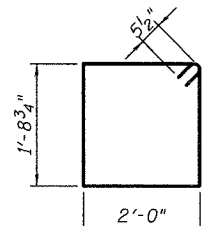

BAR s10(E)

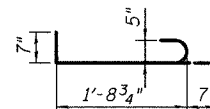

BAR s11(E)

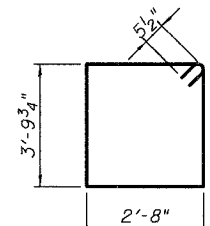

BAR s20(E)

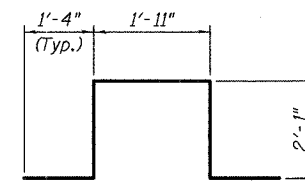

BAR s21(E)

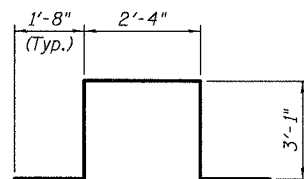

BAR s22(E)

Typ. Lap Splice	
Bar Size	Min. Lap
#5	2'-2"
#5*	3'-0"
#6	2'-7"
#7	3'-5"
#8	4'-6"

* Top Horizontal Bar

BILL OF MATERIAL

Bar	No.	Size	Length	Shape
a1(E)	2256	#5	20'-0"	
a10(E)	36	#8	35'-5"	
a11(E)	36	#8	37'-1"	
a12(E)	72	#5	7'-7"	
a20(E)	20	#8	35'-5"	
a21(E)	20	#8	37'-1"	
a22(E)	84	#8	30'-0"	
a23(E)	48	#8	23'-0"	
a24(E)	48	#8	24'-8"	
a25(E)	22	#8	40'-4"	
a26(E)	22	#8	43'-8"	
b(E)	462	#5	30'-0"	
b1(E)	154	#5	20'-0"	
b2(E)	231	#5	30'-0"	
b3(E)	693	#5	30'-0"	
b4(E)	2	#4	3'-8"	
b10(E)	288	#4	27'-10"	
b11(E)	24	#4	21'-8"	
b12(E)	16	#4	30'-5"	
b13(E)	32	#4	12'-0"	
b14(E)	8	#4	9'-3"	
b15(E)	16	#4	3'-0"	
b20(E)	36	#5	20'-10"	
b21(E)	24	#5	29'-3"	
b30(E)	20	#5	8'-2"	
b31(E)	32	#5	6'-2"	
b32(E)	32	#5	8'-4"	
b33(E)	32	#5	6'-5"	
b34(E)	32	#5	8'-9"	
b40(E)	8	#5	6'-3"	
b41(E)	8	#5	6'-8"	
b42(E)	8	#5	7'-0"	
b43(E)	8	#5	7'-5"	
b44(E)	8	#5	7'-11"	
b45(E)	8	#5	8'-3"	
b46(E)	8	#5	8'-8"	
b47(E)	8	#5	9'-0"	
b48(E)	8	#5	9'-6"	
b50(E)	4	#5	6'-0"	
b51(E)	4	#5	8'-6"	
b52(E)	4	#5	11'-0"	
b53(E)	4	#5	13'-6"	
b54(E)	4	#5	16'-0"	
b55(E)	4	#5	18'-3"	
b56(E)	4	#5	20'-9"	
b57(E)	4	#5	23'-3"	
b58(E)	4	#5	25'-6"	
c(E)	9	#4	5'-11"	
c2(E)	9	#4	6'-5"	
s10(E)	408	#5	8'-5"	
s11(E)	408	#5	2'-11"	
s20(E)	652	#5	13'-11"	
s21(E)	2	#4	2'-11"	
s22(E)	4	#4	11'-10"	
High Performance Concrete Structures				
			Cu. Yd.	1714.2
Concrete Superstructure				
			Cu. Yd.	162.7
Reinforcement Bars, Epoxy Coated				
			Pound	155600
Bridge Pavers				
			Sq. Ft.	3343
Furnishing and Installing Post-Tensioning Strands				
			Pound	113330
Latex Modified Concrete Overlay				
			Sq. Yd.	1322
Bridge Deck Grooving				
			Sq. Yd.	1264
Bar Couplers				
			Each	76

BILL OF MATERIAL

Bar	No.	Size	Length	Shape
c(E)	478	#4	2'-5"	
c1(E)	388	#4	10'-0"	
c2(E)	400	#4	3'-2"	
c3(E)	400	#4	2'-11"	
c4(E)	400	#4	3'-7"	
c5(E)	16	#4	10'-0"	
c6(E)	40	#4	5'-4"	
c7(E)	152	#4	3'-1"	
c8(E)	152	#4	3'-2"	
c9(E)	28	#4	38'-4"	
c10(E)	40	#4	22'-5"	
s1(E)	9	#4	5'-11"	
s2(E)	9	#4	6'-5"	
s10(E)	408	#5	8'-5"	
s11(E)	408	#5	2'-11"	
s20(E)	652	#5	13'-11"	
s21(E)	2	#4	2'-11"	
s22(E)	4	#4	11'-10"	
High Performance Concrete Structures				
			Cu. Yd.	1714.2
Concrete Superstructure				
			Cu. Yd.	162.7
Reinforcement Bars, Epoxy Coated				
			Pound	155600
Bridge Pavers				
			Sq. Ft.	3343
Furnishing and Installing Post-Tensioning Strands				
			Pound	113330
Latex Modified Concrete Overlay				
			Sq. Yd.	1322
Bridge Deck Grooving				
			Sq. Yd.	1264
Bar Couplers				
			Each	76

NOTES

1. Work this Sheet with Sheet No.'s 89 thru 92.
2. Reinforcement bars designated (E) shall be epoxy coated.
3. Bars Indicated 20x3-#5 etc. indicates 20 lines of bars with 3 lengths per line.
4. Adjust reinforcement in field to clear drainage scuppers.

DECK DETAILS IV
WILSON ST OVER FOX RIVER
SECTION 00-00059-00-BR
KANE COUNTY
STRUCTURE NO. 045-6051

LOCHNER
H.W. LOCHNER, INC., CHICAGO, ILLINOIS

DESIGNED - DWH
CHECKED - KSS
DRAWN - OS
CHECKED - KSS

9/20/2006 2:57:07 PM