

SIGN SCHEDULE

SIGN	MUTCD DESIGNATION	SIZE	QUANTITY
	M4-9	30in X 24in	10
	M4-9L	30in X 24in	4
	M4-9R	30in X 24in	4
BAILEY ROAD BRIDGE OVER DUPAGE RIVER WILL BE CLOSED STARTING --/--/---	SPECIAL **	84in X 24in	9
	W20-2	48in X 48in	2
	M3-2	24in X 12in	8
	M3-4	24in X 12in	10
BAILEY ROAD	SPECIAL **	36in X 12in	29
END DETOUR	M4-8A	30in X 24in	2
	W20-3(0)	36in X 36in	6
	SPECIAL **	36in X 36in	4
PATH CLOSED AT BAILEY ROAD NO ACCESS TO BAILEY ROAD	SPECIAL **	84in X 24in	2
NO TRESPASSING PRIVATE PROPERTY	SPECIAL **	84in X 24in	5
	SPECIAL **	36in X 36in	5
ROAD CLOSED TO THRU TRAFFIC	R11-4	60in X 30in	1
	SPECIAL **	48in X 48in	1
WARNING BAILEY ROAD BRIDGE CONSTRUCTION AHEAD OBSTRUCTIONS IN RIVER USE CAUTION (PLACE IN DUPAGE RIVER)	SPECIAL **	84in X 36in	2

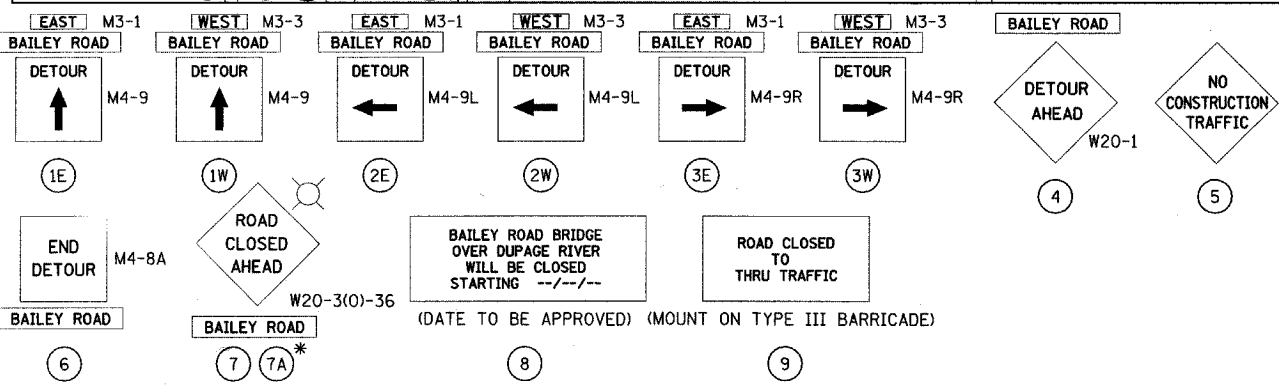
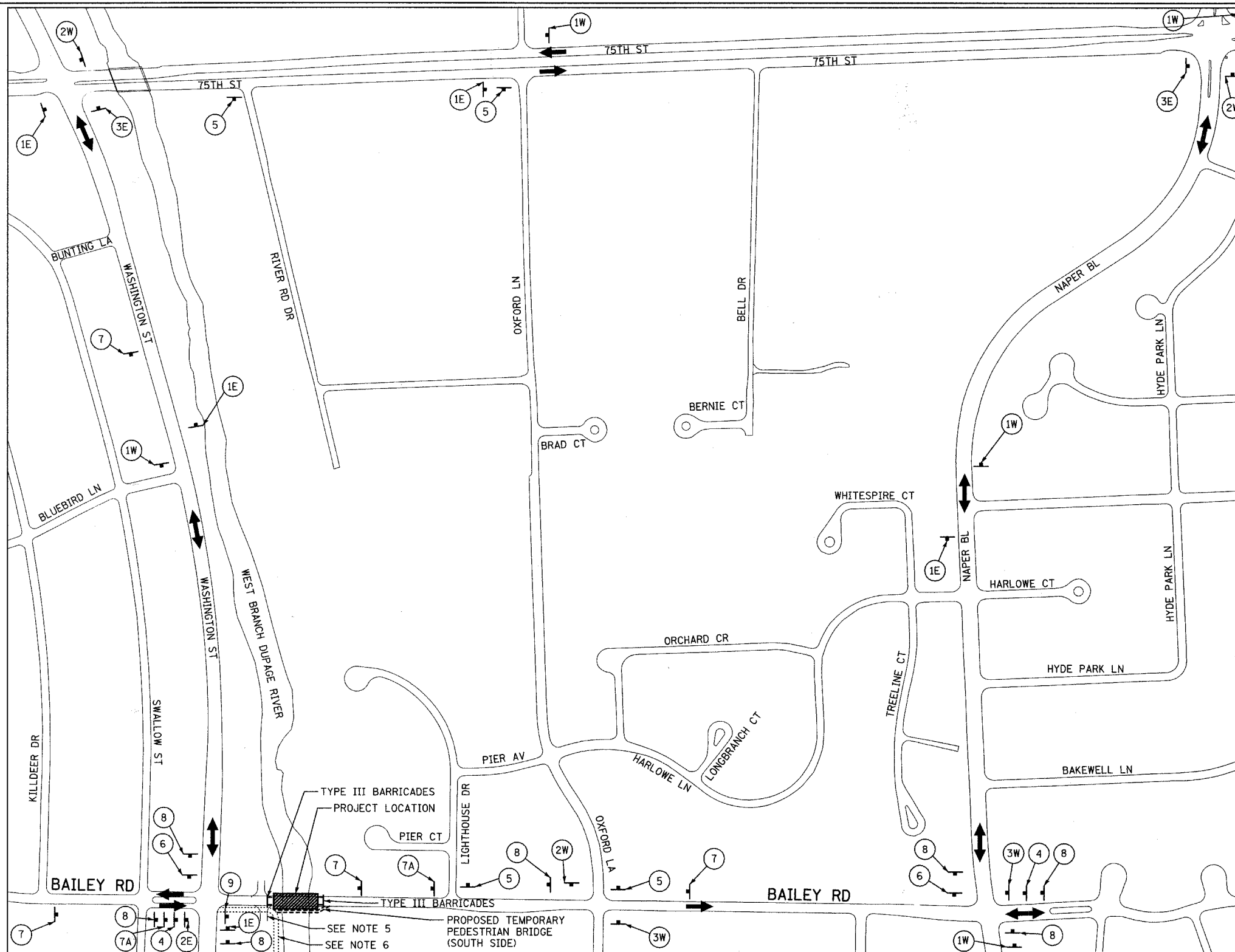

NOTES:

- ALL DETOUR SIGNS SHALL BE IN ORANGE COLOR BACKGROUND WITH BLACK LETTERS.
- FOLLOW LATEST MUTCD MANUAL AND IDOT STANDARDS FOR DETOUR SIGNS AND MAINTENANCE OF TRAFFIC SIGNS.
- THE DETOUR SIGNING SHALL BE PAID AS TRAFFIC CONTROL AND PROTECTION FOR TEMPORARY DETOUR.
- SIDEWALK CLOSURE SIGNING SHALL BE PER STANDARD 701801, AND INCLUDED IN THE COST OF TRAFFIC CONTROL AND PROTECTION FOR TEMPORARY DETOUR.
- MAINTAIN ACCESS TO ALL DRIVEWAYS AT ALL TIMES.
- SEE MAINTENANCE OF TRAFFIC DUPAGE RIVER TRAIL CLOSURE DETAILS.

** - SPECIAL CUSTOM SIGNS SHALL BE PAID FOR AS TEMPORARY INFORMATION SIGNING.

REVISIONS	
NAME	DATE

BRIDGE REHABILITATION
BAILEY ROAD OVER
WEST BRANCH OF THE DUPAGE RIVER

MAINTENANCE OF TRAFFIC
DETOUR - STAGE 2

CONSULTANT
TYLIN INTERNATIONAL

City of **Naperville**

DRAWN: RTM
CHECKED: SP
APPROVED:
DATE: JULY 13, 2007
SCALE: NONE
JOB No.: C-91-062-04

SHEET NO. **11**
PROJECT No.: BHM-8003(343)

* - "ROAD CLOSED 500 FT"