

STATE OF ILLINOIS
DEPARTMENT OF TRANSPORTATION

ROUTE NO.	SECTION	COUNTY	TOTAL SHEETS	SHEET NO.	SHEET NO. - 11 39 - SHEETS
1545	*	DUPAGE	97	32	
FED. ROAD DIST. NO.		LENGTH	FED. AID PROJECT		CONTRACT NO. 83961

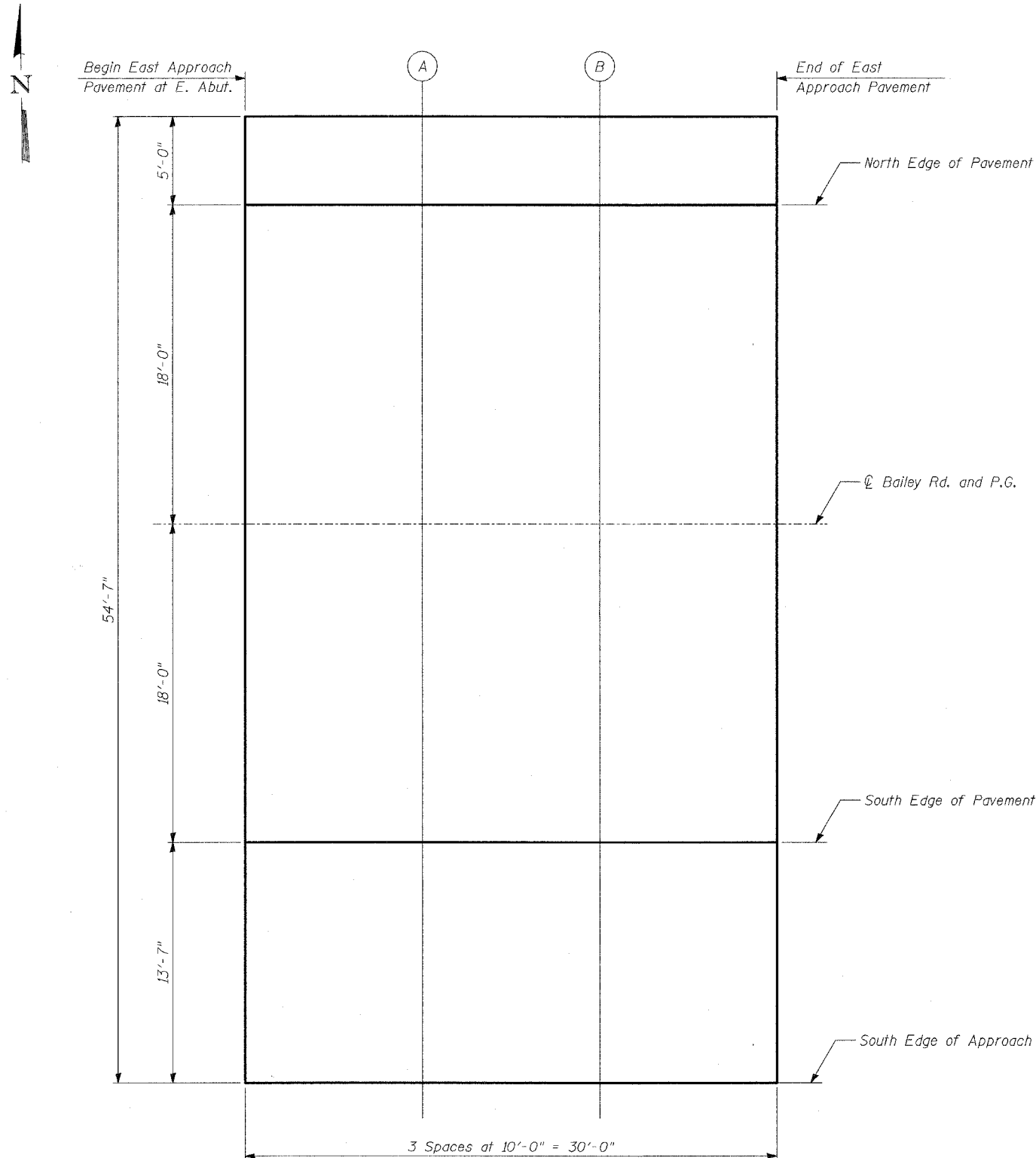

PLAN

TYLIN INTERNATIONAL

DESIGNED	- PL
CHECKED	- SNB
DRAWN	- PL
CHECKED	- SNB

NORTH EDGE OF PAVEMENT

Location	Station	Offset	Theoretical Grade Elevations
Begin E. Appr. Pav't	3+53.15	-18.00	657.71
A	3+63.15	-18.00	657.63
B	3+73.15	-18.00	657.55
End E. Appr. Pav't	3+83.15	-18.00	657.47

C BAILEY RD. AND P.G.

Location	Station	Offset	Theoretical Grade Elevations
Begin E. Appr. Pav't	3+53.15	0.00	657.99
A	3+63.15	0.00	657.94
B	3+73.15	0.00	657.89
End E. Appr. Pav't	3+83.15	0.00	657.84

SOUTH EDGE OF PAVEMENT

Location	Station	Offset	Theoretical Grade Elevations
Begin E. Appr. Pav't	3+53.15	18.00	657.71
A	3+63.15	18.00	657.63
B	3+73.15	18.00	657.55
End E. Appr. Pav't	3+83.15	18.00	657.47

SOUTH EDGE OF APPROACH

Location	Station	Offset	Theoretical Grade Elevations
Begin E. Appr. Pav't	3+53.15	31.58	657.50
A	3+63.15	31.58	657.40
B	3+73.15	31.58	657.29
End E. Appr. Pav't	3+83.15	31.58	657.19

TOP OF EAST APPROACH
PAVEMENT ELEVATIONS

BAILEY ROAD OVER THE
WEST BRANCH OF THE DUPAGE RIVER
FAU 1545
SECTION 00-00115-00-BR STA. 2+99.15
DUPAGE COUNTY
S.N. 022-3028