

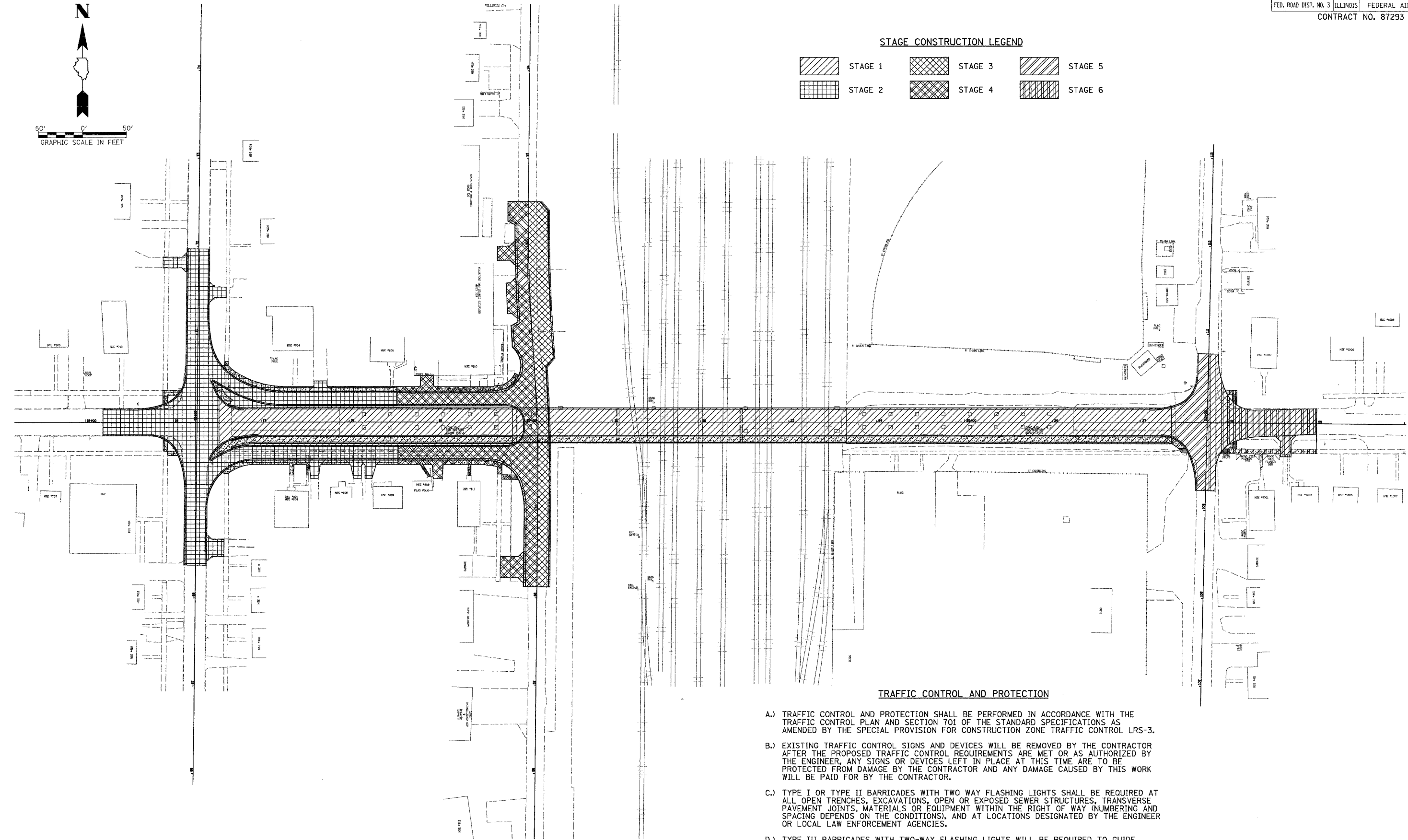

50' 0' 50'
GRAPHIC SCALE IN FEET

STAGE CONSTRUCTION LEGEND

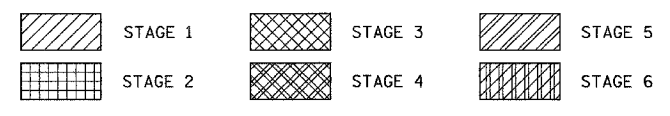

TRAFFIC CONTROL AND PROTECTION

- A.) TRAFFIC CONTROL AND PROTECTION SHALL BE PERFORMED IN ACCORDANCE WITH THE TRAFFIC CONTROL PLAN AND SECTION 701 OF THE STANDARD SPECIFICATIONS AS AMENDED BY THE SPECIAL PROVISION FOR CONSTRUCTION ZONE TRAFFIC CONTROL LRS-3.
- B.) EXISTING TRAFFIC CONTROL SIGNS AND DEVICES WILL BE REMOVED BY THE CONTRACTOR AFTER THE PROPOSED TRAFFIC CONTROL REQUIREMENTS ARE MET OR AS AUTHORIZED BY THE ENGINEER, ANY SIGNS OR DEVICES LEFT IN PLACE AT THIS TIME ARE TO BE PROTECTED FROM DAMAGE BY THE CONTRACTOR AND ANY DAMAGE CAUSED BY THIS WORK WILL BE PAID FOR BY THE CONTRACTOR.
- C.) TYPE I OR TYPE II BARRICADES WITH TWO WAY FLASHING LIGHTS SHALL BE REQUIRED AT ALL OPEN TRENCHES, EXCAVATIONS, OPEN OR EXPOSED SEWER STRUCTURES, TRANSVERSE PAVEMENT JOINTS, MATERIALS OR EQUIPMENT WITHIN THE RIGHT OF WAY (NUMBERING AND SPACING DEPENDS ON THE CONDITIONS), AND AT LOCATIONS DESIGNATED BY THE ENGINEER OR LOCAL LAW ENFORCEMENT AGENCIES.
- D.) TYPE III BARRICADES WITH TWO-WAY FLASHING LIGHTS WILL BE REQUIRED TO GUIDE TRAFFIC AWAY FROM PAVEMENT AREAS CLOSED FOR CONSTRUCTION.
- E.) TRAFFIC SIGNS SHALL BE RELOCATED FOR EACH STAGE OF CONSTRUCTION, WHERE REQUIRED.