

F.A.U. RTE.	SECTION	COUNTY	TOTAL SHEETS	SHEET NO.
6145	01-00590-00-BR	LoSALLE	168	26
STA. 11+00		TO STA. 23+00		
FED. ROAD DIST. NO. 3		ILLINOIS	FEDERAL AID PROJECT	
CONTRACT NO. 87293				

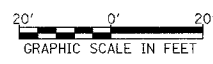
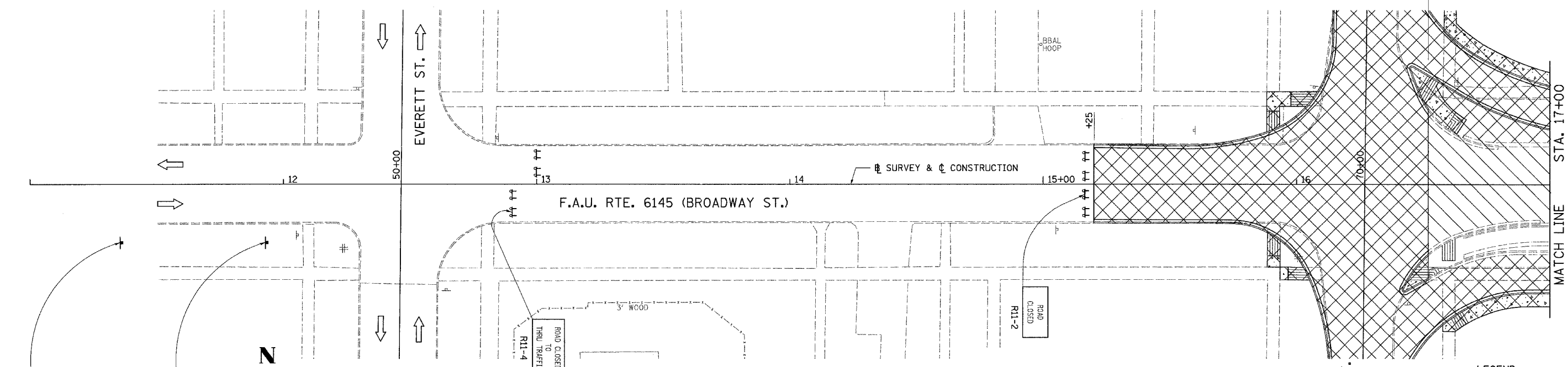

STAGE 2 CONSTRUCTION

- A.) STAGE 2 CONSTRUCTION WILL BE PERFORMED CONCURRENTLY WITH STAGE 1.
- B.) RECONSTRUCT F.A.U. RTE. 6145 (BROADWAY ST.) FROM STA. 15+25 TO STA. 16+52.
- C.) RECONSTRUCT SHABBONA ST. STA. 68+37.6 TO STA. 71+96.9
- D.) RECONSTRUCT THE N.W. AND S.W. FRONTAGE ROADS FROM SHABBONA ST. TO STA. 18+55±.

NOTE 1:

TYPE III BARRICADES MAY BE TEMPORARILY SHIFTED TO ALLOW CONSTRUCTION OF FRONTAGE ROAD PAVEMENTS, CONCRETE CURB & GUTTER, AND ENTRANCES. HOMEOWNERS SHOULD BE NOTIFIED IN ADVANCE.

STAGE 2 MAINTENANCE OF TRAFFIC

- A.) F.A.U. RTE. 6145 (BROADWAY ST.) WILL BE CLOSED TO ALL TRAFFIC FROM WEST OF SHABBONA ST. TO WEST OF IOWA ST.
- B.) SHABBONA ST. WILL BE CLOSED TO ALL TRAFFIC FROM STA. 68+37.6 TO STA. 71+96.9.
- C.) THE N.W. FRONTAGE ROAD WILL BE CLOSED TO ALL TRAFFIC FROM SHABBONA ST. TO STA. 17+40.
- D.) THE S.W. FRONTAGE ROAD WILL BE CLOSED TO ALL TRAFFIC FROM SHABBONA ST. TO STA. 17+40.
- E.) THE N.W. AND S.W. FRONTAGE ROADS WILL CONTINUE TO OPERATE FROM ILLINOIS ST.

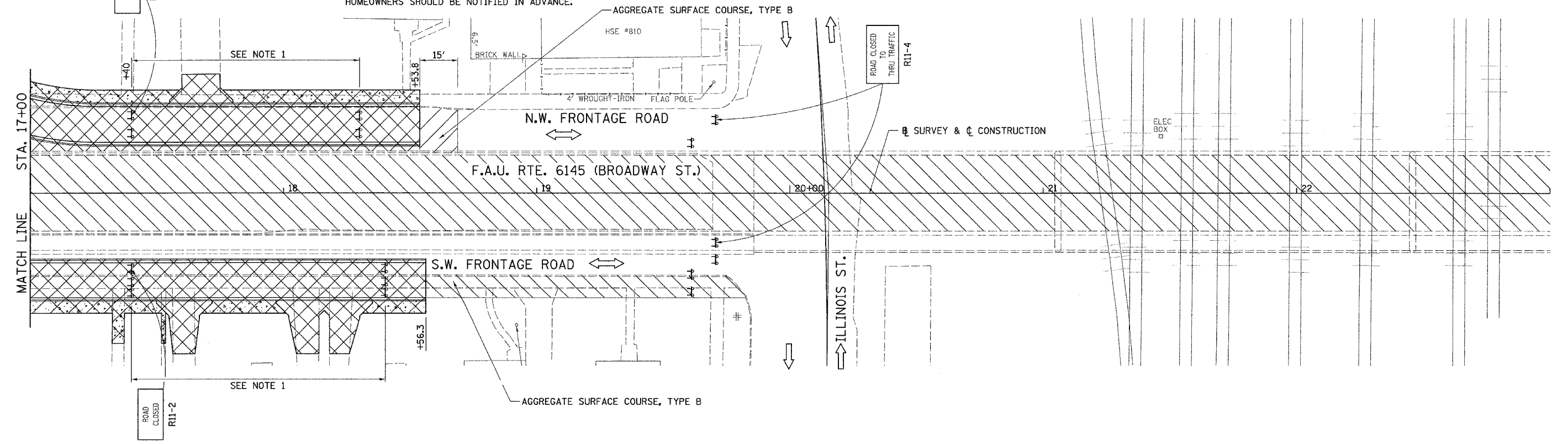

LEGEND

- BARRICADE OR DRUM WITH STEADY BURNING MONODIRECTIONAL LIGHT
- DIRECTION OF TRAFFIC
- CONSTRUCTION ZONE
- AREA CLOSED TO TRAFFIC
- TYPE III BARRICADE WITH FLASHING LIGHT (2-EA.)
- CONSTRUCTION SIGN