

F.A.U. RTE.	SECTION	COUNTY	TOTAL SHEETS	SHEET NO.
6145	01-00590-00-BR	LoSALLE	168	29
STA. 11+00		TO STA. 23+00		
FED. ROAD DIST. NO. 3		ILLINOIS	FEDERAL AID PROJECT	
CONTRACT NO. 87293				

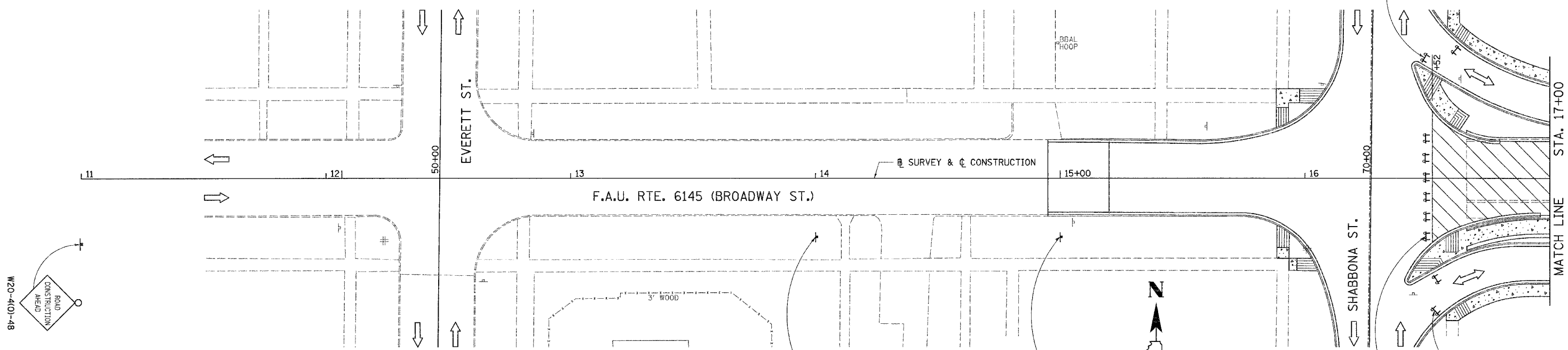

STAGE 4 MAINTENANCE OF TRAFFIC

- A.) THE N.W. FRONTAGE ROAD WILL BE CLOSED TO ALL TRAFFIC FROM STA. 18+53.8 TO ILLINOIS ST.
- B.) THE S.W. FRONTAGE ROAD WILL BE CLOSED TO ALL TRAFFIC FROM STA. 18+56.3 TO ILLINOIS ST.
- C.) THE N.W. AND S.W. FRONTAGE ROADS WILL CONTINUE TO OPERATE FROM SHABBONA ST. TRAFFIC WILL BE ALLOWED TO GO EAST ON THE S.W. FRONTAGE ROAD AND ALLOWED ACCESS TO THE N.W. FRONTAGE ROAD BETWEEN STA. 18+00 TO STA. 19+00. THE EXISTING BRIDGE SHALL BE REMOVED BETWEEN STA. 18+00 AND STA. 19+00.

STAGE 4 CONSTRUCTION

- A.) STAGE 4 CONSTRUCTION WILL BE PERFORMED CONCURRENTLY WITH STAGE 1.
- B.) STAGE 2 & 3 CONSTRUCTION MUST BE COMPLETED BEFORE STARTING STAGE 4.
- C.) RECONSTRUCT WEST HALF OF ILLINOIS ST. FROM STA. 88+12.88 TO STA. 92+50.90.
- D.) RECONSTRUCT THE N.W. AND S.W. FRONTAGE ROADS FROM STA. 18+55± TO ILLINOIS ST.

LEGEND

- BARRICADE OR DRUM WITH STEADY BURNING MONODIRECTIONAL LIGHT
- ➔ DIRECTION OF TRAFFIC
- ▨ CONSTRUCTION ZONE
- ▩ AREA CLOSED TO TRAFFIC
- ⚡ TYPE III BARRICADE WITH FLASHING LIGHT (2-EA.)
- ⚡ CONSTRUCTION SIGN

NOTE 1:

TYPE III BARRICADES MAY BE TEMPORARILY SHIFTED TO ALLOW CONSTRUCTION OF FRONTAGE ROADS PAVEMENTS, CONCRETE CURB & GUTTER, AND ENTRANCES. HOMEOWNERS SHOULD BE NOTIFIED IN ADVANCE.

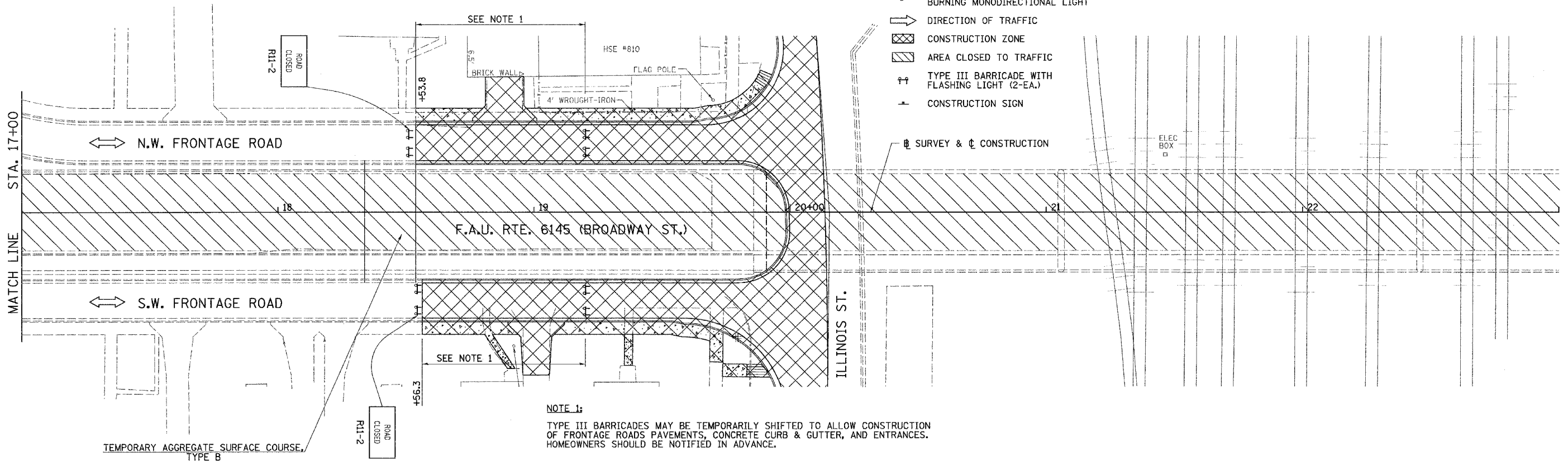

NOTE 1:

TYPE III BARRICADES MAY BE TEMPORARILY SHIFTED TO ALLOW CONSTRUCTION OF FRONTAGE ROADS PAVEMENTS, CONCRETE CURB & GUTTER, AND ENTRANCES. HOMEOWNERS SHOULD BE NOTIFIED IN ADVANCE.