

F.A.U. RTE.	SECTION	COUNTY	TOTAL SHEETS	SHEET NO.
6145	01-00590-00-BR	LOUISIANA	168	38

STA. 15+00 TO STA. 21+00

FED. ROAD DIST. NO. 3 ILLINOIS FEDERAL AID PROJECT

CONTRACT NO. 87293  
BURLINGTON NORTHERN AND SANTA FE RAILWAY COMPANY

PROPOSED TEMP. EASE. LINE  
PROPOSED CONSTRUCTION LIMITS

STA. 20+13.60 (F.A.U. RTE. 6145 (BROADWAY ST.)) = STA. 90+00.00 (ILLINOIS ST.)

EXISTING PERMANENT EASEMENT LINE

AGG & BRKEN CONC

P.I. #39 STA. 90+00.00

EXISTING PERMANENT EASEMENT LINE

BURLINGTON NORTHERN AND SANTA FE RAILWAY COMPANY

PROPOSED CONSTRUCTION LIMITS

PROPOSED TEMP. EASE. LINE

AGG

GRAPHIC SCALE IN FEET  
1" = 20' HOR.  
1" = 5' VER.



SEC. 25 T. 31 N. R. 3 E. 3RD PM

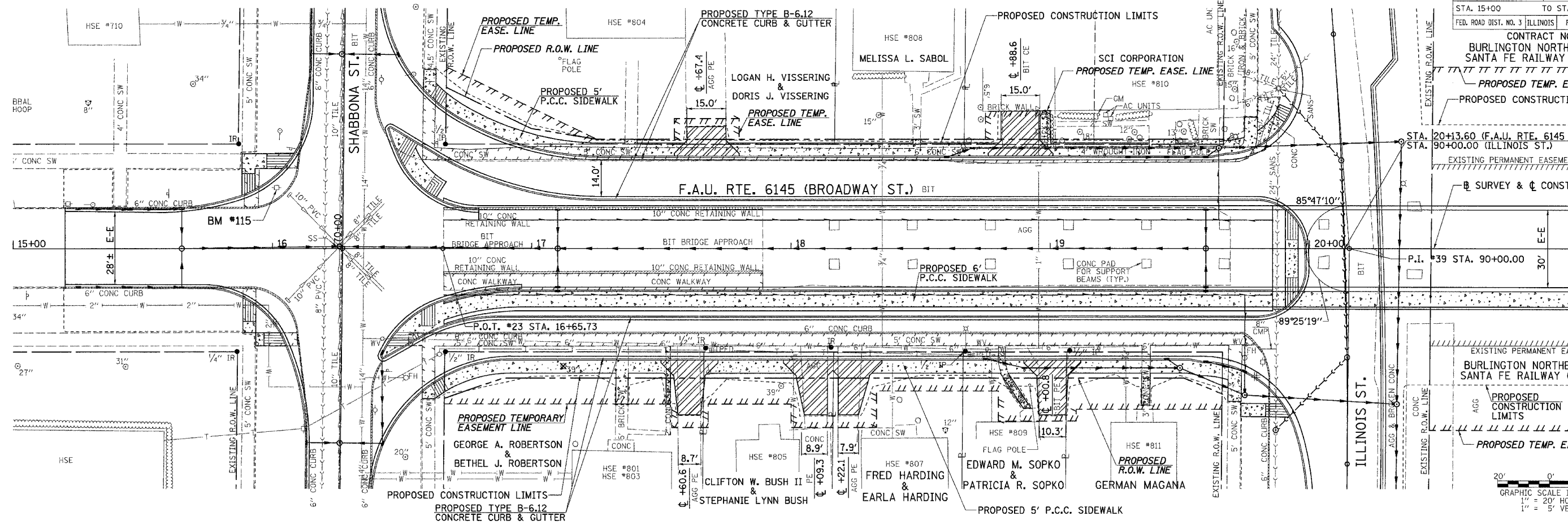

PLAN	DATE
SURVEYED	
ALIGNED	
CHECKED	
NOTE BOOK	
NO.	

PROFILE	DATE
SURVEYED	
GRADES CHECKED	
BLM. NOTED	
STRUCTURE	
NOTATIONS CHYD	
NO.	

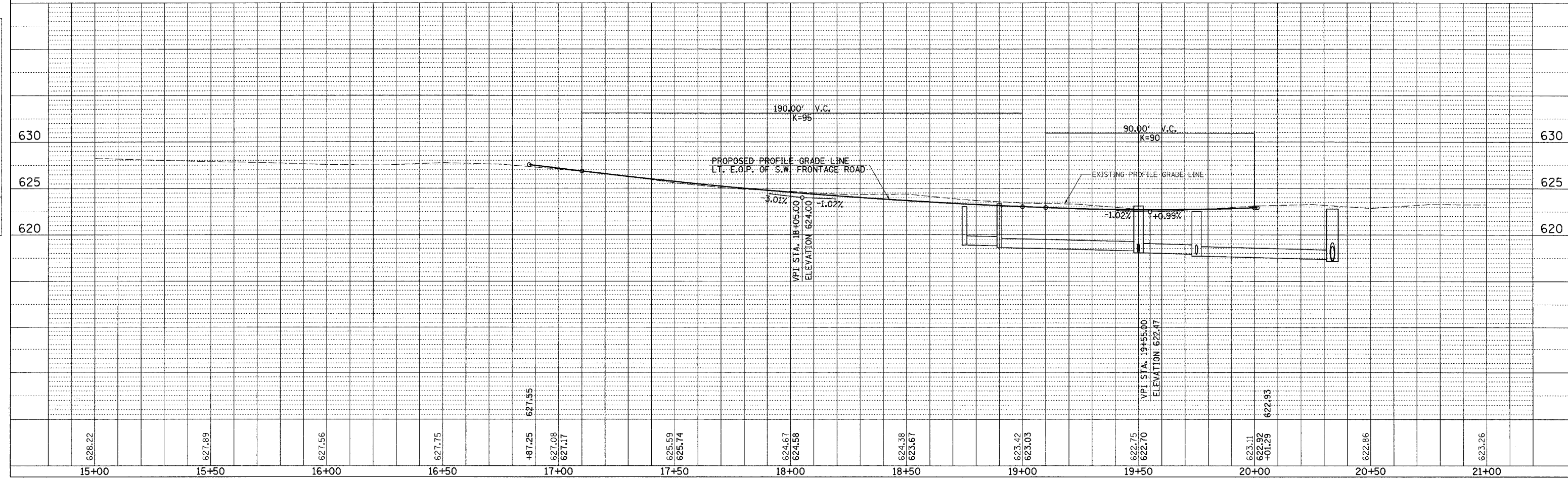

F.A.U. RTE. 6145 (BROADWAY ST.), S.W. FRONTAGE ROAD, PLAN & PROFILE, STA. 15+00 TO STA. 21+00