

GENERAL NOTES

See Special Provisions for Mechanically Stabilized Earth Retaining Wall design and construction requirements.

Reinforcement bars shall conform to the requirements of AASHTO M31 or M322, Grade 60.

The limits and quantities of removal and replacement shown are based on the boring data and may be modified by the Engineer for variable subsurface conditions encountered in the field.

The gradations and capping of the Porous Granular Material used to replace the unsuitable material shall be approved by the Engineer.

The cost of the cast-in-place concrete coping, reinforcement bars and dowel bars will be included with the bid pay item "Mechanically Stabilized Earth Wall." The Contractor may substitute a precast coping, the details of which must be included in the shop plans and approved by the Engineer.

Conduits and electrical details shown in the Retaining Wall Plans are for location and installation purposes only. Refer to Electrical and Lighting Plan for details, pay items and quantities.

For borings, See Sheet No. 30 thru 41 of 41 of the bridge plans.

**MECHANICALLY STABILIZED EARTH WALL
BILL OF MATERIAL**

ITEM	UNIT	TOTAL	TOTAL	TOTALS
		WALL NO. 1	WALL NO. 2	
* Mechanically Stabilized Earth Retaining Wall	Sq. Ft.	10,560	14,120	24,680
Structure Excavation	Cu. Yd.	972	1,309	2,281
Removal and Disposal of Unsuitable Material	Cu. Yd.	590	799	1,389
** Concrete Structures	Cu. Yd.	243.2	288.2	531.4
Reinforcement Bars Epoxy Coated	Pound	48,900	62,990	111,890
*** Concrete Superstructure	Cu. Yd.	142.1	170.8	312.9
Protective Coat	Sq. Yd.	821	963	1,784
Parapet Railing	Ft.	629	738	1,367
French Drains	Cu. Yd.	23.5	27.5	51.0

All select granular material and porous granular embankment between the walls are included with the cost of Mechanically Stabilized Earth Retaining Wall. The estimated total quantity is 14,035 CY.

* This pay item shall include the cost of Rustication Finish.

** Includes shoulder concrete.

*** Includes all parapet and sidewalk concrete.

**INDEX OF SHEETS
RETAINING WALLS NO. 1 & NO. 2**

Sheet No.	Description
1	General Plan and Elevation
2	General Notes, Bill of Material, Index
3-4	Wall Layout and Elevation View
5	Abutment and Wall Details
6	Typical Section, Elevation
7	Shoulder and Pavement Plan
8	Joint Details
9	Wall 1 Shoulder
10	Wall 2 Shoulder
11	End of Wall Layout
12	Parapet and Shoulder Details
13	Bar List and Bar Details
14	Sidewalk Profiles
15-20	Parapet and Rail Elevations
21	Parapet Railing Spacing
22	Light Pole Mount Details
23	Shoulder Slab & Parapet Details

FOR INFORMATION ONLY (ESTIMATED QUANTITIES)

ITEM	UNIT	WALL NO. 1	WALL NO. 2	TOTALS
Reinforced Soil Mass (Select Fill)	Cu. Yd.	3,835	6,183	10,018
Porous Granular Embankment	Cu. Yd.	1,883	2,135	4,018
Porous Granular Embankment (Replace Unsuitable Material)	Cu. Yd.	590	799	1,389
TOTAL				15,425 CU. YD.

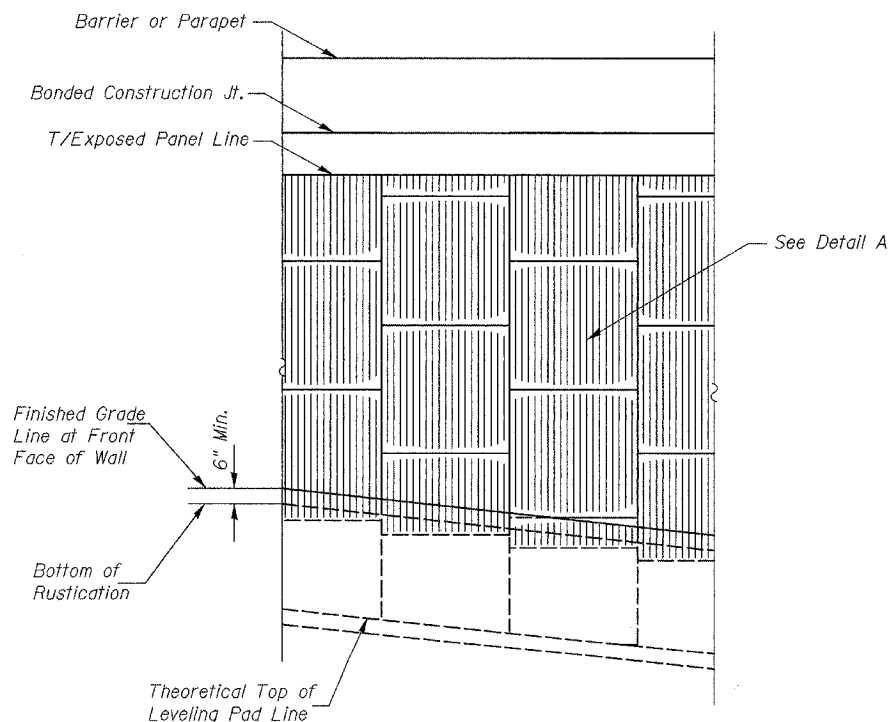

**ELEVATION
TYPICAL ARCHITECTURAL FINISH**

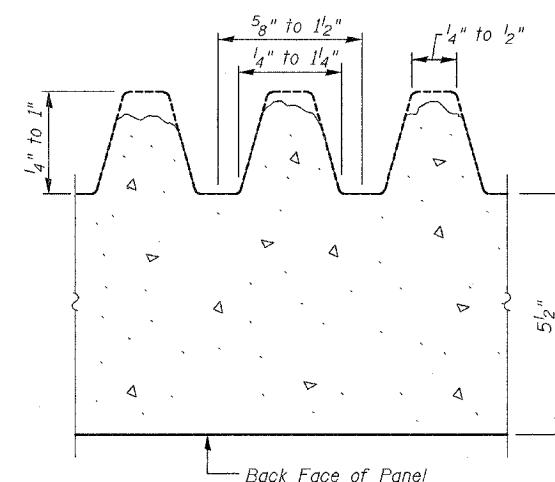

**DETAIL A
PRECAST MSE PANEL
FRACTURED FIN DETAIL**

NOTE: Fractured Fin Rustications shall be placed on Precast Mechanically Stabilized Earth Retaining Wall panels as shown in Detail A. Fractured Fin Rustication is included in the cost of Mechanically Stabilized Earth Retaining Wall. The Contractor shall submit 1.5 Sq. Ft. sample for Engineer's approval.

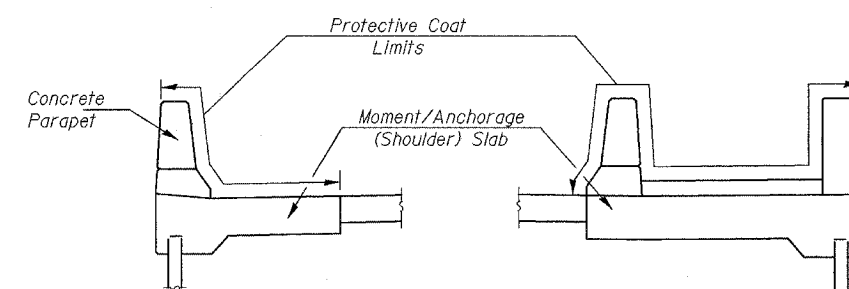

PROTECTIVE COAT LIMITS

DESIGNED	JOH
CHECKED	BRT
DRAWN	TD
CHECKED	JOH

**GENERAL NOTES, BILL OF MATERIAL
AND INDEX OF SHEETS
MSE WALL NO. 1 & 2
FAU ROUTE 6145
SECTION 01-00590-00-BR (COUNTY)
LASALLE COUNTY
STATION 16+66.11 TO 27+40.27**

HUTCHISON ENGINEERING, INC.
JACKSONVILLE & JOLIET, ILLINOIS

Date: 3 /10 /2006