

SCHEDULE OF QUANTITIES

FAS ROUTE NO.	SEC	COUNTY	TOTAL SHEETS	SHEET NO.
-	*	DEKALB	21	3

ILLINOIS PROJECT BRS-1122(107)

* 04-00206-00-BR
CONTRACT NO. 87316

LOCATION	TON
STA 53+45 - STA 56+68	347
STA 57+12 - STA 66+00	650
STA 250+98 - STA 252+25	406
STA 100+12 - STA 101+00	159
TOTAL	1561 TON

LOCATION	TON
RT. STA. 60+96	35
LT. STA. 63+68	41
TOTAL	76 TON

LOCATION	TON
STA 53+45 - STA 56+68	0.96
STA 57+12 - STA 66+00	2.14
STA 250+98 - STA 252+25	0.97
STA 100+12 - STA 101+00	0.47
PAULSON ROAD OVERLAY	3.37
TOTAL	7.90 TON

LOCATION	SQ. YD.
STA 53+45 - STA 53+95	133
STA 65+50 - STA 66+00	133
STA 100+75 - STA 101+00	133
STA 250+96 - STA 251+48	133
TOTAL	532 SQ. YD.

LOCATION	TON
STA 53+45 - STA 56+68	323
STA 57+12 - STA 66+00	558
STA 250+98 - STA 252+25	152
STA 100+12 - STA 101+00	79
PAULSON ROAD OVERLAY	1141
TOTAL	2253 TON

LOCATION	TON
STA 53+45 - STA 56+68	125
STA 57+12 - STA 66+00	250
STA 250+98 - STA 252+25	89
STA 100+12 - STA 101+00	42
PAULSON ROAD OVERLAY	570
TOTAL	1065 TON

LOCATION	FOOT
STA 53+45 - STA 56+68	512
STA 57+12 - STA 66+00	1627
STA 250+98 - STA 252+25	293
STA 100+12 - STA 101+00	205
TOTAL	2637 FOOT

LOCATION	TON
LT. STA. 53+45 - RT. STA. 250+98	32
LT. STA. 250+97.80 - LT. STA. 56+68.25	35
LT. STA. 57+11.75 - LT. STA. 66+00	171
RT. STA. 53+45 - RT. STA. 54+75	34
RT. STA. 57+11.75 - RT. STA. 101+00	154
LT. STA. 101+00 - RT. STA. 66+00	54
RT. & LT. STA. 101+00 - STA. 137+50	208
TOTAL	689 TON

LOCATION	FOOT
F.E.R. STA. 61+00	42
F.E.L. STA. 63+68	42
TOTAL	84 FOOT

LOCATION	FOOT
RT. STA. 53+45 - RT. STA. 55+95	250
TOTAL	250 FOOT

LOCATION	FOOT
LT. STA. 251+81 TO RT. STA. 251+65	115
TOTAL	115 FOOT

LOCATION	FOOT
RT. STA. 54+49.5 TO RT. STA. 56+65	212.5
RT. STA. 57+25 TO RT. STA. 58+50	125
LT. STA. 57+25 TO LT. STA. 59+37.5	212.5
TOTAL	550 FOOT

LOCATION	EACH
RT. STA. 56+55 TO RT. STA. 56+68.25	1
LT. STA. 56+55 TO LT. STA. 56+68.25	1
RT. STA. 57+11.75 TO RT. STA. 57+25	1
LT. STA. 57+11.75 TO LT. STA. 57+25	1
TOTAL	4 EACH

LOCATION	EACH
RT. STA. 53+92.50 TO RT. STA. 54+42.50	1
RT. STA. 58+50 TO RT. STA. 59+00	1
LT. STA. 59+37.50 TO LT. STA. 59+87.50	1
TOTAL	3 EACH

LOCATION	EACH
LT. STA. 59+30 TO LT. STA. 59+55	1
TOTAL	1 EACH

LOCATION	FOOT
RT. STA. 55+55 TO RT. STA. 56+72	117
LT. STA. 55+83 TO LT. STA. 56+73	90
RT. STA. 57+05 TO RT. STA. 57+96	91
LT. STA. 57+06 TO LT. STA. 58+22	116
TOTAL	414 FOOT

LOCATION	SQ. FT.
LT. STA. 56+39 (RT TURN ARROW)	15.6
LT. STA. 58+03 (RT TURN ARROW)	15.6
LT. STA. 56+39 (STRAIGHT ARROW)	11.5
LT. STA. 58+03 (STRAIGHT ARROW)	11.5
TOTAL	54.2 SQ. FT.

LOCATION	FOOT
STA. 53+45 - STA. 58+89 (SKIP DASH)	136
STA. 58+89 - STA. 64+12 (SKIP DASH)	131
STA. 68+89 - STA. 66+00	711
STA. 64+12 - STA. 66+00	188
STA. 250+98 - STA. 252+19	121
STA. 250+98 - STA. 252+19	121
TOTAL	1408 FOOT

LOCATION	FOOT
LT. STA. 53+45 - RT. STA. 250+98	225
LT. STA. 250+98 - LT. STA. 66+00	1189
RT. STA. 53+45 - RT. STA. 101+00	1066
LT. STA. 101+00 - RT. STA. 66+00	325
LT. STA. 54+81 (ISLAND)	17
LT. STA. 55+14 (ISLAND)	21
RT. STA. 63+39 (ISLAND)	17
TOTAL	2860 FOOT

LOCATION	FOOT
LT. STA. 55+42 - LT. STA. 58+54	313
LT. STA. 58+54 - LT. STA. 61+19 (SKIP DASH)	66
LT. STA. 54+81 (ISLAND)	92
LT. STA. 55+14 (ISLAND)	187
RT. STA. 63+39 (ISLAND)	96
TOTAL	754 FOOT

LOCATION	FOOT
LT. STA. 54+81 (ISLAND)	12
LT. STA. 55+14 (ISLAND)	19
RT. STA. 63+39 (ISLAND)	12
TOTAL	43 FOOT

LOCATION	FOOT
RT. STA. 252+19	12
RT. STA. 252+07	27
RT. STA. 100+32	12
RT. STA. 100+43	27
TOTAL	78 FOOT

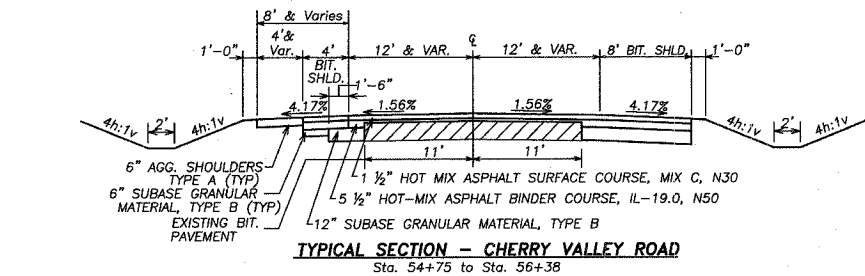
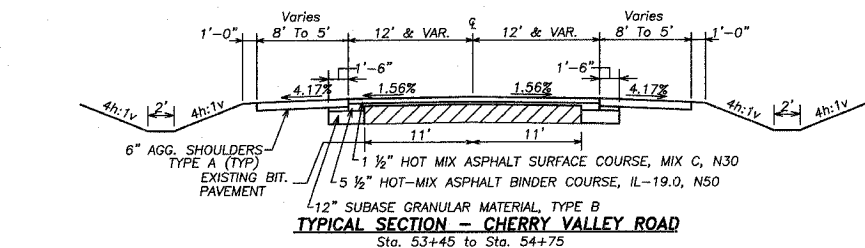

BRIDGE OMISSION STA. 56+68.25 to STA. 57+11.75

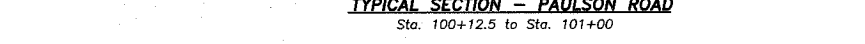
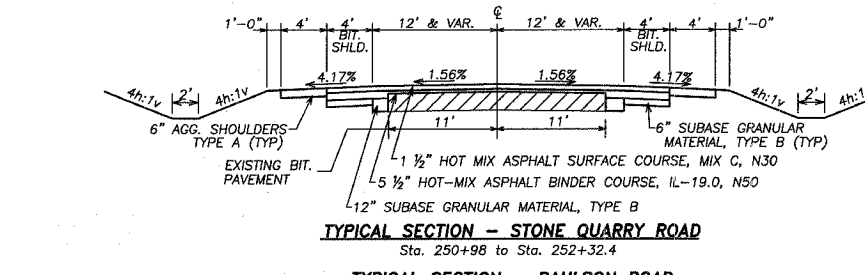
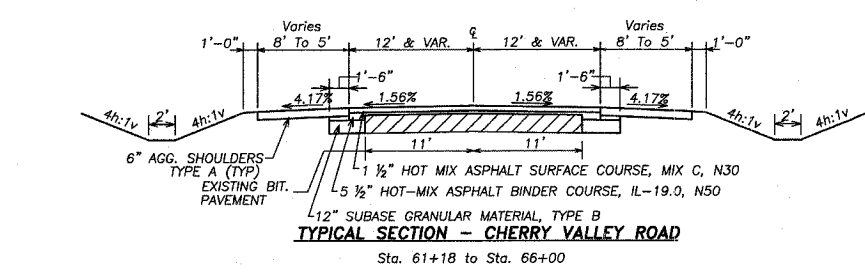
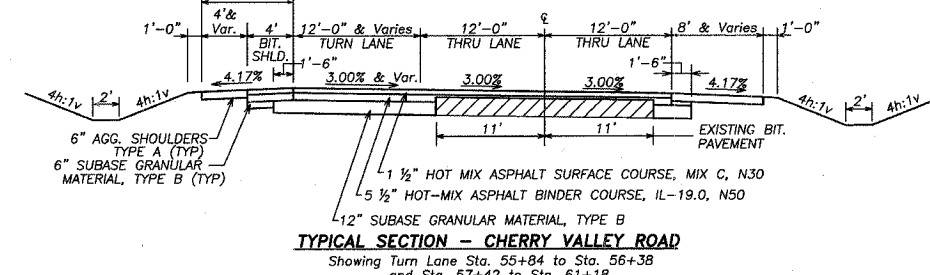
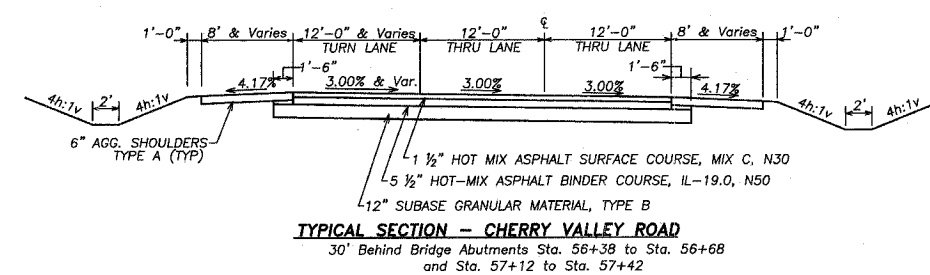

HOT-MIX ASPHALT CHART

	HMA BINDER	HMA SURFACE
PG GRADE	PG58-28	PG58-28
MAX % RAP ALLOWABLE**	25%	10%
DESIGN AIR VOIDS	4.0% @ N50	3.0% @ N30
MIXTURE COMPOSITION	IL 19.0	IL 9.5L
FRICITION AGGREGATE		MIXTURE C
DENSITY TEST METHOD	SEE SPECIAL PROVISIONS	

**IF RAP OPTION IS SELECTED, THE ASPHALT CEMENT GRADE MAY NEED TO BE ADJUSTED. THIS WILL BE DETERMINED BY THE ENGINEER.

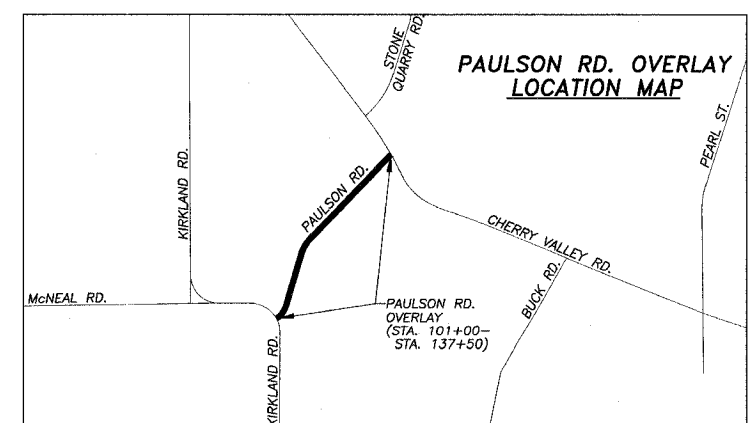
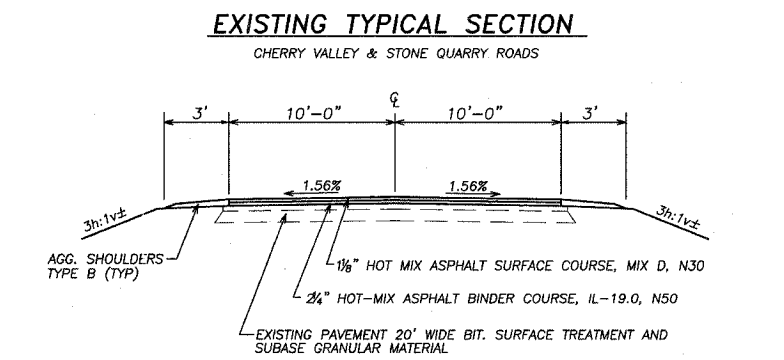
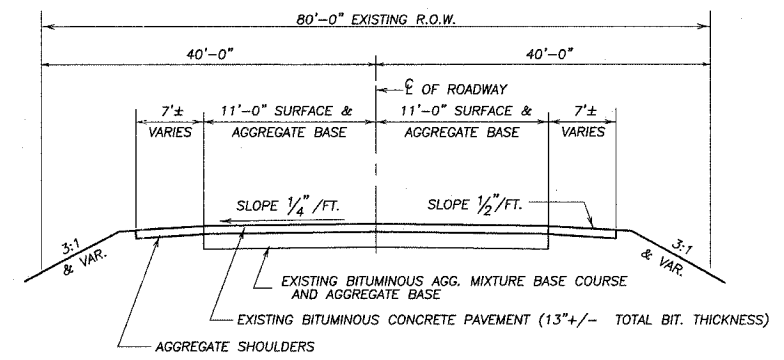

SCHEDULE OF QUANTITIES TYPICAL SECTIONS SECTION 04-00206-00-BR CHERRY VALLEY ROAD DEKALB COUNTY