

SEC. 29, T.10N., R.8E., 4th P.M.

RTE NO.	SECTION	COUNTY	TOTAL	SHEET #
FA 646	(Y)W-1, RS-3	PEORIA	142	57
STATION 15+150 TO STATION 15+350				

REMOVAL LEGEND

	1 CURB & GUTTER REMOVAL
	2 N/A
	3 PAVEMENT REMOVAL
	4 PAVED SHOULDER REMOVAL (m ²)
	±460mm WIDE (NOMINAL) 5 BIT. SHOULDER REMOVAL (meter)
	6 BUILDING REMOVAL
	7 REMOVE EXISTING CULVERTS (meter)
	8 PIPE CULVERT REMOVAL (EACH)
	9 DRIVEWAY PAVEMENT REMOVAL
	10 SIDEWALK REMOVAL
	11 STORM SEWER REMOVAL
	INDIVIDUAL TREE REMOVAL (UNITS)

CURVE #3
 PI STA 15+377.332
 PC STA 15+235.377
 PT STA 15+516.773
 Δ = 18°39'35" (LT.)
 R = 864.044m
 T = 141.955m
 L = 281.396m
 S.E. = 3.6%
 S.E. ATTAIN - 15+155 TO 15+275
 S.E. REMOVE - 15+477 TO 15+597

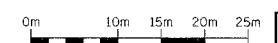
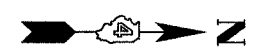
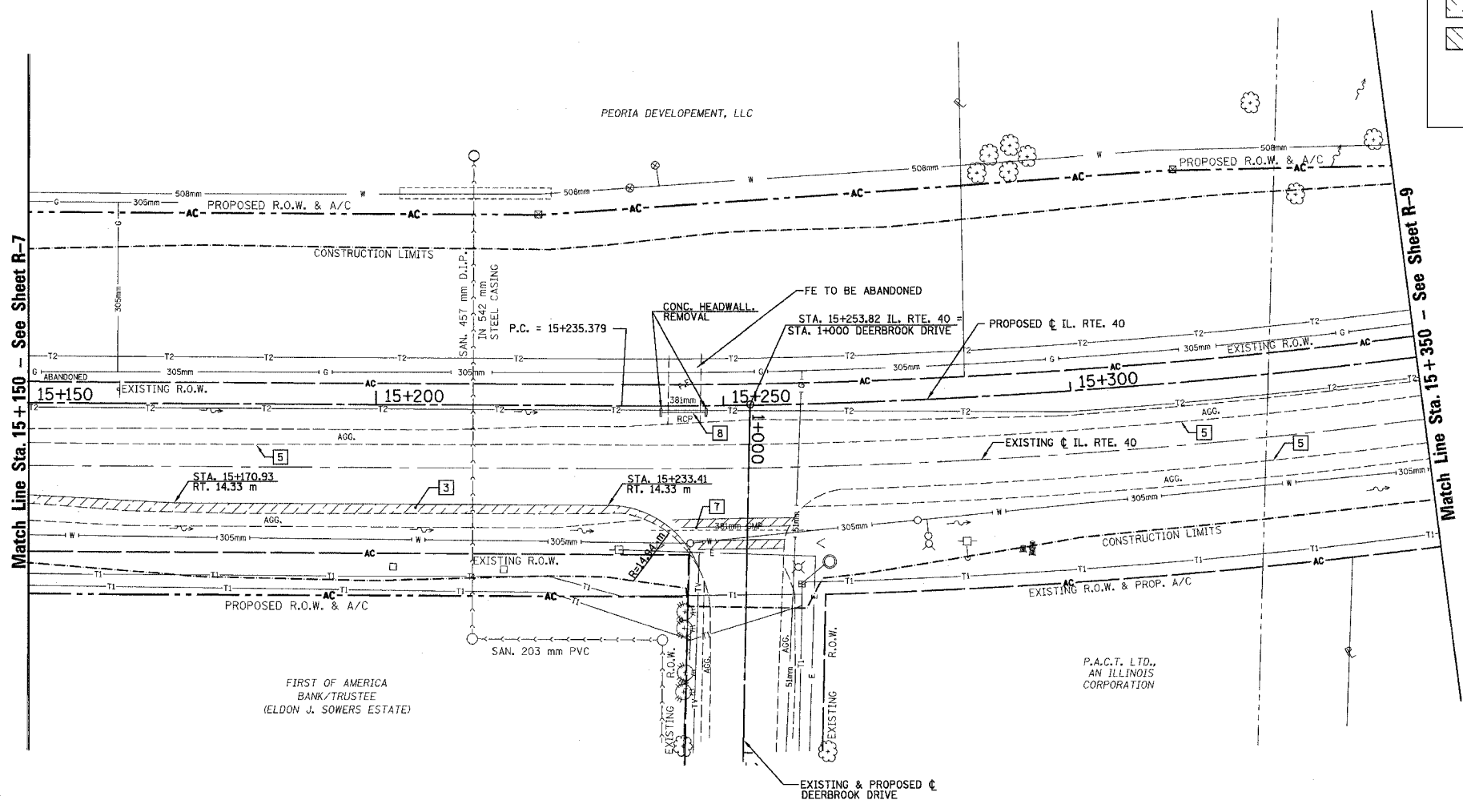

REVISIONS	
NAME	DATE

ILLINOIS DEPARTMENT OF TRANSPORTATION
EXISTING /REMOVAL
ILLINOIS ROUTE 40
 STA. 15+150 TO STA. 15+350
 SCALE: 1:400
 DATE: 09/01/06
 DRAWN BY: JDU
 CHECKED BY: ECM

R-8