

SEC.29&32, T.10N., R.8E., 4th P.M.

RTE NO.	SECTION	COUNTY	TOTAL	SHEET #
FA 646	(Y)W-1, RS-3	PEORIA	142	61
STATION 0+750 TO STATION 0+970				

REMOVAL LEGEND

	1 CURB & GUTTER REMOVAL
	2 N/A
	3 PAVEMENT REMOVAL
	4 PAVED SHOULDER REMOVAL (m ²)
	5 BIT. SHOULDER REMOVAL (meter)
	6 BUILDING REMOVAL
	7 REMOVE EXISTING CULVERTS (meter)
	8 PIPE CULVERT REMOVAL (EACH)
	9 DRIVEWAY PAVEMENT REMOVAL
	10 SIDEWALK REMOVAL
	INDIVIDUAL TREE REMOVAL (UNITS)

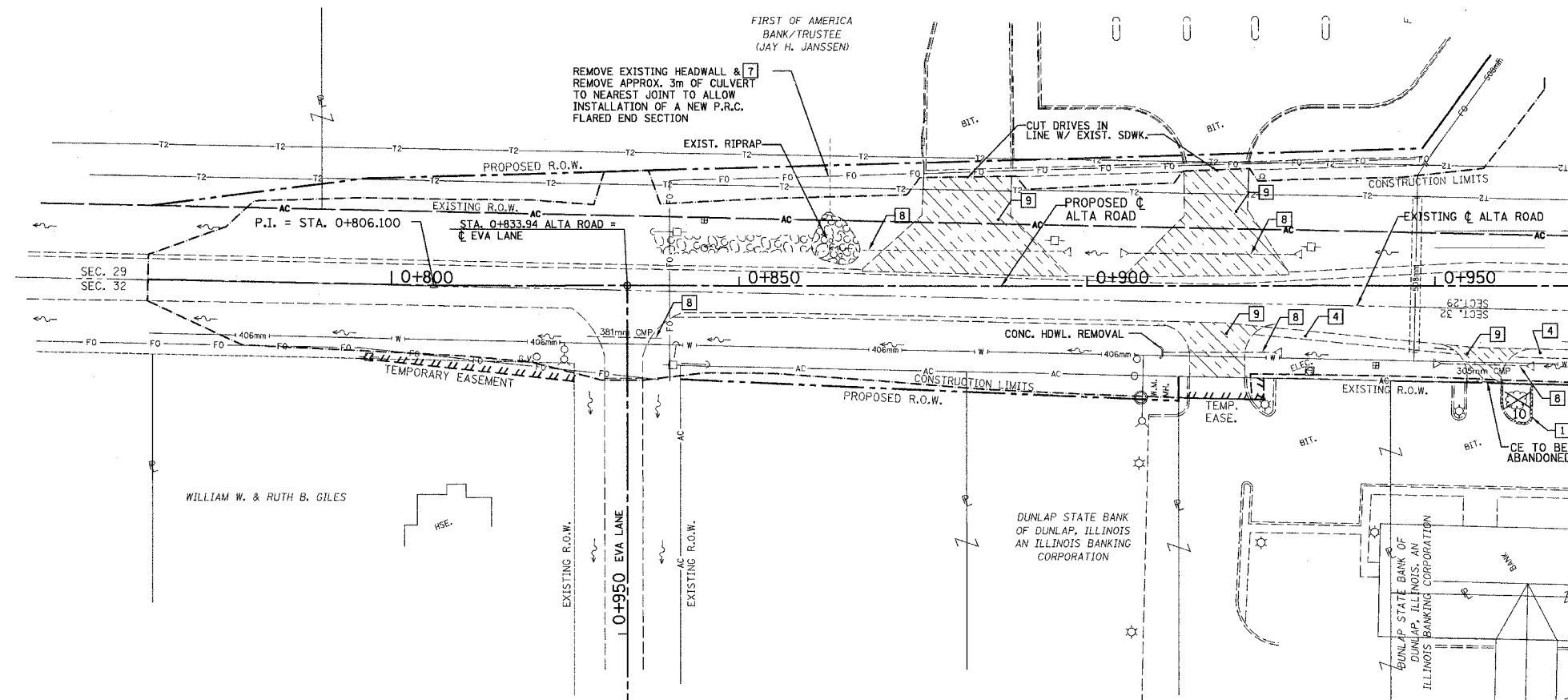

Match Line 0+970 - See Sheet R-3



0m 10m 15m 20m 25m

REVISIONS	
NAME	DATE

ILLINOIS DEPARTMENT OF TRANSPORTATION
EXISTING /REMOVAL
ILLINOIS ROUTE 40
 ALTA ROAD
 STA. 0+750 TO STA. 0+970
 SCALE: 1:400
 DATE: 09/01/06
 DRAWN BY: JDU
 CHECKED BY: ECM

R-15