

B.M. "M29B-1" - BRASS DISC IN CONCRETE  
 STA. 14+100±, 16m± RT.  
 ELEV. = 243.566  
 T.B.M. "2" - TOP VALVE STEM FIRE HYD.  
 STA. 14+002±, 16m± RT.  
 ELEV. = 244.011

SEC. 32 & 29, T. 10N., R. 8E., 4th P.M.

RTE NO.	SECTION	COUNTY	TOTAL SHEET #
FA 646	(Y)W-1, RS-3	PEORIA	142 / 74
STATION 2+300 TO STATION 2+450			

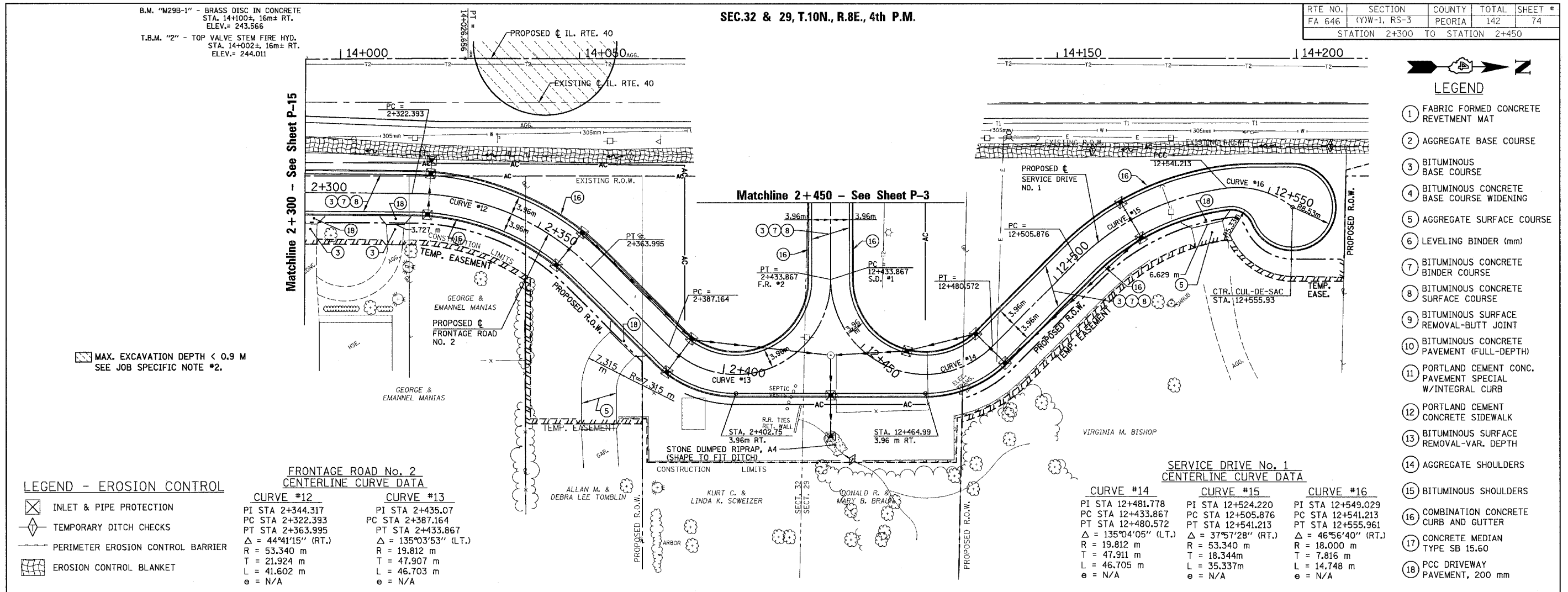

- LEGEND - EROSION CONTROL**
- INLET & PIPE PROTECTION
  - TEMPORARY DITCH CHECKS
  - PERIMETER EROSION CONTROL BARRIER
  - EROSION CONTROL BLANKET

- LEGEND**
- 1 FABRIC FORMED CONCRETE REVETMENT MAT
  - 2 AGGREGATE BASE COURSE
  - 3 BITUMINOUS BASE COURSE
  - 4 BITUMINOUS CONCRETE BASE COURSE WIDENING
  - 5 AGGREGATE SURFACE COURSE
  - 6 LEVELING BINDER (mm)
  - 7 BITUMINOUS CONCRETE BINDER COURSE
  - 8 BITUMINOUS CONCRETE SURFACE COURSE
  - 9 BITUMINOUS SURFACE REMOVAL-BUTT JOINT
  - 10 BITUMINOUS CONCRETE PAVEMENT (FULL-DEPTH)
  - 11 PORTLAND CEMENT CONC. PAVEMENT SPECIAL W/INTEGRAL CURB
  - 12 PORTLAND CEMENT CONCRETE SIDEWALK
  - 13 BITUMINOUS SURFACE REMOVAL-VAR. DEPTH
  - 14 AGGREGATE SHOULDERS
  - 15 BITUMINOUS SHOULDERS
  - 16 COMBINATION CONCRETE CURB AND GUTTER
  - 17 CONCRETE MEDIAN TYPE SB 15.60
  - 18 PCC DRIVEWAY PAVEMENT, 200 mm

