

APPENDIX A
BUILDING SEWER REGULATIONS
SANITARY SEWER CONNECTION DETAILS
DETAIL F

Commercial Individual Building (Single or Multi Story)
(Includes Multi Story, Multi Tenant, with One Owner)

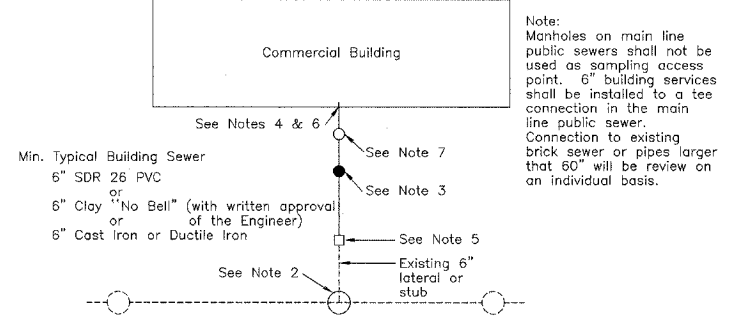

- Note: 1. Building sewer shall be sized per Illinois Administrative Code Chapter II (attached in appendix) and GPSD General Specifications Section Design Criteria. Discharges greater than 15 P.E. will require an EPA Permit.
2. If 8" or larger building sewer is installed, a manhole will be installed in the main line sewer.
3. A Sampling Access Structure may be located at any convenient location along the building sewer.
4. Gasoline, oil and flammable liquids interceptor shall be required as per 77 Illinois Administrative Code Section 890.520 (See attached Appendix C.)
5. Rubber boot transition coupling as needed unless other method is approved prior to construction.
6. Building sewer within 5' of the building shall meet State of Illinois Plumbing Code.
7. Option of installing a clean-out on the outside of the building.
8. Commercial Permit Required
9. Residential units in combination with a commercial building will be covered by the commercial permit. A separate residential permit will not be required.
- General Note: 1. Taps to existing main line sewer pipe shall be mechanical drilled by Predco or equal, typ.
2. All pipe shall be bedded with CA7 or CA11 material from an approved source per Building Reg. 10 and Sec. 035 - 5.0 Bedding GPSD General Specification.

- Legend
- 8" or larger Main Line Sewer
 - Existing Manhole
 - Proposed Manhole
 - Typ. Sampling Access Structure

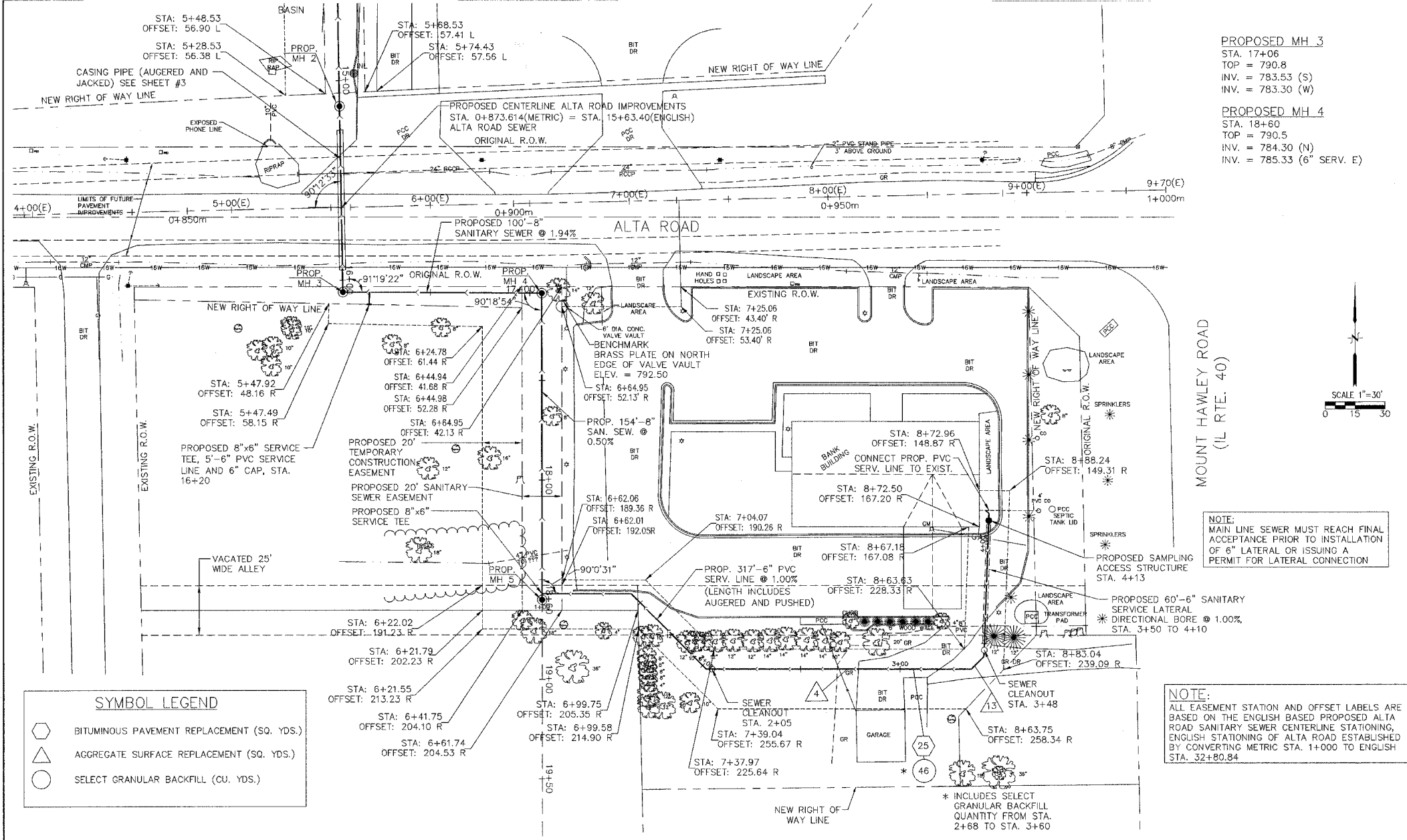

- SYMBOL LEGEND
- BITUMINOUS PAVEMENT REPLACEMENT (SQ. YDS.)
 - AGGREGATE SURFACE REPLACEMENT (SQ. YDS.)
 - SELECT GRANULAR BACKFILL (CU. YDS.)

NOTE: MAIN LINE SEWER MUST REACH FINAL ACCEPTANCE PRIOR TO INSTALLATION OF 6" LATERAL OR ISSUING A PERMIT FOR LATERAL CONNECTION

NOTE: ALL EASEMENT STATION AND OFFSET LABELS ARE BASED ON THE ENGLISH BASED PROPOSED ALTA ROAD SANITARY SEWER CENTERLINE STATIONING, ENGLISH STATIONING OF ALTA ROAD ESTABLISHED BY CONVERTING METRIC STA. 1+000 TO ENGLISH STA. 32+80.84

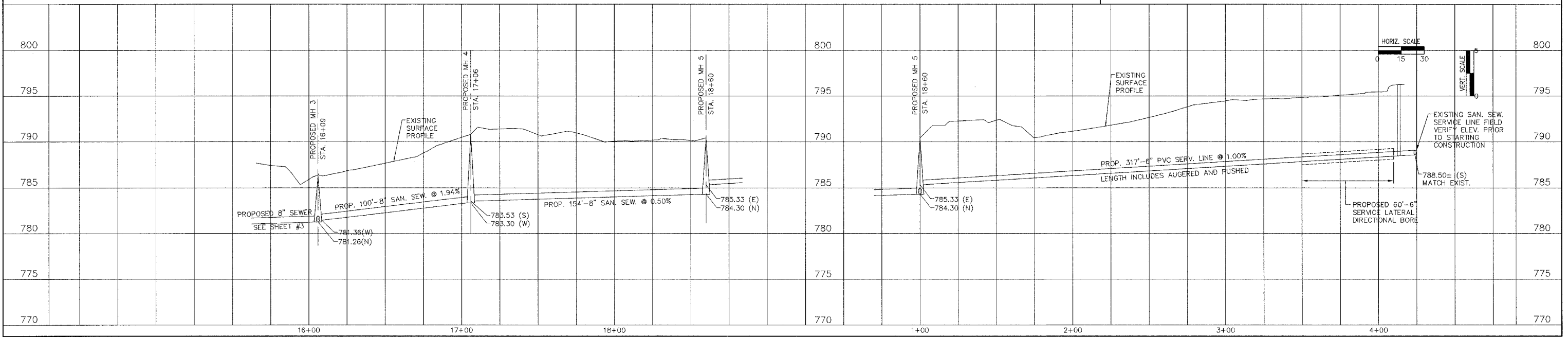

REVISIONS		
NO.	ITEM	DATE
1	REVISED AS PER GPSD & IDOT	3/8/06
2	ADD SERVICE BACK TO PLANS	3/16/06
3	RAISED SEWER OVER WATER MAIN	4/10/06
4	REVISED PROPERTY LINE AT ALLEY	6/20/06

PLOTTING SCALE: 1" = 30'

DRAWN BY: JAH/APS

CHECKED BY: JAR

DATE: JANUARY 2006

McCLURE ENGINEERING ASSOCIATES, INC.

714 East Jackson Street
Peoria, Illinois 61655
(309) 833-4594
FAX (309) 837-4909

Design firm License #184-000816 Copyright 2006 by McClure Engineering Associates, Inc.

ALTA ROAD SANITARY SEWER EXTENSION PLAN AND PROFILE

PEORIA, ILLINOIS

FILE NAME: W:\DWG\PEORIA-2005\DUMLAP-BANK.DWG FIELD BOOK No. 2679-A JOB NUMBER: 03-23-05-114