

SEC.29, T.10N., R.8E., 4th P.M.

RTE NO.	SECTION	COUNTY	TOTAL SHEET #
FA 646	(Y)W-1, RS-3	PEORIA	142 89
STATION 14+900 TO STATION 15+350			

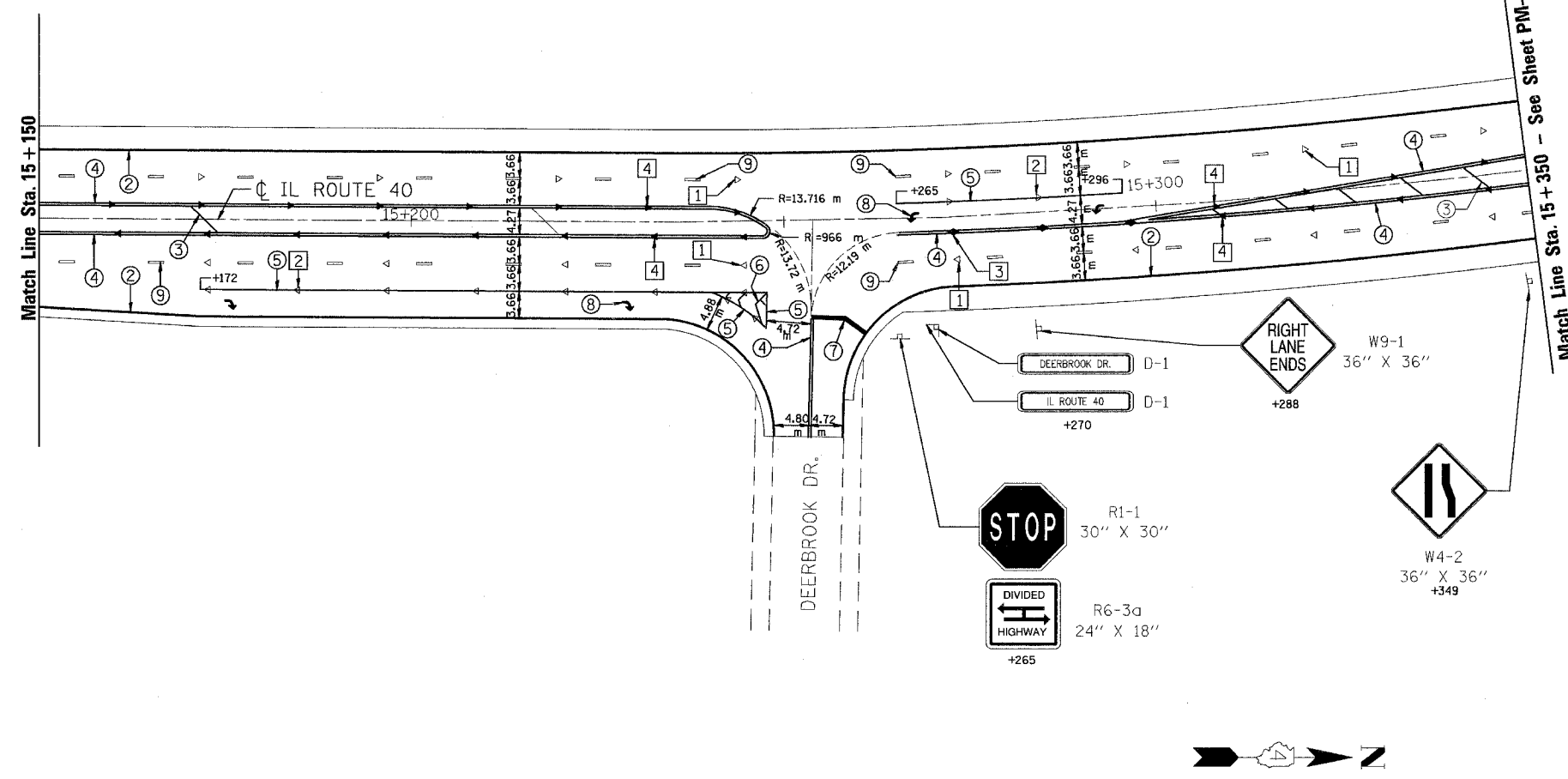

SIGN PANEL ERECTION DETAILS
REFER TO STANDARD 720006, MULTILANE HIGHWAYS, NONFREEWAYS.

- RAISED REFLECTIVE PAVEMENT MARKERS (RRPM)
- 1 4 ONE-WAY RRPM CRYSTAL MARKER AT 24.38 m CENTERS
 - 2 4 ONE-WAY RRPM CRYSTAL MARKER AT 12.19 m CENTERS
 - 3 TWO-WAY RRPM AMBER MARKER AT 12.19 m
 - 4 ONE-WAY RRPM AMBER MARKER AT 12.19 m

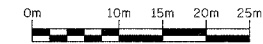
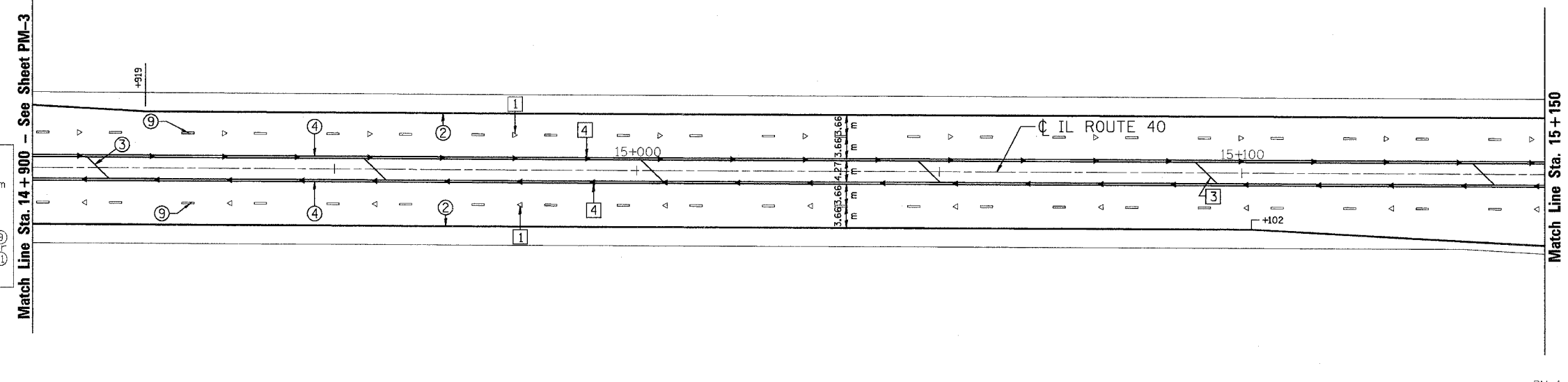
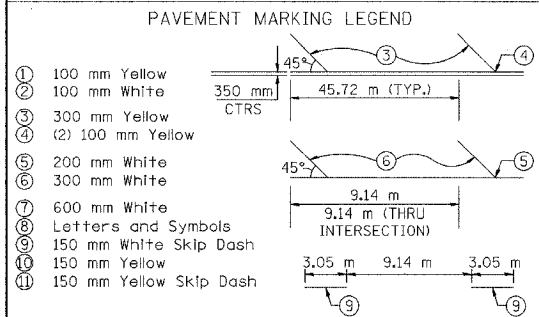
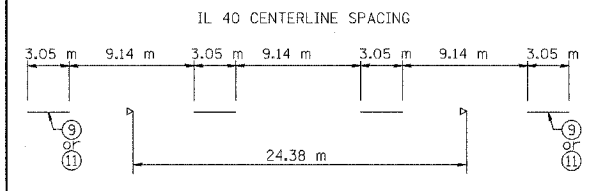

REVISIONS	
NAME	DATE

ILLINOIS DEPARTMENT OF TRANSPORTATION
PAVEMENT MARKINGS AND SIGNING PLAN
ILLINOIS ROUTE 40

SCALE: 1:400
DATE: 09/01/06

DRAWN BY: JDU
CHECKED BY: ECM