

UNLESS ELEVATIONS ARE SHOWN:
ALL UTILITY LOCATIONS ON THE CROSS SECTIONS ARE BASED ON
THE APPROXIMATE DEPTH SUPPLIED BY THE UTILITY COMPANY.

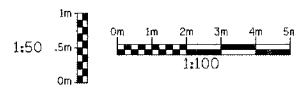

TOPSOIL EXCAVATION QUANTITIES DO
NOT INCLUDE THE STOCKPILE LOCATED
AT STA. 14+240 TO 14+295

RTE NO.	SECTION	COUNTY	TOTAL	SHEET #
FA 646	(Y)W-1, RS-3	PEORIA	142	130
STATION 15+025 TO STATION 15+100				

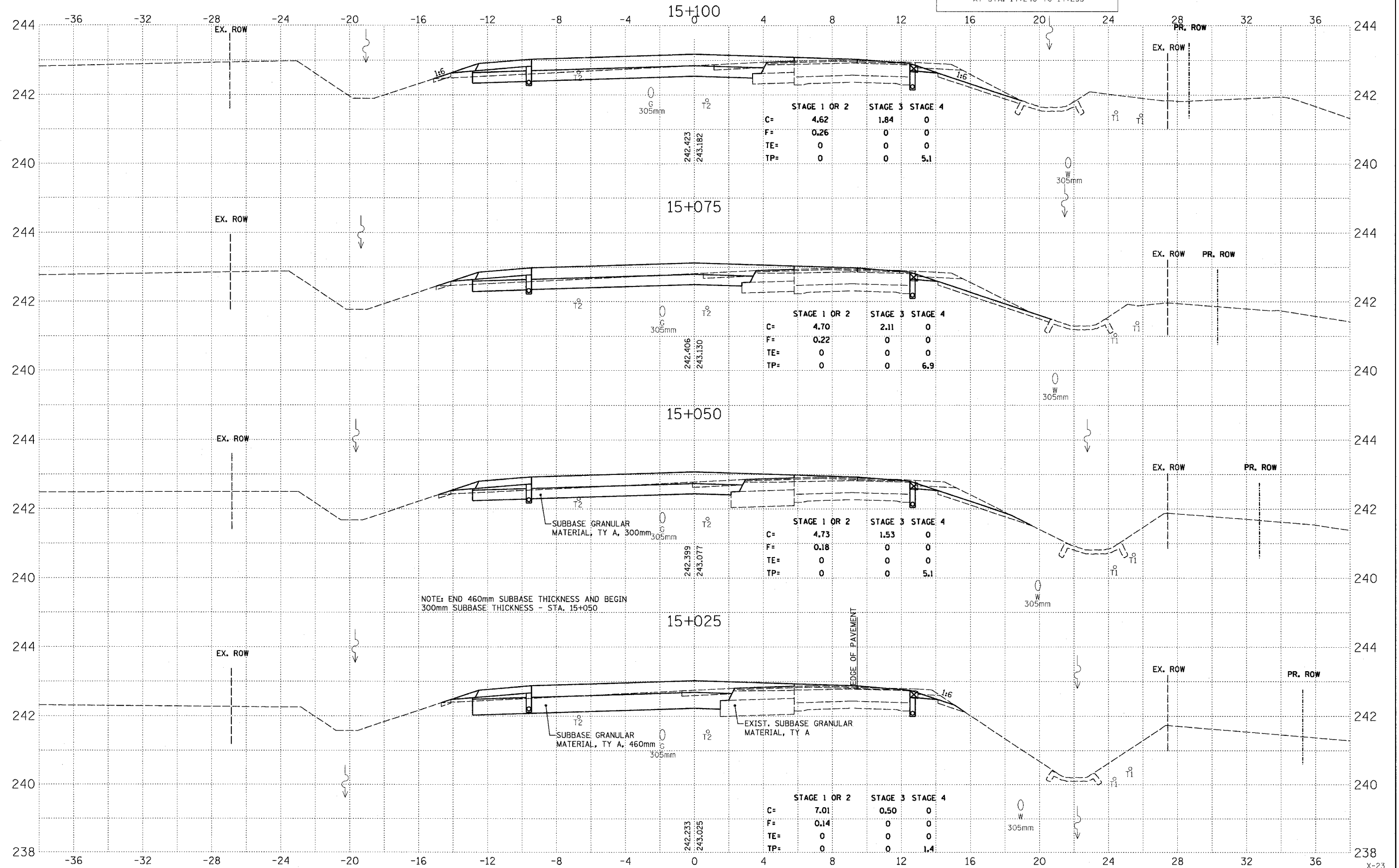

	STAGE 1 OR 2	STAGE 3	STAGE 4
C=	4.62	1.84	0
F=	0.26	0	0
TE=	0	0	0
TP=	0	0	5.1

	STAGE 1 OR 2	STAGE 3	STAGE 4
C=	4.70	2.11	0
F=	0.22	0	0
TE=	0	0	0
TP=	0	0	6.9

	STAGE 1 OR 2	STAGE 3	STAGE 4
C=	4.73	1.53	0
F=	0.18	0	0
TE=	0	0	0
TP=	0	0	5.1

	STAGE 1 OR 2	STAGE 3	STAGE 4
C=	7.01	0.50	0
F=	0.14	0	0
TE=	0	0	0
TP=	0	0	1.4

NOTE: END 460mm SUBBASE THICKNESS AND BEGIN
300mm SUBBASE THICKNESS - STA. 15+050