

UNLESS ELEVATIONS ARE SHOWN:
ALL UTILITY LOCATIONS ON THE CROSS SECTIONS ARE BASED ON
THE APPROXIMATE DEPTH SUPPLIED BY THE UTILITY COMPANY.

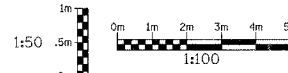

TOPSOIL EXCAVATION QUANTITIES DO NOT INCLUDE THE STOCKPILE LOCATED AT STA. 14+240 TO 14+295

RTE NO.	SECTION	COUNTY	TOTAL	SHEET #
FA 646	(Y)W-1, RS-3	PEORIA	142	134
STATION 15+375 TO STATION 15+429				

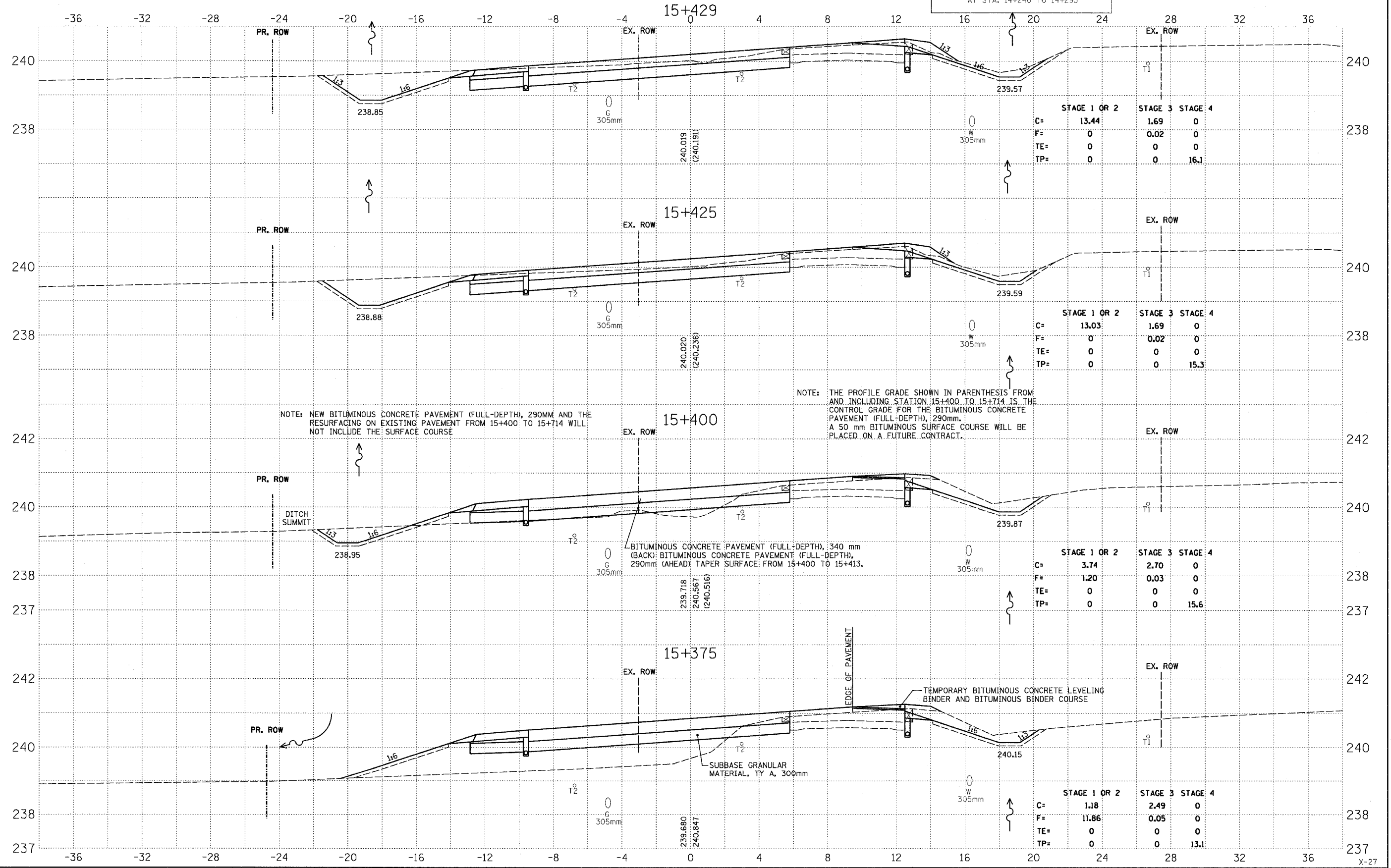

	STAGE 1 OR 2	STAGE 3	STAGE 4
C=	13.44	1.69	0
F=	0	0.02	0
TE=	0	0	0
TP=	0	0	16.1

	STAGE 1 OR 2	STAGE 3	STAGE 4
C=	13.03	1.69	0
F=	0	0.02	0
TE=	0	0	0
TP=	0	0	15.3

	STAGE 1 OR 2	STAGE 3	STAGE 4
C=	3.74	2.70	0
F=	1.20	0.03	0
TE=	0	0	0
TP=	0	0	15.6

	STAGE 1 OR 2	STAGE 3	STAGE 4
C=	1.18	2.49	0
F=	11.86	0.05	0
TE=	0	0	0
TP=	0	0	13.1

NOTE: NEW BITUMINOUS CONCRETE PAVEMENT (FULL-DEPTH), 290MM AND THE RESURFACING ON EXISTING PAVEMENT FROM 15+400 TO 15+714 WILL NOT INCLUDE THE SURFACE COURSE

NOTE: THE PROFILE GRADE SHOWN IN PARENTHESIS FROM AND INCLUDING STATION 15+400 TO 15+714 IS THE CONTROL GRADE FOR THE BITUMINOUS CONCRETE PAVEMENT (FULL-DEPTH), 290MM. A 50 mm BITUMINOUS SURFACE COURSE WILL BE PLACED ON A FUTURE CONTRACT.

BITUMINOUS CONCRETE PAVEMENT (FULL-DEPTH), 340 mm; (BACK) BITUMINOUS CONCRETE PAVEMENT (FULL-DEPTH), 290mm (AHEAD) TAPER SURFACE FROM 15+400 TO 15+413.

TEMPORARY BITUMINOUS CONCRETE LEVELING BINDER AND BITUMINOUS BINDER COURSE

SUBBASE GRANULAR MATERIAL, TY A, 300mm