

F.A.P. RTE.	SECTION	COUNTY	TOTAL SHEETS	SHEET NO.
821	13B-1	JEFFERSON	39	9
STA.		TO STA.		
FED. ROAD DIST. NO.		ILLINOIS FED. AID PROJECT		

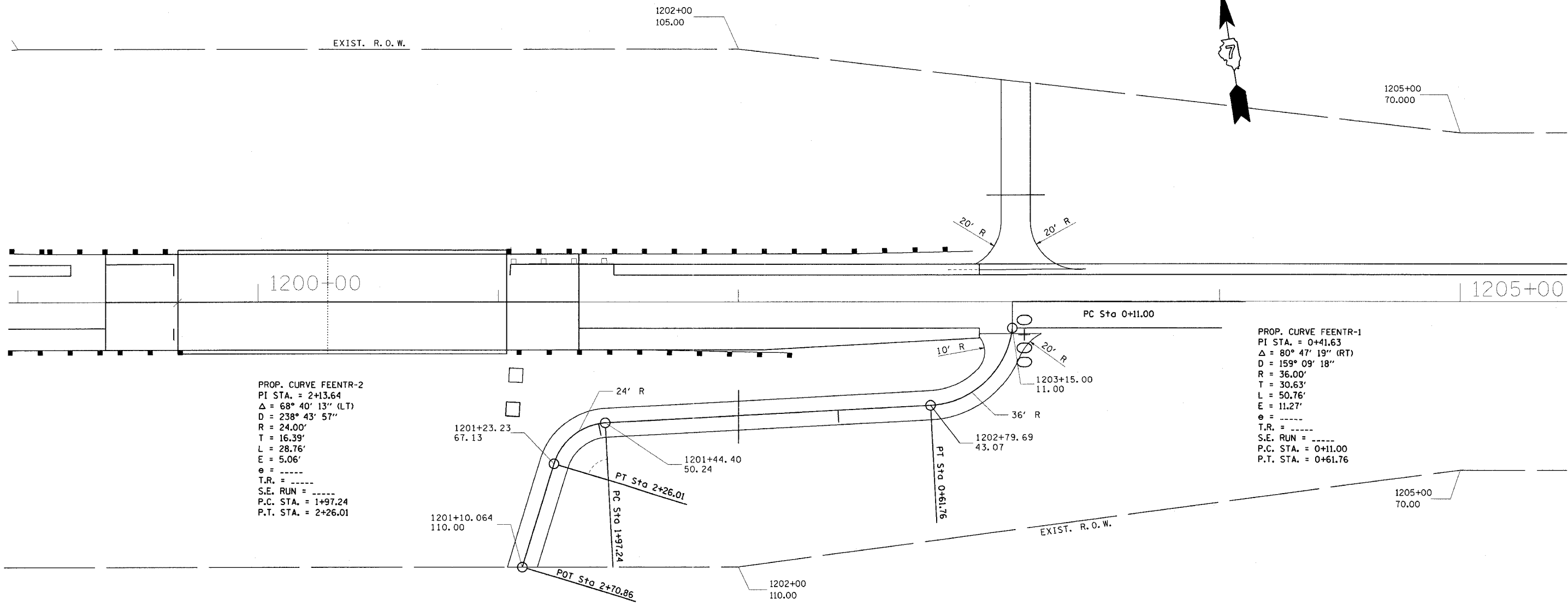

PROP. CURVE FEENTR-2
 PI STA. = 2+13.64
 Δ = 68° 40' 13'' (LT)
 D = 238° 43' 57''
 R = 24.00'
 T = 16.39'
 L = 28.76'
 E = 5.06'
 e = -----
 T.R. = -----
 S.E. RUN = -----
 P.C. STA. = 1+97.24
 P.T. STA. = 2+26.01

PROP. CURVE FEENTR-1
 PI STA. = 0+41.63
 Δ = 80° 47' 19'' (RT)
 D = 159° 09' 18''
 R = 36.00'
 T = 30.63'
 L = 50.76'
 E = 11.27'
 e = -----
 T.R. = -----
 S.E. RUN = -----
 P.C. STA. = 0+11.00
 P.T. STA. = 0+61.76

FIELD ENTRANCES
 STATION 1203+15.00

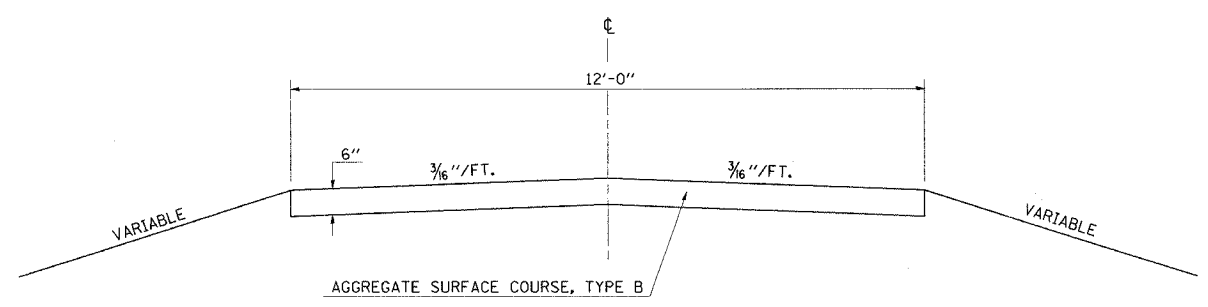

STATION	ELEVATION	GRADE
0+13.5	439.65	-0.827
0+25	439.55	-0.827
0+50	439.34	-0.827
0+75	439.14	-0.827
1+00	438.93	-0.827
1+25	438.73	-0.827
1+50	438.52	-0.827
1+75	438.31	-0.827
2+00	438.10	-0.827
2+10	438.02	-0.827
2+20	437.94	-0.827

REVISIONS	
NAME	DATE

ILLINOIS DEPARTMENT OF TRANSPORTATION

**FIELD ENTRANCE
DETAILS**

SCALE: VERT. _____
 HORIZ. _____

DRAWN BY _____
 CHECKED BY _____

PLOT DATE = 8/23/2088
 FILE NAME = #FILE#
 USER NAME = #USER#