

ROUTE	SECTION	COUNTY	TOWNSHIP	TOTAL SHEETS	SHEET NUMBER
T.R. 93	04-01178-00-BR	UNION	SEC 33, T11S, R1W	14	8
JOB NO. C-99-545-04		PROJECT NO. BROS-181 (22)			
JOHN RICH SCHOOL ROAD		CONTRACT NO. 99271			

B.M. - 2-60D NAILS SET IN P.P. STA. 9+06, 42' LT.
ELEV. 499.00

EXISTING STRUCTURE - STA. 9+88.5 - STA. 10+11.5, 23' SPAN,
(NO. 1) 16' WIDTH, TIMBER RUNNERS AND DECK,
STEEL I-BEAM STRINGERS AND STEEL
RAILS. STONE AND MORTAR ABUTMENTS
WITH TIMBER PILING.

SALVAGE - CONTRACTOR TO SALVAGE STONE FROM
(STRUCTURE NO. 1) EXISTING ABUTMENTS. STONE TO BE
DELIVERED TO UNION COUNTY
HIGHWAY DEPARTMENT IN
JONESBORO, ILLINOIS.

DESIGN SPECIFICATIONS

2002 AASHTO Standard Specifications - 17th ed.

LOADING HS20-44

Allow 25#/sq. ft. for future
wearing surface.

SEISMIC DATA

Seismic Performance Category (SPC) = B
Bedrock Acceleration Coefficient (A) = 0.145
Site Coefficient (S) = 1.0

PILE DATA (2-ABUTS.)

TYPE	HP 10X42 STEEL PILES
CAPACITY	SET PILES IN ROCK
ESTIMATED LENGTH	125 FEET (4 @ 15.6 FT. + 4 @ 15.7 FT.)
NUMBER REQUIRED	8 EACH

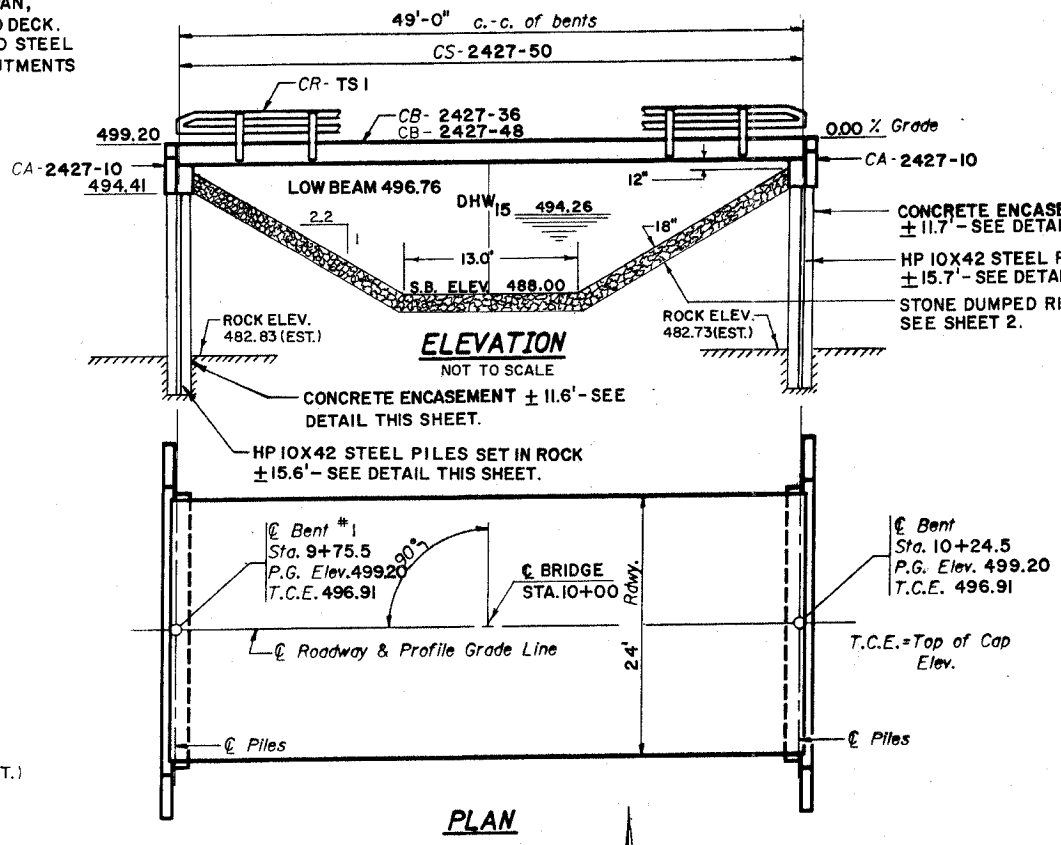

GENERAL NOTES

- See Special Provisions for boring logs.
- A Corrosion inhibitor, as covered in the Special Provisions, shall be used in the concrete for precast prestressed concrete deck beams.
- AFTER DECK BEAMS HAVE BEEN SET, THE DECK SURFACE SHALL BE INSPECTED.

TOTAL BILL OF MATERIAL

Item	Unit	Super	Sub.		Total
			Piers	Abuts.	
Removal of Existing Structures	Each				1
STONE DUMPED RIP-RAP, CLASS A-4	Ton				650
Concrete Structures	Cu. Yd.			18.2	18.2
Precast Prestressed Concrete Deck Beams (27" Depth)	Sq. Ft.	1200			1200
Steel Railing, Type S-1	Foot	100			100
Reinforcement Bars	Pound			2300	2300
Furnishing STEEL PILES HP 10X42	Foot			125	125
SETTING PILES IN ROCK	EACH			8	8
Name Plates					
CONCRETE ENCASEMENT	Cu. Yd.			8.0	8.0

NOTE:
CHANNEL AND STRUCTURE EXCAVATION TO
BE PAID FOR AS EARTH EXCAVATION.

INDEX OF SHEETS

- STANDARD CS-2427-50
- STANDARD CB-2427-36
- STANDARD CB-2427-48
- STANDARD CA-2427-10
- STANDARD CR-TS1
- STANDARD CN

QUANTITIES / LIN. FT. OF ENCASEMENT (STEEL PILES)

Pile Size	Item	Quantity
HP 10	Concrete Encasement	0.006 CY

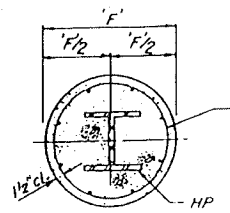

SECTION A-A
DETAIL OF HP
PILE ENCASEMENT

PILE DETAILS

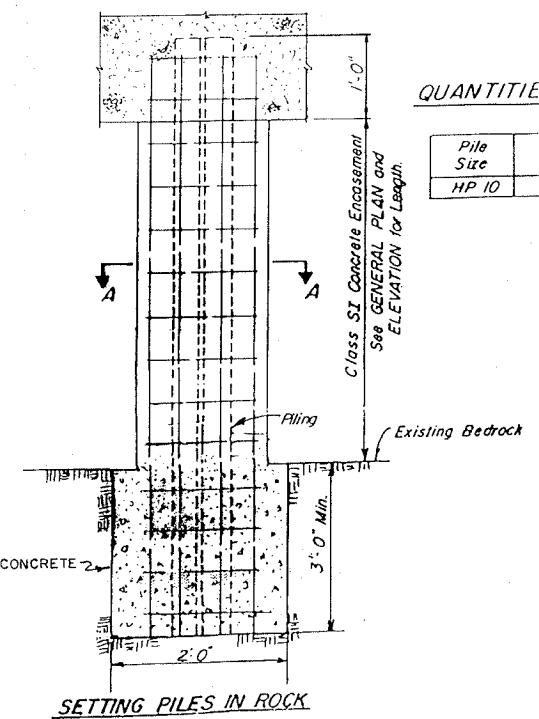

Concrete Encasement to be constructed from
existing bedrock to bottom of bent when piles
are set in rock.

A TRIBUTARY TO
CACHE RIVER
SEC. 04-01178-00-BR BUILT 2007
TR 93-JOHN RICH SCHOOL ROAD
UNION COUNTY
LOADING HS20
STR. NO. 091-3223

LETTERING FOR NAME PLATE
Locate Name Plate at NORTHWEST
Corner of Bridge (See Std. CN)

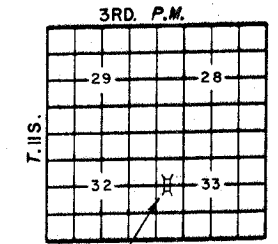

PROPOSED R.1W.
BRIDGE
LOCATION SKETCH

WATERWAY INFORMATION

Drainage Area = 1.125 SQ. MI.		Low Grade Elev. = 498.13		Sta. 12+25					
Flood	Freq. Yr.	Q C.F.S.	Opening Sq. Ft.	Not. H.W.E.	Head - Ft.	Headwater El.			
Design	15	770	102	166	494.06	0.43	0.20	494.49	494.26
Base	100	1242	155	266	494.98	2.02	0.59	497.00	495.57
Overtopping									
Max. Calc.	500	1632							

GENERAL PLAN & ELEVATION

TR 93-JOHN RICH SCHOOL ROAD
OVER TRIBUTARY TO CACHE RIVER
SECTION 04-01178-00-BR
UNION COUNTY
STATION 10+00