

STATE OF ILLINOIS  
DEPARTMENT OF TRANSPORTATION

F.A.E. RTE.	SECTION	COUNTY	TOTAL SHEETS	SHEET NO.
885	D9 PATCH 2018-2	HARDIN	12	1
ILLINOIS CONTRACT NO. 78598				

FOR INDEX OF SHEETS, SEE SHEET NO 3  
FOR SUMMARY OF QUANTITIES, SEE SHEET NO 5

# PROPOSED HIGHWAY PLANS

FAP 885, ROUTE IL 146  
SECTION D9 PATCH 2018-2

SINKHOLE REPAIR  
HARDIN COUNTY

C-99-052-17

TRAFFIC DATA  
IL 146 HARDIN COUNTY

IL-146: MP 4.02 TO 6.35, EAST OF THE IL 146 IL 34 INTERSECTION		
	2015	2018
PV =	2,630	2,710
SU =	70	70
MU =	50	50
ADT =	2,750	2,830

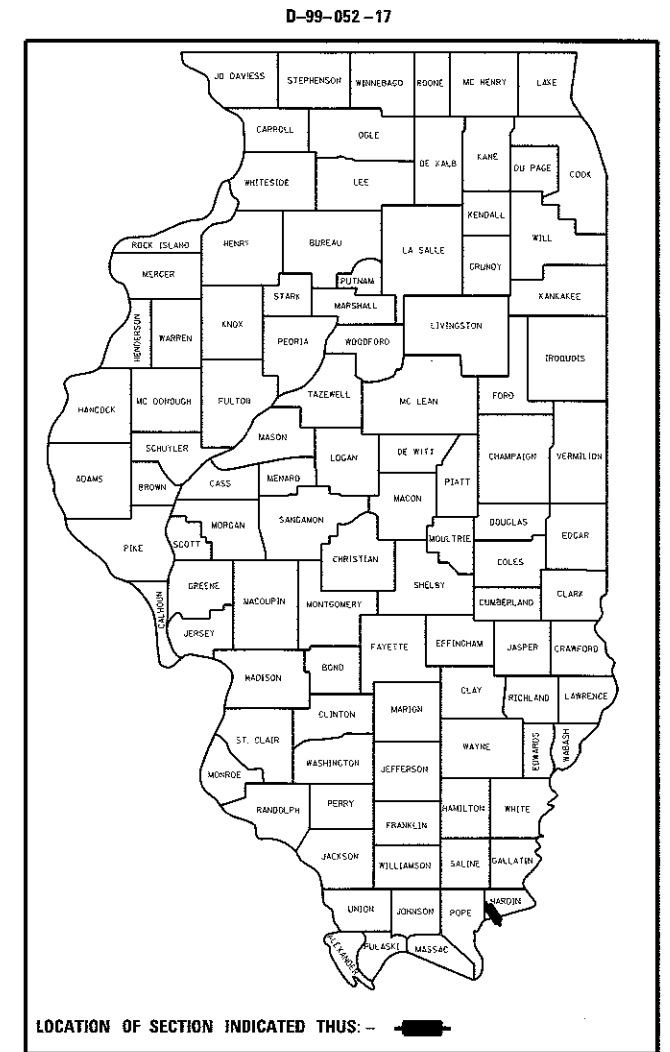

**TOWNSHIPS:**  
McFARLAN

DESIGN DESIGNATION: NA  
COORDINATE SYSTEM: NA  
POSTED SPEED: 55 MPH

J.U.L.I.E.  
JOINT UTILITY LOCATION INFORMATION FOR EXCAVATION  
1-800-892-0123  
OR 811

PROJECT ENGINEER CHARLES STEIN ..... 618-351-5210  
PROJECT MANAGER DARRYL LEFTWICH .. 618-351-5291

CONTRACT NO. 78598

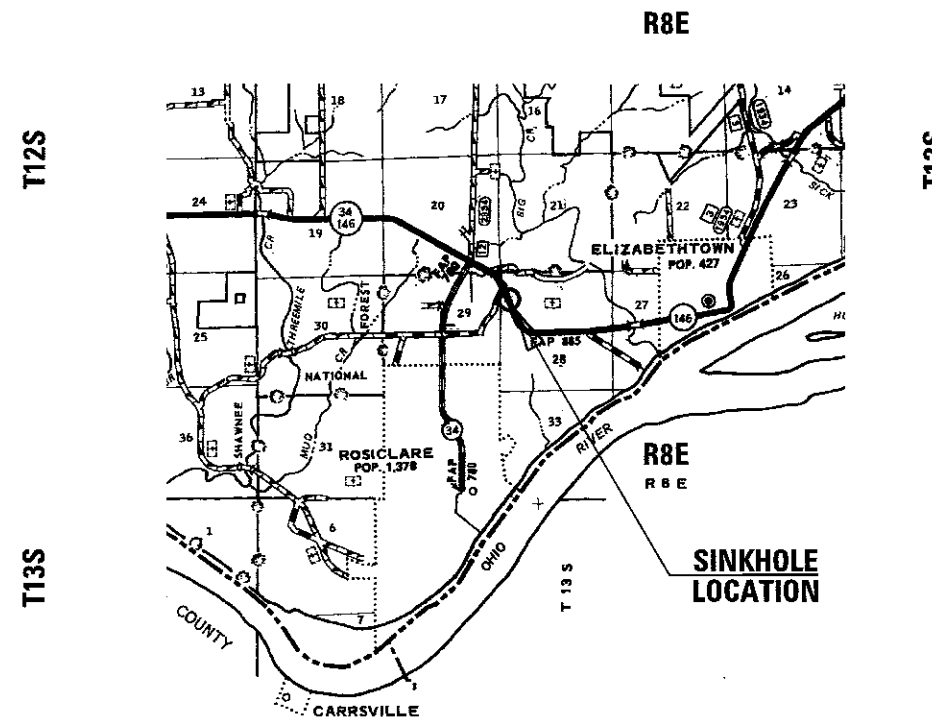

GROSS LENGTH = 110 FT = 0.021 MILE  
NET LENGTH = 110 FT = 0.021 MILE

STATE OF ILLINOIS  
DEPARTMENT OF TRANSPORTATION

SUBMITTED August 30 2017  
Jeffery A. Keem  
REGION FIVE ENGINEER

Oct 13 2017  
Hansen M. Addis  
ENGINEER OF DESIGN AND ENVIRONMENT

Oct 13 2017  
Director of Program Development

PRINTED BY THE AUTHORITY  
OF THE STATE OF ILLINOIS



SHEET NO	DESCRIPTION
1	COVER SHEET
2	SIGNATURE SHEET
3	INDEX OF SHEETS, HIGHWAY STANDARDS
4	GENERAL NOTES, COMMITMENTS & MIX DESIGNS
5	SUMMARY OF QUANTITIES
6	TYPICAL SECTION: IL 146
7	SCHEDULES: SINK HOLE REPAIR PAVEMENT MARKING
8	RESURFACING DETAIL: PLAN VIEW
9	RESURFACING DETAIL: PROFILE VIEW
10-11	OLD PLAN SHEETS: FOR INFORMATION ONLY
12	DETAILS: TEMP HMA TRANSITIONS DETAILS: ROUGH GROOVED SURFACE DETAILS: UNEVEN LANE SIGNS

# HIGHWAY STANDARDS

- 000001-06 STANDARD SYMBOLS ABBREVIATIONS & PATTERNS
- 001006 DECIMAL OF INCH & FOOT
- 701001-02 OFF RD OP - 2L2W - 15 FT MIN FROM EOP
- 701006-05 OFF RD OP - 2L2W - 15 FT TO EOP
- 701301-04 LN CLOSURE 2L2W - SHORT TIME OP
- 701306-03 LN CLOSURE 2L2W - SLOW MOVE OP DAY ONLY 45 MPH OR MORE
- 701311-03 LN CLOSURE 2L2W - MOVING OP DAY ONLY
- 701901-06 TRAF CNTRL DEVICES
- 780001-05 TYPICAL PVMT MRKINGS

MODEL: Default  
 FILE: \\nas101.pva.illinois.gov:PWIDOT\Documents\DOT\_Offices\District 9\Projects\78598\CADDData\Design\0978598-Design.dgn

USER NAME = Leftwichd	DESIGNED -	REVISED -	<b>STATE OF ILLINOIS DEPARTMENT OF TRANSPORTATION</b>	<b>INDEX OF SHEETS HIGHWAY STANDARDS</b>		F.A.P. RTE.	SECTION	COUNTY	TOTAL SHEETS	SHEET NO.
DRAWN -	REVISED -	885				D9 PATCH 2018-2	HARDIN	12	3	
PLOT SCALE = 100,0000' / in.	CHECKED -	REVISED -		SCALE: SHEET OF SHEETS STA. TO STA.		CONTRACT NO. 78598				
PLOT DATE = 9/5/2017	DATE -	REVISED -		ILLINOIS FED. AID PROJECT						

# HMA MIXTURE REQUIREMENTS TABLES

## GENERAL NOTES

FACTORS USED FOR ESTIMATING PLAN QUANTITIES ARE AS FOLLOWS AND SHALL NOT BE USED FOR THE BASIS OF FINAL QUANTITIES:

ALL HOT MIX ASPHALT 2.016 TONS/CU. YD.  
ALL AGGREGATE 2.05 TONS/CU. YD.

THE ALGEBRAIC DIFFERENCE BETWEEN THE PAVEMENT AND SHOULDER SLOPES SHALL NOT EXCEED 8%. THE SHOULDER ON THE OUTSIDE OF SUPERELEVATED CURVES SHALL BE FLATTENED ACCORDINGLY.

THE THICKNESS OF HOT MIX ASPHALT MIXTURE SHOWN ON THE PLANS IS THE NOMINAL THICKNESS. DEVIATIONS FROM THE NOMINAL THICKNESS WILL BE PERMITTED WHEN SUCH DEVIATIONS OCCUR DUE TO IRREGULARITIES IN THE EXISTING SURFACE OR BASE ON WHICH THE HOT MIX ASPHALT MIXTURE IS PLACED.

THE QUANTITY OF SHORT TERM PAVEMENT MARKING SHOWN IN THE PLANS IS BASED ON ONE APPLICATION EACH FOR THE HMA SURFACE REMOVAL, BINDER COURSE AND SURFACE COURSE.

ATTAINMENT OF PROPER CROWN OR SUPERELEVATION SHALL BE FULLY ACCOMPLISHED WITH THE HOT MIX ASPHALT SURFACE REMOVAL OR HOT MIX ASPHALT BINDER COURSE OR LEVELING BINDER, WHEN SPECIFIED.

AFTER A LIFT OF HOT MIX ASPHALT HAS BEEN PLACED, THE LANE SHALL REMAIN CLOSED TO TRAFFIC UNTIL THE NEW MAT HAS COOLED TO 150 DEGREES FAHRENHEIT

THERE ARE NO AVAILABLE WASTE SITES ON THE EXISTING RIGHT OF WAY WITHIN THE PROJECT LIMITS. DISPOSAL WILL BE THE RESPONSIBILITY OF THE CONTRACTOR AND WASTE MUST BE DISPOSED OF IN ACCORDANCE WITH ARTICLE 202.03 OF THE STANDARD SPECIFICATIONS.

## COMMITMENTS

NONE

The following HMA mixture requirements are applicable for this project

Location(s):	Hot-Mix Asphalt Surface Course and Incidental Hot-Mix Asphalt Surfacing
Mixture Use(s):	Hot-Mix Asphalt Surface Course, Mix C, N70
PG:	PG64-22
Design Air Voids:	4.0 %, 70 Gyration Design
Mixture Composition: (Mixture Gradation)	IL-9.5mm
Friction Aggregate:	C Surface
Mixture Weight:	112 lbs/Sq Yd/in
Quality Management Program:	QCQA
Sublot Size:	TBD
Number of Roller Passes	NA

Location(s):	Hot-Mix Asphalt Binder
Mixture Use(s):	Hot-Mix Asphalt Binder Course, N70, IL-19.0
PG:	PG64-22
Design Air Voids:	4.0 %, 70 Gyration Design
Mixture Composition: (Mixture Gradation)	IL-19.0mm
Friction Aggregate:	None
Mixture Weight:	112 lbs/Sq Yd/in
Quality Management Program:	QCQA
Sublot Size:	NA
Number of Roller Passes	NA

Location(s):	Hot-Mix Asphalt Shoulders
Mixture Use(s):	Hot-Mix Asphalt Binder Course, N30, IL-19.0L
PG:	PG64-22
Design Air Voids:	4.0 %, 30 Gyration Design
Mixture Composition: (Mixture Gradation)	IL-19.0L
Friction Aggregate:	None
Mixture Weight:	112 lbs/Sq Yd/in
Quality Management Program:	QCQA
Sublot Size:	NA
Number of Roller Passes	NA

STATE OF ILLINOIS  
DEPARTMENT OF TRANSPORTATION

GENERAL NOTES  
MIX DESIGNS

F.A.P. RTE.	SECTION	COUNTY	TOTAL SHEETS	SHEET NO.
885	D9 PATCH 2018-2	HARDIN	12	4
CONTRACT NO. 78598				
ILLINOIS FED. AID PROJECT				

SCALE: SHEET OF SHEETS STA. TO STA.

USER NAME = Leftwichd	DESIGNED -	REVISED -
	DRAWN -	REVISED -
PLOT SCALE = 100.0000' / in.	CHECKED -	REVISED -
PLOT DATE = 9/5/2017	DATE -	REVISED -

# SUMMARY OF QUANTITIES

COUNTY:	HARDIN CO
ROUTE:	IL 146
FUNDING:	100% STATE ✓
LOCATION:	RURAL ✓
	ROADWAY
	0005 ✓

CODE NUMBER	ITEM DESCRIPTION	UNIT	QUANTITY
40600290	BITUMINOUS MATERIALS (TACK COAT)	POUND	223
40600990	TEMPORARY RAMP	SQ YD	36
40603085	HOT-MIX ASPHALT BINDER COURSE, IL-19.0, N70	TON	47
40603315	HOT-MIX ASPHALT SURFACE COURSE, MIX "C", N70	TON	27
44000155	HOT-MIX ASPHALT SURFACE REMOVAL, 1 1/2"	SQ YD	104
48100100	AGGREGATE SHOULDERS, TYPE A	TON	5
48203100	HOT-MIX ASPHALT SHOULDERS	TON	19
67100100	MOBILIZATION	LSUM	1
70100460	TRAFFIC CONTROL AND PROTECTION, STANDARD 701306	LSUM	1
70300100	SHORT TERM PAVEMENT MARKING	FOOT	33
70300150	SHORT TERM PAVEMENT MARKING REMOVAL	SQ FT	11
70300220	TEMPORARY PAVEMENT MARKING - LINE 4"	FOOT	440
* 78001110	PAINT PAVEMENT MARKING - LINE 4"	FOOT	440
78300200	RAISED REFLECTIVE PAVEMENT MARKER REMOVAL	EACH	1

\* SPECIALTY ITEM

MODEL: Default  
FILE NAME: D:\11004\EDID\TCC\Illinois.gov\FWD\DOT\Documents\DOT - Office\District 9\Project\17958\CAD\DATA\Design\0973598.Dwg

USER NAME = Leftkhol
PLOT SCALE = 100.0000' / in.
PLOT DATE = 9/5/2017

DESIGNED -	REVISED -
DRAWN -	REVISED -
CHECKED -	REVISED -
DATE -	REVISED -

**STATE OF ILLINOIS  
DEPARTMENT OF TRANSPORTATION**

**SUMMARY OF QUANTITIES**

SCALE: SHEET OF SHEETS STA. TO STA.

F.A.P. RTE.	SECTION	COUNTY	TOTAL SHEETS	SHEET NO.
885	D9 PATCH 2018-2	HARDIN	12	5
CONTRACT NO. 78598				
ILLINOIS FED. AID PROJECT				

# TYPICAL SECTION



IL 146

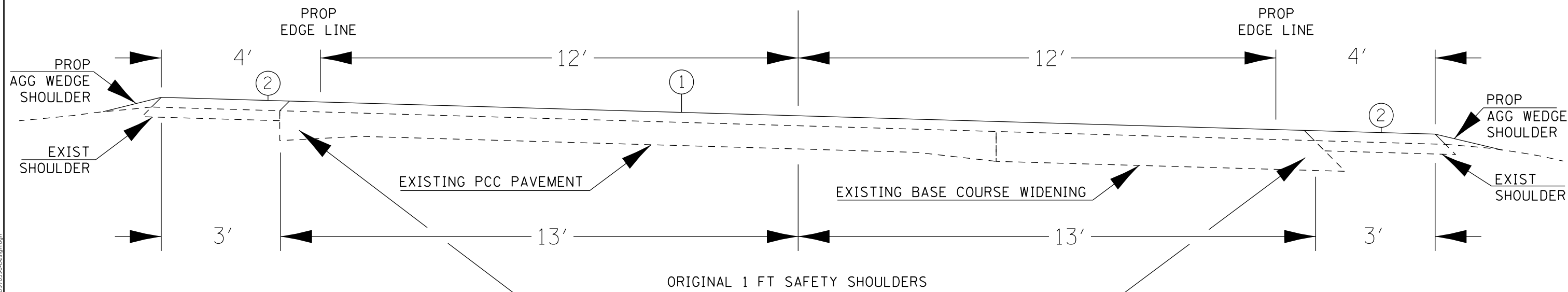

STA 197+30 TO STA 198+40

- ① PROP HMA BINDER (THICKNESS VARIES) AND SURFACE COARSE 1 1/2"
- ② PROP HMA SHOULDER - THICKNESS VARIES

SEE PLAN SHEET: RESURFACING DETAIL - PLAN VIEW  
FOR LOCATIONS OF HMA SURFACE REMOVAL 1 1/2"

MODEL: Default  
FILE: \\nas0101\B&E\BID\ITC\Illinois\pwr\pwr\DOT\Documents\BIDD\Office\BIDD\Tct 9\Projects\178598\CADD\Drawings\978598-06.dgn

USER NAME = Leftwichdl	DESIGNED -	REVISED -
	DRAWN -	REVISED -
PLOT SCALE = 100.0000' / in.	CHECKED -	REVISED -
PLOT DATE = 9/5/2017	DATE -	REVISED -

STATE OF ILLINOIS  
DEPARTMENT OF TRANSPORTATION

TYPICAL SECTION

SCALE: SHEET OF SHEETS STA. TO STA.

F.A.P. RTE.	SECTION	COUNTY	TOTAL SHEETS	SHEET NO.
885	D9 PATCH 2018-2	HARDIN	12	6
ILLINOIS FED. AID PROJECT			CONTRACT NO. 78598	

## SCHEDULE FOR SINK HOLE RESURFACING

R146 SINK HOLE		SECTION LENGTH (INFO ONLY)	HMA SURF REMOVAL	HMA BIND CSE N70	HMA SURF CSE MIX "C" N70	HMA SHOULDERS		AGGREGATE SHOULDER WEDGE	BIT MATLS TACK CT	TEMPORARY RAMP
						BINDER NOM 4.5"	SURFACE 1.5"			
	COMMENT	FEET	SQ YD	TON	TON	TON	TON	TON	POUND	SQ YD
<u>R 146 NEAR ROSICLARE</u>										
						( SHOULDERS )	( SHOULDERS )			
	197+30.00 BK	Improvement Begins								
STA 197+30.00	TO STA 198+40.00	110.00	104	47	27	12	7	5	223	36
	STA 198+40.00	Improvement Ends								
			104	47	27	12	7	5	223	36
						19				**

\* INCLUDES SOME SHOULDER QUANTITY

\*\* INCLUDES SHOULDERS

## SCHEDULE FOR 146 PAVEMENT MARKING

R146		SECTION LENGTH (INFO ONLY)	PAVEMENT MARKING LINE 4"		TEMPORARY PVMT MRK LINE 4"	SHORT TERM PVMT MRK	SHORT TERM PVMT MRK REMOVAL	RAISED REFLECTIVE PVMT MKR
			WHITE	YELLOW				
	COMMENT	FEET	FOOT	FOOT	FOOT	FOOT	SQ FT	EACH
<u>R 146 NEAR ROSICLARE</u>								
	197+30.00 BK	Improvement Begins						
STA 197+30.00	TO STA 198+40.00	110.00	220	220	440	33	11	1
	STA 198+40.00	Improvement Ends						
			220	220	440	33	11	1
			440					

**STATE OF ILLINOIS  
DEPARTMENT OF TRANSPORTATION**

**RESURFACING SCHEDULE  
PAVEMENT MARKING SCHEDULE**

F.A.P. RTE.	SECTION	COUNTY	TOTAL SHEETS	SHEET NO.
885	D9 PATCH 2018-2	HARDIN	12	7
CONTRACT NO. 78598				
ILLINOIS FED. AID PROJECT				

SCALE: SHEET OF SHEETS STA. TO STA.

MODEL: Default  
 FILE: \\nas0101\proj\1108\B&E\BIDD\ITEC\Illinois\gov\p\WIDOT\Documents\DOT\_Offices\Bldg\DOT\_78598\CaddData\Design\0978598-Design.dgn





# RESURFACING DETAIL - PROFILE VIEW FOR INFORMATION ONLY

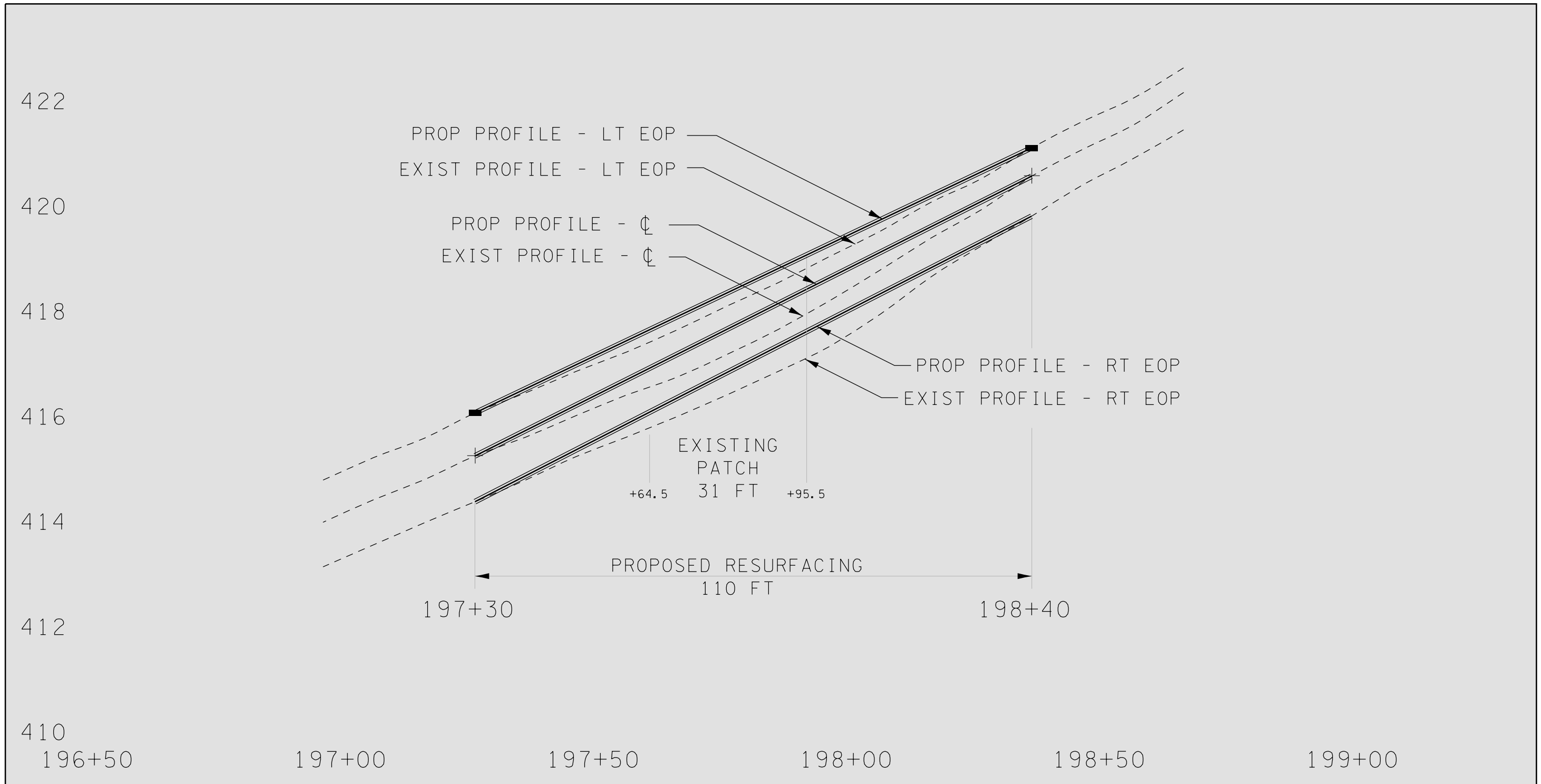

MODEL: Default  
 FILE: h:\mhc\p\110848EED\DOT\Illinois\p\110848EED\DOT\Documents\DOT Office\110848EED\DOT\110848EED\DOT\110848EED.dgn

USER NAME = Leftwichd	DESIGNED -	REVISED -
	DRAWN -	REVISED -
PLOT SCALE = 100.0000' / in.	CHECKED -	REVISED -
PLOT DATE = 9/5/2017	DATE -	REVISED -

**STATE OF ILLINOIS  
DEPARTMENT OF TRANSPORTATION**

**RESURFACING DETAIL  
PROFILE VIEW**

SCALE:      SHEET      OF      SHEETS      STA.      TO      STA.

F.A.P. RTE.	SECTION	COUNTY	TOTAL SHEETS	SHEET NO.
885	D9 PATCH 2018-2	HARDIN	12	9
ILLINOIS FED. AID PROJECT			CONTRACT NO. 78598	

# OLD PLAN SHEET (CN 98003) - FOR INFORMATION ONLY

ROUTE	SECTION	COUNTY	TOTAL SHEETS	SHEET NO.
FA885	#	HARDIN	112	13
STA. 180+00				195+00

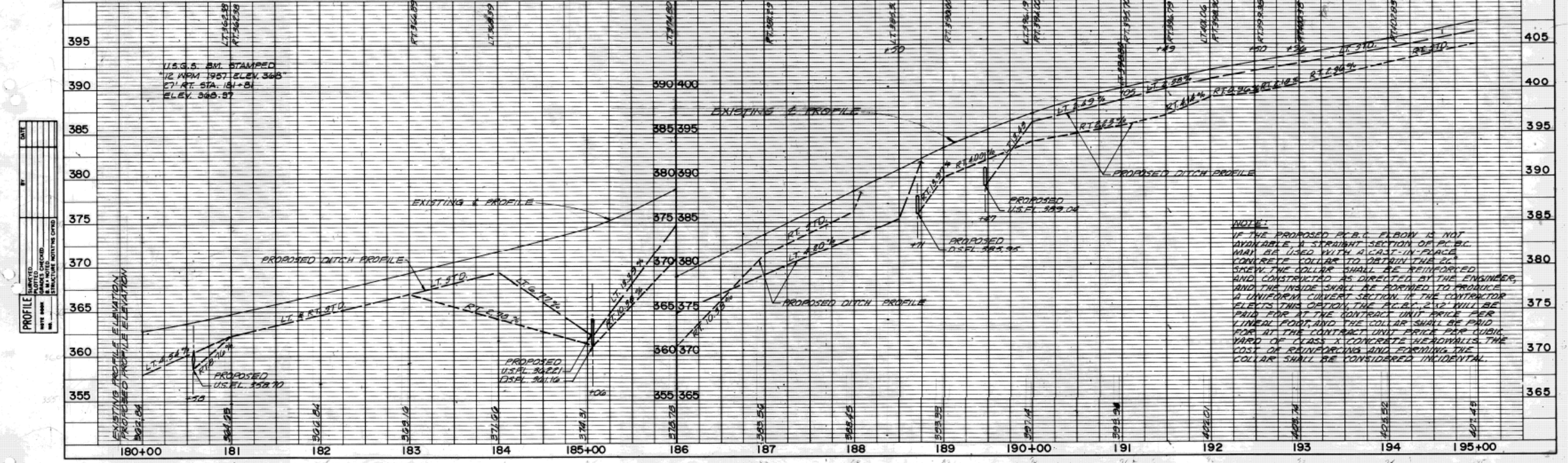
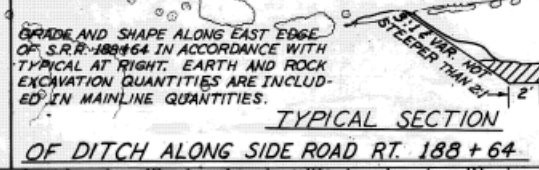
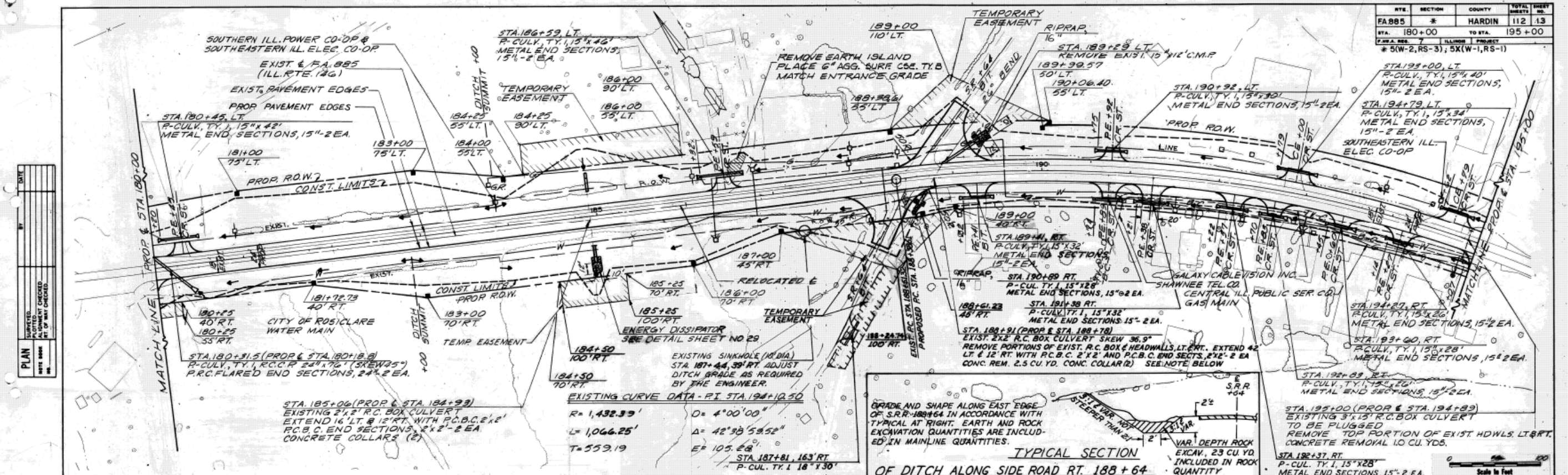

DATE	BY	REVISION

DATE	BY	REVISION

SCALE: 1" = 120' (60 SCALE x 2)

USER NAME = Leftwichd DESIGNED - DRAWN - PLOT SCALE = 120,0000' / in. CHECKED - DATE = 9/5/2017	REVISED - REVISED - REVISED - REVISED -	STATE OF ILLINOIS DEPARTMENT OF TRANSPORTATION	OLD PLANS FOR REFERENCE ONLY S146_HAR_1987_12_98003
F.A.P. RTE. 885 SECTION D9 PATCH 2018-2 COUNTY HARDIN TOTAL SHEETS 12 SHEET NO. 10		SCALE: SHEET OF SHEETS STA. TO STA. ILLINOIS FED. AID PROJECT CONTRACT NO. 78598	

MODEL: Default  
 FILE: \\nas01\pub\BARDNET\ITC\Illinois\gov\p\WDOT\Documents\1801\Office\1801\18598\CaddData\Design\0929598-Design.dgn

# OLD PLAN SHEET (CN 98003) - FOR INFORMATION ONLY

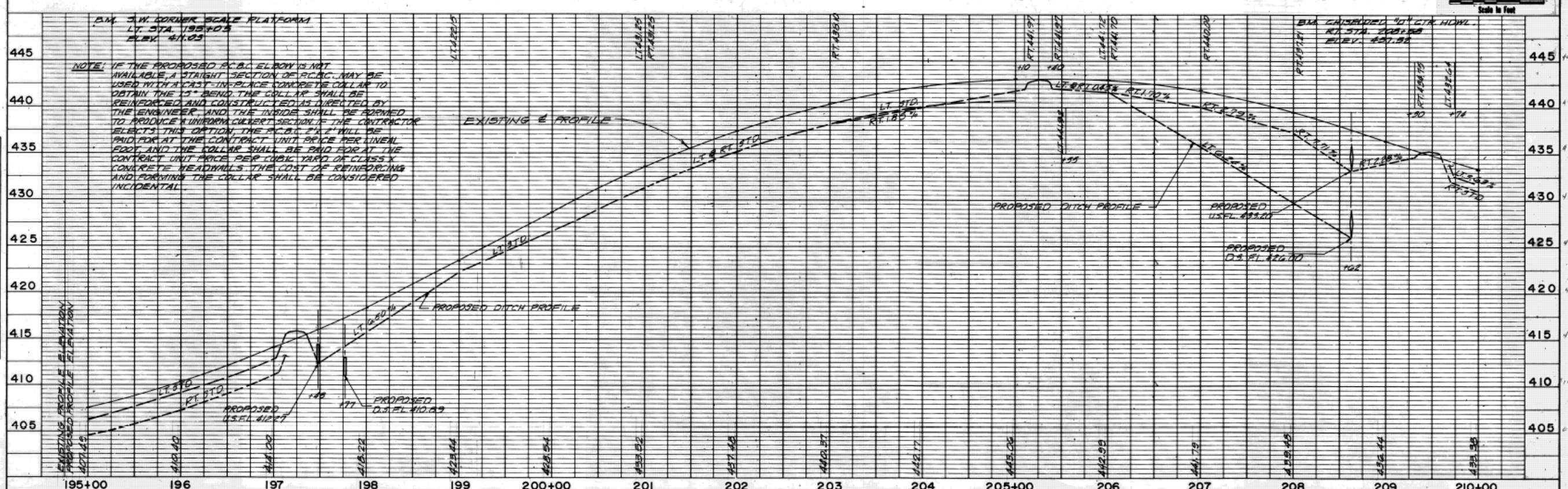
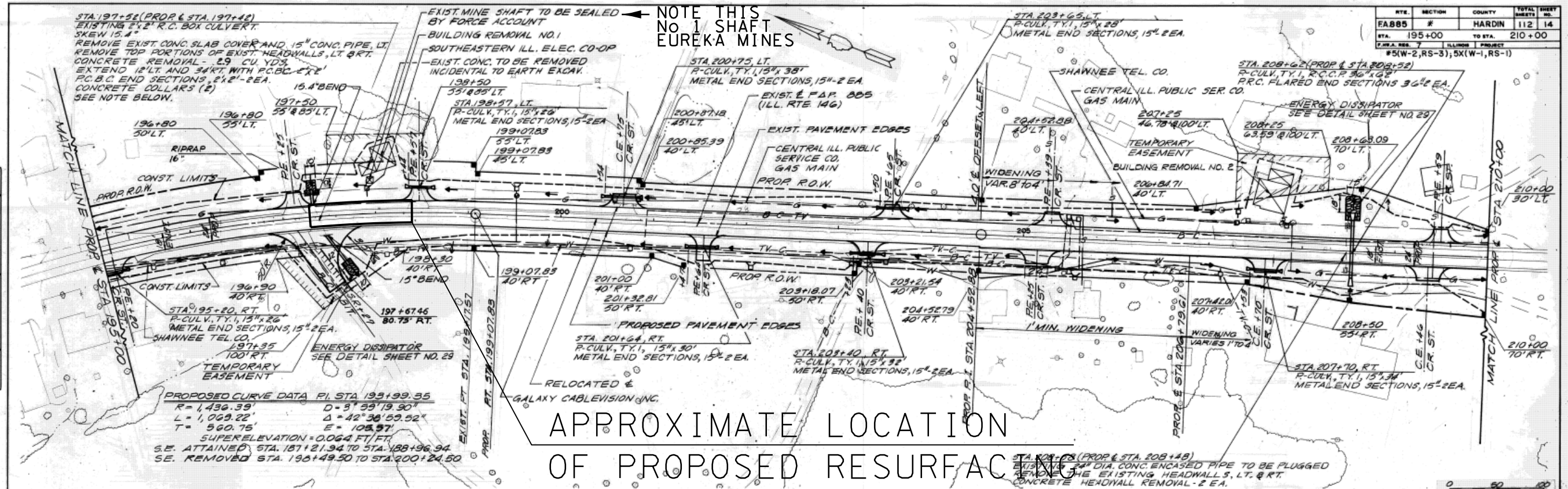

DATE	
BY	
REVISED	
REASON FOR CHANGE	
DATE	
BY	
REVISED	
REASON FOR CHANGE	
DATE	
BY	
REVISED	
REASON FOR CHANGE	
DATE	
BY	
REVISED	
REASON FOR CHANGE	

DATE	
BY	
REVISED	
REASON FOR CHANGE	
DATE	
BY	
REVISED	
REASON FOR CHANGE	
DATE	
BY	
REVISED	
REASON FOR CHANGE	
DATE	
BY	
REVISED	
REASON FOR CHANGE	

RTE.	SECTION	COUNTY	TOTAL SHEETS
FA885	#	HARDIN	112   14
STA.	195+00	TO STA.	210+00
PROJECT #5(W-2,RS-3),5X(W-1,RS-1)			

(ILL. RTE. 146) 8466-01 14  
Rev 1-22-88  
115-210

USER NAME = Leftwichd	DESIGNED -	REVISED -
	DRAWN -	REVISED -
PLOT SCALE = 120,0000' / in.	CHECKED -	REVISED -
PLOT DATE = 9/5/2017	DATE -	REVISED -

**STATE OF ILLINOIS  
DEPARTMENT OF TRANSPORTATION**

OLD PLANS FOR REFERENCE ONLY S146_HAR_1987_12_98003			
SCALE:	SHEET	OF SHEETS	STA. TO STA.

F.A.P. RTE.	SECTION	COUNTY	TOTAL SHEETS	SHEET NO.
885	D9 PATCH 2018-2	HARDIN	12	11
CONTRACT NO. 78598				
ILLINOIS FED. AID PROJECT				

MODEL: Default  
FILE: \\s:\p\1108\BIBID\ITC\Illinoi.gov\PIV\DOT\Documents\1001\Office\Director\9\Projects\18598\CaddData\Design\092598\_Design.dgn

# TEMPORARY HOT-MIX ASPHALT TRANSITIONS

# UNEVEN LANES SIGN

W8-11 (48" x 48")

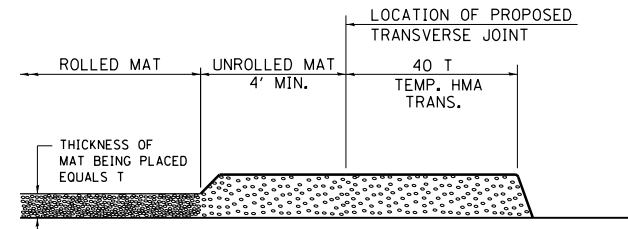

## STEP I

1. PLACE HOT-MIX ASPHALT MAT, LENGTH 40 TIMES THE THICKNESS OF THE MAT BEING PLACED PAST THE PROPOSED TRANSVERSE JOINT LOCATION USING NORMAL OPERATING PROCEDURES.
2. EXTREME CARE SHOULD BE TAKEN TO MAINTAIN ENOUGH MATERIAL IN FRONT OF THE SCREED TO MAINTAIN REQUIRED PAVING DEPTH.

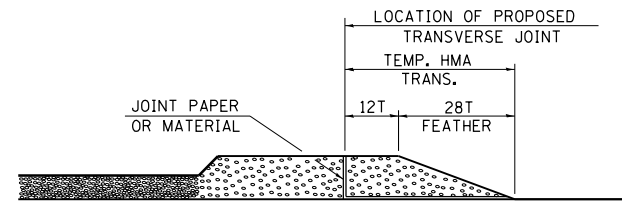

## STEP III

1. JOINT PAPER OR OTHER PRESELECTED JOINT MATERIAL IS THEN PLACED IN THE CLEARED AREA AND THE EXCESS ASPHALT USED TO HAND FORM A TRANSITION TO THE DIMENSIONS SHOWN ABOVE.
2. NOTE THAT IN CONSTRUCTING THE TRANSITION, THE MAT DEPTH IS CONTINUED AS PART OF THE TRANSITION BEFORE FORMING THE FEATHER.

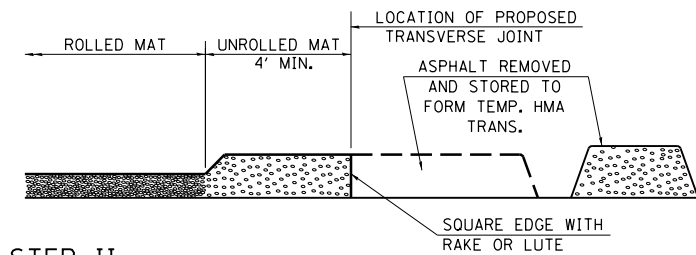

## STEP II

1. MOVE THE PAVER OUT OF THE WAY AND REMOVE THE ASPHALT FROM THE AREA OF THE PROPOSED TEMPORARY HOT-MIX ASPHALT TRANSITION.
2. SQUARE UP THE END OF THE MAT WITH A RAKE OR LUTE.
3. NOTE THAT THE MAT WITHIN 4' OF THE END OF JOINT IS NOT TO BE ROLLED AT THIS TIME.

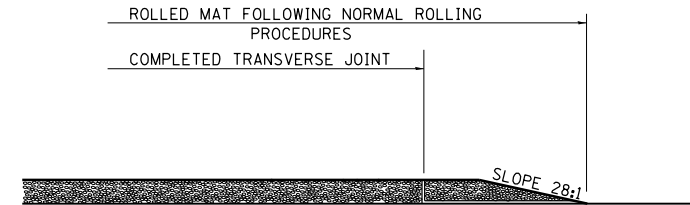

## STEP IV

1. COMPLETE TEMPORARY TRANSITION BY ROLLING.
2. TO RESUME PAVING, AT THE JOINT, REMOVE TEMPORARY TRANSITION AND DISPOSE OF THE MATERIAL ACCORDING TO ART. 202.03 OF THE STD. SPECS. (COST INCLUDED IN THE CONTRACT).
3. CONSTRUCTING THE TEMPORARY TRANSITIONS WILL NOT BE PAID FOR SEPARATELY IN ACCORDANCE WITH ARTICLE 406.14 OF THE STANDARD SPECIFICATIONS.

STD. 9-26

REVISIONS	
REDRAWN	2-15-89
REVISED	8-16-94
REVISED	01-09-07
RESIZED	05-8-08
REVISED	05-16-13

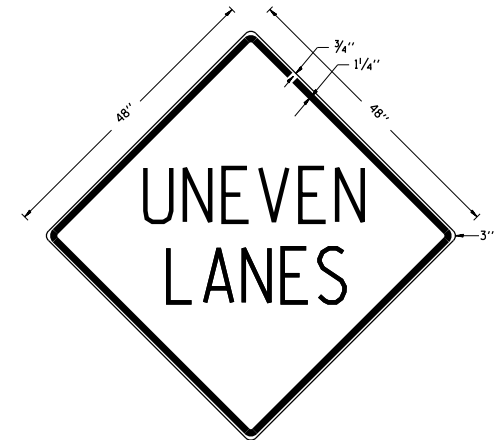

## COLORS:

LEGEND AND BORDER - BLACK NON-REFLECTORIZED  
BACKGROUND - ORANGE REFLECTORIZED

**NOTE:** PRIOR TO ALLOWING TRAFFIC ON ANY PORTION OF THE ROADWAY THAT HAS BEEN COLDMILLED OR BEFORE RESURFACING OPERATIONS BEGIN, THE CONTRACTOR SHALL HAVE ERECTED "UNEVEN PAVEMENT" SIGNS THAT CONFORM TO THE ABOVE DETAILS. A MINIMUM OF ONE SIGN AT EACH END OF THE IMPROVEMENT WILL BE REQUIRED. THE CONTRACTOR SHALL MAINTAIN THE "UNEVEN PAVEMENT" SIGNS UNTIL THE RESURFACING OPERATIONS ARE COMPLETED.

IF AT ANY TIME THE SIGNS ARE IN PLACE BUT NOT APPLICABLE, THEY SHALL BE TURNED FROM THE VIEW OF MOTORISTS OR COVERED AS DIRECTED BY THE ENGINEER.

THE COST OF FURNISHING, ERECTING, MAINTAINING, AND REMOVING THE REQUIRED SIGNS SHALL BE INCLUDED IN THE CONTRACT.

STD. 9-41

REVISIONS	
DRAWN	2-15-89
REVISED	4-06-93
REDESIGNED	7-23-04
REVISED	5-08-08
REVIEWED	5-17-13

# ILLINOIS STANDARD

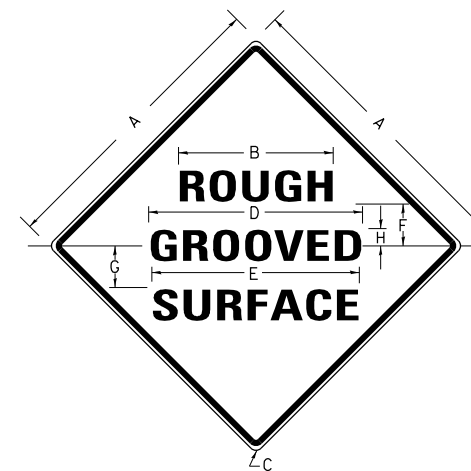

## COLORS:

LEGEND AND BORDER- BLACK NON-REFLECTORIZED  
BACKGROUND- ORANGE REFLECTORIZED

SIGN SIZE	DIMENSIONS							
	A	B	C	D	E	F	G	H
48x48	48.0	24.1	3.0	34.0	33.0	6.0	13.0	3.5

SIGN SIZE	SERIES LINES			MAR-GIN	BOR-DER	BLANK STD.
	1	2	3			
48x48	7C	7C	7C	0.8	1.2	B4-48D

ALL DIMENSIONS IN INCHES

## NOTES:

PRIOR TO ALLOWING TRAFFIC ON ANY PORTION OF THE ROADWAY THAT HAS BEEN COLDMILLED, THE CONTRACTOR SHALL HAVE ERECTED "ROUGH GROOVED SURFACE" SIGNS THAT CONFORM TO THE ABOVE DETAILS. A MINIMUM OF ONE SIGN AT EACH END OF THE IMPROVEMENT WILL BE REQUIRED. THE CONTRACTOR SHALL MAINTAIN THE "ROUGH GROOVED SURFACE" SIGNS UNTIL THE COLDMILLED SURFACE IS COVERED WITH LEVELING BINDER OR SURFACE COURSE.

IF AT ANY TIME THE SIGNS ARE IN PLACE BUT NOT APPLICABLE, THEY SHALL BE TURNED FROM THE VIEW OF MOTORISTS OR COVERED AS DIRECTED BY THE ENGINEER.

THE COST OF FURNISHING, ERECTING, MAINTAINING, AND REMOVING THE REQUIRED SIGNS SHALL BE INCLUDED IN THE CONTRACT.

STD. 9-39

REVISIONS	
REDRAWN	2-15-89
REVISED	4-6-93
REVISED	3-27-08
REVIEWED	5-17-13

STATE OF ILLINOIS  
DEPARTMENT OF TRANSPORTATION

DISTRICT STANDARDS

SCALE: SHEET OF SHEETS STA. TO STA.

F.A.P. RTE.	SECTION	COUNTY	TOTAL SHEETS	SHEET NO.
885	D9 PATCH 2018-2	HARDIN	12	12
CONTRACT NO. 78598				
ILLINOIS FED. AID PROJECT				

USER NAME	DESIGNED	REVISIONS
= Leftwichdt	-	-
	DRAWN	REVISED
	-	-
PLOT SCALE = 100.0000' / in.	CHECKED	REVISED
	-	-
PLOT DATE = 9/5/2017	DATE	REVISED
	-	-