

|               |  |
|---------------|--|
| DATE          |  |
| BY            |  |
| SURVEYED      |  |
| PLOTTED       |  |
| TEMPLATE      |  |
| AREAS CHECKED |  |
| FINL SURVEY   |  |
| NOTE BOOK     |  |
| NO.           |  |

|                 |  |
|-----------------|--|
| DATE            |  |
| BY              |  |
| SURVEYED        |  |
| PLOTTED         |  |
| TEMPLATE        |  |
| AREAS CHECKED   |  |
| ORIGINAL SURVEY |  |
| NOTE BOOK       |  |
| NO.             |  |

FILE NAME = G:\CH13\009\Road\Sheets - B2 Contract\2013\B24-SHT-XS-ILE1E13.dgn

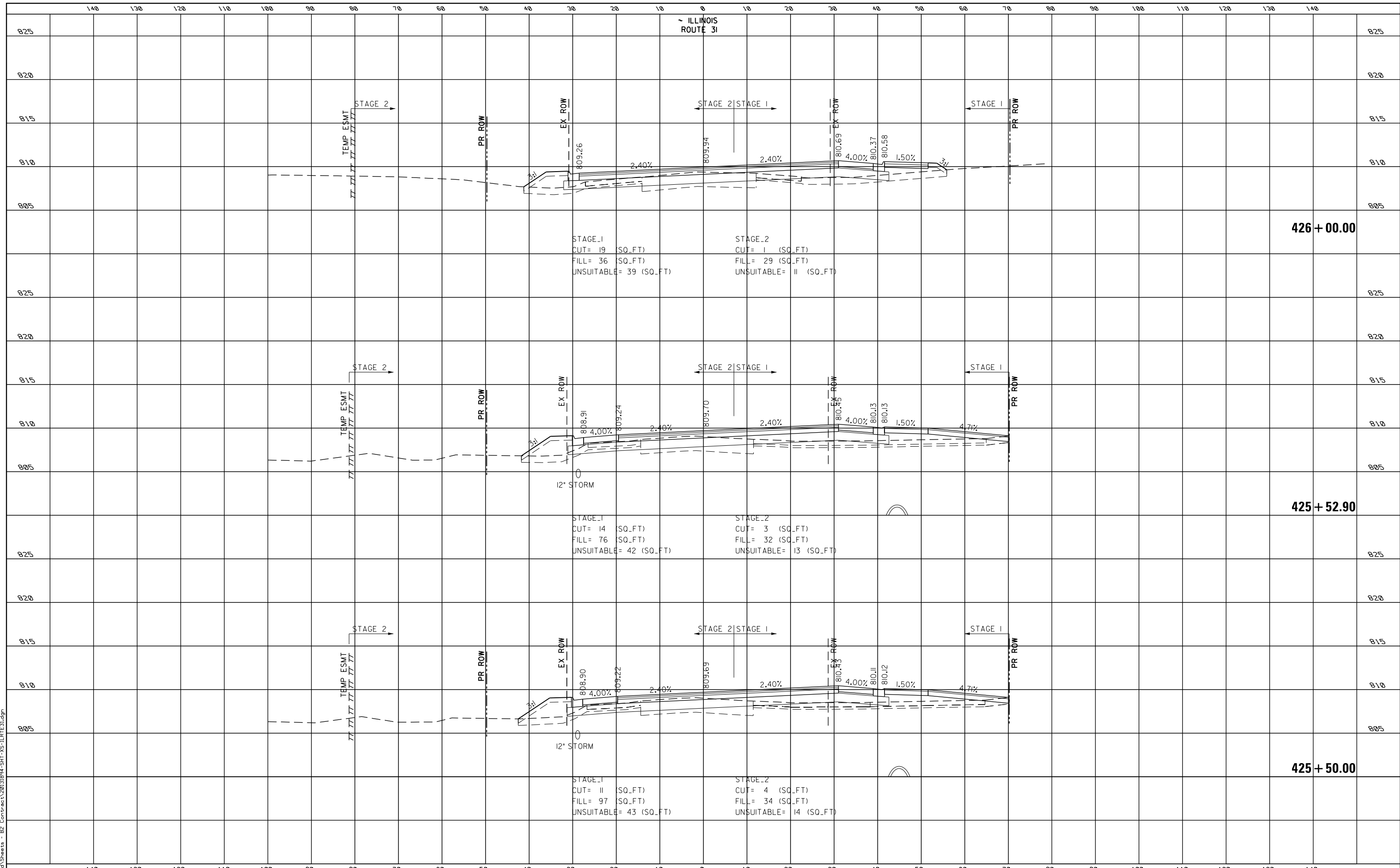

STAGE\_1  
CUT= 19 (SQ\_FT)  
FILL= 36 (SQ\_FT)  
UNSUITABLE= 39 (SQ\_FT)

STAGE\_2  
CUT= 1 (SQ\_FT)  
FILL= 29 (SQ\_FT)  
UNSUITABLE= 11 (SQ\_FT)

STAGE\_1  
CUT= 14 (SQ\_FT)  
FILL= 76 (SQ\_FT)  
UNSUITABLE= 42 (SQ\_FT)

STAGE\_2  
CUT= 3 (SQ\_FT)  
FILL= 32 (SQ\_FT)  
UNSUITABLE= 13 (SQ\_FT)

STAGE\_1  
CUT= 11 (SQ\_FT)  
FILL= 97 (SQ\_FT)  
UNSUITABLE= 43 (SQ\_FT)

STAGE\_2  
CUT= 4 (SQ\_FT)  
FILL= 34 (SQ\_FT)  
UNSUITABLE= 14 (SQ\_FT)



|                            |                 |           |
|----------------------------|-----------------|-----------|
| USER NAME = mbmwhorter     | DESIGNED = BSH  | REVISED = |
|                            | DRAWN = MLB     | REVISED = |
| PLOT SCALE = 20.000' / in. | CHECKED = MFD   | REVISED = |
| PLOT DATE = 9/25/2017      | DATE = 8/7/2017 | REVISED = |

**STATE OF ILLINOIS  
DEPARTMENT OF TRANSPORTATION**

**IL RTE 31  
CROSS SECTIONS**

SCALE: 10H : 5V SHEET 601 OF 611 SHEETS STA. 425+50.00 TO STA. 426+00.00

|   |                |        |              |           |
|---|----------------|--------|--------------|-----------|
| F.A.P. RTE.                                     | SECTION        | COUNTY | TOTAL SHEETS | SHEET NO. |
| 2298  | 16-00215-II-PV | KANE   | 611          | 601       |
| CONTRACT NO. 61E05                              |                |        |              |           |
| FED. ROAD DIST. NO. 1 ILLINOIS FED. AID PROJECT |                |        |              |           |

|               |  |
|---------------|--|
| DATE          |  |
| BY            |  |
| SURVEYED      |  |
| PLOTTED       |  |
| TEMPLATE      |  |
| AREAS CHECKED |  |
| FINL SURVEY   |  |
| NOTE BOOK     |  |
| NO.           |  |

|                 |  |
|-----------------|--|
| DATE            |  |
| BY              |  |
| SURVEYED        |  |
| PLOTTED         |  |
| TEMPLATE        |  |
| AREAS CHECKED   |  |
| ORIGINAL SURVEY |  |
| NOTE BOOK       |  |
| NO.             |  |

FILE NAME = G:\CH13\099\Road\Sheets - B2 Contract\2013\B94-SHT-XS-ILE-1E13.dgn

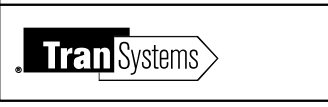
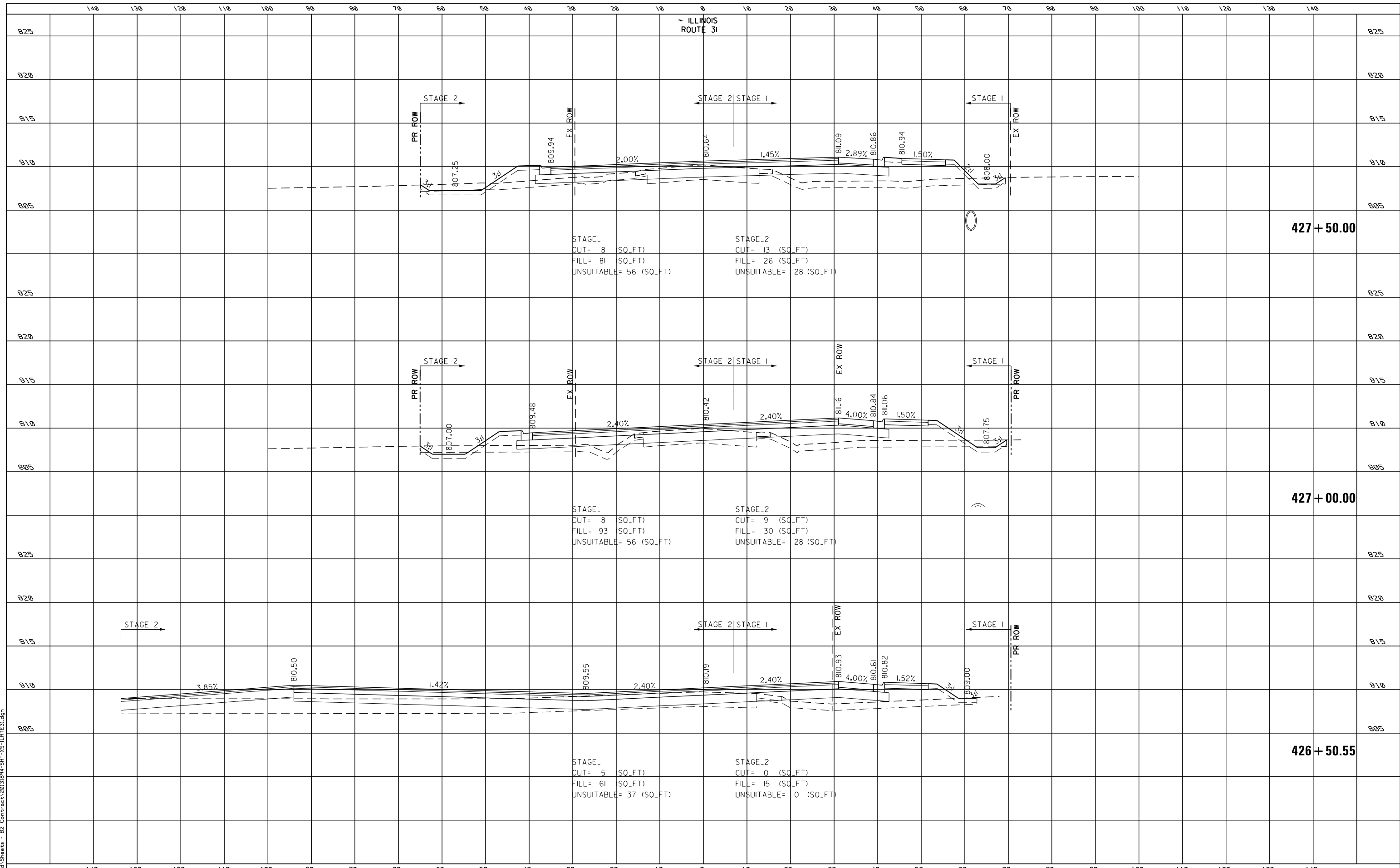

|                            |                 |           |
|----------------------------|-----------------|-----------|
| USER NAME = mbmwhorter     | DESIGNED = BSH  | REVISED = |
|                            | DRAWN = MLB     | REVISED = |
| PLOT SCALE = 20.000' / in. | CHECKED = MFD   | REVISED = |
| PLOT DATE = 9/25/2017      | DATE = 8/7/2017 | REVISED = |

**STATE OF ILLINOIS  
DEPARTMENT OF TRANSPORTATION**

**IL RTE 31  
CROSS SECTIONS**

SCALE: 10H : 5V    SHEET 602 OF 611    SHEETS    STA. 426+50.55 TO STA. 427+50.00

|   |                |        |              |           |
|---|----------------|--------|--------------|-----------|
| F.A.P. RTE.   | SECTION        | COUNTY | TOTAL SHEETS | SHEET NO. |
| 2298  | 16-00215-II-PV | KANE   | 611          | 602       |
| CONTRACT NO. 61E05                                    |                |        |              |           |
| FED. ROAD DIST. NO. 1    ILLINOIS    FED. AID PROJECT |                |        |              |           |

|             |               |
|-------------|---------------|
| DATE        |               |
| BY          |               |
| FINL SURVEY | SURVEYED      |
| NOTE BOOK   | PLOTTED       |
| NO.         | TEMPLATE      |
|             | AREAS CHECKED |
|             | AREAS CHECKED |

|                 |               |
|-----------------|---------------|
| DATE            |               |
| BY              |               |
| ORIGINAL SURVEY | SURVEYED      |
| NOTE BOOK       | PLOTTED       |
| NO.             | TEMPLATE      |
|                 | AREAS CHECKED |
|                 | AREAS CHECKED |

FILE NAME = G:\CH13\099\Road\Sheets - B2 Contract\2013\B24-SHT-XS-ILE-E3.dgn

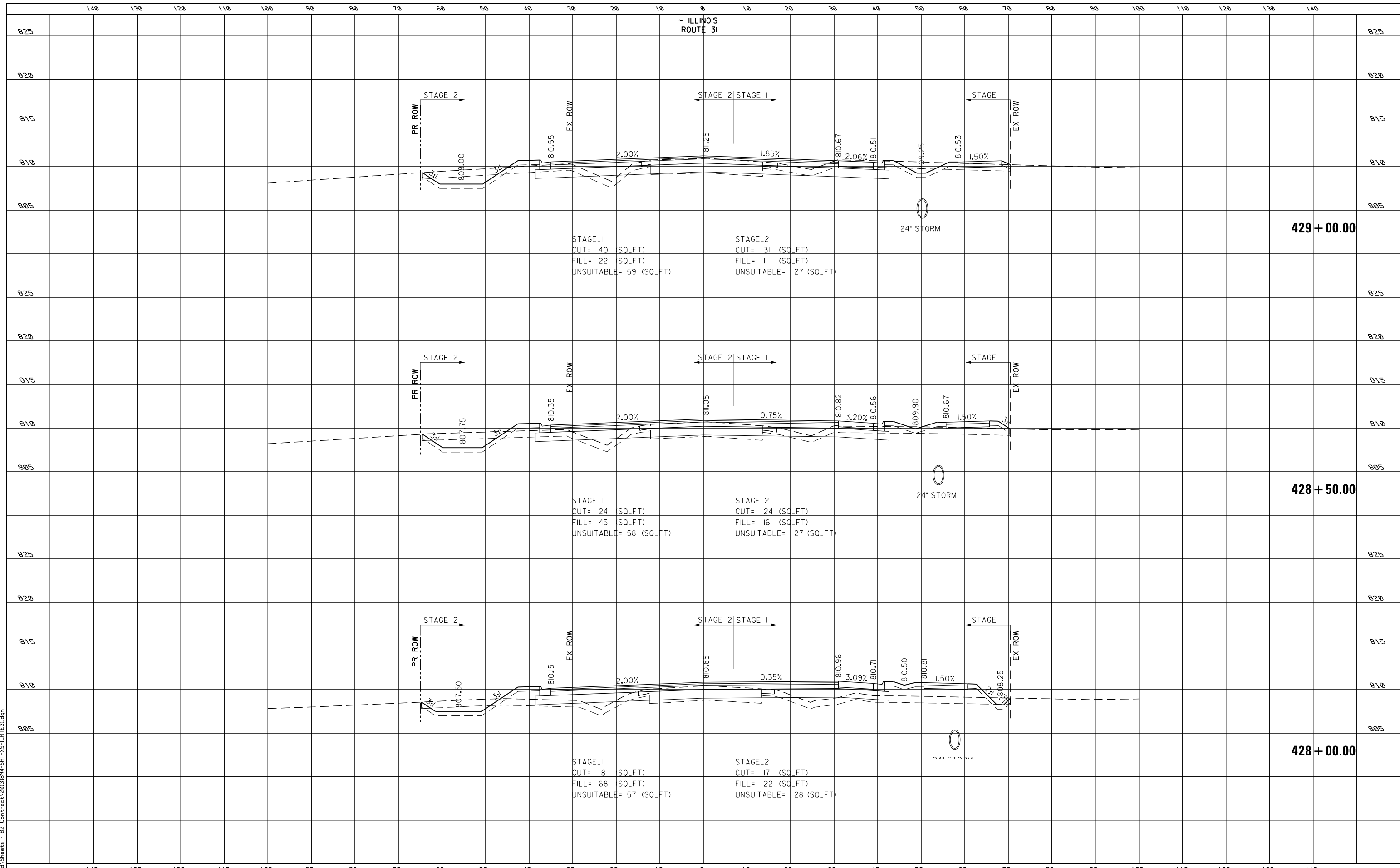

|               |  |
|---------------|--|
| DATE          |  |
| BY            |  |
| SURVEYED      |  |
| PLOTTED       |  |
| TEMPLATE      |  |
| AREAS CHECKED |  |
| FINL SURVEY   |  |
| NOTE BOOK     |  |
| NO.           |  |

|                 |  |
|-----------------|--|
| DATE            |  |
| BY              |  |
| SURVEYED        |  |
| PLOTTED         |  |
| TEMPLATE        |  |
| AREAS CHECKED   |  |
| ORIGINAL SURVEY |  |
| NOTE BOOK       |  |
| NO.             |  |

FILE NAME = G:\CH13\099\Road\Sheets - B2 Contract\2013\B24-SHT-XS-ILE-E3.dgn

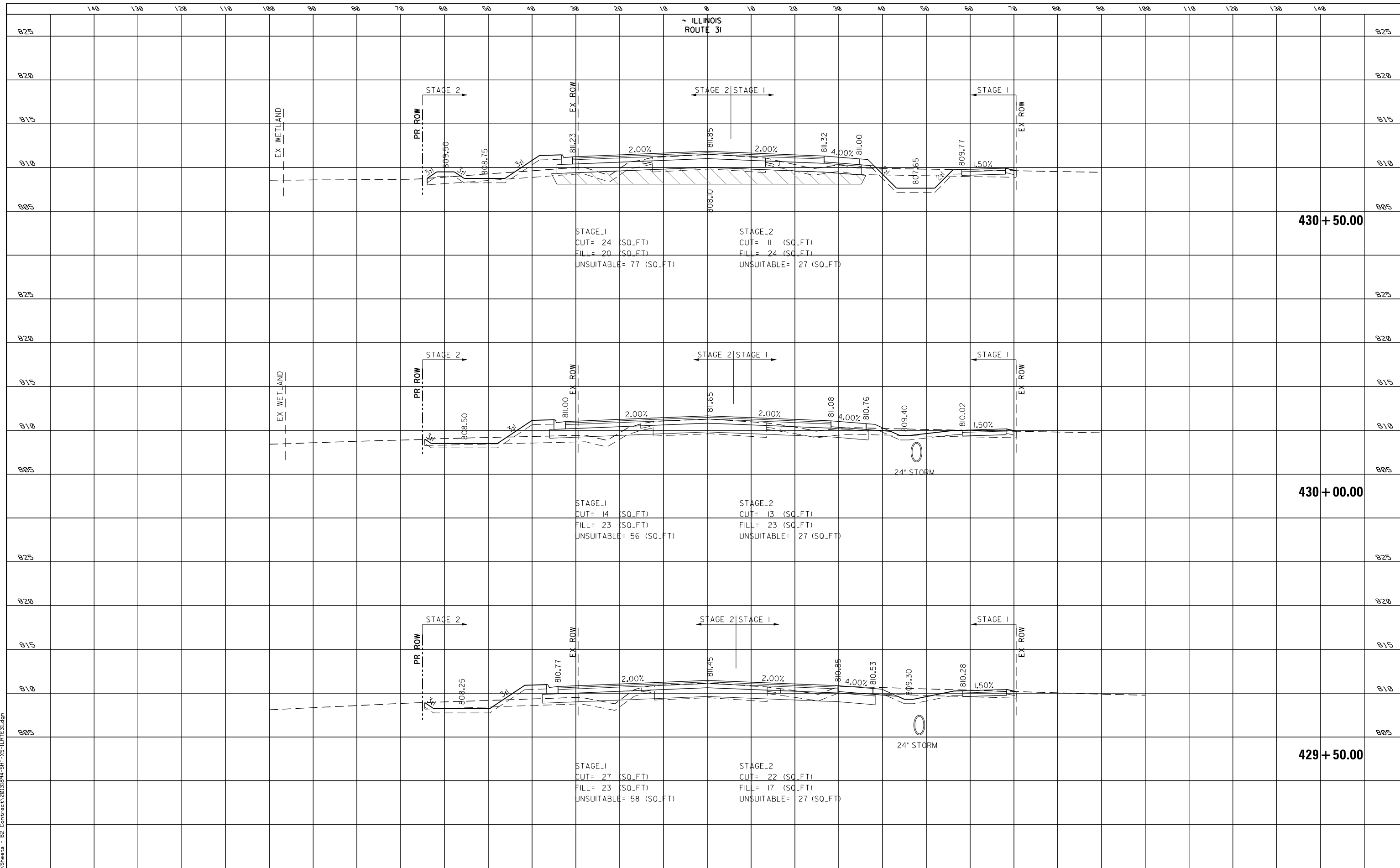

|  |                            |                 |           |   |   |   |                          |                                  |                    |                 |
|--|----------------------------|-----------------|-----------|---|---|---|--------------------------|----------------------------------|--------------------|-----------------|
|  | USER NAME = mbmwhorter     | DESIGNED = BSH  | REVISED = | <b>STATE OF ILLINOIS</b><br><b>DEPARTMENT OF TRANSPORTATION</b> | <b>IL RTE 31</b><br><b>CROSS SECTIONS</b> | F.A.P. RTE. = 2298                              | SECTION = 16-00215-II-PV | COUNTY = KANE                    | TOTAL SHEETS = 611 | SHEET NO. = 604 |
|  | PLOT SCALE = 20.000' / in. | CHECKED = MFD   | REVISED = |   |   | SCALE: 10H : 5V                                 | SHEET 604 OF 611 SHEETS  | STA. 429+50.00 TO STA. 430+50.00 | CONTRACT NO. 61E05 |                 |
|  | PLOT DATE = 9/25/2017      | DATE = 8/7/2017 | REVISED = |   |   | FED. ROAD DIST. NO. 1 ILLINOIS FED. AID PROJECT |                          |                                  |                    |                 |

|             |               |
|-------------|---------------|
| DATE        |               |
| BY          |               |
| FINL SURVEY | SURVEYED      |
| NOTE BOOK   | PLOTTED       |
| NO.         | TEMPLATE      |
|             | AREAS CHECKED |
|             | AREAS CHECKED |

|                 |               |
|-----------------|---------------|
| DATE            |               |
| BY              |               |
| ORIGINAL SURVEY | SURVEYED      |
| NOTE BOOK       | PLOTTED       |
| NO.             | TEMPLATE      |
|                 | AREAS CHECKED |
|                 | AREAS CHECKED |

FILE NAME = G:\CH13\099\Road\Sheets - B2 Contract\2013\B94-SHT-XS-ILE-E3.dgn

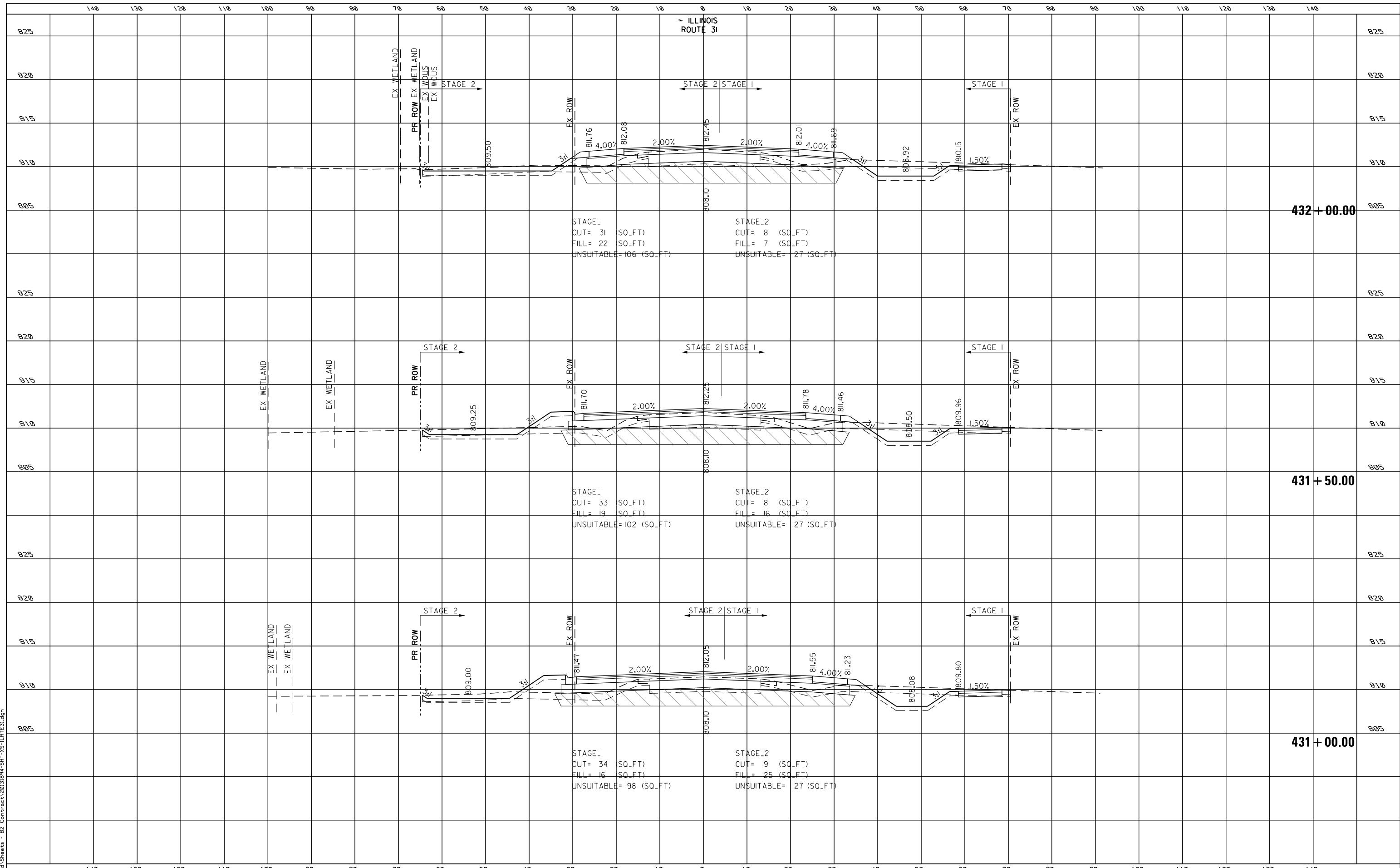

|                            |                 |           |
|----------------------------|-----------------|-----------|
| USER NAME = mbmwhorter     | DESIGNED = BSH  | REVISED = |
|                            | DRAWN = MLB     | REVISED = |
| PLOT SCALE = 20.000' / in. | CHECKED = MFD   | REVISED = |
| PLOT DATE = 9/25/2017      | DATE = 8/7/2017 | REVISED = |

**STATE OF ILLINOIS  
DEPARTMENT OF TRANSPORTATION**

|                                     |  |
|-------------------------------------|--|
| <b>IL RTE 31<br/>CROSS SECTIONS</b> |  |
| SCALE: 10H : 5V                     | SHEET 605 OF 611 SHEETS STA. 431+00.00 TO STA. 432+00.00 |

|   |                        |             |                    |               |
|---|------------------------|-------------|--------------------|---------------|
| F.A.P. RTE. 2298                                | SECTION 16-00215-II-PV | COUNTY KANE | TOTAL SHEETS 611   | SHEET NO. 605 |
| FED. ROAD DIST. NO. 1 ILLINOIS FED. AID PROJECT |                        |             | CONTRACT NO. 61E05 |               |

|               |  |
|---------------|--|
| DATE          |  |
| BY            |  |
| SURVEYED      |  |
| PLOTTED       |  |
| TEMPLATE      |  |
| AREAS CHECKED |  |
| NO.           |  |

|               |  |
|---------------|--|
| DATE          |  |
| BY            |  |
| SURVEYED      |  |
| PLOTTED       |  |
| TEMPLATE      |  |
| AREAS CHECKED |  |
| NO.           |  |

FILE NAME = G:\CH\3109\Road\Sheets - B2 Contract\2013\B24-SHT-XS-ILE-31.dgn

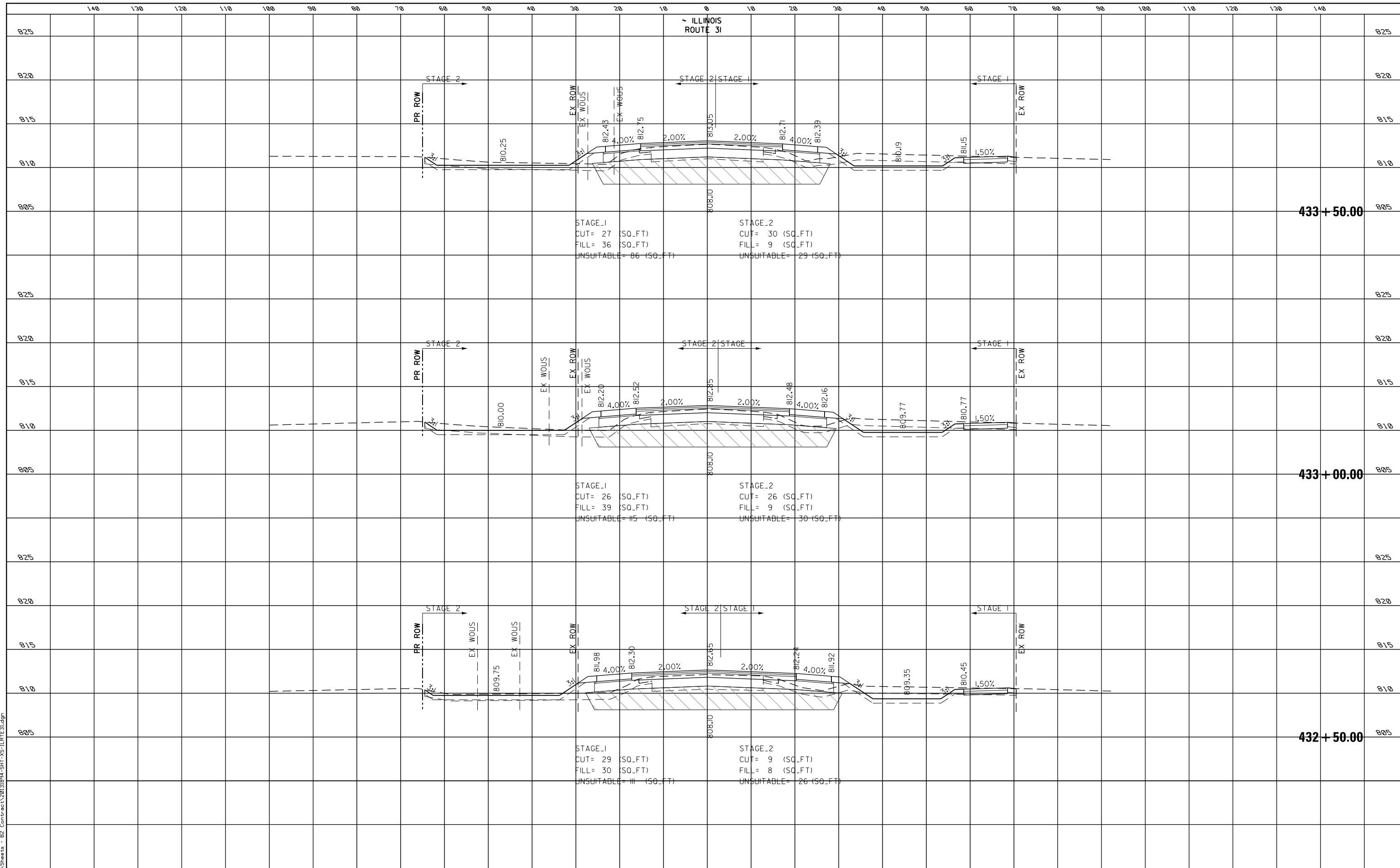

|                            |                 |           |
|----------------------------|-----------------|-----------|
| USER NAME = mbmwhorter     | DESIGNED = BSH  | REVISED = |
|                            | DRAWN = MLB     | REVISED = |
| PLOT SCALE = 20.000' / in. | CHECKED = MFD   | REVISED = |
| PLOT DATE = 9/25/2017      | DATE = 8/7/2017 | REVISED = |

**STATE OF ILLINOIS  
DEPARTMENT OF TRANSPORTATION**

|                                     |                         |
|-------------------------------------|-------------------------|
| <b>IL RTE 31<br/>CROSS SECTIONS</b> |                         |
| SCALE: 10H : 5V                     | SHEET 606 OF 611 SHEETS |
| STA. 432+50.00 TO STA. 433+50.00    |                         |

|   |                |        |              |           |
|---|----------------|--------|--------------|-----------|
| F.A.P. RTE.                                     | SECTION        | COUNTY | TOTAL SHEETS | SHEET NO. |
| 2298  | 16-00215-II-PV | KANE   | 611          | 606       |
| CONTRACT NO. 61E05                              |                |        |              |           |
| FED. ROAD DIST. NO. 1 ILLINOIS FED. AID PROJECT |                |        |              |           |

|              |               |
|--------------|---------------|
| BY           | DATE          |
|              |               |
| FINAL SURVEY | SURVEYED      |
| NOTE BOOK    | PLOTTED       |
| NO.          | TEMPLATE      |
|              | AREAS CHECKED |
|              | AREAS CHECKED |

|                 |               |
|-----------------|---------------|
| BY              | DATE          |
|                 |               |
| ORIGINAL SURVEY | SURVEYED      |
| NOTE BOOK       | PLOTTED       |
| NO.             | TEMPLATE      |
|                 | AREAS CHECKED |
|                 | AREAS CHECKED |

FILE NAME = G:\CH13\009\Road\Sheets - B2 Contract\2013\B24-SHT-XS-ILE-31.dgn

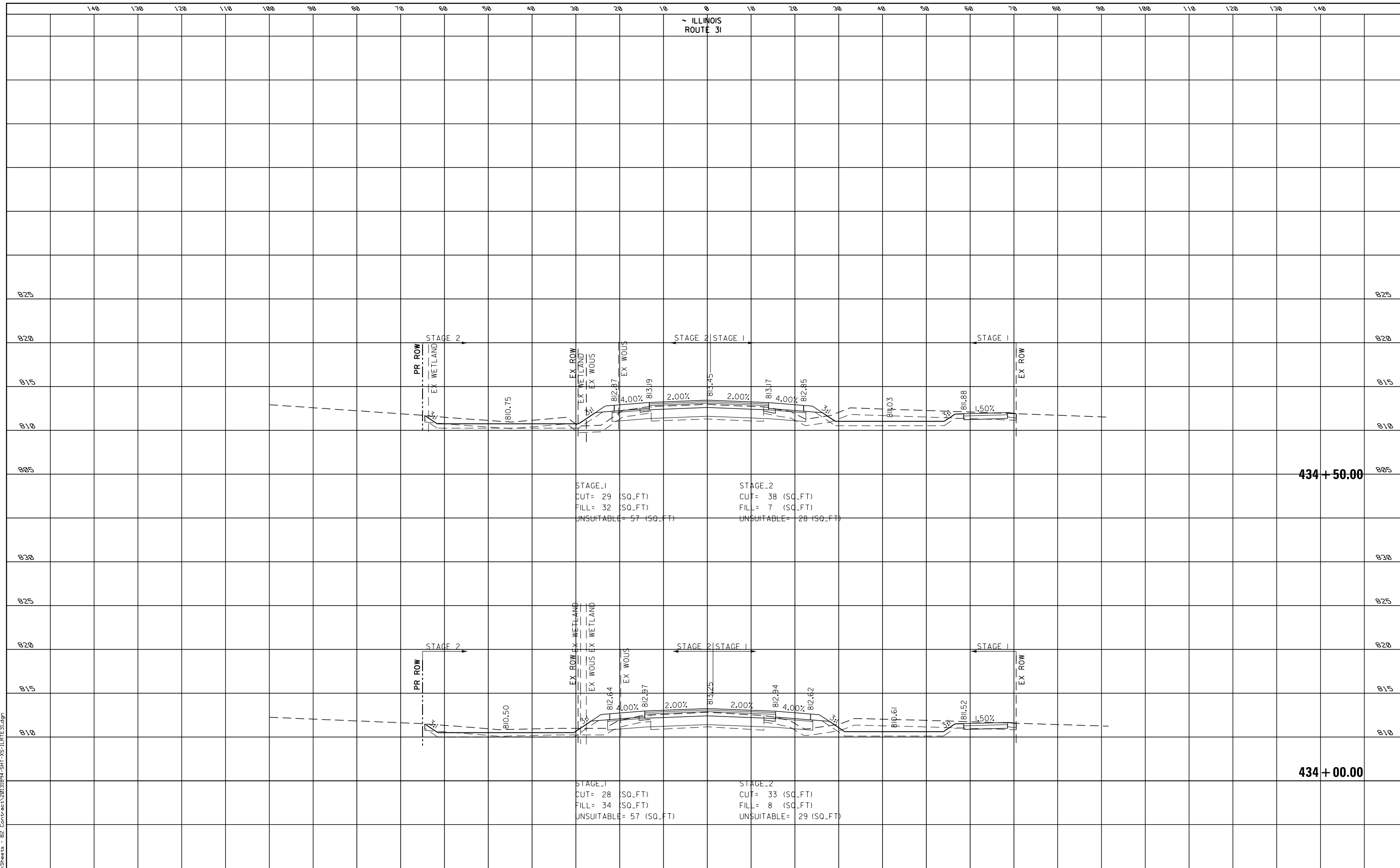

STAGE 1  
CUT = 29 (SQ. FT)  
FILL = 32 (SQ. FT)  
UNSUITABLE = 57 (SQ. FT)

STAGE 2  
CUT = 38 (SQ. FT)  
FILL = 7 (SQ. FT)  
UNSUITABLE = 28 (SQ. FT)

STAGE 1  
CUT = 28 (SQ. FT)  
FILL = 34 (SQ. FT)  
UNSUITABLE = 57 (SQ. FT)

STAGE 2  
CUT = 33 (SQ. FT)  
FILL = 8 (SQ. FT)  
UNSUITABLE = 29 (SQ. FT)

**434 + 50.00**

**434 + 00.00**



|                            |                 |            |
|----------------------------|-----------------|------------|
| USER NAME = mbmwhorter     | DESIGNED = BSH  | REVISIED = |
|                            | DRAWN = MLB     | REVISIED = |
| PLOT SCALE = 20.000' / in. | CHECKED = MFD   | REVISIED = |
| PLOT DATE = 9/25/2017      | DATE = 8/7/2017 | REVISIED = |

**STATE OF ILLINOIS  
DEPARTMENT OF TRANSPORTATION**

|                                     |                         |
|-------------------------------------|-------------------------|
| <b>IL RTE 31<br/>CROSS SECTIONS</b> |                         |
| SCALE: 10H : 5V                     | SHEET 607 OF 611 SHEETS |
| STA. 434+00.00 TO STA. 434+50.00    |                         |

|   |                |        |              |                    |
|---|----------------|--------|--------------|--------------------|
| F.A.P. RTE.                                     | SECTION        | COUNTY | TOTAL SHEETS | SHEET NO.          |
| 2298  | 16-00215-II-PV | KANE   | 611          | 607                |
|   |                |        |              | CONTRACT NO. 61E05 |
| FED. ROAD DIST. NO. 1 ILLINOIS FED. AID PROJECT |                |        |              |                    |

|               |  |
|---------------|--|
| DATE          |  |
| BY            |  |
| SURVEYED      |  |
| PLOTTED       |  |
| TEMPLATE      |  |
| AREAS CHECKED |  |
| FINL SURVEY   |  |
| NOTE BOOK     |  |
| NO.           |  |

|                 |  |
|-----------------|--|
| DATE            |  |
| BY              |  |
| SURVEYED        |  |
| PLOTTED         |  |
| TEMPLATE        |  |
| AREAS CHECKED   |  |
| ORIGINAL SURVEY |  |
| NOTE BOOK       |  |
| NO.             |  |

FILE NAME = G:\CH13\099\Road\Sheets - B2 Contract\2013\B24-SHT-XS-LE-E31.dgn

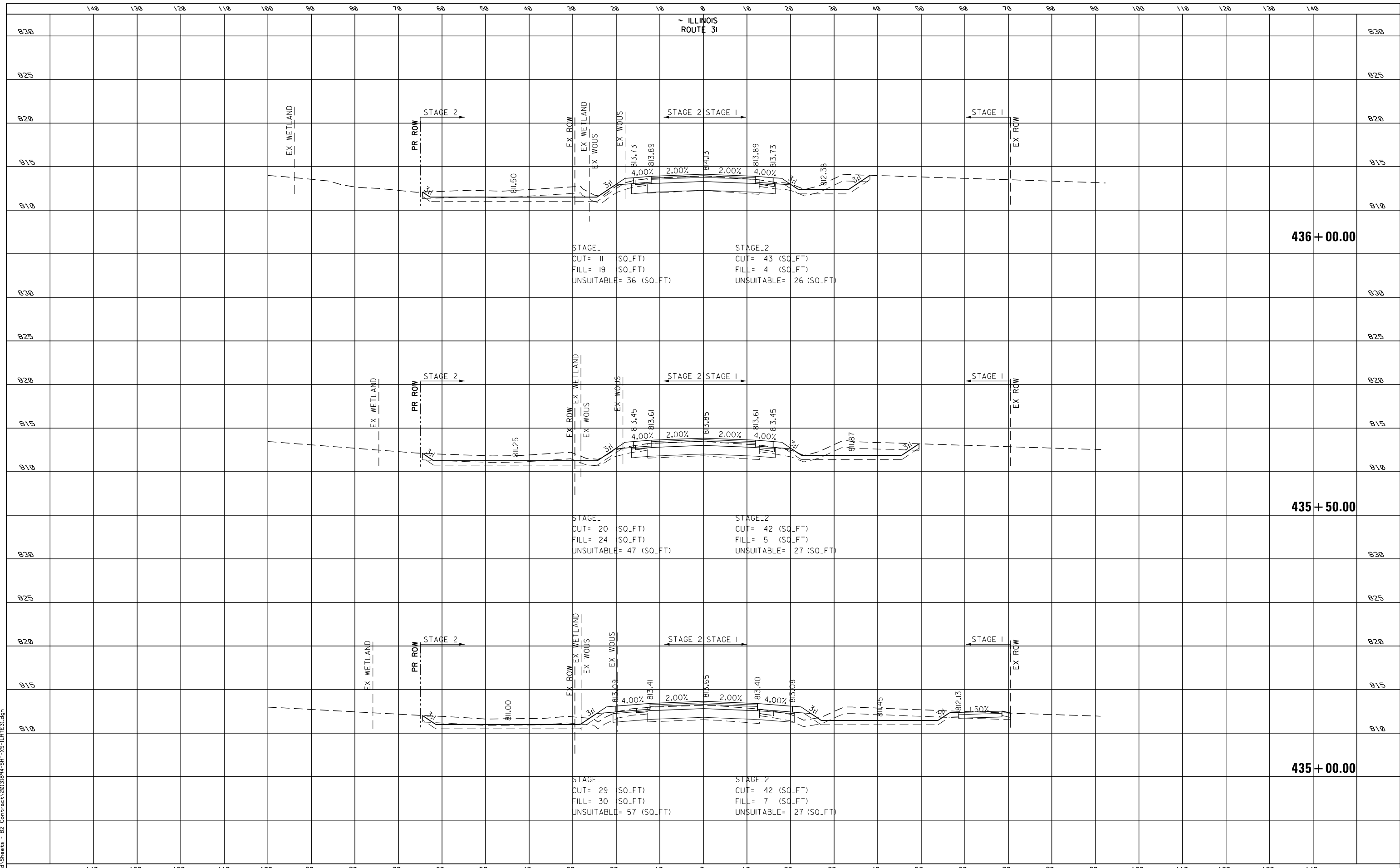

STAGE\_1  
CUT= 11 (SQ\_FT)  
FILL= 19 (SQ\_FT)  
UNSUITABLE= 36 (SQ\_FT)

STAGE\_2  
CUT= 43 (SQ\_FT)  
FILL= 4 (SQ\_FT)  
UNSUITABLE= 26 (SQ\_FT)

STAGE\_1  
CUT= 20 (SQ\_FT)  
FILL= 24 (SQ\_FT)  
UNSUITABLE= 47 (SQ\_FT)

STAGE\_2  
CUT= 42 (SQ\_FT)  
FILL= 5 (SQ\_FT)  
UNSUITABLE= 27 (SQ\_FT)

STAGE\_1  
CUT= 29 (SQ\_FT)  
FILL= 30 (SQ\_FT)  
UNSUITABLE= 57 (SQ\_FT)

STAGE\_2  
CUT= 42 (SQ\_FT)  
FILL= 7 (SQ\_FT)  
UNSUITABLE= 27 (SQ\_FT)



|                            |                 |           |
|----------------------------|-----------------|-----------|
| USER NAME = mbmawhorter    | DESIGNED = BSH  | REVISED = |
|                            | DRAWN = MLB     | REVISED = |
| PLOT SCALE = 20.000' / in. | CHECKED = MFD   | REVISED = |
| PLOT DATE = 9/25/2017      | DATE = 8/7/2017 | REVISED = |

**STATE OF ILLINOIS  
DEPARTMENT OF TRANSPORTATION**

**IL RTE 31  
CROSS SECTIONS**

SCALE: 10H : 5V SHEET 608 OF 611 SHEETS STA. 435+00.00 TO STA. 436+00.00

|   |                |        |              |           |
|---|----------------|--------|--------------|-----------|
| F.A.P. RTE.                                     | SECTION        | COUNTY | TOTAL SHEETS | SHEET NO. |
| 2298  | 16-00215-II-PV | KANE   | 611          | 608       |
| CONTRACT NO. 61E05                              |                |        |              |           |
| FED. ROAD DIST. NO. 1 ILLINOIS FED. AID PROJECT |                |        |              |           |



|               |  |
|---------------|--|
| DATE          |  |
| BY            |  |
| SURVEYED      |  |
| PLOTTED       |  |
| TEMPLATE      |  |
| AREAS CHECKED |  |
| NO.           |  |

|               |  |
|---------------|--|
| DATE          |  |
| BY            |  |
| SURVEYED      |  |
| PLOTTED       |  |
| TEMPLATE      |  |
| AREAS CHECKED |  |
| NO.           |  |

FILE NAME = G:\CH13\09\Road\Sheets - B2 Contract\2013\B24-SHT-XS-ILEE31.dgn

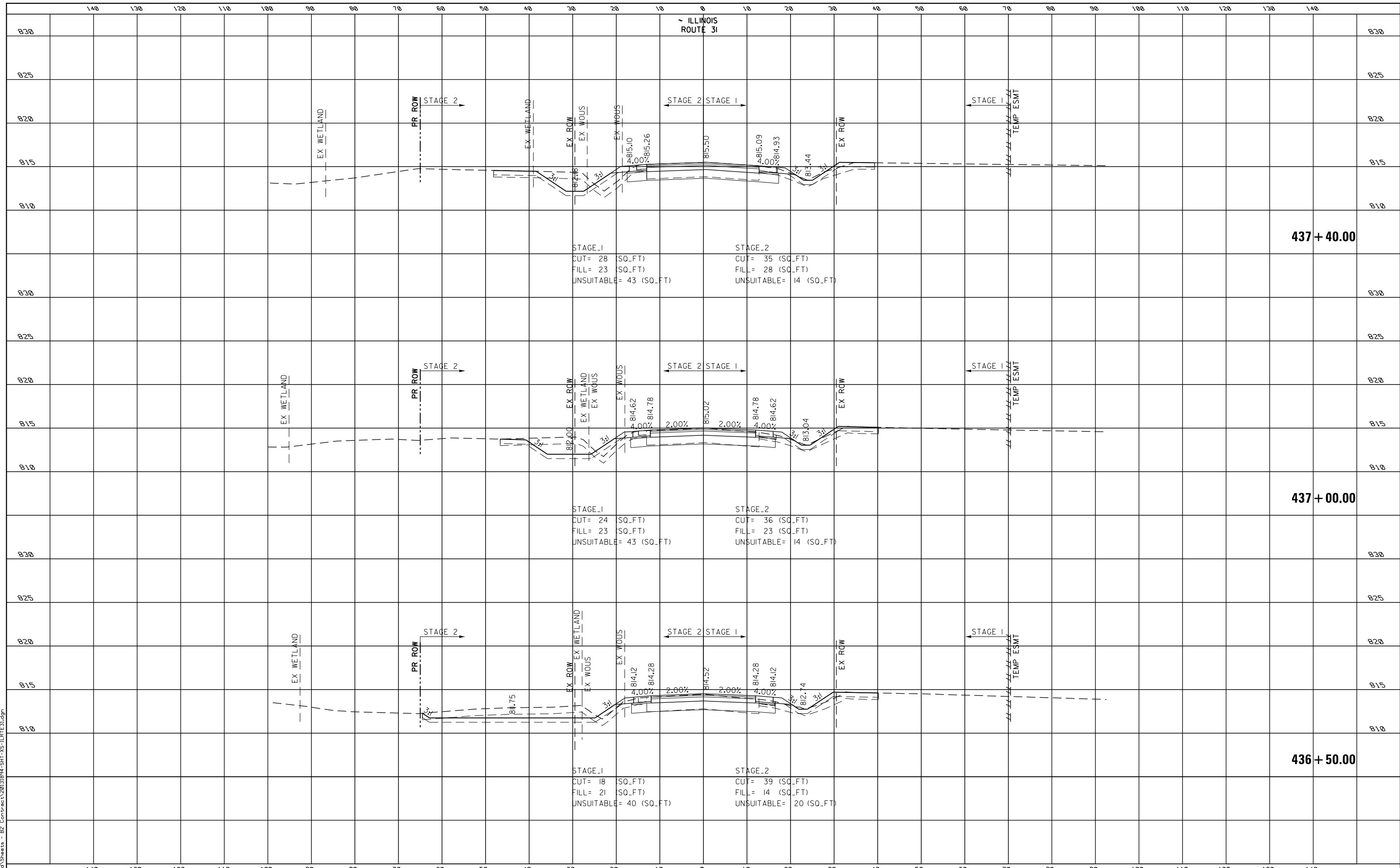

|  |                            |                 |           |   |   |   |                          |               |                                  |                    |  |  |  |
|--|----------------------------|-----------------|-----------|---|---|---|--------------------------|---------------|----------------------------------|--------------------|--|--|--|
|  | USER NAME = mbmwhorter     | DESIGNED = BSH  | REVISED = | <b>STATE OF ILLINOIS</b><br><b>DEPARTMENT OF TRANSPORTATION</b> | <b>IL RTE 31</b><br><b>CROSS SECTIONS</b> | F.A.P. RTE. = 2298                              | SECTION = 16-00215-II-PV | COUNTY = KANE | TOTAL SHEETS = 611               | SHEET NO. = 609    |  |  |  |
|  | PLOT SCALE = 20.000' / in. | CHECKED = MFD   | REVISED = |   |   | SCALE: 10H : 5V                                 | SHEET 609 OF 611         | SHEETS        | STA. 436+50.00 TO STA. 437+40.00 | CONTRACT NO. 61E05 |  |  |  |
|  | PLOT DATE = 9/25/2017      | DATE = 8/7/2017 | REVISED = |   |   | FED. ROAD DIST. NO. 1 ILLINOIS FED. AID PROJECT |                          |               |                                  |                    |  |  |  |
|  |                            |                 |           |   |   |   |                          |               |                                  |                    |  |  |  |

|               |  |
|---------------|--|
| DATE          |  |
| BY            |  |
| SURVEYED      |  |
| PLOTTED       |  |
| TEMPLATE      |  |
| AREAS CHECKED |  |
| FINL SURVEY   |  |
| NOTE BOOK     |  |
| NO.           |  |

|                 |  |
|-----------------|--|
| DATE            |  |
| BY              |  |
| SURVEYED        |  |
| PLOTTED         |  |
| TEMPLATE        |  |
| AREAS CHECKED   |  |
| ORIGINAL SURVEY |  |
| NOTE BOOK       |  |
| NO.             |  |

FILE NAME = G:\CH13\009\Road\Sheets - B2 Contract\2013\B24-SHT-XS-LE-E3.dgn

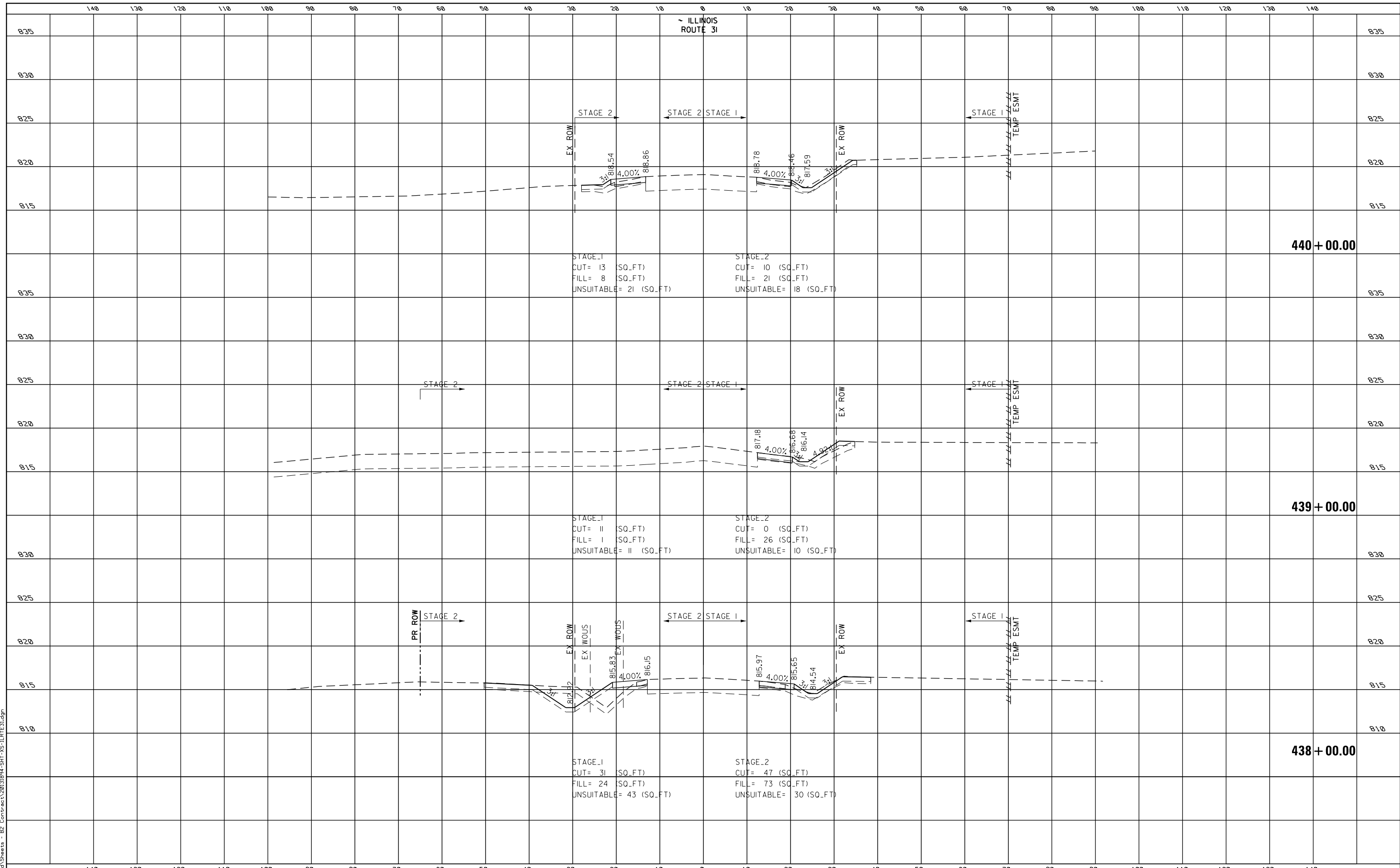

STAGE\_1  
CUT= 13 (SQ.FT)  
FILL= 8 (SQ.FT)  
UNSUITABLE= 21 (SQ.FT)

STAGE\_2  
CUT= 10 (SQ.FT)  
FILL= 21 (SQ.FT)  
UNSUITABLE= 18 (SQ.FT)

STAGE\_1  
CUT= 11 (SQ.FT)  
FILL= 1 (SQ.FT)  
UNSUITABLE= 11 (SQ.FT)

STAGE\_2  
CUT= 0 (SQ.FT)  
FILL= 26 (SQ.FT)  
UNSUITABLE= 10 (SQ.FT)

STAGE\_1  
CUT= 31 (SQ.FT)  
FILL= 24 (SQ.FT)  
UNSUITABLE= 43 (SQ.FT)

STAGE\_2  
CUT= 47 (SQ.FT)  
FILL= 73 (SQ.FT)  
UNSUITABLE= 30 (SQ.FT)



|                            |                 |           |
|----------------------------|-----------------|-----------|
| USER NAME = mbmwhorter     | DESIGNED = BSH  | REVISED = |
|                            | DRAWN = MLB     | REVISED = |
| PLOT SCALE = 20.000' / in. | CHECKED = MFD   | REVISED = |
| PLOT DATE = 9/25/2017      | DATE = 8/7/2017 | REVISED = |

**STATE OF ILLINOIS  
DEPARTMENT OF TRANSPORTATION**

**IL RTE 31  
CROSS SECTIONS**

SCALE: 10H : 5V SHEET 610 OF 611 SHEETS STA. 438+00.00 TO STA. 440+00.00

|   |                |        |              |           |
|---|----------------|--------|--------------|-----------|
| F.A.P. RTE.                                     | SECTION        | COUNTY | TOTAL SHEETS | SHEET NO. |
| 2298  | 16-00215-II-PV | KANE   | 611          | 610       |
| CONTRACT NO. 61E05                              |                |        |              |           |
| FED. ROAD DIST. NO. 1 ILLINOIS FED. AID PROJECT |                |        |              |           |

140 130 120 110 100 90 80 70 60 50 40 30 20 10 0 10 20 30 40 50 60 70 80 90 100 110 120 130 140

~ ILLINOIS  
ROUTE 31

|                  |                                |    |      |
|------------------|--------------------------------|----|------|
| FINAL SURVEY NO. | SURVEYED PLOTTED AREAS CHECKED | BY | DATE |
|                  |                                |    |      |
|                  |                                |    |      |
|                  |                                |    |      |
|                  |                                |    |      |
|                  |                                |    |      |

|                     |                                |    |      |
|---------------------|--------------------------------|----|------|
| ORIGINAL SURVEY NO. | SURVEYED PLOTTED AREAS CHECKED | BY | DATE |
|                     |                                |    |      |
|                     |                                |    |      |
|                     |                                |    |      |
|                     |                                |    |      |
|                     |                                |    |      |

835  
830  
825  
820  
815

835  
830  
825  
820  
815

441 + 00.00

140 130 120 110 100 90 80 70 60 50 40 30 20 10 0 10 20 30 40 50 60 70 80 90 100 110 120 130 140

|                            |                 |           |
|----------------------------|-----------------|-----------|
| USER NAME = mbmwhorter     | DESIGNED = BSH  | REVISED = |
| PLOT SCALE = 20.000' / in. | DRAWN = MLB     | REVISED = |
| PLOT DATE = 9/25/2017      | CHECKED = MFD   | REVISED = |
|                            | DATE = 8/7/2017 | REVISED = |

**STATE OF ILLINOIS  
DEPARTMENT OF TRANSPORTATION**

**IL RTE 31  
CROSS SECTIONS**

SCALE: 10H : 5V SHEET 611 OF 611 SHEETS STA. 441+00.00 TO STA. 441+00.00

|   |                        |             |                    |               |
|---|------------------------|-------------|--------------------|---------------|
| F.A.P. RTE. 2298                                | SECTION 16-00215-II-PV | COUNTY KANE | TOTAL SHEETS 611   | SHEET NO. 611 |
| FED. ROAD DIST. NO. 1 ILLINOIS FED. AID PROJECT |                        |             | CONTRACT NO. 61E05 |               |



FILE NAME = G:\CH13\099\Road\Sheets - B2 Contract\2013\B24-SHT-XS-ILE-31.dgn