

STATE OF ILLINOIS  
 DEPARTMENT OF TRANSPORTATION  
 DIVISION OF HIGHWAYS

F.A.	SECTION	COUNTY	TOTAL SHEETS
342	12B-1-1	LAKE	13

D-91-388-96

FOR INDEX OF SHEETS, SEE SHEET NO. 2

PLANS FOR PROPOSED  
 FEDERAL AID HIGHWAY

F.A. 342 (IL 120)  
 OVER DES PLAINES RIVER  
 SECTION: 12B-1-1  
 BRIDGE REPAIR  
 C-91-388-96  
 SN: 049-0046 & 049-0047

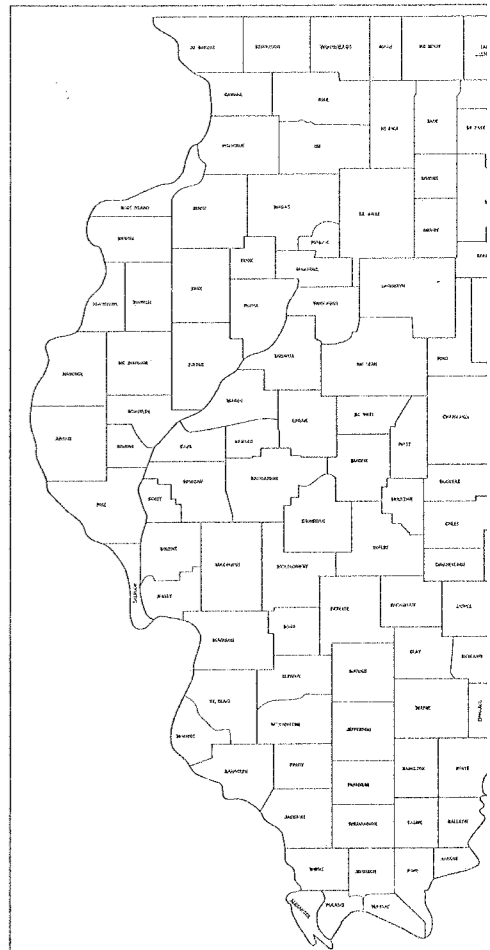

LOCATION OF SECTION INDICATED THUS: —

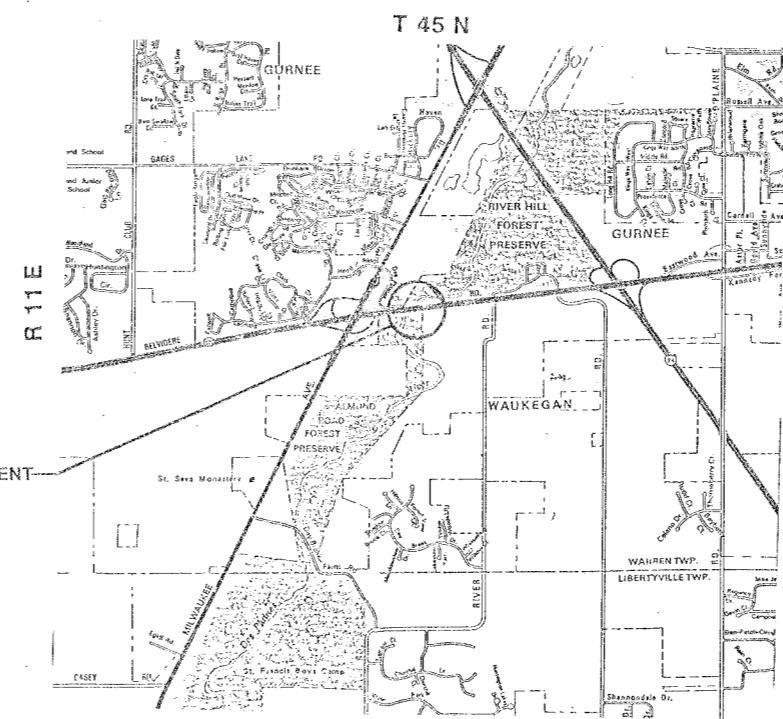

SPEED LIMIT: 55 mph  
 1995 ADT: 22700

STATE OF ILLINOIS  
 DEPARTMENT OF TRANSPORTATION  
 DIVISION OF HIGHWAYS

SUBMITTED \_\_\_\_\_ 19\_\_\_\_ DISTRICT \_\_\_\_\_

EXAMINED \_\_\_\_\_ 19\_\_\_\_ ENGINEER OF PLANS AND \_\_\_\_\_

PASSED \_\_\_\_\_ 19\_\_\_\_ ENGINEER \_\_\_\_\_

APPROVED \_\_\_\_\_ 19\_\_\_\_ DIRECTOR, DIVISION OF \_\_\_\_\_

PRINTED BY AUTHORITY OF THE  
 STATE OF ILLINOIS

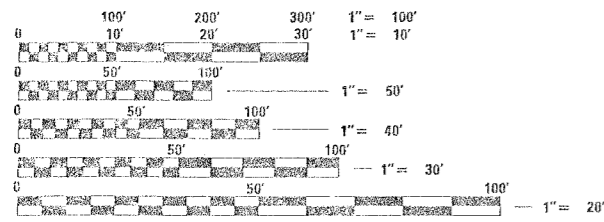

FULL SIZE PLANS HAVE BEEN PREPARED USING STANDARD ENGINEERING SCALES, REDUCED SIZED PLANS WILL NOT CONFORM TO STANDARD SCALES, IN MAKING MEASUREMENTS ON REDUCED PLANS, THE ABOVE SCALES MAY BE USED.

DISTRICT ONE - BUREAU OF MAINTENANCE: K. ANTONSON  
 MAINTENANCE DESIGN ENGINEER: B. EPINO / J. COWLEY (847) 705-4757

CONTRACT NO. 60202

## INDEX OF SHEETS

1. TITLE SHEET
2. INDEX OF SHEETS  
STATE STANDARDS  
GENERAL NOTES
3. SUMMARY OF QUANTITIES
4. GENERAL PLAN & ELEVATION
5. DECK PATCHING
6. CROSS SECTIONS, BRIDGE RAIL DETAIL
- 7-8. SUBSTRUCTURE REPAIR
9. BRIDGE RAIL DETAIL
10. GUARDRAIL PLAN
- 11-13. INFORMATION SHEETS

## GENERAL NOTES

1. BEFORE STARTING ANY EXCAVATION, THE CONTRACTOR SHALL CALL "J.U.L.I.E." AT (800)892-0123 FOR FIELD LOCATIONS OF BURIED ELECTRIC, TELEPHONE AND GAS UTILITIES. (48 HOUR NOTIFICATION IS REQUIRED).
2. THE CONTRACTOR WILL NOT BE ALLOWED TO SET UP A YARD OR FIELD OFFICE ON STATE PROPERTY WITHOUT WRITTEN PERMISSION FROM THE DEPARTMENT.
3. THE REMOVAL OF GUARDRAIL TERMINAL SECTIONS SHALL BE INCLUDED IN THE UNIT PRICE PER LINEAL FOOT FOR "STEEL PLATE BEAM GUARDRAIL REMOVAL."
4. BARRICADES: THE CONTRACTOR SHALL PROVIDE AND INSTALL TWO (2) WEIGHTED SAND BAGS ON EACH TYPE I OR TYPE II BARRICADE USED. (ONE [1] WEIGHTED SAND BAG ACROSS EACH BOTTOM RAIL).
5. EXACT BRIDGE PATCHING LOCATIONS WILL BE DETERMINED IN THE FIELD BY THE ENGINEER.
6. IT SHALL BE THE CONTRACTOR'S RESPONSIBILITY TO VERIFY ALL DIMENSIONS AND CONDITIONS EXISTING IN THE FIELD PRIOR TO CONSTRUCTION AND ORDERING OF MATERIALS.
7. THE CONTRACTOR SHALL CONTACT THE DISTRICT ONE TRAFFIC CONTROL SUPERVISOR AT (847)705-4470 A MINIMUM OF 72 HOURS IN ADVANCE OF BEGINNING WORK.
8. THE ENGINEER SHALL CONTACT FRANK GRONN, TRAFFIC FIELD ENGINEER AT (847)438-2300 TWO (2) WEEKS PRIOR TO THE START OF THIS PROJECT SO THAT EXACT STATIONING OF NO PASSING ZONES AND OTHER PAVEMENT MARKINGS MAY BE ESTABLISHED.
9. THESE PLANS HAVE BEEN PREPARED FROM NOTES RECEIVED FROM FIELD BRIDGE MAINTENANCE ENGINEERS.
10. THE CONTRACTOR SHALL BE REQUIRED TO PROVIDE ACCESS TO ABUTTING PROPERTY AT ALL TIMES DURING THE CONSTRUCTION OF THIS PROJECT.

## STATE STANDARDS

630001 631026 701401 631011

701411 702001 780001

REVISIONS	
NAME	DATE

ILLINOIS DEPARTMENT OF TRANSPORTATION

**INDEX OF SHEETS**

**STATE STANDARDS**

**GENERAL NOTES**

SCALE: VERT. \_\_\_\_\_  
 HORIZ. \_\_\_\_\_

DATE \_\_\_\_\_

DRAWN \_\_\_\_\_  
 DESIGN \_\_\_\_\_  
 CHECK \_\_\_\_\_

## SUMMARY OF QUANTITIES

CODE NO.	ITEM	UNIT	TOTAL QUANTITY	A	B
28100101	STONE RIPRAP, CLASS A1	SQ YD	26	26	0
28200100	FILTER FABRIC FOR USE WITH RIPRAP	SQ YD	26	26	0
50301245	FORMED CONCRETE REPAIR (DEPTH EQUAL TO OR LESS THAN 5")	SQ FT	101	44	57
50301250	FORMED CONCRETE REPAIR (DEPTH GREATER THAN 5")	SQ FT	50	0	50
50901001	STEEL BRIDGE RAIL	FOOT	708	354	354
63000000	STEEL PLATE BEAM GUARD RAIL, TYPE A	FOOT	400	200	200
63100045	TRAFFIC BARRIER TERMINAL, TYPE 2	EACH	2	1	1
63100075	TRAFFIC BARRIER TERMINAL, TYPE 5A	EACH	7	3	4
63200600	STEEL PLATE BEAM GUARD RAIL REMOVAL, SINGLE RAIL	FOOT	217.5	105	112.5
63301000	REMOVE AND RE-ERECT STEEL PLATE BEAM GUARD RAIL	FOOT	337.5	125	212.5
Z0007400	BRIDGE SIDEWALK REPAIR (PARTIAL DEPTH)	SQ FT	560	390	170
Z0016001	DECK SLAB REPAIR (FULL DEPTH, TYPE I)	SQ YD	20	15	5
Z0016002	DECK SLAB REPAIR (FULL DEPTH, TYPE II)	SQ YD	155	60	95
Z0016200	DECK SLAB REPAIR (PARTIAL)	SQ YD	580	250	330
70100420	TRAFFIC CONTROL AND PROTECTION, STANDARD 701411	EACH	1	1	0
70100800	TRAFFIC CONTROL AND PROTECTION, STANDARD 701401	L SUM	1	0.5	0.5

A: IL 120 EASTBOUND OVER DES PLAINES RIVER S.N. 049-0046

B: IL 120 WESTBOUND OVER DES PLAINES RIVER S.N. 049-0047

REVISIONS	
NAME	DATE

ILLINOIS DEPARTMENT OF TRANSPORTATION

### SUMMARY OF QUANTITIES

SCALE: VERT.  
HORIZ.  
DATE

DRAWN  
DESIGN  
CHECK



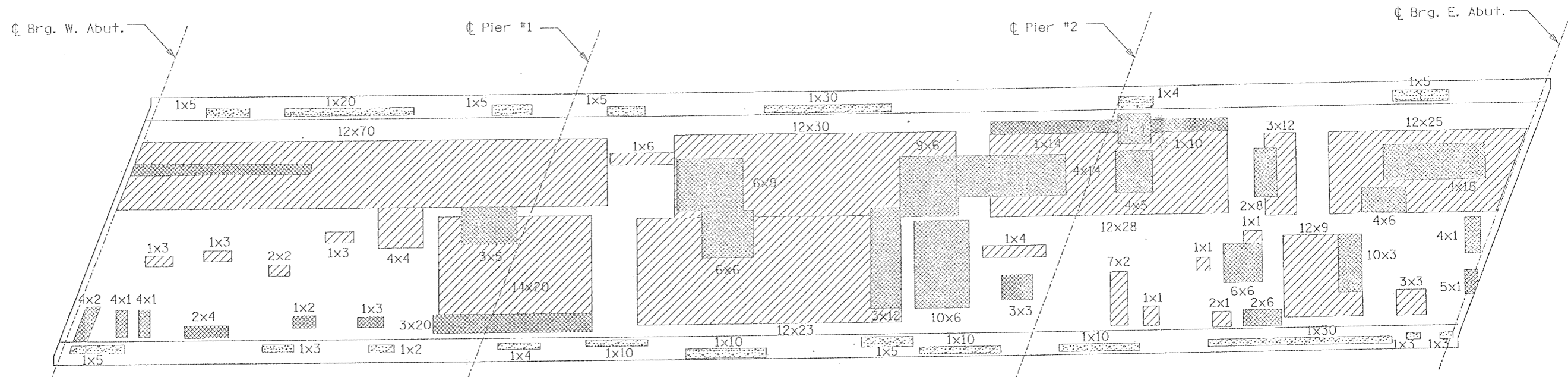

WEST BOUND  
STRUCT. NO. 049-0047

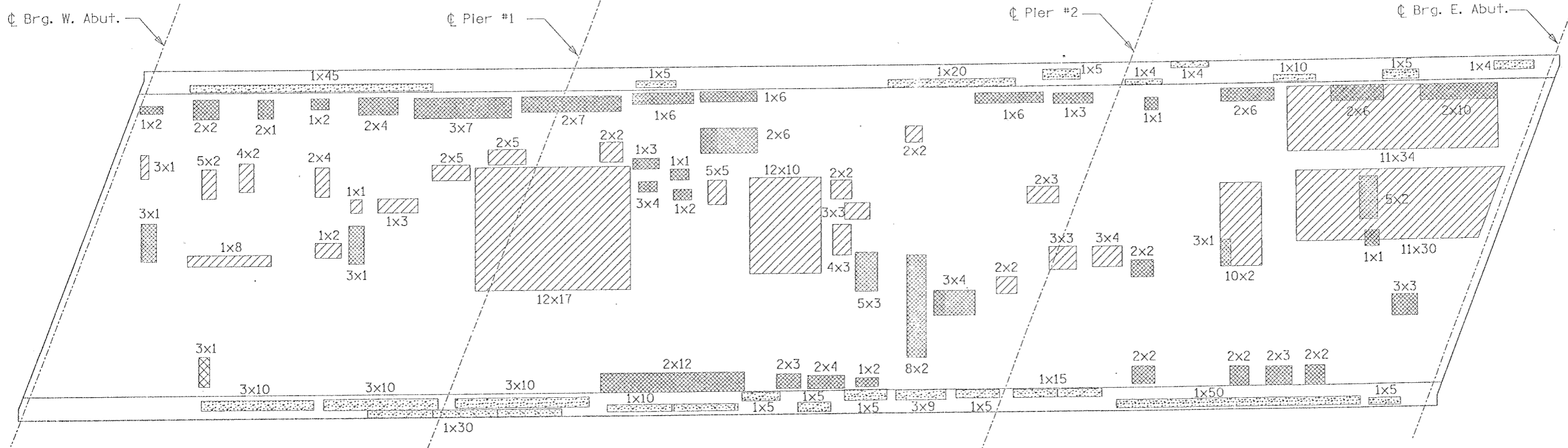

EAST BOUND  
STRUCT. NO. 049-0046

- LEGEND**
- SPALLS OR MAP CRACKED AREAS-PARTIAL DEPTH
  - FULL DEPTH REPAIR AREAS (TYPE I OR II)
  - SIDEWALK REPAIR

**BILL OF MATERIAL**

ITEM	UNIT	QUANTITY		
		E.B.	W.B.	TOTAL
DECK SLAB REPAIR PARTIAL DEPTH	SQ YD	250	330	580
DECK SLAB REPAIR FULL DEPTH (TYPE I)	SQ YD	15	5	20
DECK SLAB REPAIR FULL DEPTH (TYPE II)	SQ YD	60	95	155
SIDEWALK REPAIR PARTIAL DEPTH	SQ FT	200	400	600

PATCHING SURVEY DATE: 4-  
STRUCTURE NO

REVISIONS		
NO.	DATE	REVISIONS
1		
2		
3		
4		
5		
6		
7		
8		
9		
10		

DECK PLAN  
DEPARTMENT  
II



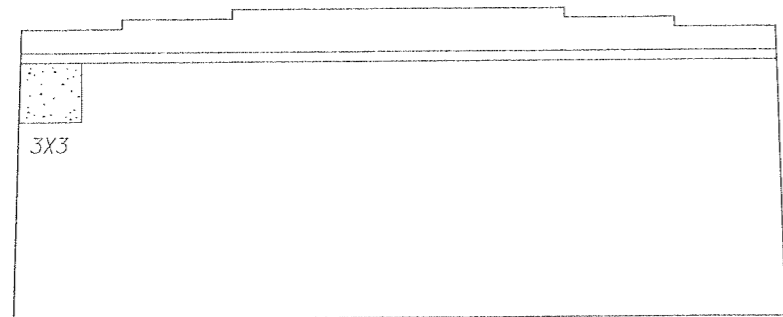

ELEVATION EAST FACE  
PIER #1 (W.B.) S.NO. 049-0047

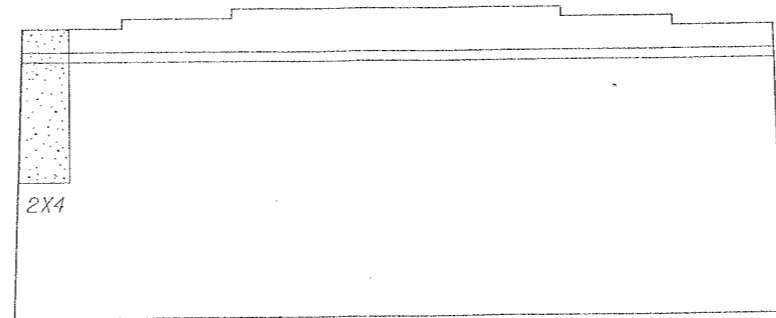

ELEVATION EAST FACE  
PIER #1 (E.B.) S.N. 049-0046

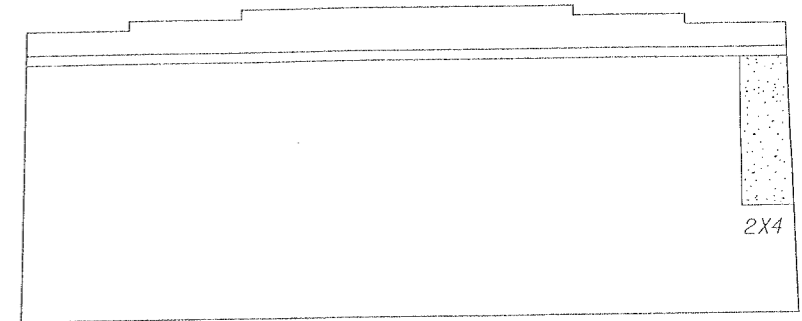

ELEVATION WEST FACE  
PIER #1 (E.B.) S.N. 049-0046

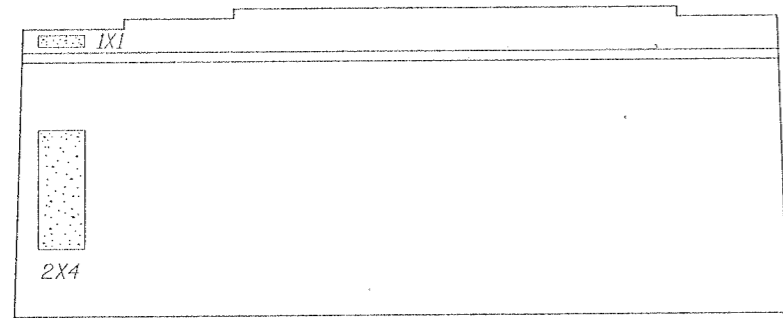

ELEVATION EAST FACE  
PIER #2 (W.B.) S.NO-049-0047

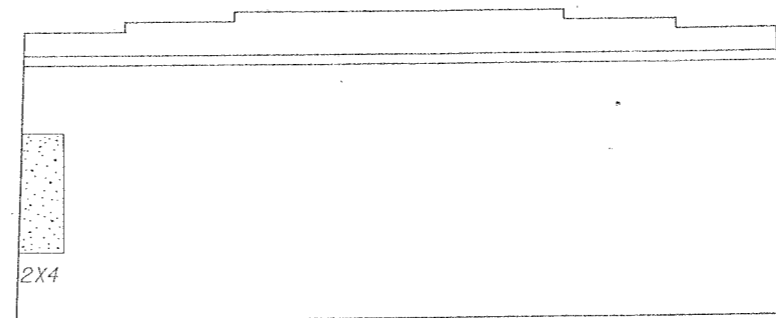

ELEVATION EAST FACE  
PIER #2 (E.B.) S.N. 049-0046

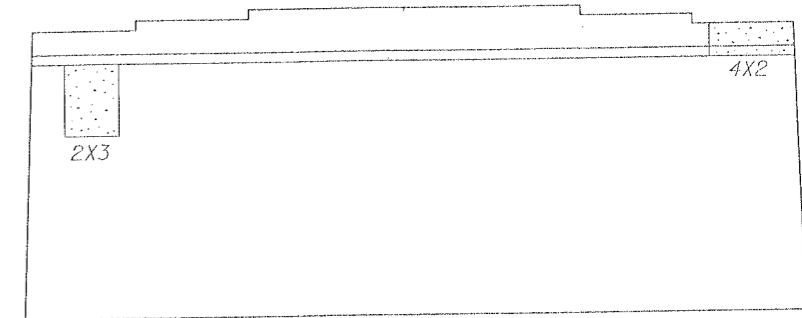

ELEVATION WEST FACE  
PIER #2 (E.B.) S.N. 049-0046

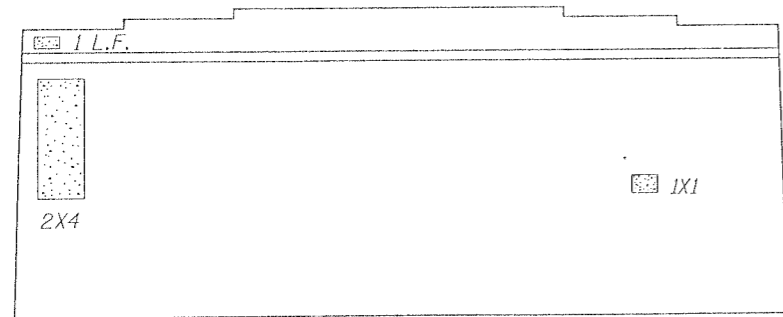

ELEVATION WEST FACE  
PIER #2 (WB) S.N. 049-0047

BILL OF MATERIAL

Formed Concrete Repair	UNIT	TOTAL
W.B. Bridge < 5"	SQ FT	38
E.B. Bridge < 5"	SQ FT	27

LEGEND

 Formed Concrete Repair < 5"

FILE: I:\A012\012\rep03.dgn  
DATE: 23-Dec-96 10:47

STRUCTURE NO. 049-0046 & 049-0047

**SUBSTRUCTURE REPAIR**

STATE OF ILLINOIS  
DEPARTMENT OF TRANSPORTATION

REVISIONS		
NO.	DATE	DETAILS
1		
2		
3		
4		
5		
6		
7		
8		
9		
10		

4 OF 4

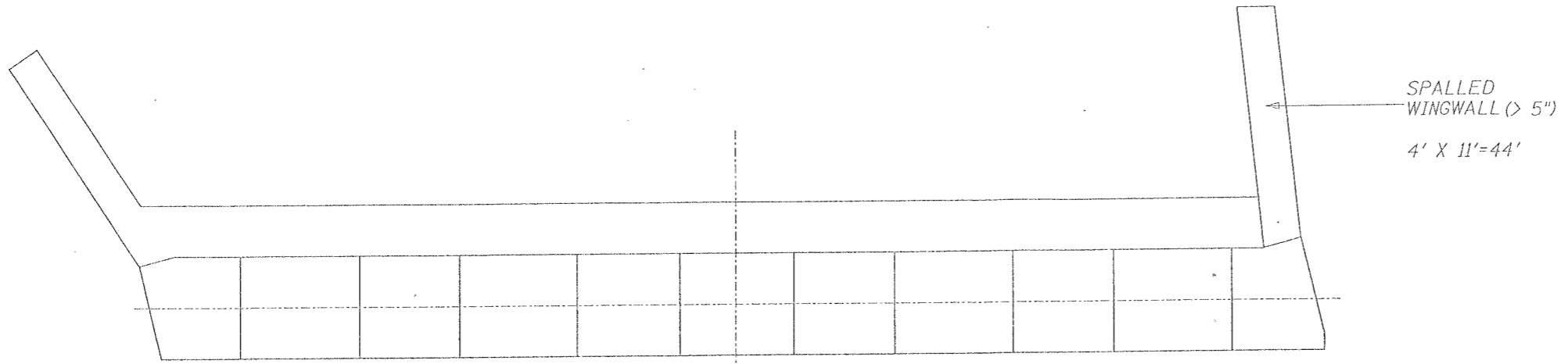

PLAN  
(W.B.) BRIDGE

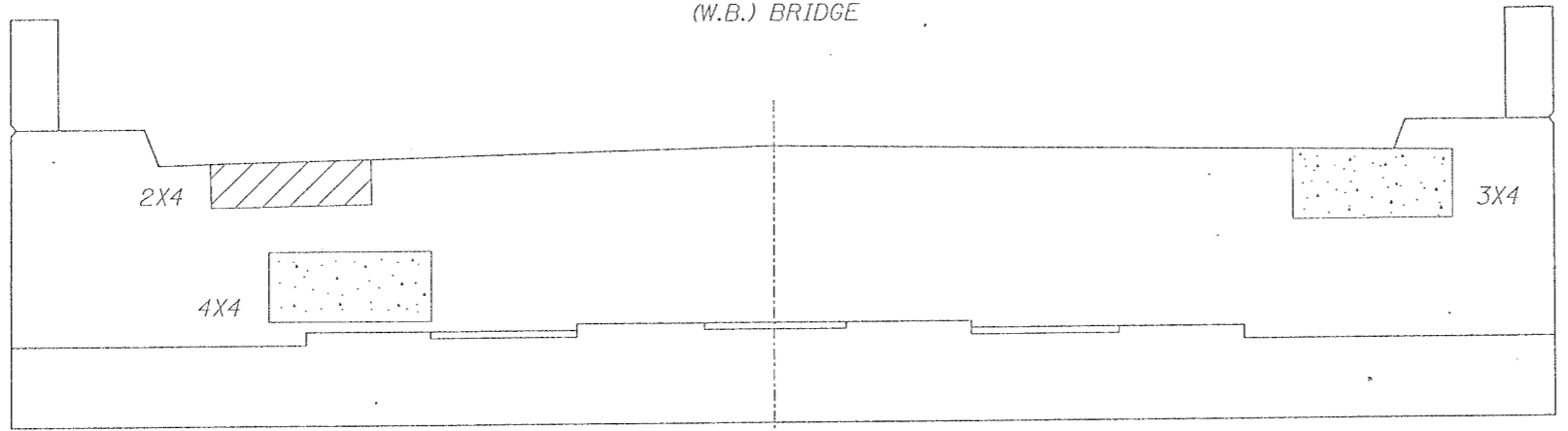

ELEVATION EAST ABUTMENT  
(W.B.) BRIDGE

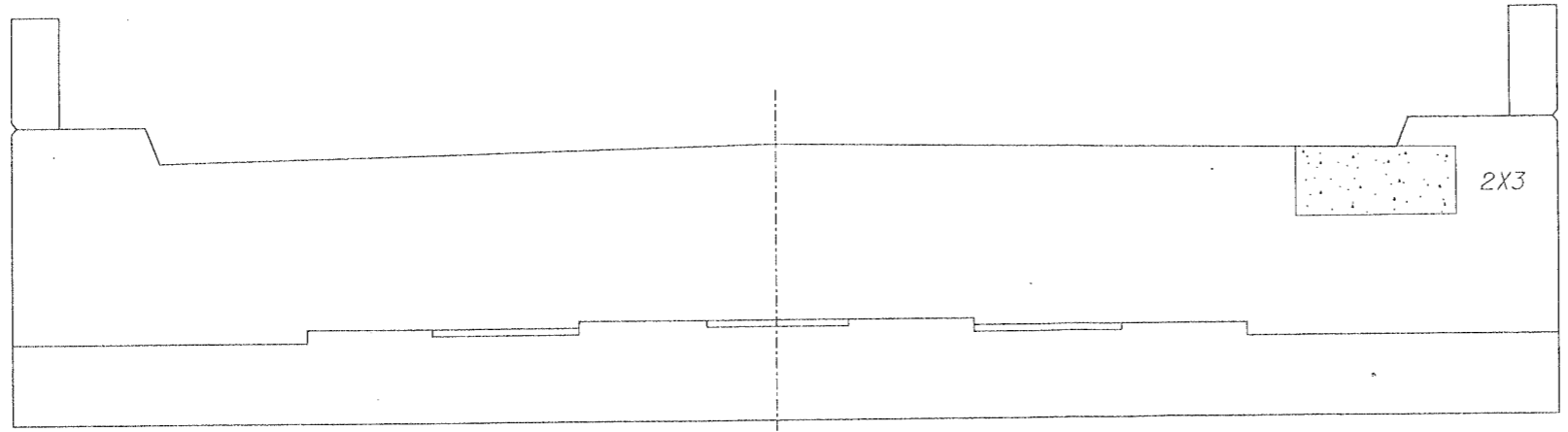

ELEVATION WEST ABUTMENT  
(E.B.) BRIDGE

LEGEND

- FORMED CONCRETE REPAIR < 5"
- FORMED CONCRETE REPAIR > 5"

BILL OF MATERIAL

Formed Concrete Repair	UNIT	TOTAL
E.B. Bridge < 5"	SQ FT	6
W.B. Bridge < 5"	SQ FT	28
> 5"	SQ FT	52

STRUCTURE NO. 049-0046 & 049-0047

REVISIONS			SUBSTRUCTURE REPAIR	
NO.	DATE	INITIALS	STATE OF ILLINOIS DEPARTMENT OF TRANSPORTATION DIVISION OF HIGHWAYS	
1			<p>IL 120 OVER DES PLAINES RIVER</p> <p><b>CHASTAIN &amp; ASSOCIATES, LLP</b> CONSULTING ENGINEERS</p> <p>8609 N. BRYN MAWR AVENUE SUITE 204 CHICAGO, ILLINOIS 60631 312-714-0050 FAX 312-714-0055</p>	
2				
3				
4				
5				
6				
7				
8				
9				
10				

FILE: I:\012\012-ep-01.dgn DATE: 3-jun-97 13:15





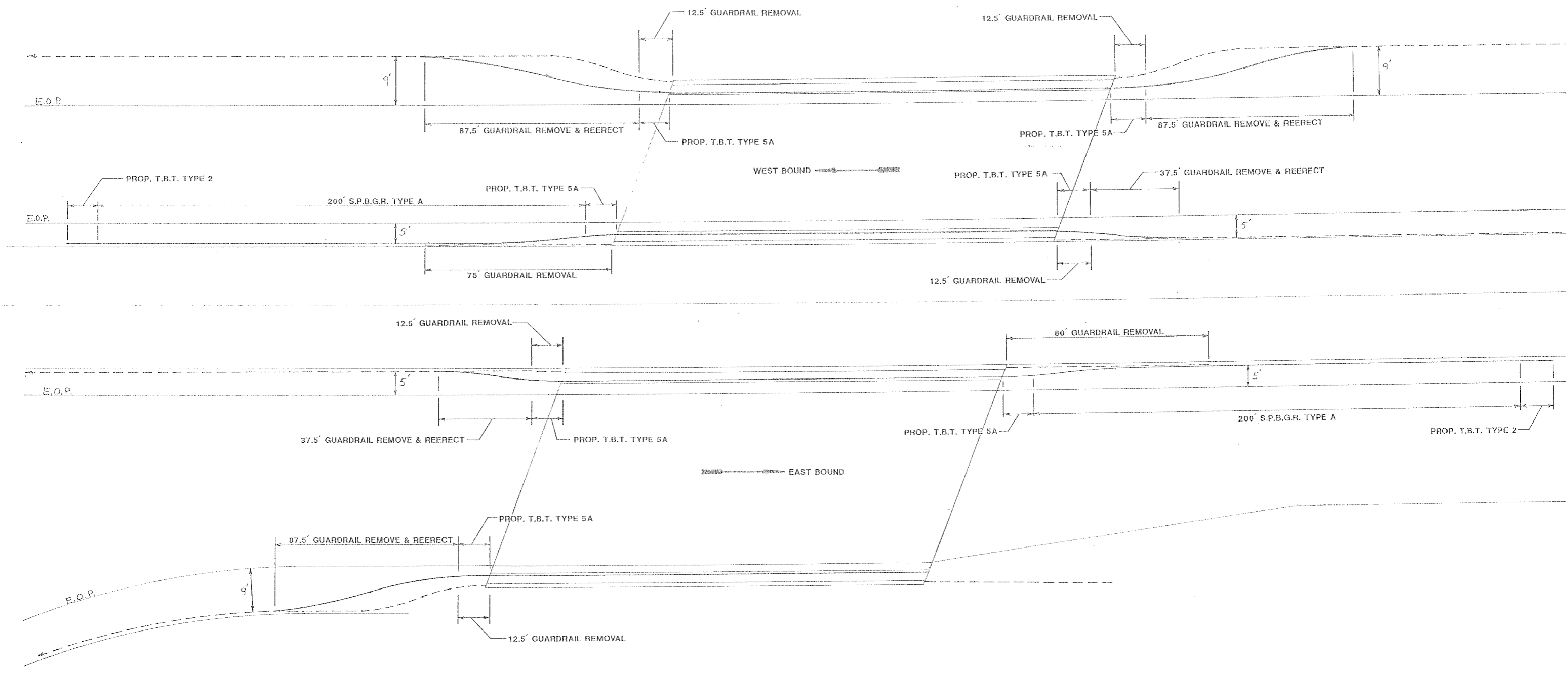

REVISIONS	
NAME	DATE

ILLINOIS DEPARTMENT OF TRANS

**GUARDRAIL PLAN**

SCALE: VERT.  
HORIZ.

DATE

DRAW  
DESIG  
CHEC

# FOR INFORMATION ONLY

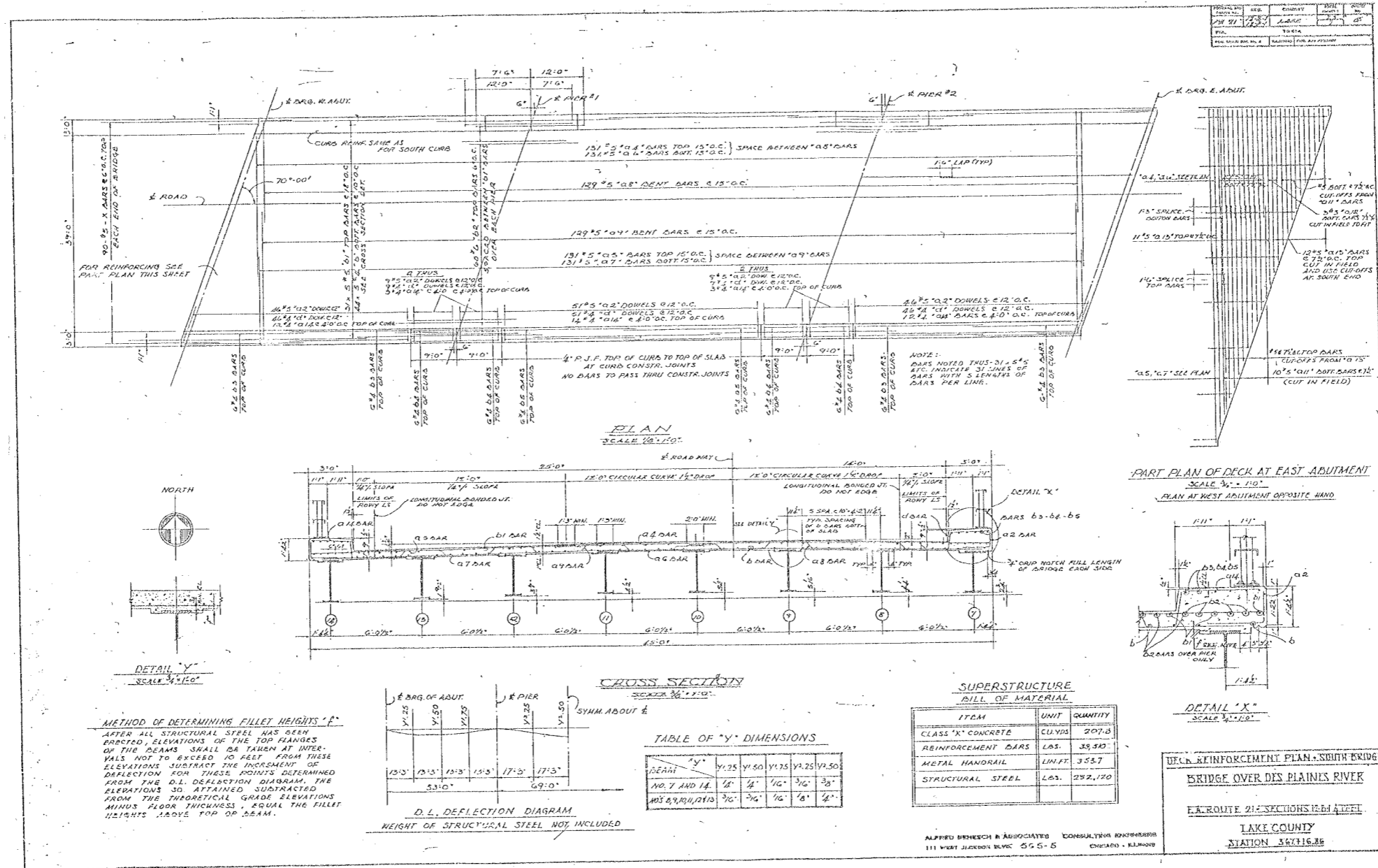

ILLINOIS DEPARTMENT OF TRANSPORTATION

SN: 049-0046

INFORMATION SHEET

SCALE: VERT. \_\_\_\_\_  
HORIZ. \_\_\_\_\_

DATE \_\_\_\_\_

DRY DESIGN CHECK

REVISIONS	
NAME	DATE

# FOR INFORMATION ONLY

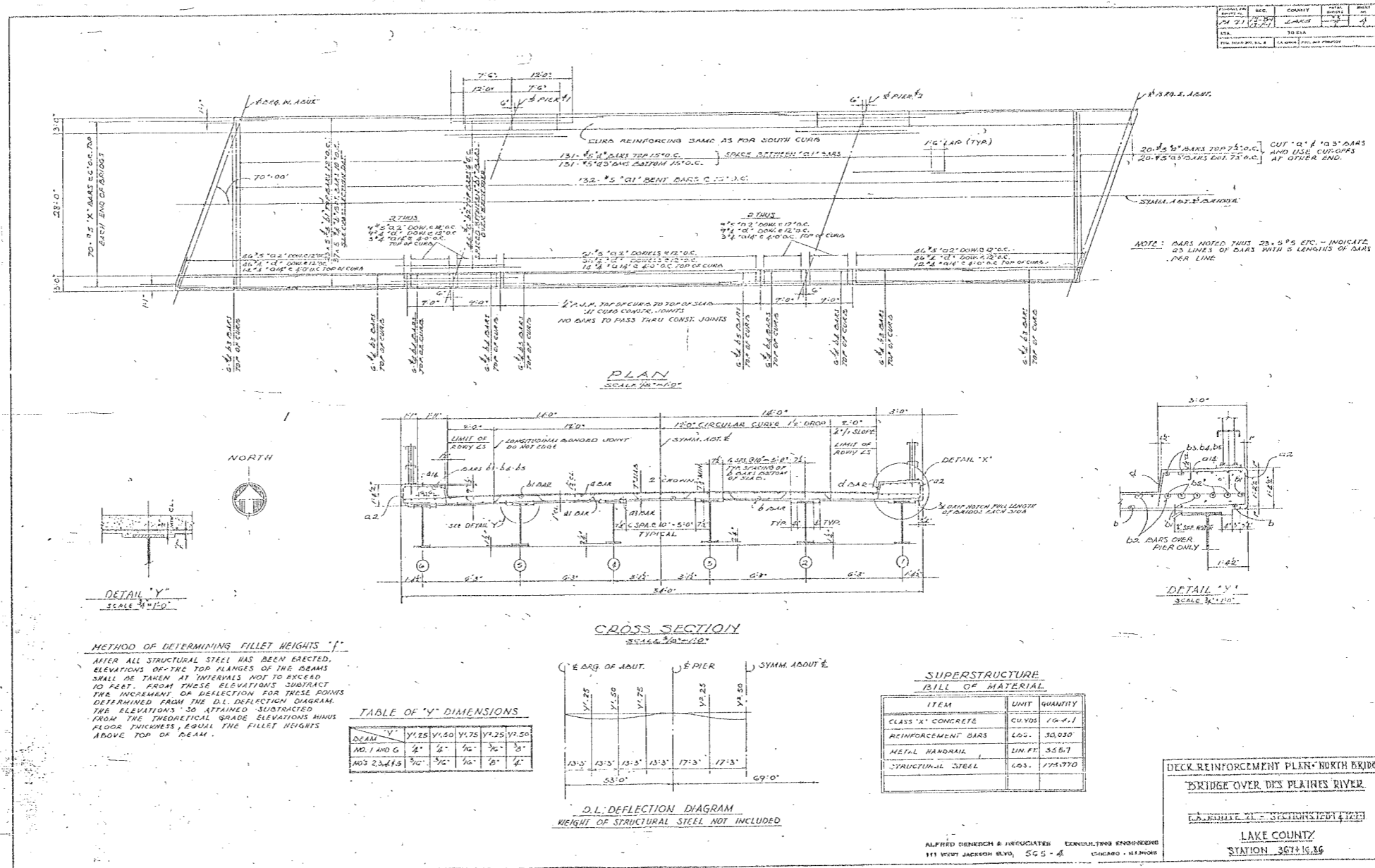

ILLINOIS DEPARTMENT OF TRANS

SN: 049-0047

INFORMATION SHEET

SCALE: VERT. HORIZ. DATE

DRAW DESIG CHECK

NAME	DATE

# FOR INFORMATION ONLY

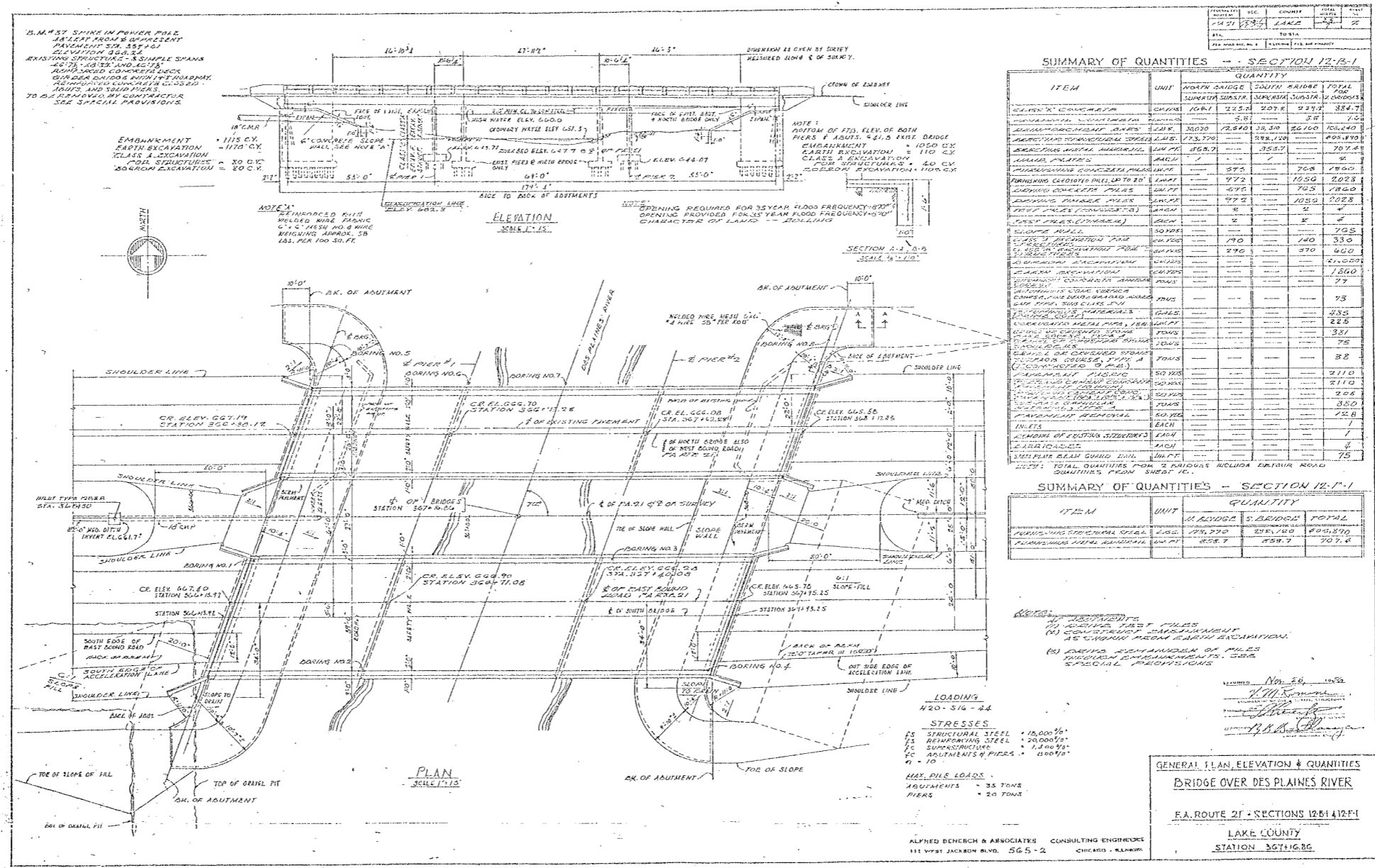

ILLINOIS DEPARTMENT OF TRANS  
SN: 049-0046 SN: 049-0

REVISIONS	
NAME	DATE

INFORMATION SHEET

SCALE: VERT.      DRAW  
HORIZ.              DESIG  
DATE                      CHECK