

STATE OF ILLINOIS
DEPARTMENT OF PUBLIC WORKS & BUILDINGS
DIVISION OF HIGHWAYS

ROUTE NO.	SECTION	COUNTY	TOTAL SHEETS	SHEET NO.	SHEET NO. / 2 SHEETS
S.B.I. 3	6X-1	CASS	108	98	
F.A.		BLANDS		TEL. RD. PROJECT	

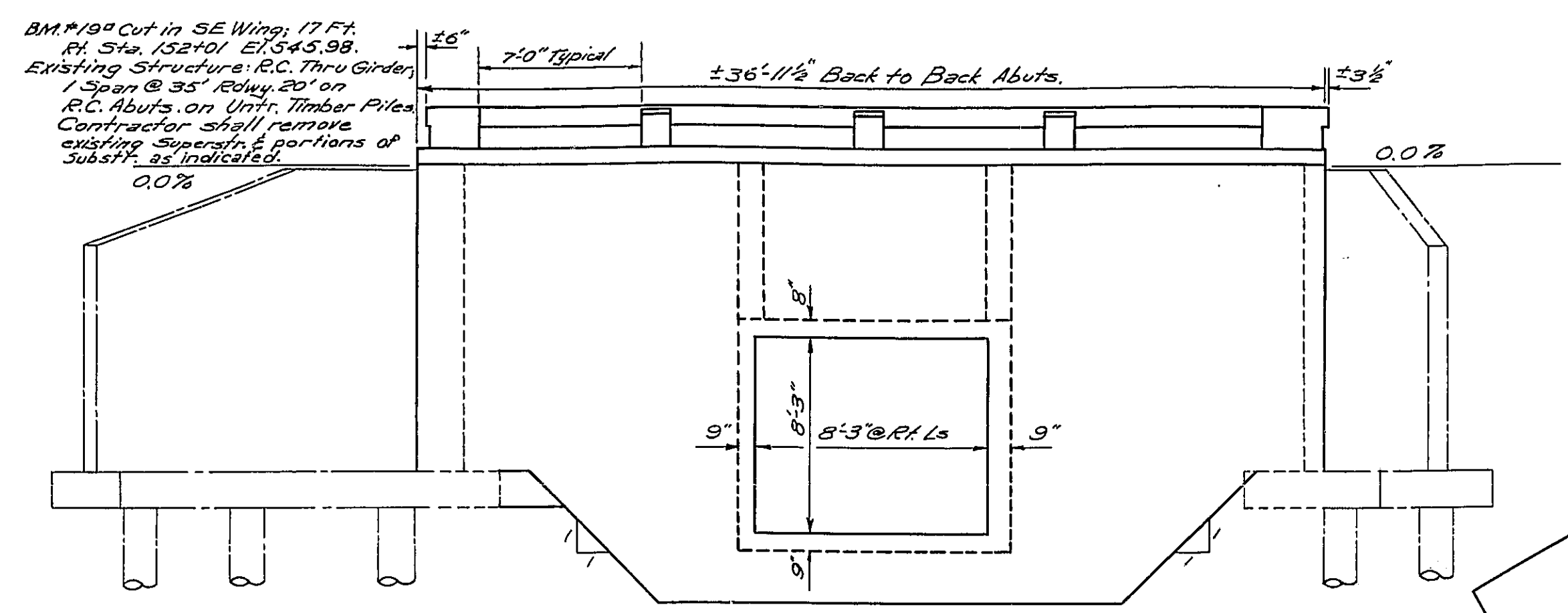

ELEVATION

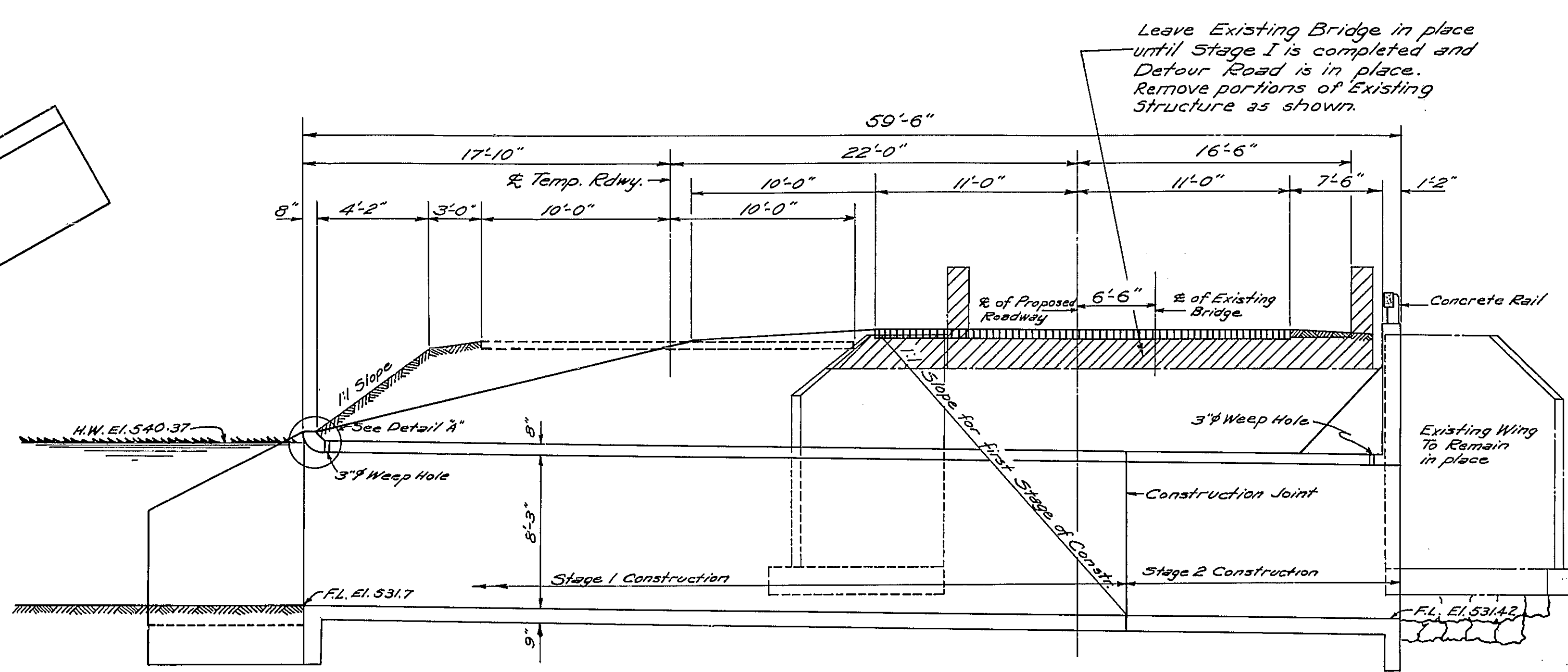

CROSS SECTION
At Right Angles to R. of Roadway

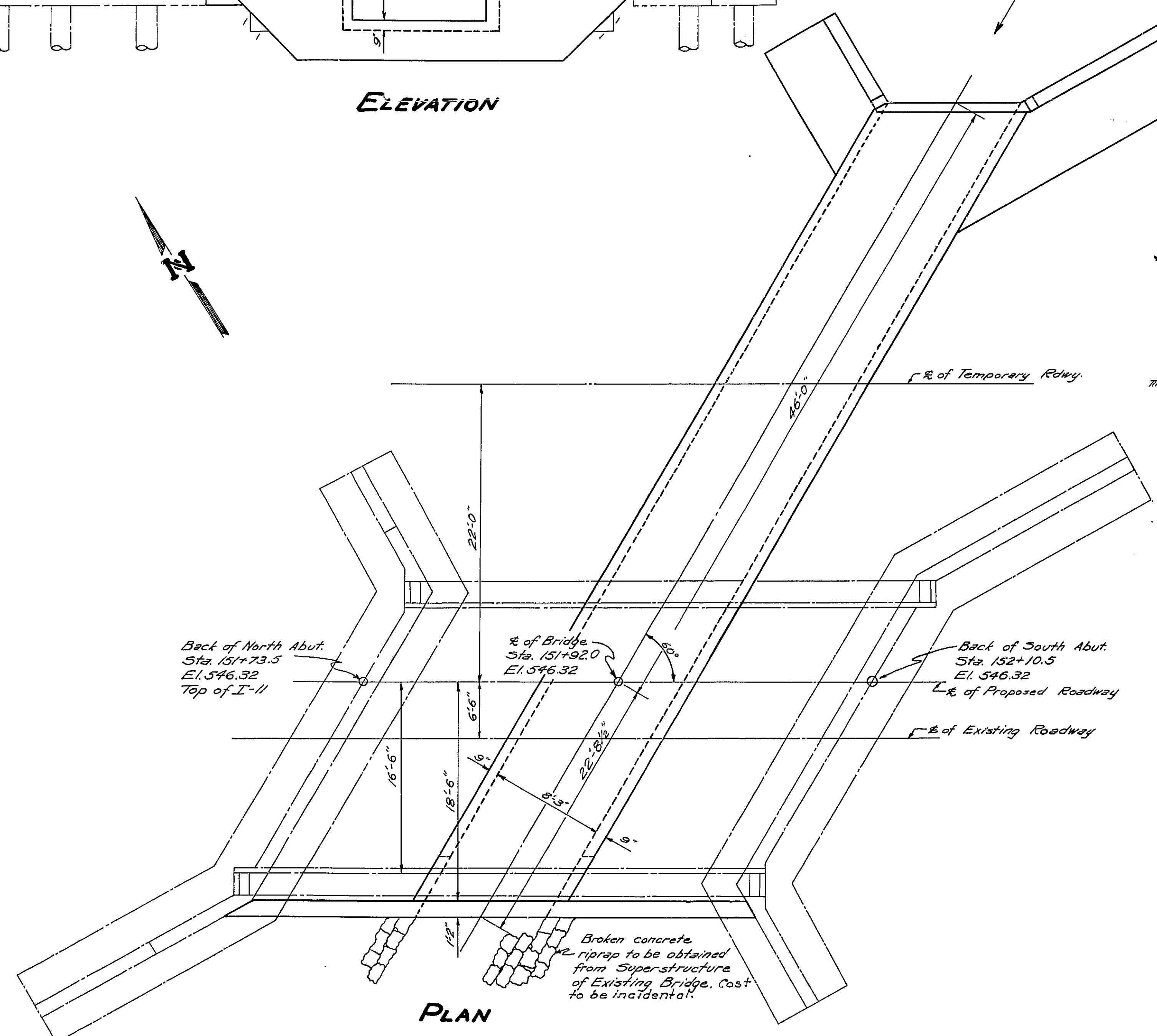

PLAN

WATERWAY INFORMATION

Drainage Area	218 Acres
Character	Rolling & Cultivated
Required Opening	63 Sq. Ft.
Present Opening	160 Sq. Ft.
Proposed Opening	68 Sq. Ft.

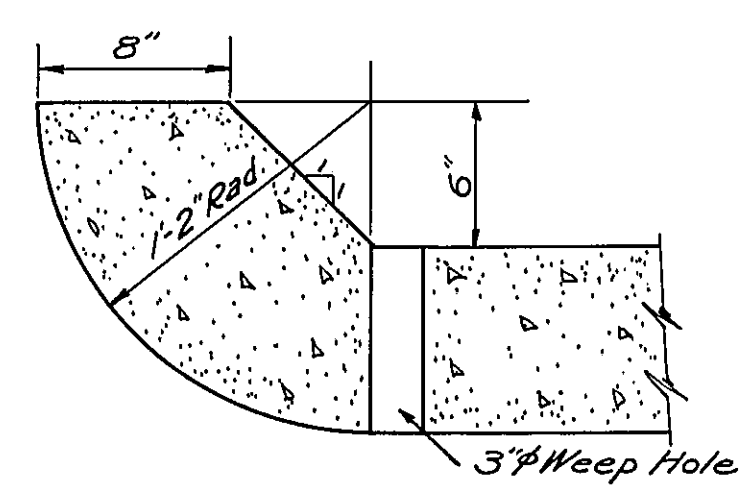

DETAIL "A"

STRESSES
fc = 1400 psi Barrel
fc = 500 psi Wings
fs = 20,000 psi Reinfc.
n = 10

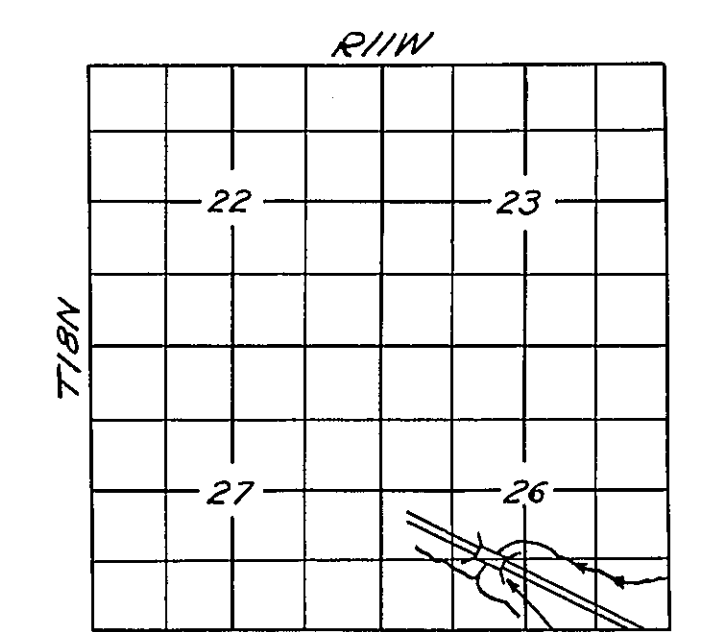

PROJECT F-46(3)
GENERAL PLAN & ELEVATION
S.B.I. RT.3 SECTION 6X-1
CASS COUNTY
STATION 151+92.0

DESIGNED	Harry P. Keenan	EXAMINED	W. E. Hanson
CHECKED	Richard D. Collins	PASSED	Edmund J. ...
DRAWN	W. A. Sausoman, Jr., E. Rush	APPROVED	R. B. ...
CHECKED	R. B. ...		

120-516-44 LOADING



STATE OF ILLINOIS
DEPARTMENT OF PUBLIC WORKS & BUILDINGS
DIVISION OF HIGHWAYS

ROUTE NO.	SECTION	COUNTY	TOTAL SHEETS	SHEET NO.
S.B.I. 3	6X-1	CASS	108	89
F.L.A.				2 SHEETS

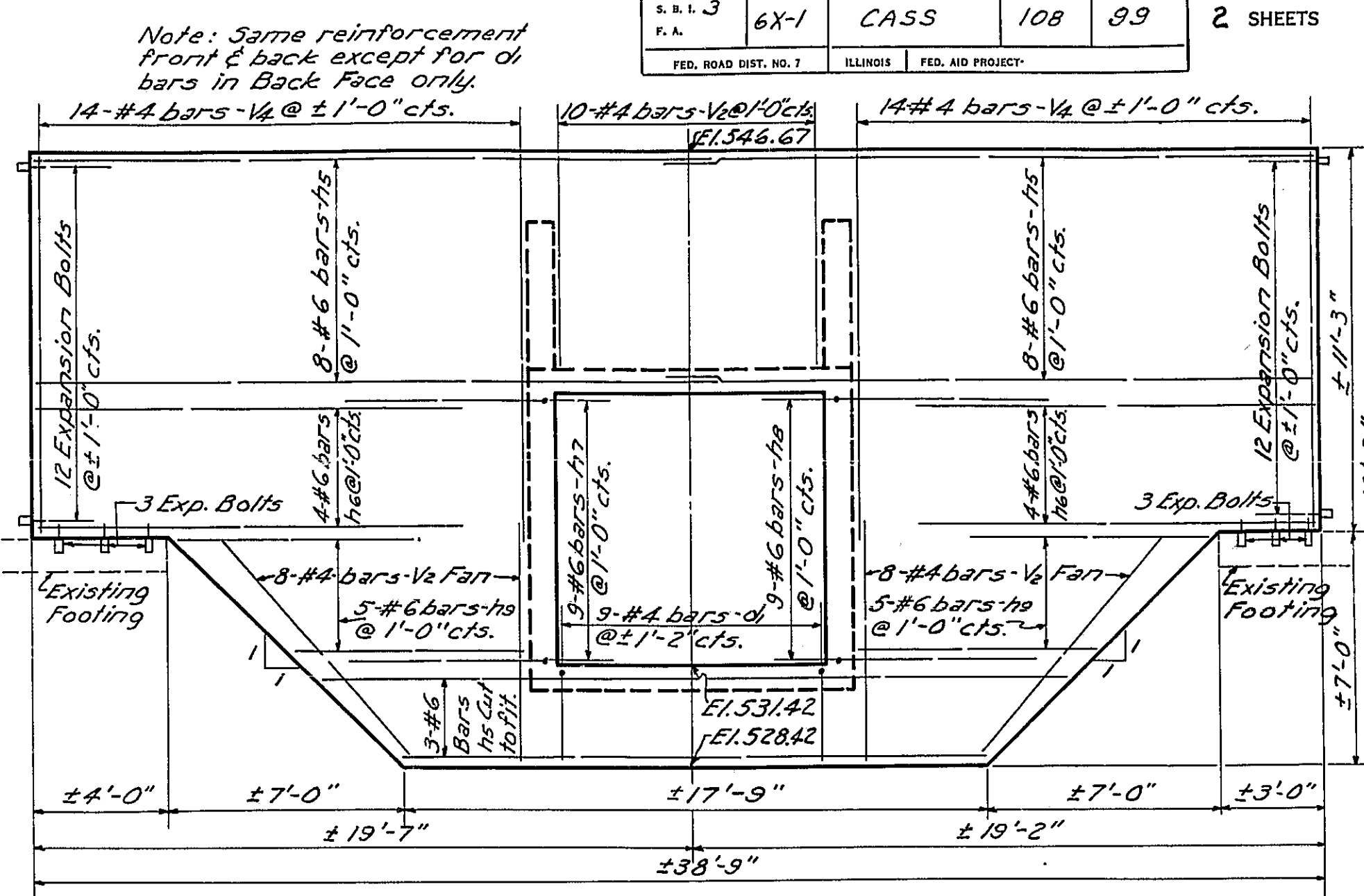
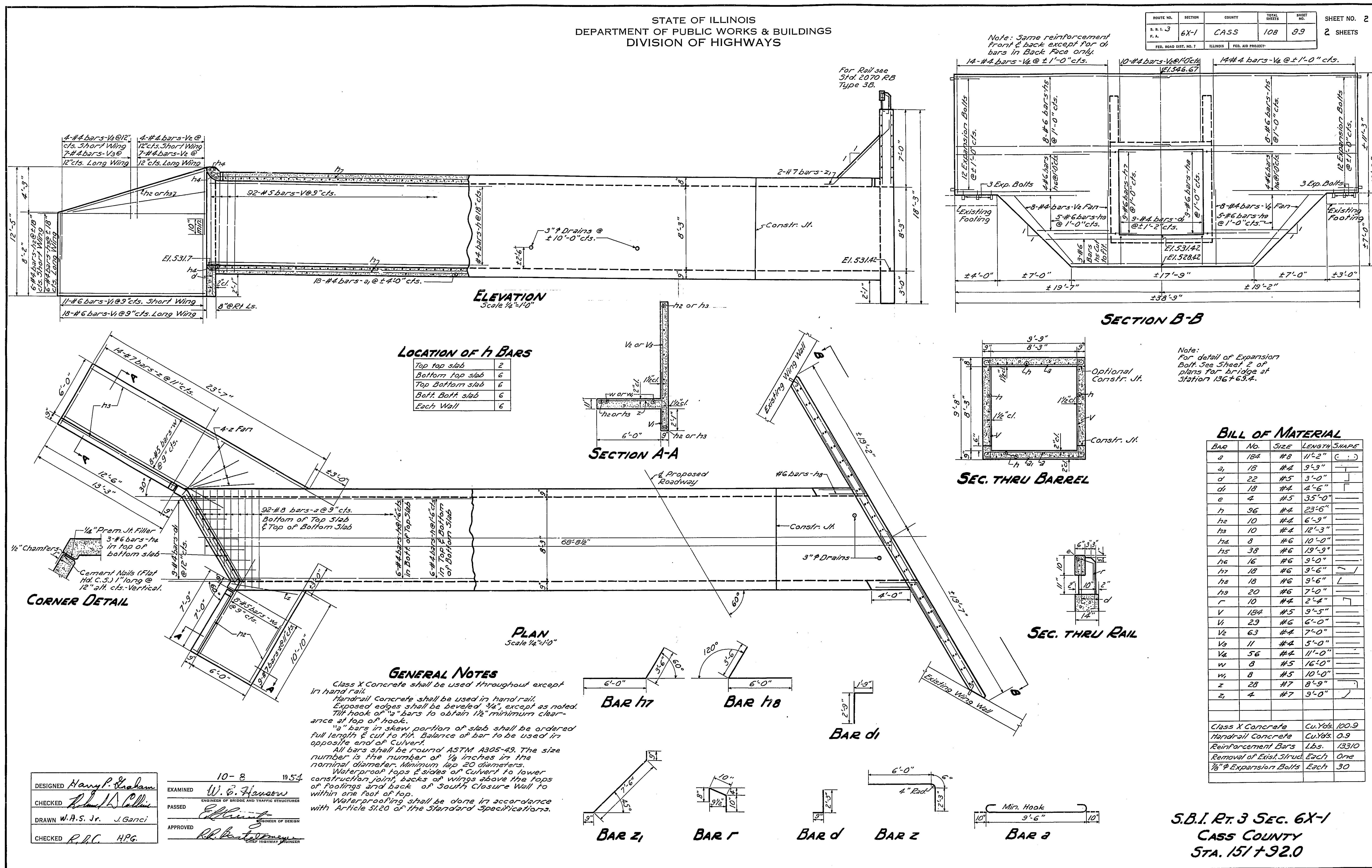

LOCATION OF h BARS

Top top slab	2
Bottom top slab	6
Top Bottom slab	6
Boff. Boff. slab	6
Each Wall	6

Note:
For detail of Expansion Bolt See Sheet 2 of plans for bridge at Station 136+63.4.

BILL OF MATERIAL

BAR	NO.	SIZE	LENGTH	SHAPE
a	184	#8	11'-2"	C.L.D.
a ₁	18	#4	9'-9"	
d	22	#5	3'-0"	
d ₁	18	#4	4'-6"	
e	4	#5	3'-0"	
h	36	#4	23'-6"	
h ₁	10	#4	6'-9"	
h ₂	10	#4	12'-3"	
h ₃	8	#6	10'-0"	
h ₄	38	#6	19'-9"	
h ₅	16	#6	9'-0"	
h ₆	18	#6	9'-6"	
h ₇	18	#6	9'-6"	
h ₈	20	#6	7'-0"	
r	10	#4	2'-4"	
v	184	#5	9'-5"	
v ₁	29	#6	6'-0"	
v ₂	63	#4	7'-0"	
v ₃	11	#4	5'-0"	
v ₄	56	#4	11'-0"	
w	8	#5	16'-0"	
w ₁	8	#5	10'-0"	
z	28	#7	8'-9"	
z ₁	4	#7	9'-0"	

Class X Concrete	Cu.Yds.	100.9
Handrail Concrete	Cu.Yds.	0.9
Reinforcement Bars	Lbs.	13310
Removal of Exis. Struc.	Each	One
1/2" Expansion Bolts	Each	30

GENERAL NOTES

Class X Concrete shall be used throughout except in hand rail.

Handrail Concrete shall be used in hand rail.

Exposed edges shall be beveled 1/4" except as noted.

Tilt hook of 1/2" bars to obtain 1/2" minimum clearance at top of hook.

1/2" bars in skew portion of slab shall be ordered full length & cut to fit. Balance of bar to be used in opposite end of Culvert.

All bars shall be round ASTM A305-43. The size number is the number of 1/8 inches in the nominal diameter. Minimum lap 20 diameters.

Waterproofing shall be done in accordance with Article 5120 of the Standard Specifications.

DESIGNED	Harry P. Graham	EXAMINED	W. G. Flanagan
CHECKED	R. D. Collins	PASSED	[Signature]
DRAWN	W. A. S. Jr. J. Ganci	APPROVED	[Signature]
CHECKED	R. D. C. HPG.		

S.B.I. Rt. 3 Sec. 6X-1
CASS COUNTY
STA. 151+92.0

