

11-17-2023 LETTING ITEM 104

# STATE OF ILLINOIS DEPARTMENT OF TRANSPORTATION SAFE ROUTES TO SCHOOL

SECTION 22-00038-00-SW

JOB NO. C-97-146-23

PROJECT NO. TOG4(781)

CITY OF SULLIVAN

MOULTRIE COUNTY, ILLINOIS

CONTRACT 95941

CONTRACT #	SECTION	COUNTY	TOTAL SHEETS	SHEET NO.
95941	22-00038-00-SW	MOULTRIE	17	1

FOR INDEX OF SHEETS  
SEE SHEET 2

- EXISTING ADA COMPLIANT SIDEWALK
- PROPOSED REMOVE AND REPLACE SIDEWALK
- PROPOSED SIDEWALK

**LOCATION MAP**  
CITY OF SULLIVAN

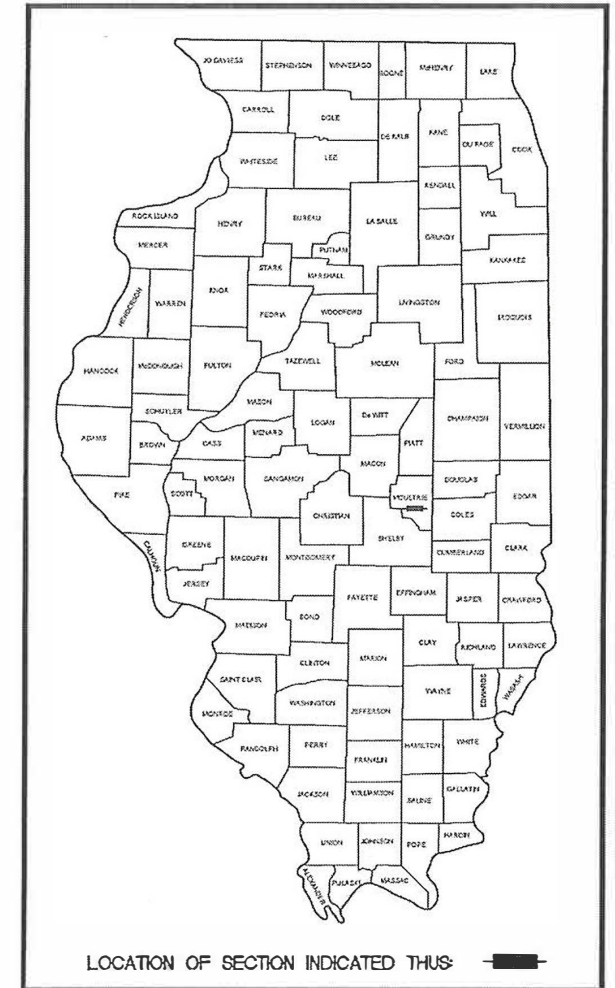

LOCATION OF SECTION INDICATED THIS

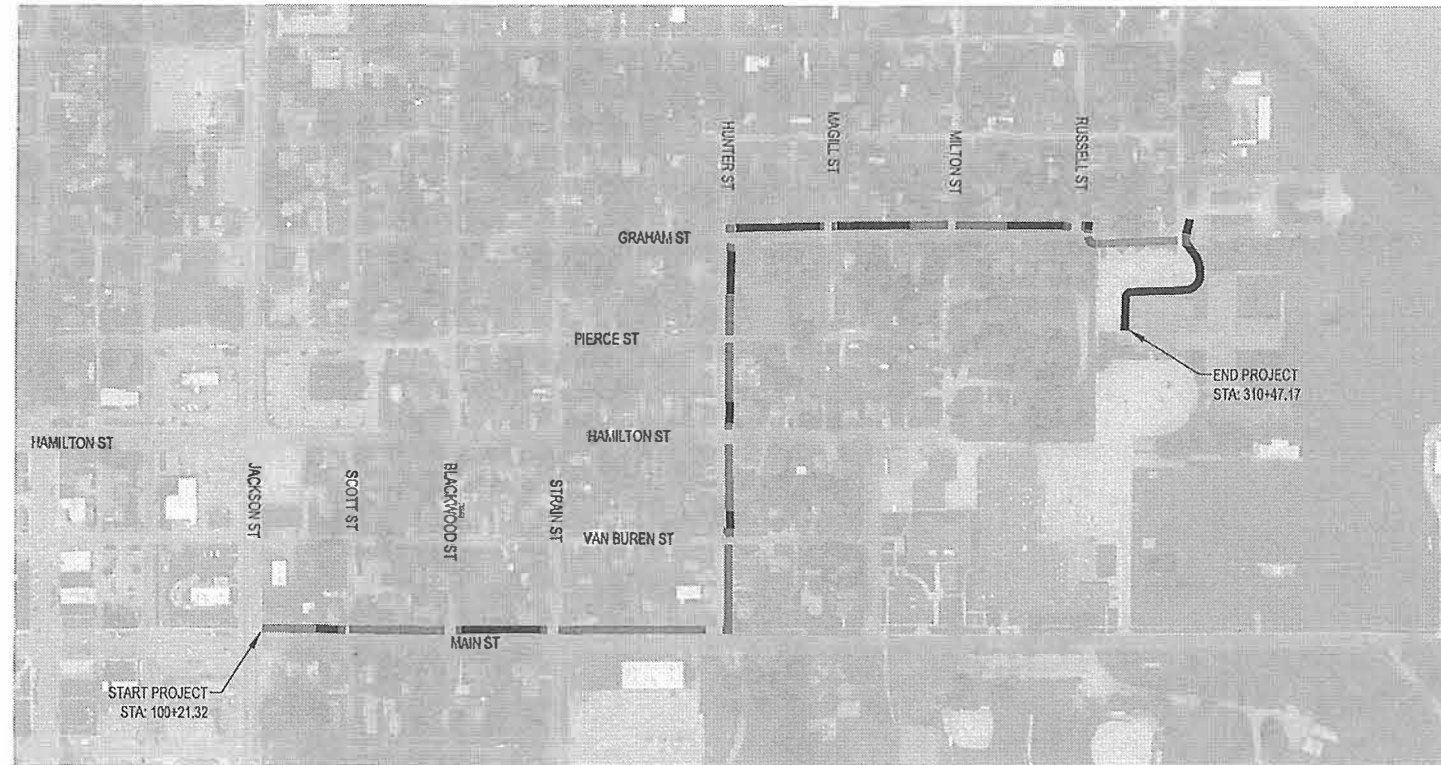
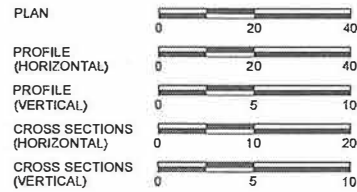

DESIGN STAGE J.U.L.I.E. DIG NUMBER  
DIG # A222494473

**J.U.L.I.E.**  
JOINT UTILITY LOCATION INFORMATION FOR EXCAVATION  
1-800-892-0123

**UTILITY NOTE**

THE LOCATIONS OF THOSE BURIED AND ABOVEGROUND UTILITIES SHOWN ARE APPROXIMATE, ARE SHOWN FOR CONTRACTOR INFORMATIONAL USE ONLY, AND ARE NOT TO BE REFERENCED FOR CONSTRUCTION PURPOSES. THE IMPLIED PRESENCE OR ABSENCE OF UTILITIES IS NOT TO BE CONSTRUED BY THE OWNER, ENGINEER, CONTRACTOR, OR SUBCONTRACTORS TO BE AN ACCURATE AND COMPLETE REPRESENTATION OF UTILITIES THAT MAY OR MAY NOT EXIST ON THE CONSTRUCTION SITE. BURIED AND ABOVEGROUND UTILITY LOCATION, IDENTIFICATION, AND MARKING ARE THE SOLE RESPONSIBILITY OF THE CONTRACTOR. REROUTING, DISCONNECTION, PROTECTION, ETC. OF ANY UTILITIES MUST BE COORDINATED BETWEEN THE CONTRACTOR, UTILITY COMPANY, AND OWNER. SITE SAFETY, INCLUDING THE AVOIDANCE OF HAZARDS ASSOCIATED WITH BURIED AND ABOVEGROUND UTILITIES, REMAIN THE SOLE RESPONSIBILITY OF THE CONTRACTOR. CONTRACTOR MUST CONTACT J.U.L.I.E. 48 HOURS PRIOR TO THE BEGINNING OF CONSTRUCTION.

Contract No. 95941

**Main Street**  
FUNCTIONAL CLASSIFICATION - Local Road/Street  
ADT (2020 Highest data) - 1550 vpd

**Hunter Street**  
FUNCTIONAL CLASSIFICATION - Local Road/Street  
ADT (2020 Highest data) - 800 vpd

**Graham Street**  
FUNCTIONAL CLASSIFICATION - Local Road/Street  
ADT (2020 Highest data) - 650 vpd

**LENGTH OF PROJECT**  
Main Street = 1,547 FEET (0.29 MILES)  
Hunter Street = 952 FEET (0.18 MILES)  
Graham Street = 1,058 FEET (0.20 MILES)  
TOTAL = 3,557 FEET (0.67 MILES)

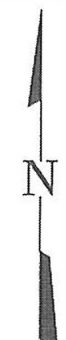

APPROVED: 9/13/23  
MAYOR, CITY OF SULLIVAN

PASSED: 23  
DISTRICT SEVEN ENGINEER OF LOCAL ROADS & STREETS

Releasing For Bid Based on Limited Review: 23  
REGION FOUR ENGINEER

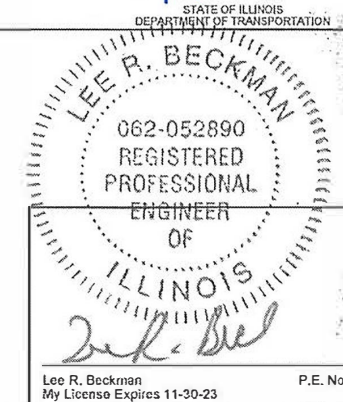

PLANS DATED:  
AUGUST 2023

<p>BY: MAS DATE: 08/16/2023 REVISIONS LISTED DESCRIPTION</p>	<p>FIELD BOOK: 818 DRAWN BY: MJB CHECKED BY: LEB FILE LOCATION: S:\2022\2023\2023\08\16\TITLEDWG SAVE DATE: 8/16/2023 11:55</p>	<p>MILANO &amp; GRUNLOH ENGINEERS, LLC 114 W. WASHINGTON AVE.   PO BOX 897 EFFINGHAM, IL 62401 Phone: (217) 347-7262   (800) 877-2714 Email: mgen@mgengineers.com Web: www.mgenengineers.com Design Firm #184-003108</p>
<p>TITLE SHEET SAFE ROUTES TO SCHOOL 22-00038-00-SW SULLIVAN, ILLINOIS</p>		<p>SHEET # 1 OF 17</p>
<p>Contract No. 95941</p>		<p>JOB # 21207BG8</p>

CONTRACT #	SECTION	COUNTY	TOTAL SHEETS	SHEET NO.
95941	22-00038-00-SW	MOULTRIE	17	2
		ILLINOIS		

### INDEX OF SHEETS

1	TITLE SHEET
2	INDEX OF SHEETS AND STANDARDS & GENERAL NOTES SHEET & DETAILS
3	SUMMARY OF QUANTITIES
4	SCHEDULE OF QUANTITIES
5	TYPICAL SECTIONS
6	BENCHMARK AND ALIGNMENT SHEET
7-10	REMOVAL SHEETS
11-17	SIDEWALK PLAN SHEETS

### STANDARDS

280001-07	Temporary Erosion Control Systems
424001-11	Perpendicular Curb Ramps for Sidewalks
424016-05	Mid-Block Cub Ramps for Sidewalks
424021-06	Depressed Corner for Sidewalks
424026-03	Entrance/Alley Pedestrian Crossings
606001-08	Concrete Curb Type B and Combination Concrete Curb and Gutter
701001-02	Off-Road Operations, 2L, 2W, More Than 15' (4.5 m) Away
701006-05	Off-Road Operations, 2L, 2W, 15' (4.5 m) to 24" (600 mm) from Pavement Edge
701011-04	Off-Road Moving Operations, 2L, 2W, Day Only
701301-04	Lane Closure, 2L, 2W, Short Tim Operations
701501-06	Urban Lane Closure, 2L 2W, Undivided
701801-06	Sidewalk, Corner or Crosswalk Closure
701901-08	Traffic Control Devices

### LEGEND

●	IRON PIN SET
○	IRON PIN FOUND
🌳	TREE (DECIDUOUS)
🔥	FIRE HYDRANT
⊕	WATER METER
⊗	VALVE (GAS OR WATER)
⊠	GAS METER
○ GAS	GAS MARKER
⊞	TELEPHONE PEDESTAL
⊞	POWER POLE
⊞	GUY ANCHOR
⊞	ELECTRIC PEDESTAL
⊞	ELECTRIC METER
⊞	STOP SIGN
⊞	STREET SIGN
○ B	BOLLARD
⊙	WOOD POST
⊙	SANITARY MANHOLE
—	SANITARY SEWER
—	STORM SEWER
— T	EXISTING TELE-COMMUNICATIONS LINE
— F	EXISTING FIBER OPTIC LINE
x 100.00	PROPOSED ELEVATION
x 100.00 FL	PROPOSED FLOWLINE ELEVATION
x 100.00	EXISTING ELEVATION
x 100.00 (M.E.G.)	(MATCH EXISTING GRADE)
IP	INLET PROTECTION
PP	PIPE PROTECTION
SF	SILT FENCE
W	WATER MAIN (EXISTING)
OHE	OVERHEAD ELECTRIC (EXISTING)
E	UNDERGROUND ELECTRIC (EXISTING)
⊙	LIGHTPOLE
⊙	ELECTRIC POLE w/ LIGHT

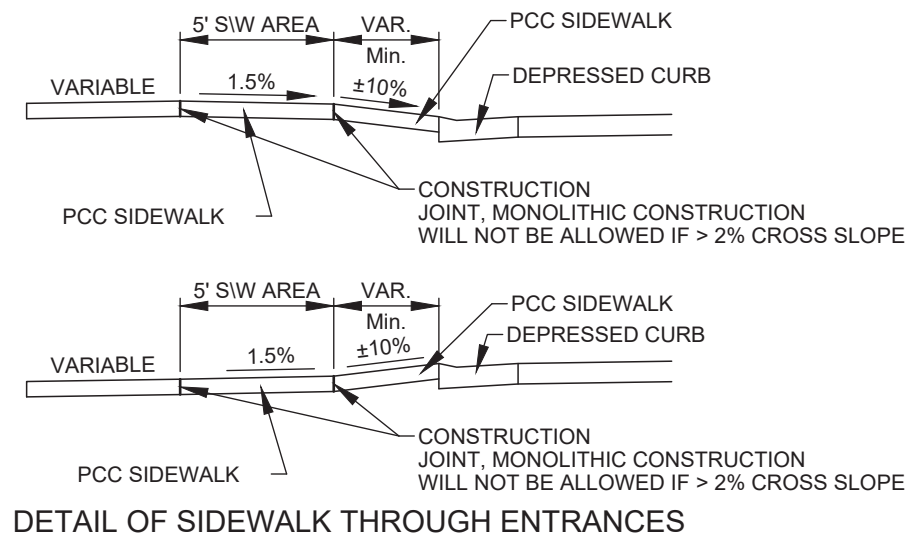

### GENERAL NOTES

- Pavement grades shown are at the top of pavement surfaces, unless otherwise noted in the plans.
- Erosion control measures shall be in accordance with IDOT Specifications. Placement shall be directed by the Engineer.
- All elevations refer to U.S.G.S. mean sea level datum. - NAVD 88
- Any reference to a standard in the plans shall be interpreted to mean the edition as indicated by the sub-number listed on Sheet 2.
- CURB AND GUTTER, WALKS, SLABS, AND PCC DRIVEWAY PAVEMENT**
  - Concrete curb and gutter shall be in accordance with IDOT Std. Spec. Locate contraction joints at 20 ft on center, unless otherwise shown. Locate expansion joints at minimum 100 ft. on center, unless otherwise shown.
  - Concrete walks shall be in accordance with IDOT Std. Spec. Unless otherwise shown, locate sidewalk contraction joints at 5 ft on center and expansions joints at 50 ft on center, unless otherwise shown, locate contraction joints in larger slabs at 15 ft intervals in each direction.
  - Concrete walks crossing through entrances shall be constructed in accordance with the detail shown on sheet 3. Monolithically constructed sidewalks will not be allowed if greater than 2% cross slope.
  - Dowel bars shall be used when Portland Cement Concrete Driveways are placed adjacent to any existing concrete. The dowel bars shall be 2 feet in length and shall be placed on 2 foot centers. Dowel bars shall not be paid for separately but shall be included in the price of the of the Portland Cement Concrete Driveway of the type and depth specified.
- The following rates of application or units were used for calculating plan quantities:
  - Aggregate Base Course, Type A - 2.05 Tons/Cu Yd

818	FIELD BOOK	DRAWN BY IMH	CHECKED BY LRB	FILE LOCATION S:\2021\21207BG8\DWG\TITLE.DWG	DATE 8/25/2023	BY TMS	REVISION/ISSUE/DATE
<b>MILANO &amp; GRUNLOH ENGINEERS, LLC</b> 114 W. WASHINGTON AVE.   PO BOX 897 EFFINGHAM, IL 62401 Phone: (217) 347-7262   (800) 677-2714 Email: mgenr@mgengineers.com Web: www.mgengineers.com Design Firm # 184-003108							
INDEX SHEET							
SAFE ROUTES TO SCHOOL 22-00038-00-SW SULLIVAN, ILLINOIS							
SHEET # 2 OF 17							
JOB # 21207BG8							

CONTRACT #	SECTION	COUNTY	TOTAL SHEETS	SHEET NO.
65941	22-00038-00-SW	MOULTRIE	17	3
		ILLINOIS		

ITEM No.	ITEM	UNIT	QUANTITY
20200100	EARTH EXCAVATION	CU YD	75
* 20100110	TREE REMOVAL (6 TO 15 UNITS DIAMETER)	UNIT	12
* 20100210	TREE REMOVAL (OVER 15 UNITS DIAMETER)	UNIT	108
28000400	PERIMETER EROSION BARRIER	FOOT	1,500
35100100	AGGREGATE BASE COURSE, TYPE A	TON	34
42300200	PORTLAND CEMENT CONCRETE DRIVEWAY PAVEMENT, 6 INCH	SQ YD	36
42400100	PORTLAND CEMENT CONCRETE SIDEWALK 4 INCH	SQ FT	9,692
42400300	PORTLAND CEMENT CONCRETE SIDEWALK 6 INCH	SQ FT	734
42400800	DETECTABLE WARNINGS	SQ FT	320
44000200	DRIVEWAY PAVEMENT REMOVAL	SQ YD	88
44000500	COMBINATION CURB AND GUTTER REMOVAL	FOOT	279
44000600	SIDEWALK REMOVAL	SQ FT	7,981
56500300	DOMESTIC METER VAULTS TO BE ADJUSTED	EACH	5
60600605	CONCRETE CURB, TYPE B	FOOT	258
60605100	COMBINATION CONCRETE CURB AND GUTTER, TYPE B-6.24 (ABUTTING EXISTING PAVEMENT)	FOOT	196
67100100	MOBILIZATION	L SUM	1
K0026830	SHRUB REMOVAL	EACH	3
X2500900	SEEDING CLASS 1, (SPECIAL)	ACRE	0.75
X7010216	TRAFFIC CONTROL AND PROTECTION, (SPECIAL)	L SUM	1
XX008958	EARTH EXCAVATION SOIL MANAGEMENT	L SUM	1

\* SPECIALTY ITEMS

DATE	BY	SCALE	PROJECT NO.	PROJECT NAME
FIELD BOOK	818	DRAWN BY	MJH	
CHECKED BY	LRB	FILE LOCATION	S:\2021\21207BG6\01\TITLE.DWG	
SAVE DATE	8/25/2023 14:55			
<b>MILANO &amp; GRUNLOH ENGINEERS, LLC</b> 114 W. WASHINGTON AVE.   PO BOX 697 EFFRINGHAM, IL 62401 Phone: (217) 347-7262   (800) 677-2714 Email: mpe@milanoandgrunloh.com Web: www.milanoandgrunloh.com Design Firm #184-003108				
SUMMARY OF QUANTITIES SAFE ROUTES TO SCHOOL 22-00038-00-SW SULLIVAN, ILLINOIS				
SHEET #				
3 OF 17				
JOB #				
21207BG6				



CONTRACT #	SECTION	COUNTY	TOTAL SHEETS	SHEET NO.
95941	22-00038-00-SW	MOULTRIE	17	5
		ILLINOIS		

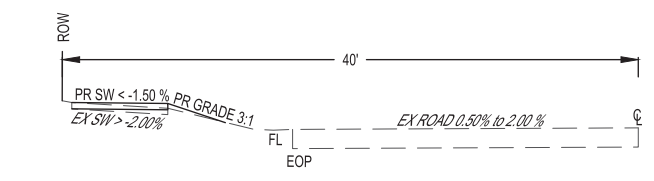

MAIN ST  
Station 100+00 to Station 101+50  
Station 102+00 to Station 105+25  
Station 107+35 to Station 111+75  
Station 112+20 to Station 112+30

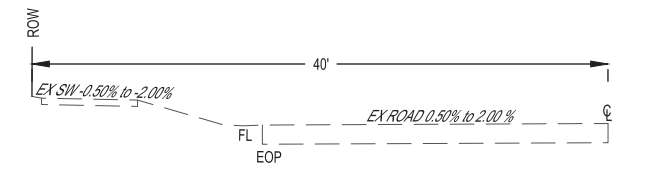

MAIN ST  
Station 101+50 to Station 102+00  
Station 105+25 to Station 107+35  
Station 111+75 to Station 112+20

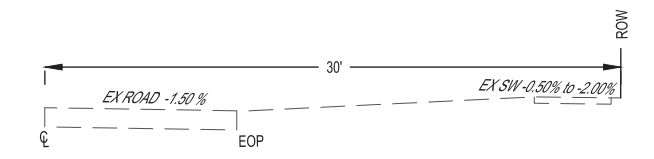

HUNTER ST  
Station 204+50 to Station 205+50

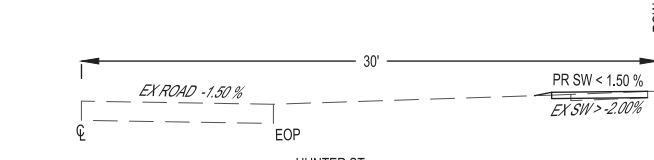

HUNTER ST  
Station 200+30 to Station 202+45  
Station 203+60 to Station 204+50  
Station 205+50 to Station 205+60  
Station 206+40 to Station 208+90  
Station 210+30 to Station 210+85

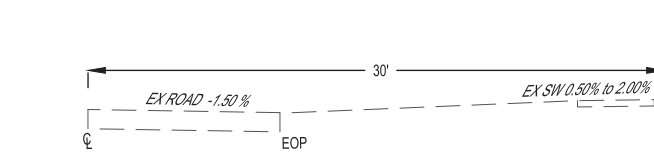

HUNTER ST  
Station 202+40 to Station 203+75  
Station 205+50 to Station 206+50  
Station 207+75 to Station 208+25  
Station 208+75 to Station 210+50

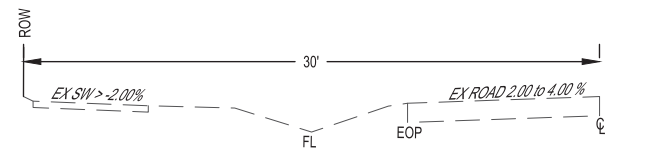

GRAHAM ST  
Station 300+30 to Station 304+85  
Station 305+60 to Station 306+10  
Station 306+15 to Station 306+65  
Station 307+40 to Station 309+00  
Station 309+10 to Station 309+65

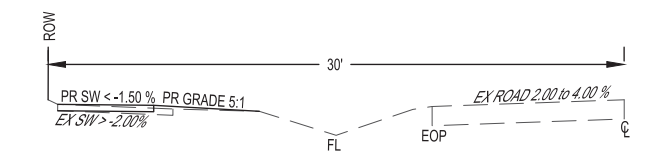

GRAHAM ST  
Station 300+10 to Station 300+30  
Station 304+85 to Station 305+60  
Station 306+10 to Station 306+15  
Station 306+65 to Station 307+40  
Station 309+00 to Station 309+10

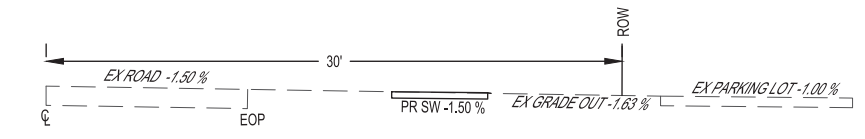

GRAHAM ST  
Station 309+65 to Station 311+75

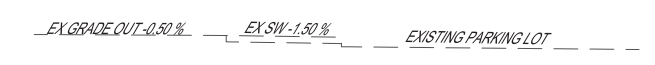

ADA COMPLIANT EXISTING SIDEWALK ALONG SCHOOL W/ OUT BLDG GRADE TOWARDS

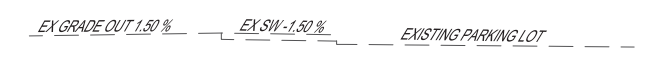

ADA COMPLIANT EXISTING SIDEWALK ALONG SCHOOL W/ OUT BLDG GRADE OUT

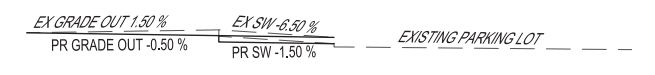

ADA COMPLIANT EXISTING SIDEWALK ALONG SCHOOL W/ OUT BLDG

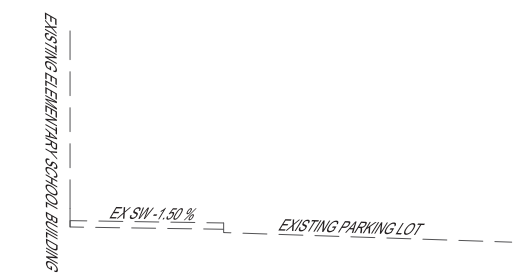

ADA COMPLIANT EXISTING SIDEWALK ALONG SCHOOL W/ BLDG

REVISION	DATE	ISSUED	BY	DATE	ISSUED	BY
	01/12/2023					
MILANO & GRUNLOH ENGINEERS, LLC						
114 W. WASHINGTON AVE.   PO BOX 897						
EFFINGHAM, IL 62401						
Phone: (217) 347-7262   (800) 677-2714						
Email: mgenr@mgengineers.com						
Web: www.mgengineers.com						
Design Firm # 184-003108						
FIELD BOOK	818	DRAWN BY	IMH	FILE LOCATION	S:\2023\2207BG8\DWG\TITLEDWG	
CHECKED BY	LRB	SAVE DATE	8/25/2023 14:55			
TYPICAL SHEET						
SAFE ROUTES TO SCHOOL						
22-00038-00-SW						
SULLIVAN, ILLINOIS						
SHEET #						
5 OF 17						
JOB #						
21207BG8						

NOTE: ALL SLOPES NOT LABELED SHALL MATCH EXISTING SLOPES

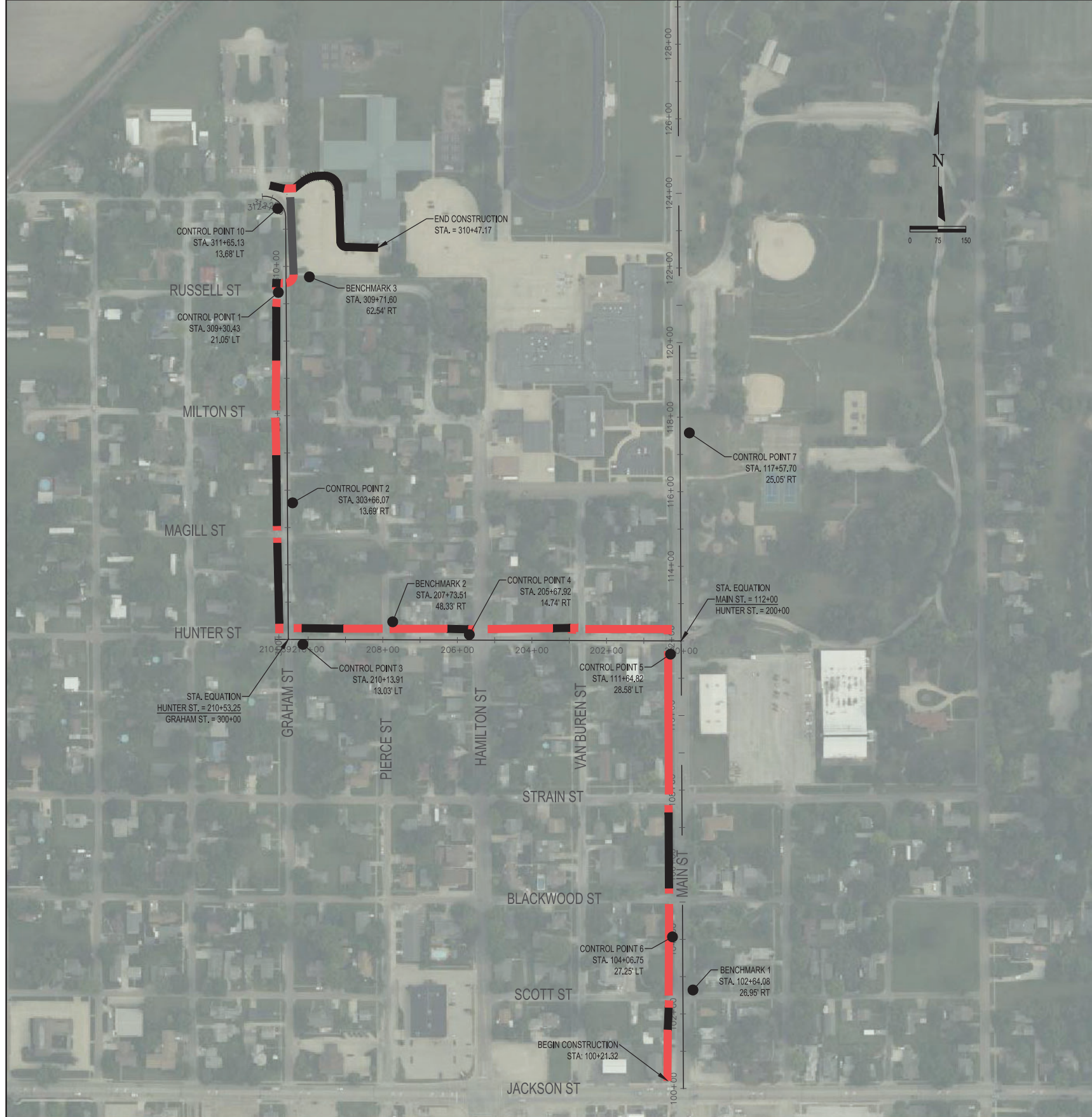

CONTRACT #	SECTION	COUNTY	TOTAL SHEETS	SHEET NO.
95941	22-00038-00-SW	MOULTRIE	17	6
		ILLINOIS		

BENCHMARKS		
BM #	ELEVATION	DESCRIPTION
BM 1	673.12	SET ON TOP CAP BOLT OF FIRE HYDRANT @ TIP OF OPEN ARROW
BM 2	679.89	SET @ FC/SW ON NORTH SIDE OF HUNTER STREET AND THE EAST SIDE OF PIERCE STREET @ ±10.5' EAST OF EOP PIERCE STREET
BM 3	680.85	SET AS SAWED "X" ON BK/SW SOUTH OF ELEMENTARY SCHOOL PARKING @ ±5' SOUTH OF BK/CB

POINT TABLE				
BM #	ELEVATION	NORTHING	EASTING	DESCRIPTION
CP 1	680.56	1070771.53	905910.49	IP
CP 2	677.00	1070207.39	905993.78	IP
CP 3	678.76	1069828.06	905976.60	IP
CP 4	678.79	1069854.08	906422.69	IP
CP 5	673.89	1069801.74	906962.15	IP
CP 6	672.39	1069043.69	906967.44	IP
CP 7	669.52	1070394.90	907012.70	IP

DATE	BY	REVISION
03/12/2023	MJS	GEOMETRICS REVIEW

FIELD BOOK	818
DRAWN BY	MJH
CHECKED BY	LRB
FILE LOCATION	S:\2021\2207\BG8\DWG\TITLE.DWG
SAVE DATE	9/11/2023 11:33

**MILANO & GRUNLOH ENGINEERS, LLC**  
 114 W. WASHINGTON AVE. | PO BOX 897  
 EFFINGHAM, IL 62401  
 Phone: (217) 947-7262 | (800) 877-2714  
 Email: mge@milanoandgrunloh.com  
 Web: www.milanoandgrunloh.com  
 Design Firm #184-003108





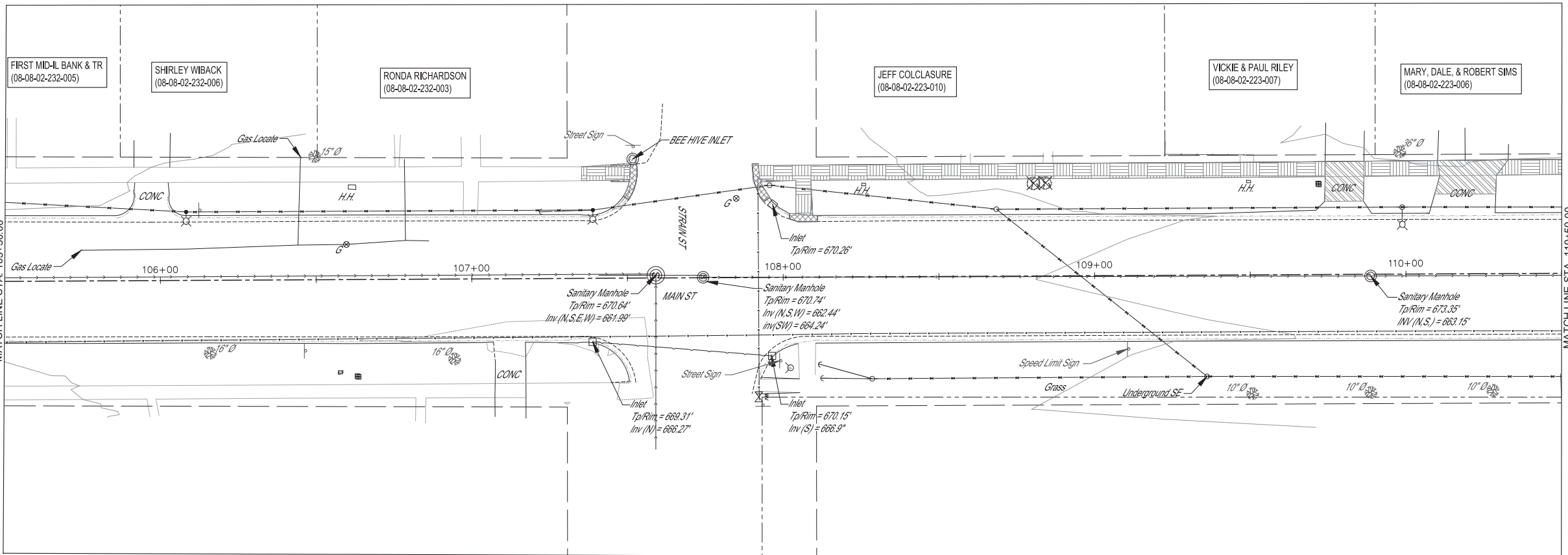
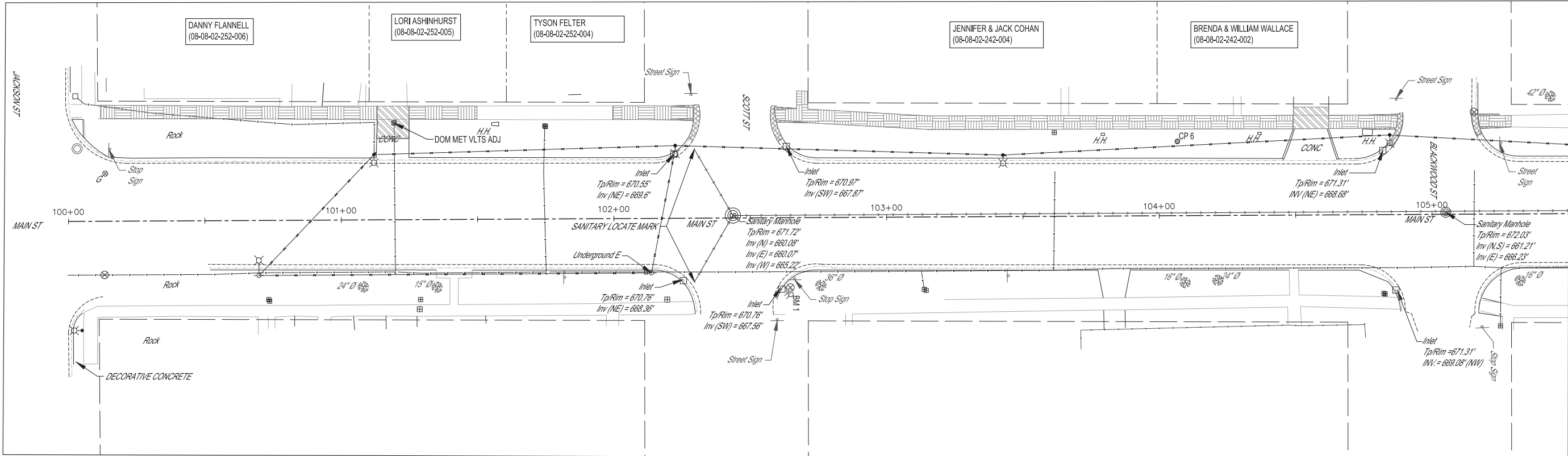
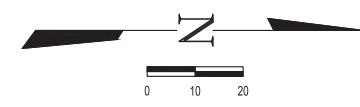

BENCHMARK AND ALIGNMENT SHEET  
 SAFE ROUTES TO SCHOOL  
 22-00038-00-SW  
 SULLIVAN, ILLINOIS

SHEET #  
6 OF 17  
 JOB #  
21207BG8

CONTRACT #	SECTION	COUNTY	TOTAL SHEETS	SHEET NO.
95941	22-00038-00-SW	MOULTRIE	17	7
		ILLINOIS		



**LEGEND**

-  4" SIDEWALK REMOVAL
-  PCC DRIVEWAY REMOVAL
-  AGGREGATE DRIVEWAY REMOVAL
-  HMA DRIVEWAY REMOVAL
-  CURB & GUTTER REMOVAL



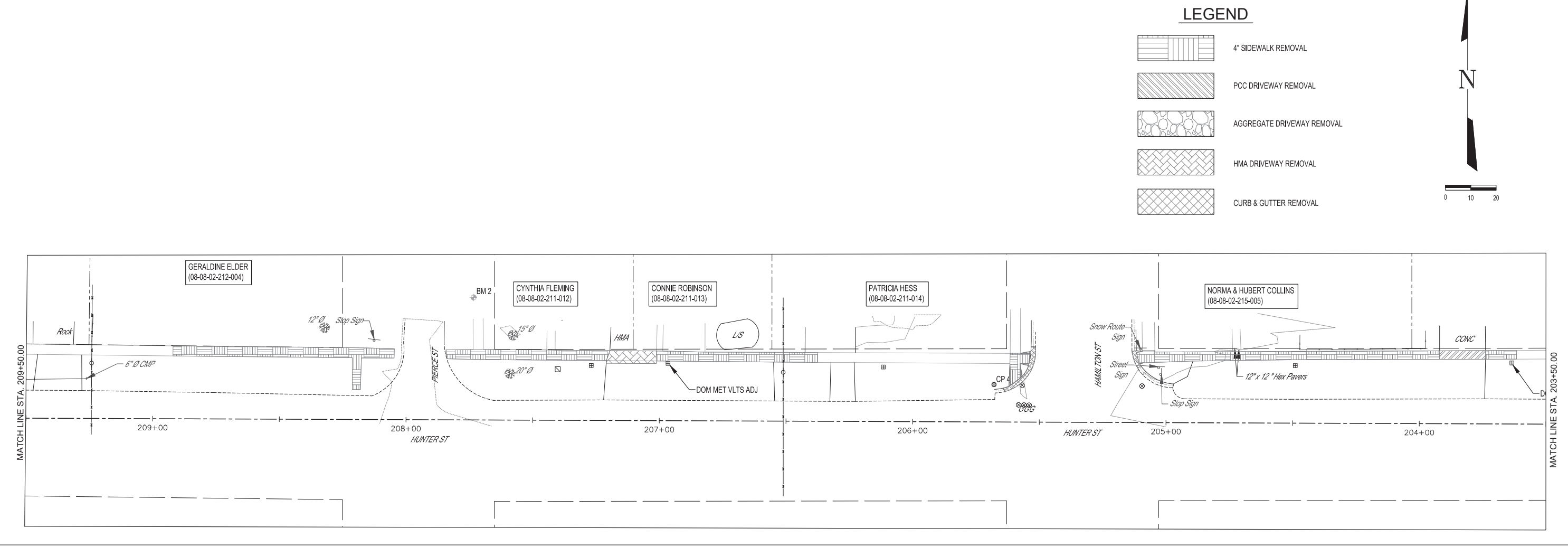
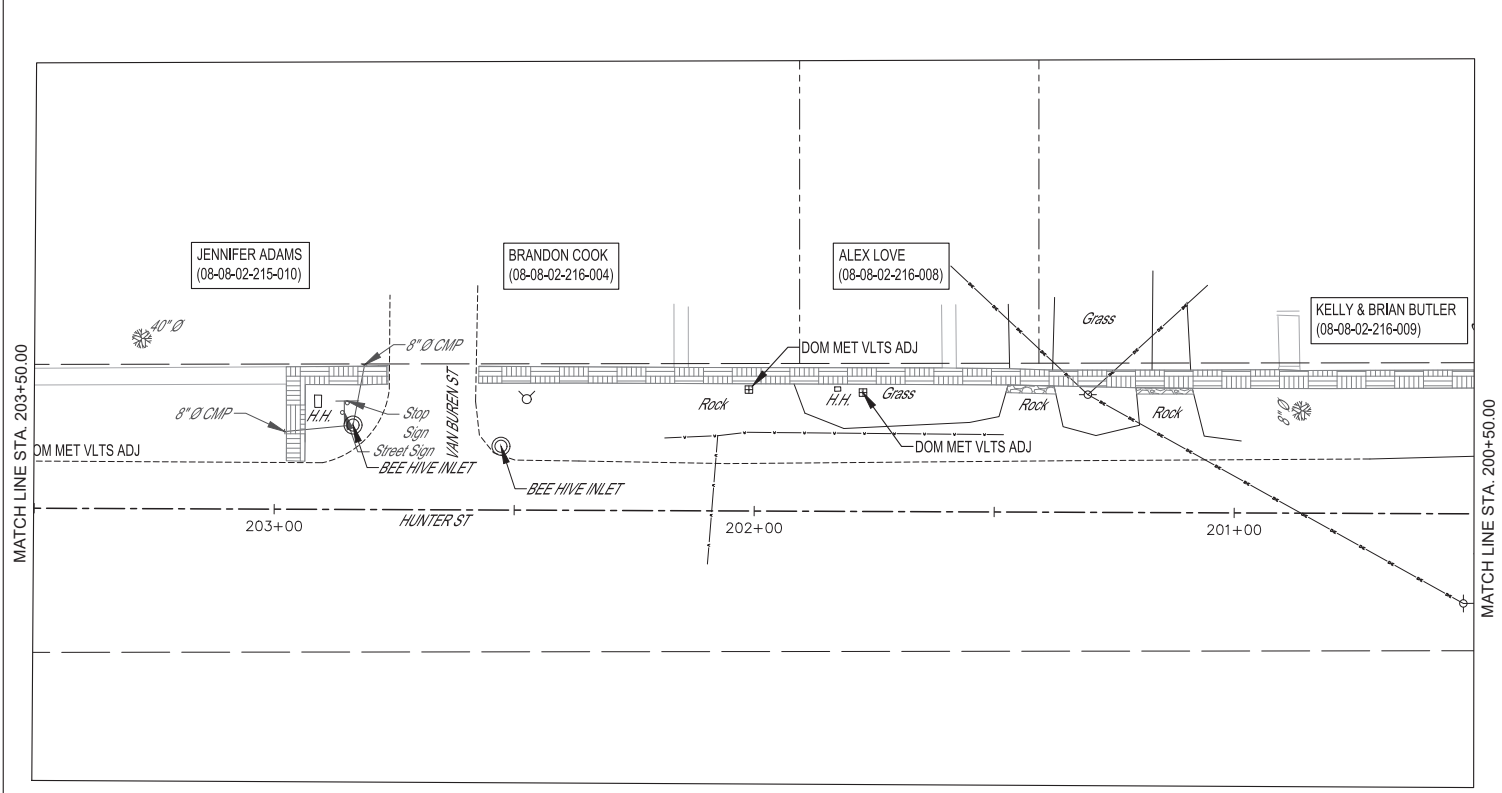
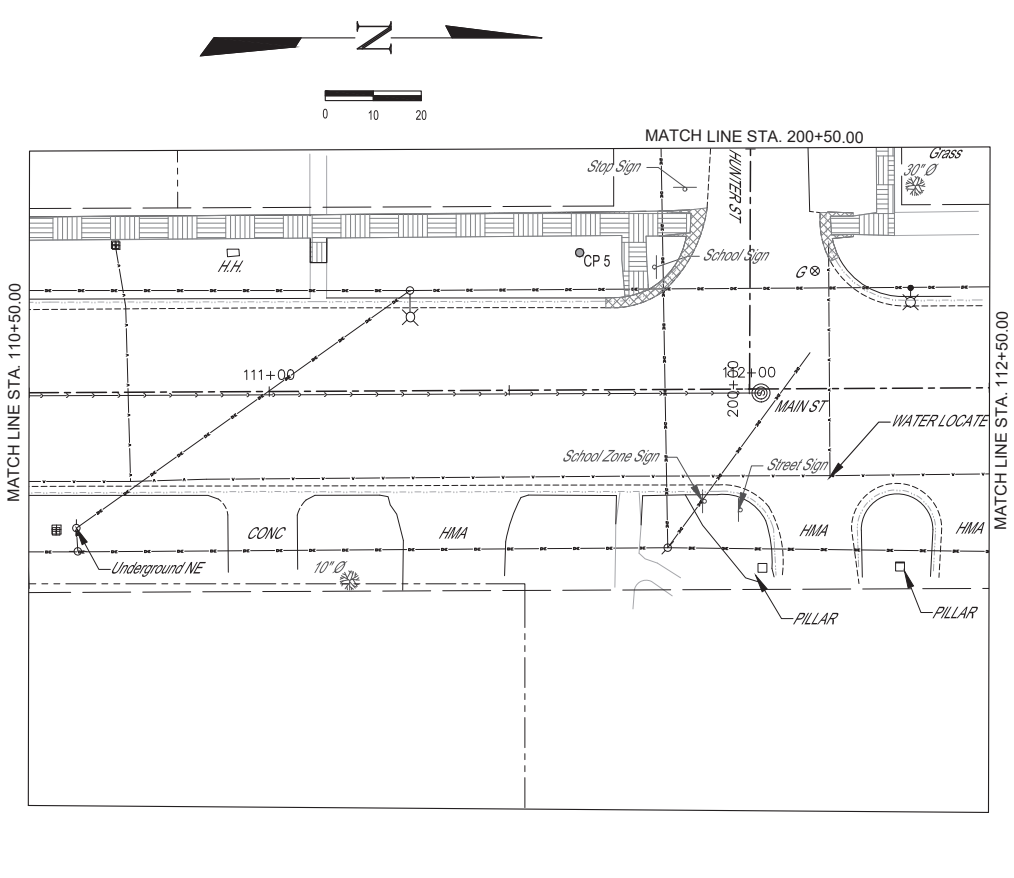

REVISION ISSUES	DATE	BY
GEOMETRICS REVIEW	04/14/2023	NMS
FIELD BOOK	818	
DRAWN BY	MJH	
CHECKED BY	LRB	
FILE LOCATION	S:\2021\22\038\DWG\REMOVAL.DWG	
SAVE DATE	8/25/2023 14:53	
<b>MILANO &amp; GRUNLOH ENGINEERS, LLC</b> 114 W. WASHINGTON AVE.   PO BOX 897 EFFINGHAM, IL 62401 Phone: (217) 347-7262   (800) 677-2714 Email: mgenr@engr.com Web: www.mgenr.com Design Firm # 184-003108		
SIDEWALK PLANS 100+00.00-110+50.00 SAFE ROUTES TO SCHOOL 22-00038-00-SW SULLIVAN, ILLINOIS		
SHEET # 7 OF 17		
JOB # 21207BG8		

CONTRACT #	SECTION	COUNTY	TOTAL SHEETS	SHEET NO.
95941	22-00038-00-SW	MOULTRIE	17	8
		ILLINOIS		

BY	DATE	REVISION / ISSUES
NMS	04/14/2023	GEOMETRICS REVIEW



**LEGEND**

-  4" SIDEWALK REMOVAL
-  PCC DRIVEWAY REMOVAL
-  AGGREGATE DRIVEWAY REMOVAL
-  HMA DRIVEWAY REMOVAL
-  CURB & GUTTER REMOVAL

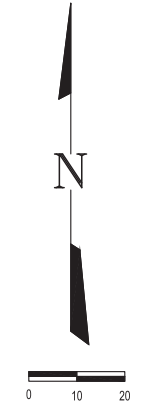

FIELD BOOK	818
DRAWN BY	MJH
CHECKED BY	LRB
FILE LOCATION	S:\2021\21207BG8\DWG\REMOVAL.DWG
SAVE DATE	8/25/2023 14:53

**MILANO & GRUNLOH ENGINEERS, LLC**  
 114 W. WASHINGTON AVE. | PO BOX 897  
 EFFINGHAM, IL 62401  
 Phone: (217) 347-7262 | (800) 677-2714  
 Email: mgeengineers@mgeengineers.com  
 Web: www.mgeengineers.com  
 Design Firm # 184-003108

SIDEWALK PLANS 110+50.00-12+50.00	SHEET #
SIDEWALK PLANS 200+00.00-203+50.00	8 OF 17
SAFE ROUTES TO SCHOOL	JOB #
22-00038-00-SW	21207BG8
SULLIVAN, ILLINOIS	





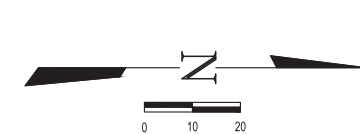
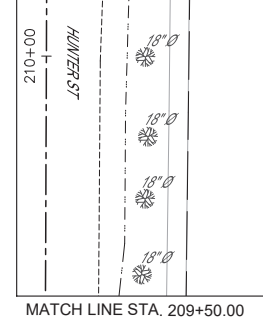
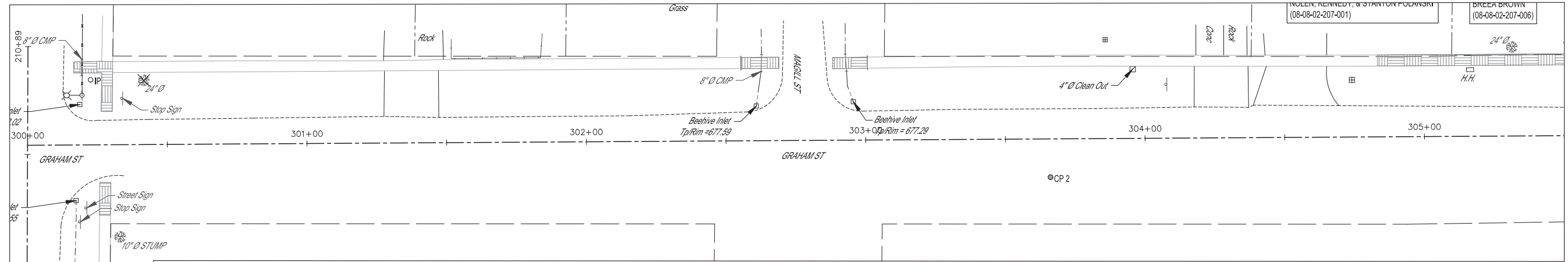

CONTRACT #	SECTION	COUNTY	TOTAL SHEETS	SHEET NO.
95941	22-00038-00-SW	MOULTRIE	17	9
		ILLINOIS		

REVISION	ISSUED	DATE	BY
GEOMETRICS REVIEW		04/14/2023	NMS



**LEGEND**

-  4" SIDEWALK REMOVAL
-  PCC DRIVEWAY REMOVAL
-  AGGREGATE DRIVEWAY REMOVAL
-  HMA DRIVEWAY REMOVAL
-  CURB & GUTTER REMOVAL

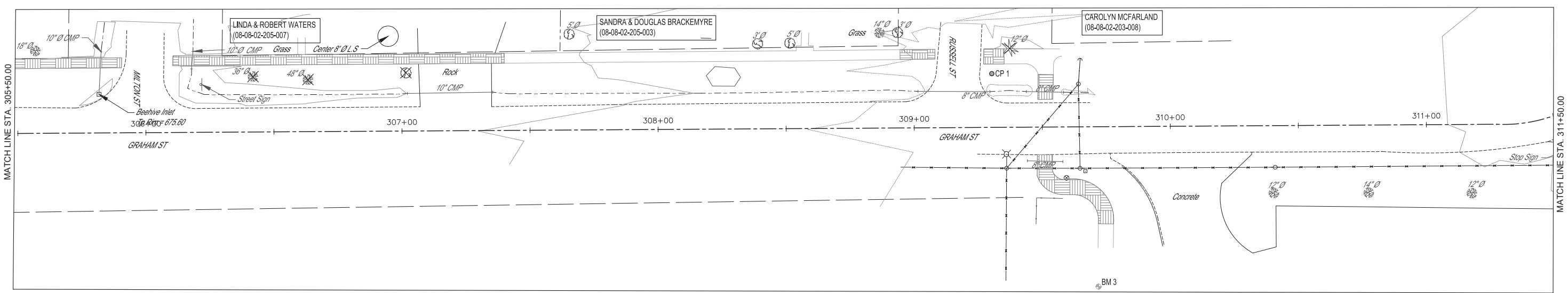

FIELD BOOK	818
DRAWN BY	MJH
CHECKED BY	LRB
FILE LOCATION	S:\2021\21207BG8\DWG\REMOVAL.DWG
SAVE DATE	8/25/2023 14:53

**MILANO & GRUNLOH ENGINEERS, LLC**  
 114 W. WASHINGTON AVE. | PO BOX 897  
 EFFINGHAM, IL 62401  
 Phone: (217) 347-7262 | (800) 677-2714  
 Email: mgen@engr.com | www.mgen.com

**LINDA & ROBERT WATERS**  
 (08-08-02-205-007)

**SANDRA & DOUGLAS BRACKEMYRE**  
 (08-08-02-205-003)

**CAROLYN MCFARLAND**  
 (08-08-02-203-008)





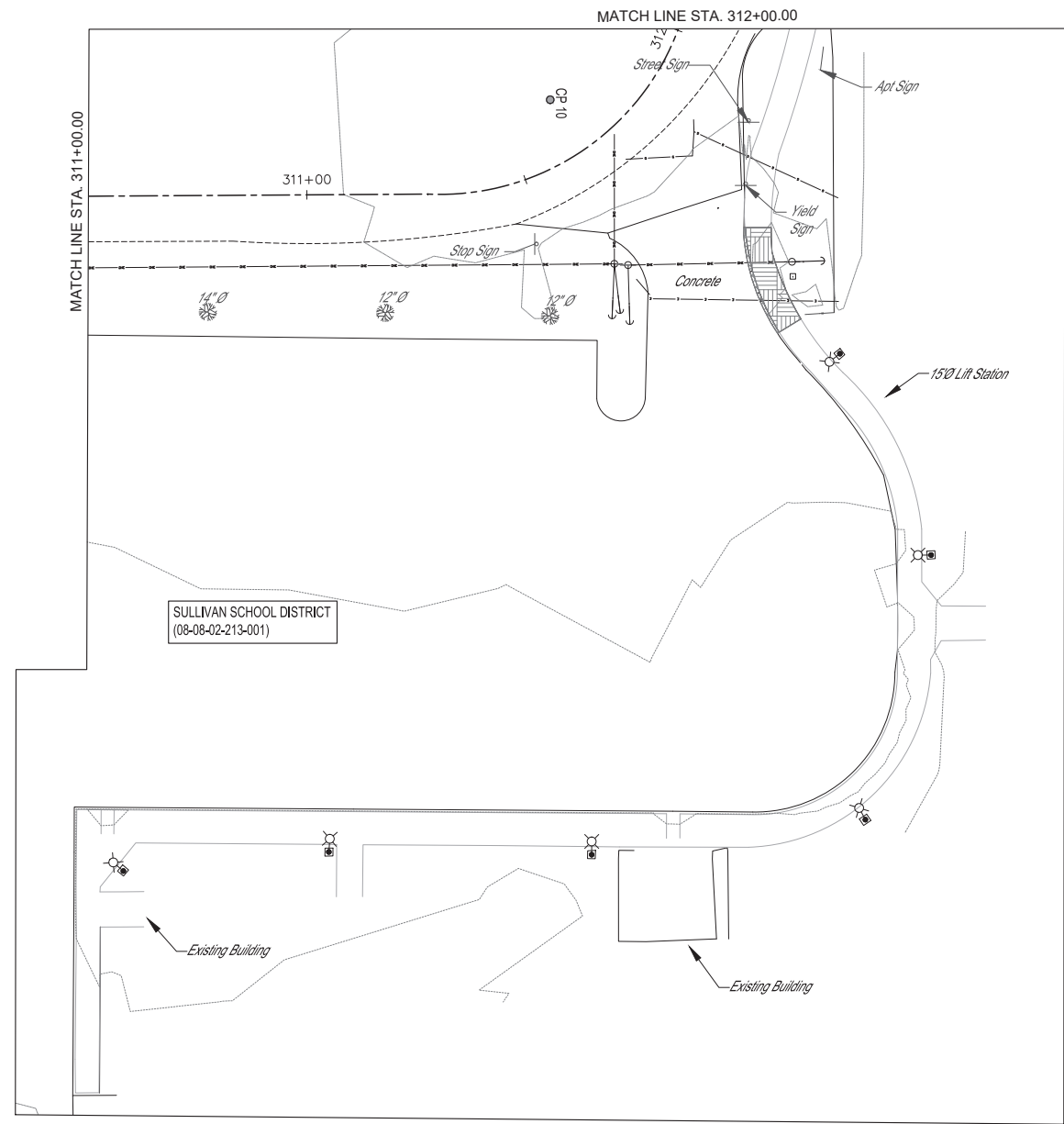
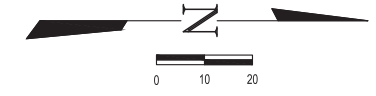

SIDEWALK PLANS 12+50.00-30+46.00  
 SAFE ROUTES TO SCHOOL  
 22-00038-00-SW  
 SULLIVAN, ILLINOIS

SHEET #  
 9 OF 17  
 JOB #  
 21207BG8

CONTRACT #	SECTION	COUNTY	TOTAL SHEETS	SHEET NO.
95941	22-00038-00-SW	MOULTRIE	17	10
		ILLINOIS		

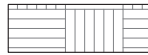

**LEGEND**

-  4" SIDEWALK REMOVAL
-  PCC DRIVEWAY REMOVAL
-  AGGREGATE DRIVEWAY REMOVAL
-  HMA DRIVEWAY REMOVAL
-  CURB & GUTTER REMOVAL

BY	DATE	REVISION	ISSUED FOR
NMS	04/14/2023		GEOMETRICS REVIEW

FIELD BOOK	818
DRAWN BY	MJH
CHECKED BY	LRB
FILE LOCATION	S:\2021\21207BG8\DWG\REMOVAL.DWG
SAVE DATE	8/25/2023 14:53

**MILANO & GRUNLOH ENGINEERS, LLC**  
 114 W. WASHINGTON AVE. | PO BOX 897  
 EFFINGHAM, IL 62401  
 Phone: (217) 347-7262 | (800) 677-2714  
 Email: mgeengineers@mgeengineers.com  
 Web: www.mgeengineers.com  
 Design Firm # 184-003108



SIDEWALK PLANS 300+00.00-310+50.00  
 SAFE ROUTES TO SCHOOL  
 22-00038-00-SW  
 SULLIVAN, ILLINOIS

CONTRACT #	SECTION	COUNTY	TOTAL SHEETS	SHEET NO.
95941	22-00038-00-SW	MOULTRIE	17	11
		ILLINOIS		

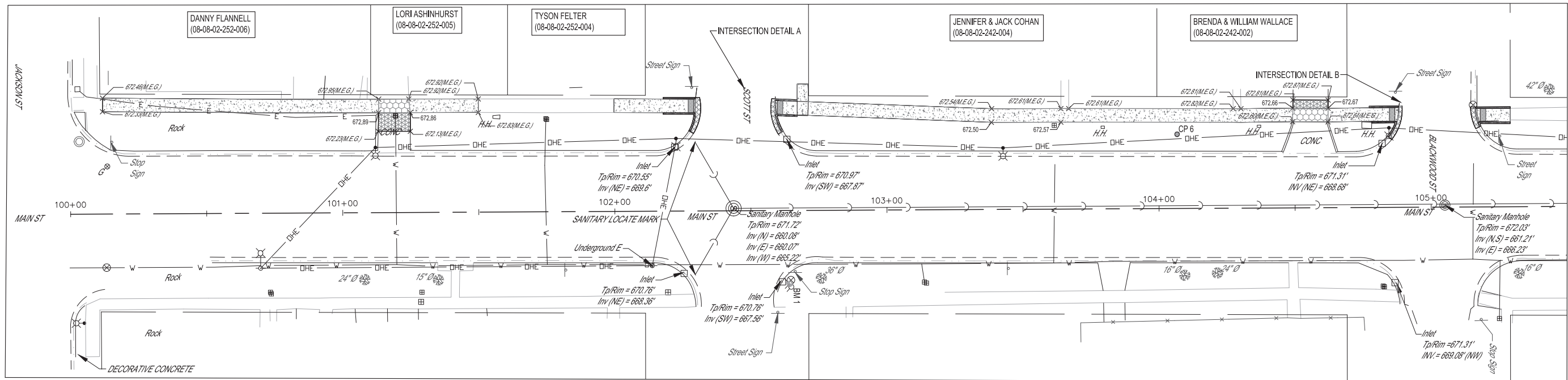

**LEGEND**

- PCC 4" SIDEWALK
- ADA DETECTABLE WARNING PANEL
- AGGREGATE BASE COURSE
- B.6-24 CURB AND GUTTER
- SIDEWALK CURB
- PCC 6" SIDEWALK
- PCC DRIVEWAY PAVEMENT

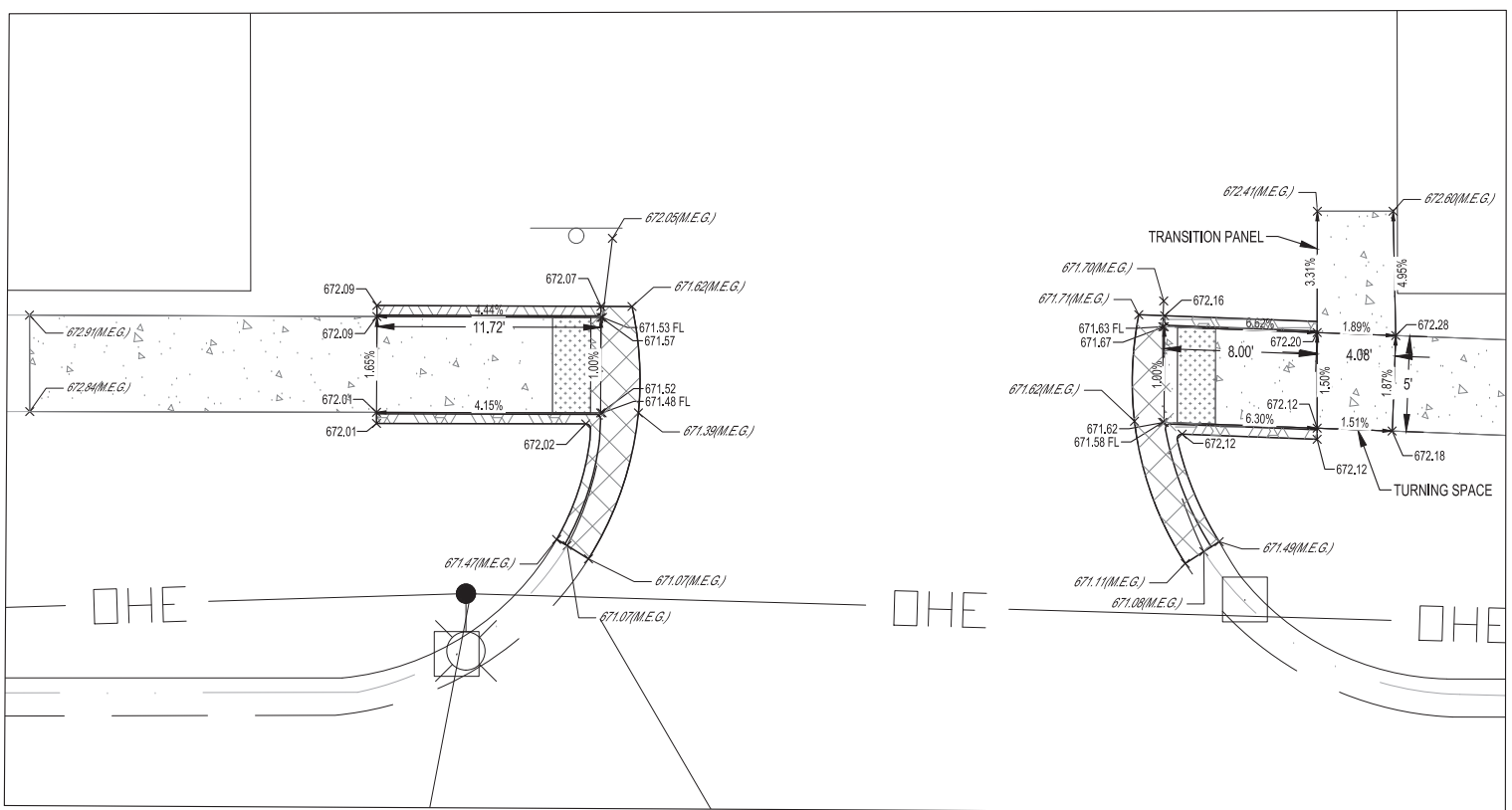
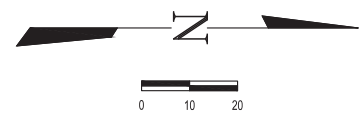

**INTERSECTION DETAIL A**  
SCALE 5:1

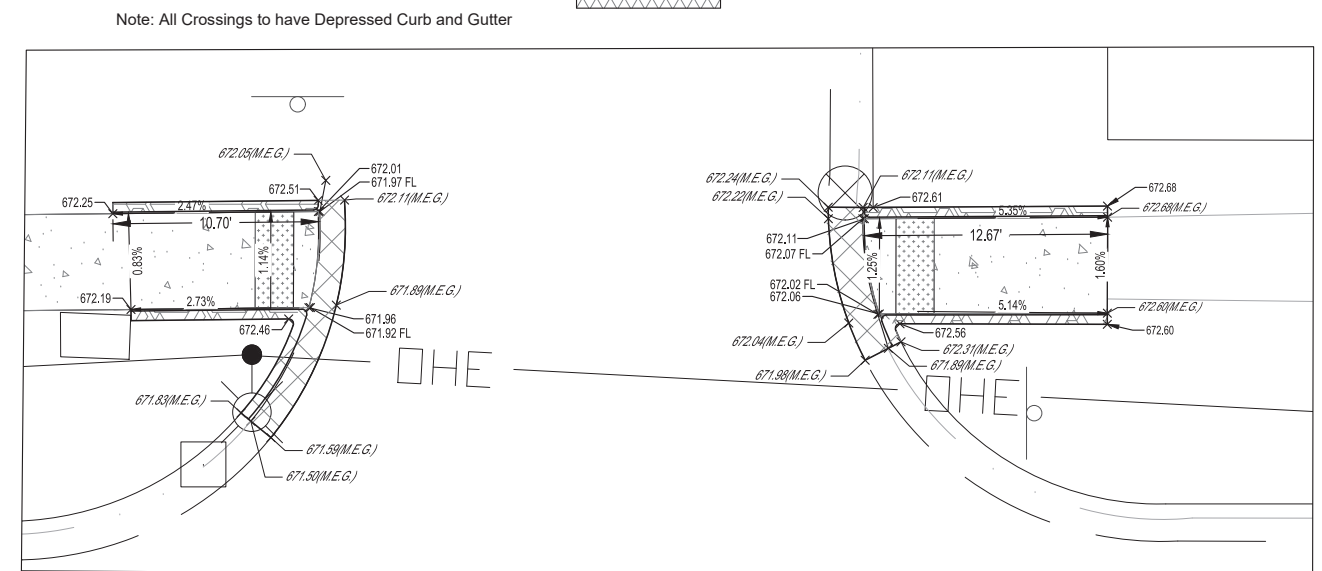

**INTERSECTION DETAIL B**  
SCALE 5:1

REVISIONS NO. DATE BY 01/14/2023 NMS	FIELD BOOK 818	DRAWN BY M.H.	CHECKED BY L.R.B.	FILE LOCATION S:\2021\22\20768\DWG\SIDEWALK.DWG
<b>MILANO &amp; GRUNLOH ENGINEERS, LLC</b> 114 W. WASHINGTON AVE.   PO BOX 897 EFFINGHAM, IL 62401 Phone: (217) 347-2662   (800) 677-2714 Email: mgeengineers@gmail.com Website: www.mgeengineers.com Design Firm # 184-003108				
SIDEWALK PLANS 100+00.00-10+50.00 SAFE ROUTES TO SCHOOL 22-00038-00-SW SULLIVAN, ILLINOIS				
SHEET # 11 OF 17 JOB # 21207BG8				

CONTRACT #	SECTION	COUNTY	TOTAL SHEETS	SHEET NO.
95941	22-00038-00-SW	MOULTRIE	17	12
		ILLINOIS		

BY	DATE	REVISION / ISSUED FOR
NMS	04/14/2023	GEOMETRICS REVIEW

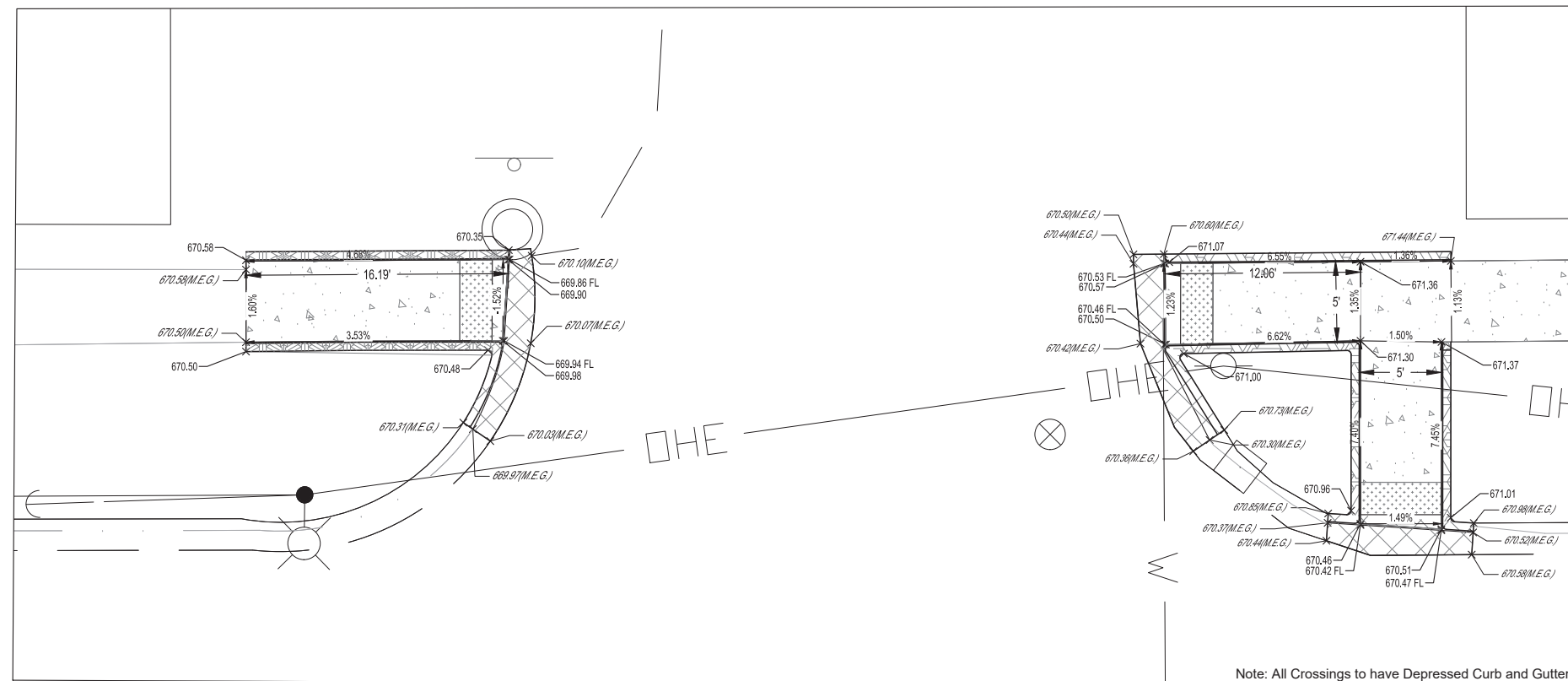
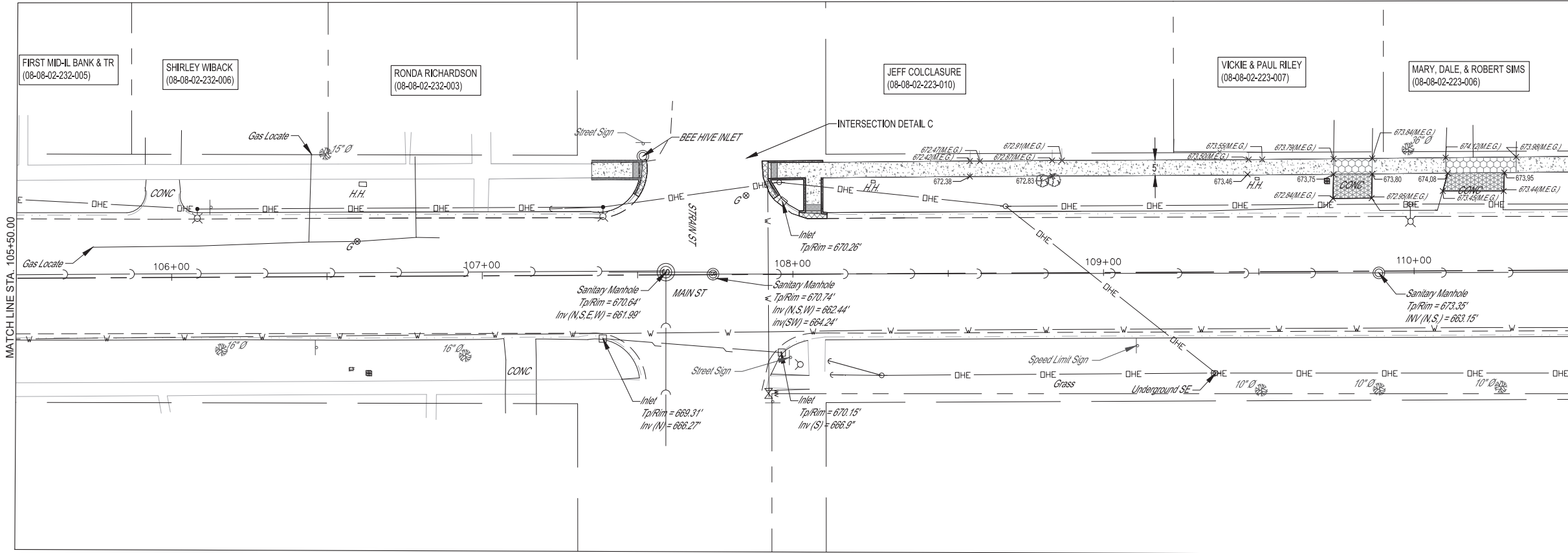

**LEGEND**

	PCC 4" SIDEWALK
	ADA DETECTABLE WARNING PANEL
	AGGREGATE BASE COURSE
	B-6-24 CURB AND GUTTER
	SIDEWALK CURB
	PCC 6" SIDEWALK
	PCC DRIVEWAY PAVEMENT

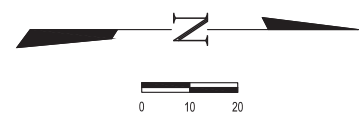

**INTERSECTION DETAIL C**  
SCALE 5:1

Note: All Crossings to have Depressed Curb and Gutter

FIELD BOOK	818
DRAWN BY	MJH
CHECKED BY	LRB
FILE LOCATION	S:\2023\2207BG8\DWG\SIDEWALK.DWG
SAVE DATE	8/25/2023 14:54

**MILANO & GRUNLOH ENGINEERS, LLC**  
114 W. WASHINGTON AVE. | PO BOX 897  
EFFINGHAM, IL 62401  
Phone: (217) 347-7262 | (800) 677-2714  
Email: mgeengineers@mgeengineers.com  
Web: www.mgeengineers.com  
Design Firm # 184-003108

SIDEWALK PLANS 106+00.00-110+50.00
SAFE ROUTES TO SCHOOL 22-00038-00-SW SULLIVAN, ILLINOIS
SHEET # 12 OF 17
JOB # 21207BG8

CONTRACT #	SECTION	COUNTY	TOTAL SHEETS	SHEET NO.
95941	22-00038-00-SW	MOULTRIE	17	13
		ILLINOIS		

BY	DATE	REVISION	ISSUED FOR
NMS	04/14/2023		GEOMETRICS REVIEW

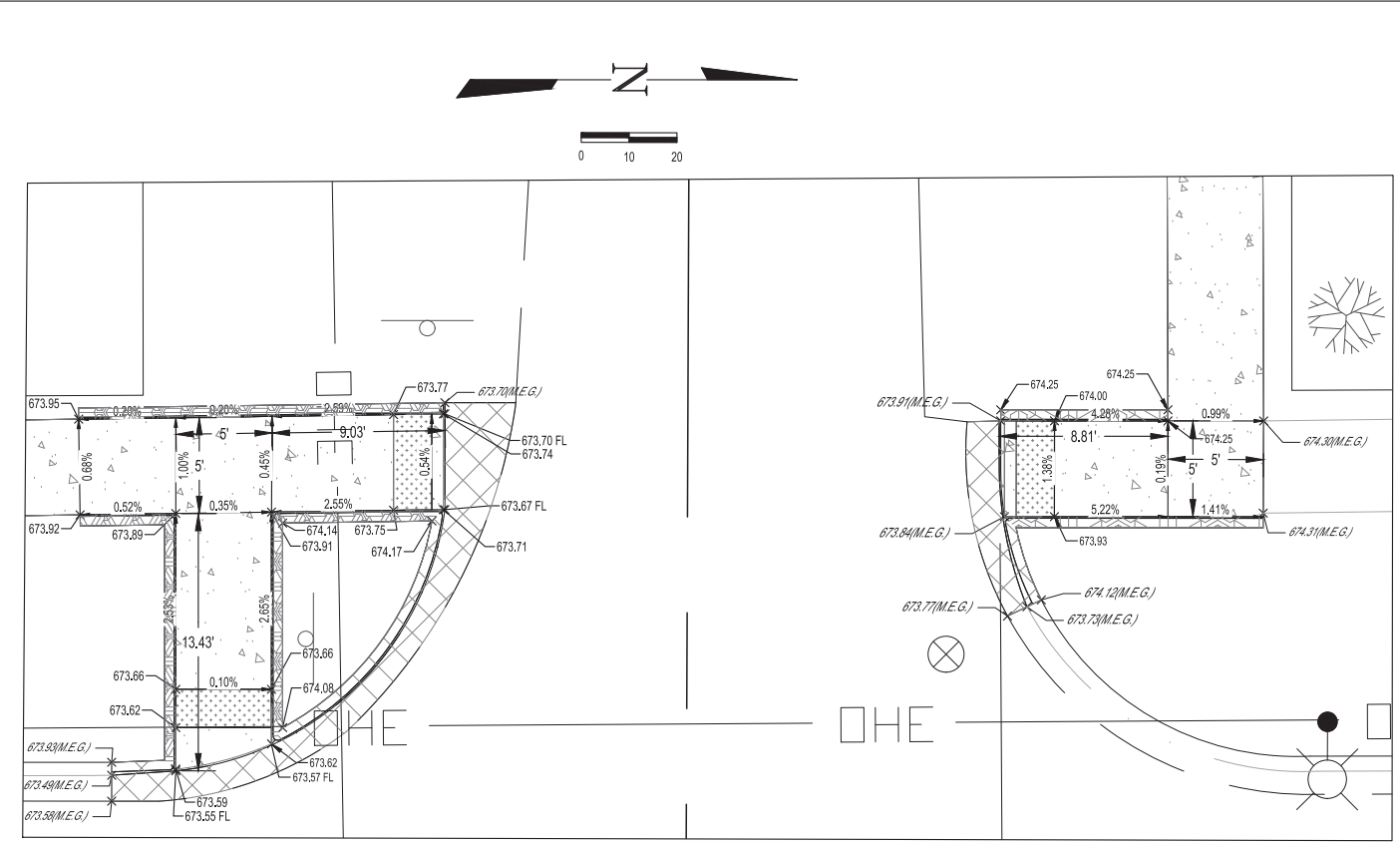
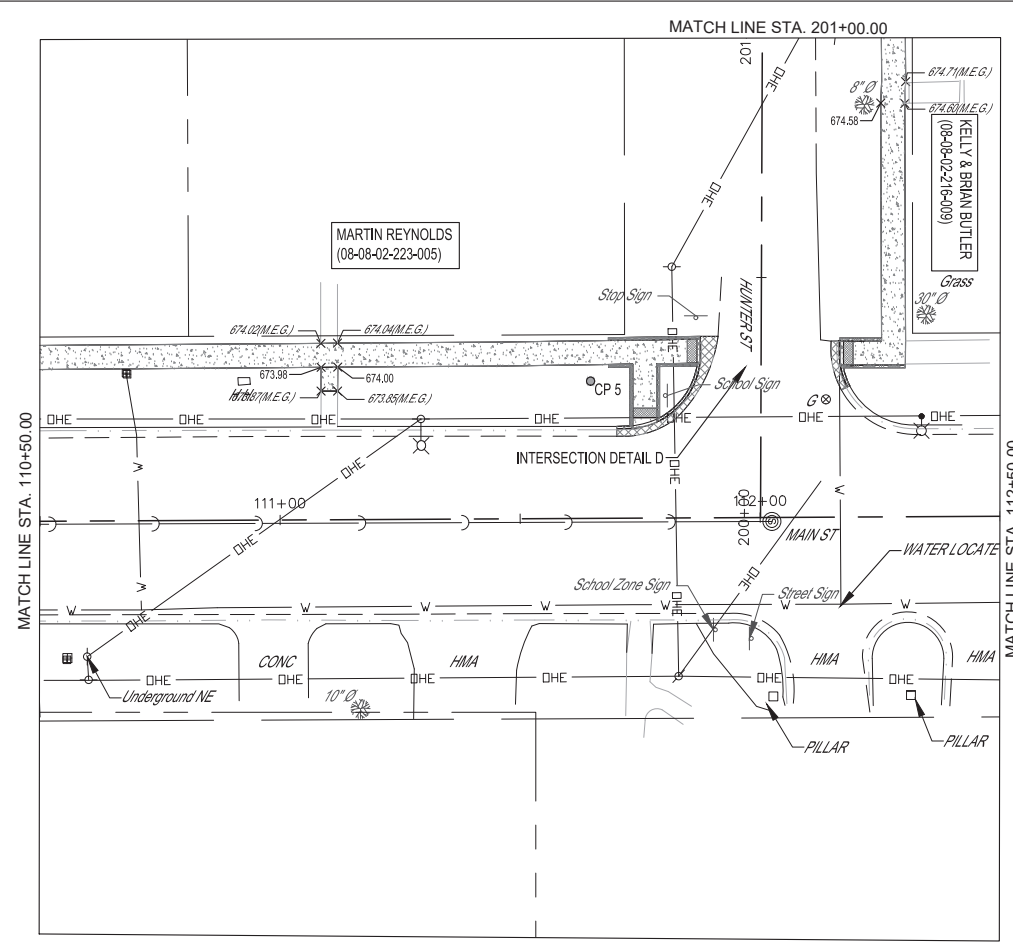

**INTERSECTION DETAIL D**  
SCALE 5:1

**LEGEND**

	PCC 4" SIDEWALK
	ADA DETECTABLE WARNING PANEL
	AGGREGATE BASE COURSE
	8.6-24 CURB AND GUTTER
	SIDEWALK CURB
	PCC 6" SIDEWALK
	PCC DRIVEWAY PAVEMENT

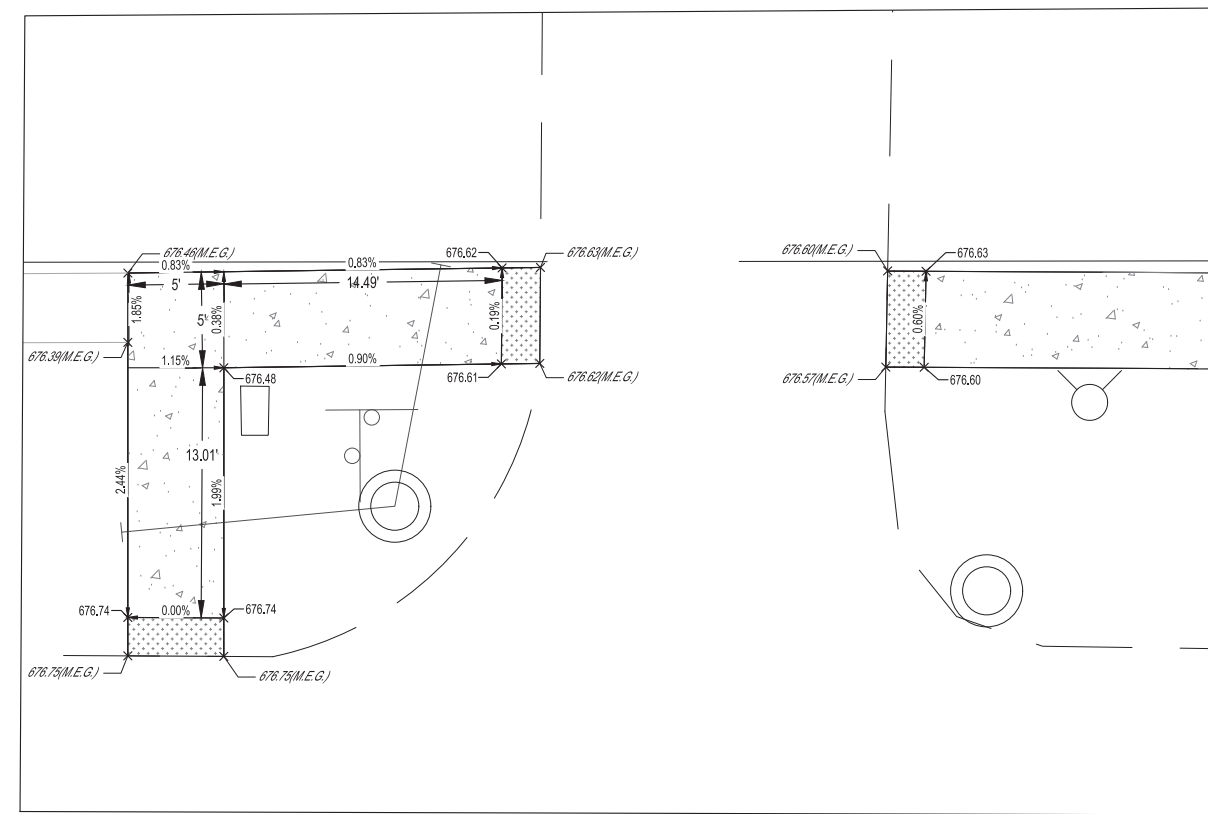
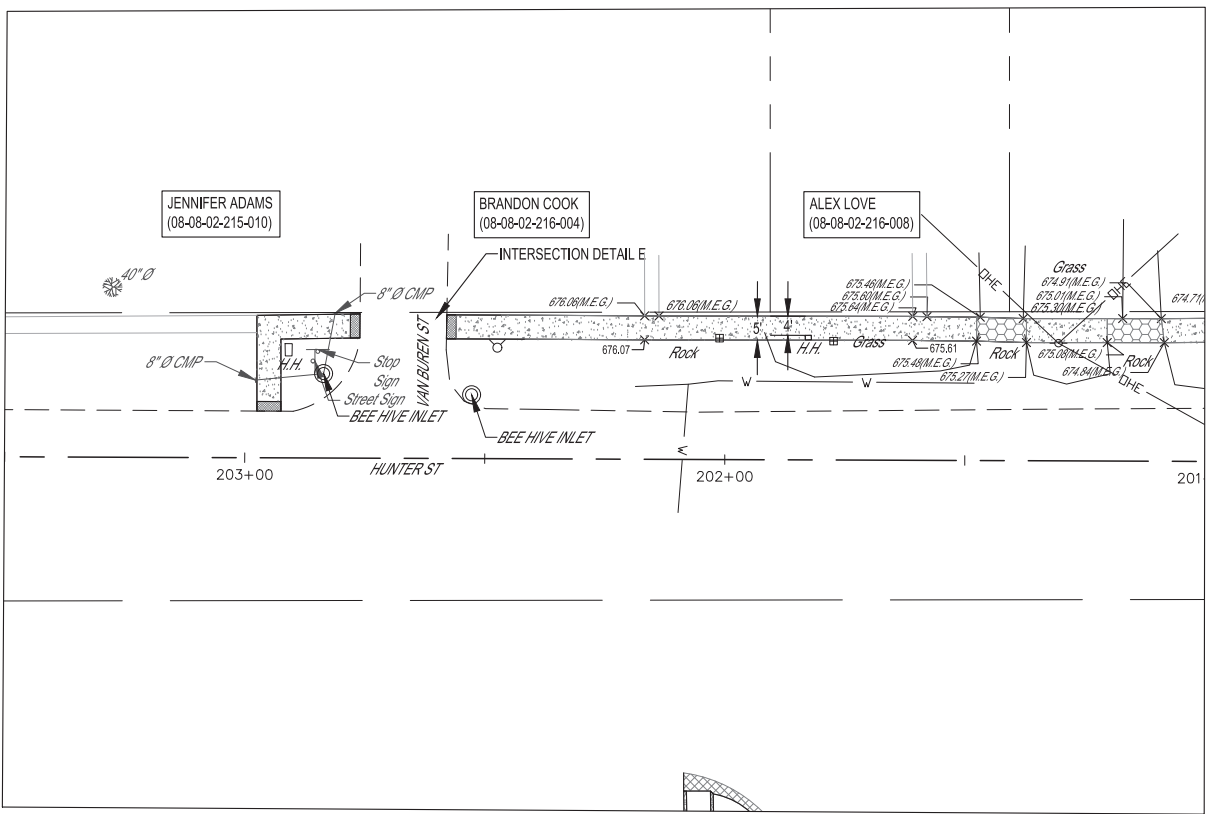

**INTERSECTION DETAIL E**  
SCALE 5:1

FIELD BOOK	818
DRAWN BY	MJH
CHECKED BY	LRB
FILE LOCATION	S:\2023\2207BG8\DWG\SIDEWALK.DWG
SAVE DATE	8/25/2023 14:54

MILANO & GRUNLOH ENGINEERS, LLC	114 W. WASHINGTON AVE.   PO BOX 897
EFFINGHAM, IL 62401	Phone: (217) 347-262   (800) 677-2714
	Email: mgeengineers@mgeengineers.com
	Web: www.mgeengineers.com
	Design Firm # 184-003108

SIDEWALK PLANS 110+50.00-12+50.00
SIDEWALK PLANS 200+00.00-203+50.00
SAFE ROUTES TO SCHOOL
22-00038-00-SW
SULLIVAN, ILLINOIS

SHEET #	13 OF 17
JOB #	21207BG8

Note: All Crossings to have Depressed Curb and Gutter

CONTRACT #	SECTION	COUNTY	TOTAL SHEETS	SHEET NO.
95941	22-00038-00-SW	MOULTRIE	17	14
		ILLINOIS		

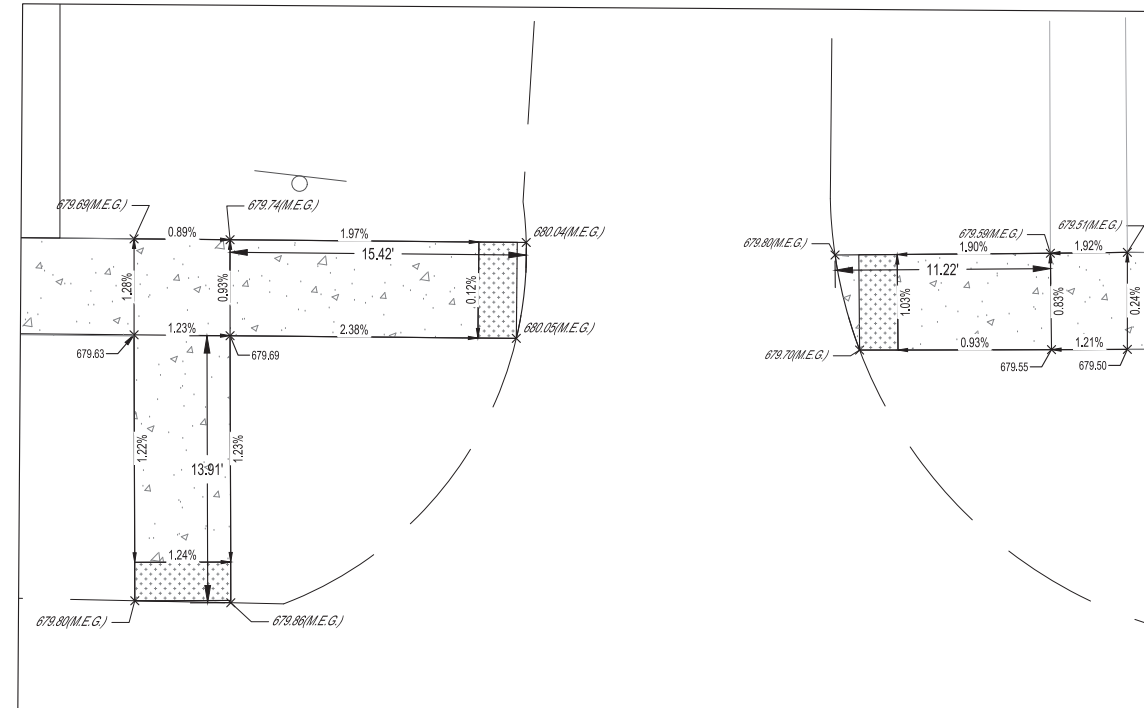
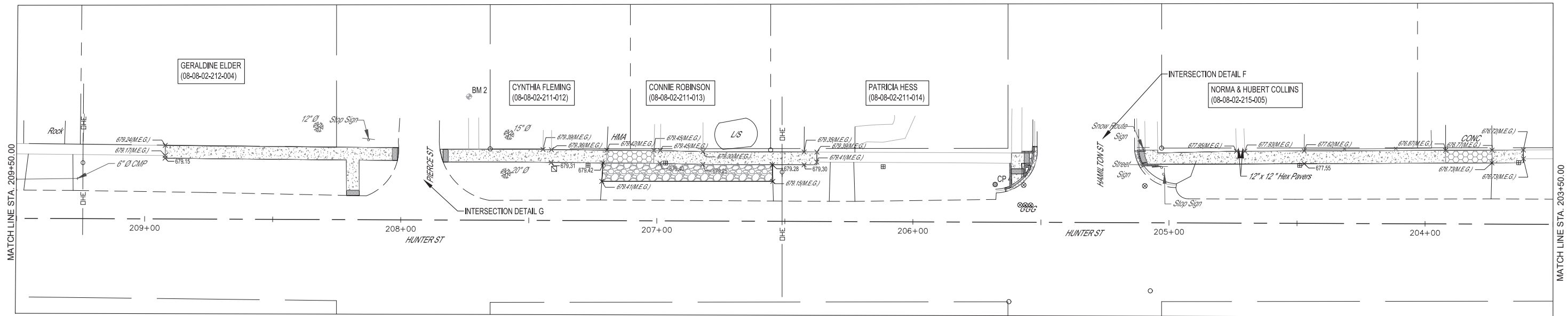

**INTERSECTION DETAIL G**  
SCALE 5:1

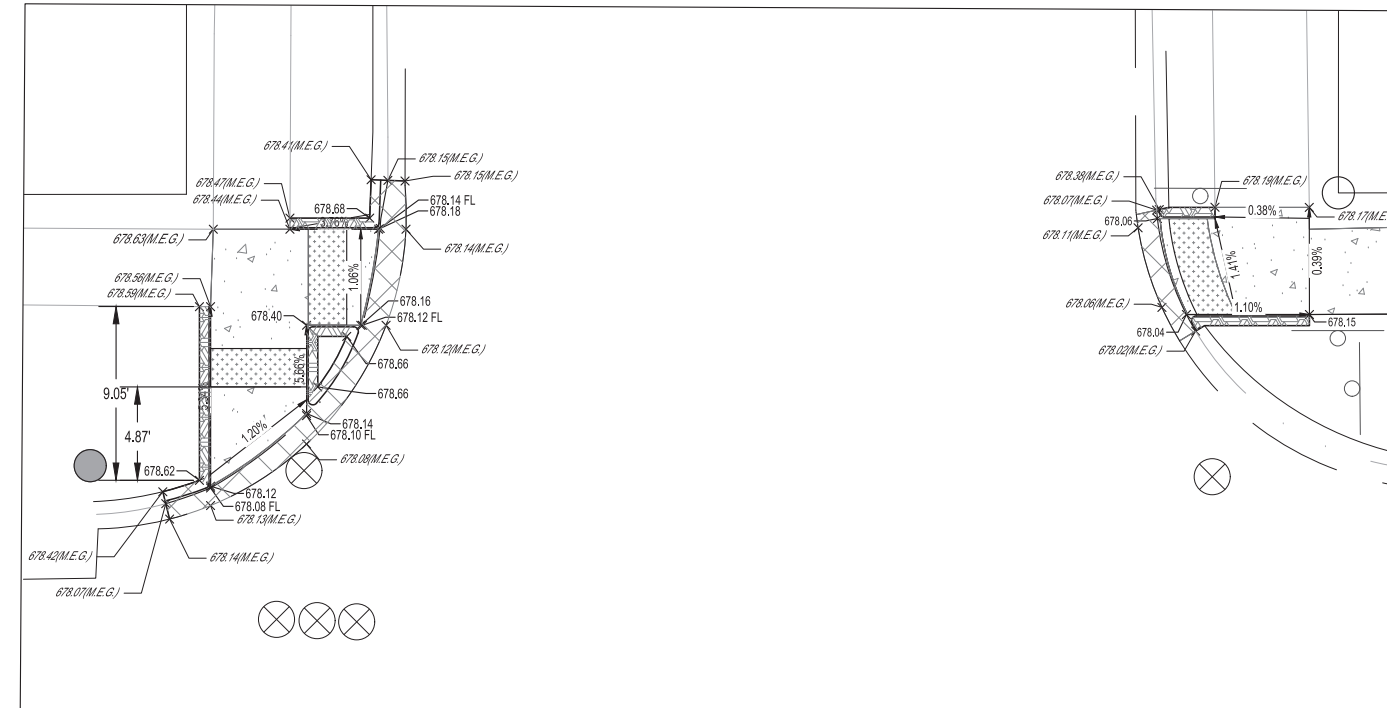

**INTERSECTION DETAIL F**  
SCALE 5:1

N

0 10 20

**LEGEND**

- PCC 4" SIDEWALK
- ADA DETECTABLE WARNING PANEL
- AGGREGATE BASE COURSE
- B.6-24 CURB AND GUTTER
- SIDEWALK CURB
- PCC 6" SIDEWALK
- PCC DRIVEWAY PAVEMENT

REVISION ISSUED	DATE	BY	DESCRIPTION
GEOMETRICS REVIEW	04/22/23	NMS	
FIELD BOOK	818		
DRAWN BY	MJH		
CHECKED BY	LRB		
FILE LOCATION	S:\2021\22\0038\DWG\SIDEWALK.DWG		
SAVE DATE	8/25/2023 14:54		
<b>MILANO &amp; GRUNLOH ENGINEERS, LLC</b>			
114 W. WASHINGTON AVE.   PO BOX 897			
EFFINGHAM, IL 62401			
Phone: (217) 347-7262   (800) 677-2714			
Email: mgeengineers@mgeengineers.com			
Web: www.mgeengineers.com			
Design Firm # 184-003108			
SIDEWALK PLANS 110+50.00-121+50.00			
SAFE ROUTES TO SCHOOL			
22-00038-00-SW			
SULLIVAN, ILLINOIS			
SHEET #			
14 OF 17			
JOB #			
21207BG8			

Note: All Crossings to have Depressed Curb and Gutter

CONTRACT #	SECTION	COUNTY	TOTAL SHEETS	SHEET NO.
95941	22-00038-00-SW	MOULTRIE	17	15

ILLINOIS	REVISION ISSUES
DATE	BY
04/14/2023	NMS
	GEOMETRICS REVIEW

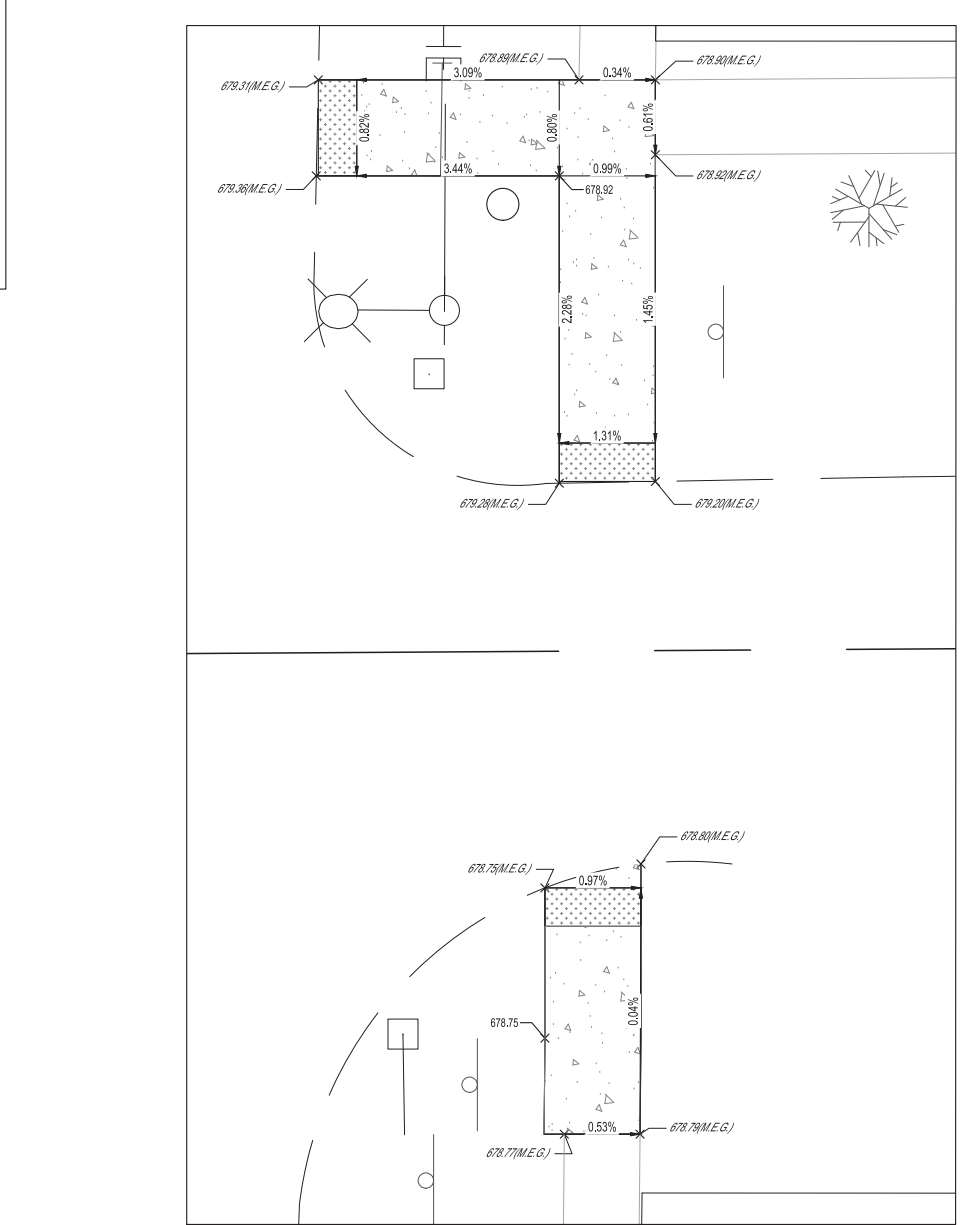
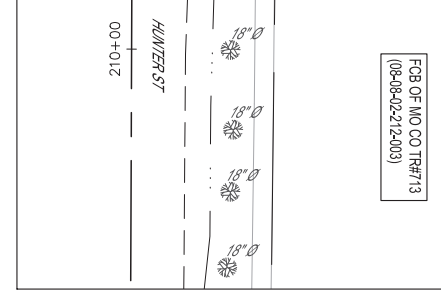
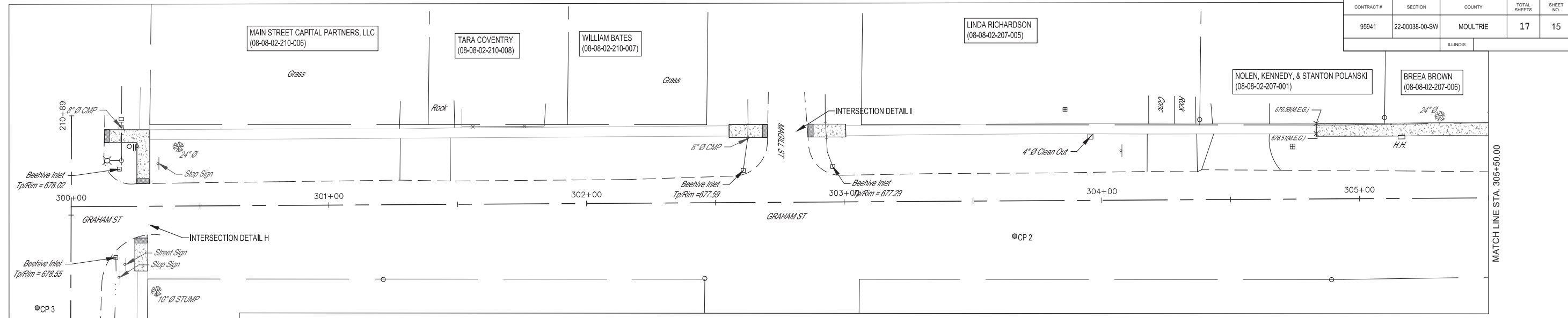

INTERSECTION DETAIL H  
SCALE 5:1

- LEGEND**
- PCC 4" SIDEWALK
  - ADA DETECTABLE WARNING PANEL
  - AGGREGATE BASE COURSE
  - 8.5-24 CURB AND GUTTER
  - PCC 6" SIDEWALK
  - PCC DRIVEWAY PAVEMENT

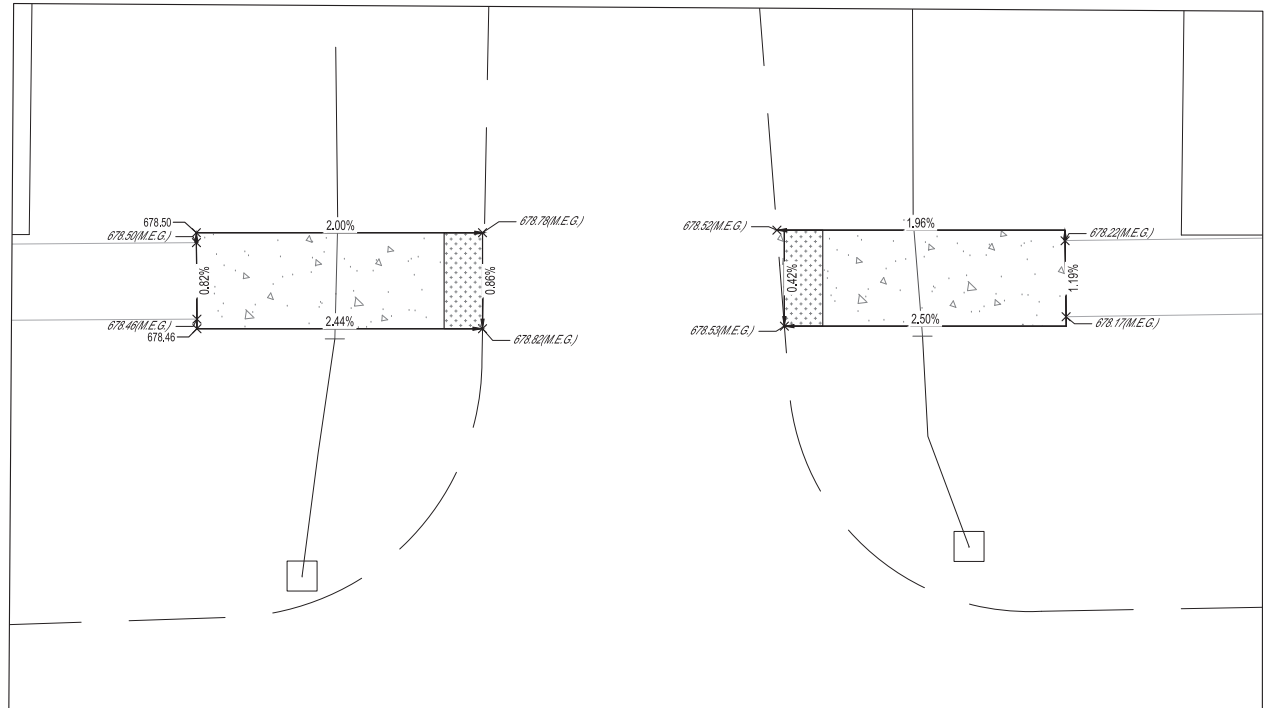
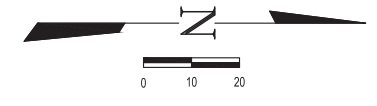

INTERSECTION DETAIL I  
SCALE 5:1

Note: All Crossings to have Depressed Curb and Gutter

FIELD BOOK	818
DRAWN BY	MJH
CHECKED BY	LRB
FILE LOCATION	S:\2021\21207BG8\DWG\SIDEWALK.DWG
SAVE DATE	8/25/2023 14:54

**MILANO & GRUNLOH ENGINEERS, LLC**  
 114 W. WASHINGTON AVE. | PO BOX 897  
 EFFINGHAM, IL 62401  
 Phone: (217) 347-7262 | (800) 677-2714  
 Email: mgeengineers@mgeengineers.com  
 Web: www.mgeengineers.com  
 Design Firm # 184-003108

SIDEWALK PLANS 12+50.00-130+46.00  
 SAFE ROUTES TO SCHOOL  
 22-00038-00-SW  
 SULLIVAN, ILLINOIS

SHEET #  
15 OF 17  
 JOB #  
21207BG8

CONTRACT #	SECTION	COUNTY	TOTAL SHEETS	SHEET NO.
95941	22-00038-00-SW	MOULTRIE	17	16
ILLINOIS				

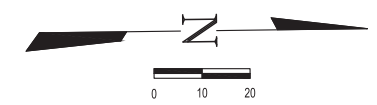
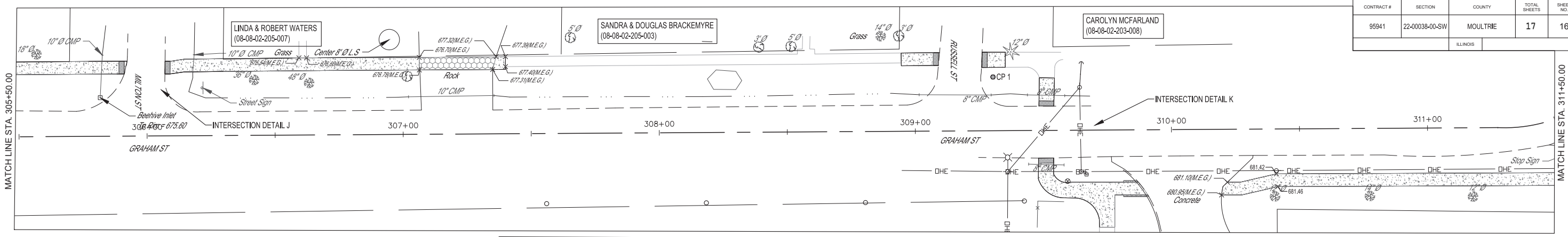

**LEGEND**

- PCC 4" SIDEWALK
- ADA DETECTABLE WARNING PANEL
- AGGREGATE BASE COURSE
- B.6-24 CURB AND GUTTER
- PCC 6" SIDEWALK
- PCC DRIVEWAY PAVEMENT

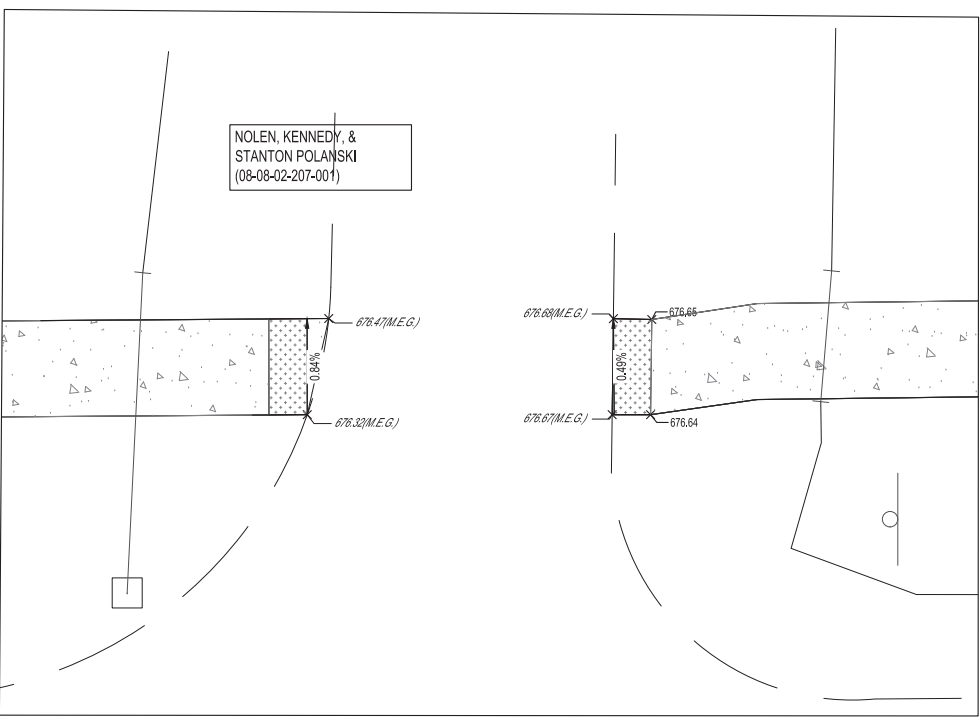
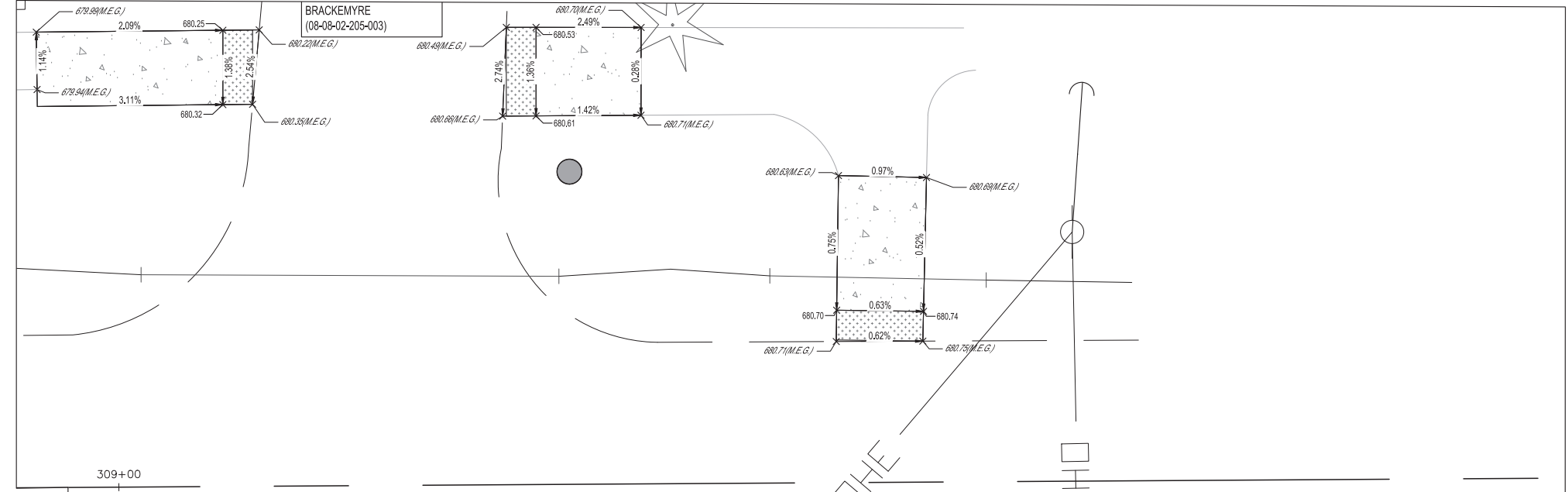

**INTERSECTION DETAIL J**  
SCALE 5:1

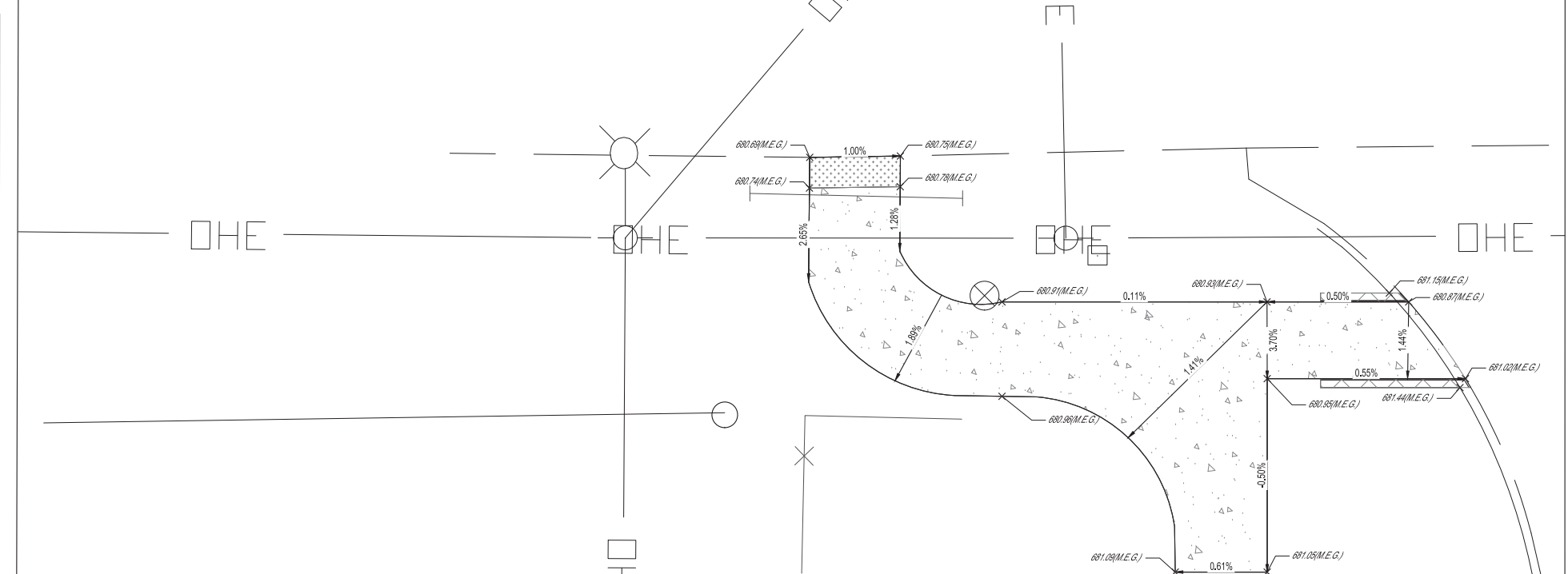

**INTERSECTION DETAIL K**  
SCALE 5:1

Note: All Crossings to have Depressed Curb and Gutter

REVISION	DATE	ISSUED BY	BY
GEOMETRICS REVIEW	04/14/2023		
FIELD BOOK	818	DRAWN BY	MJH
		CHECKED BY	LRB
		FILE LOCATION	S:\2021\21207BG8\DWG\SIDEWALK.DWG
		SAVE DATE	8/25/2023 14:54

**MILANO & GRUNLOH ENGINEERS, LLC**  
114 W. WASHINGTON AVE. | PO BOX 897  
EFFINGHAM, IL 62401  
Phone: (217) 347-7262 | (800) 677-2714  
Email: mgeengineers@mgeengineers.com  
Web: www.mgeengineers.com  
Design Firm # 184-003108

SIDEWALK PLANS 305+50.00-311+50.00  
SAFE ROUTES TO SCHOOL  
22-00038-00-SW  
SULLIVAN, ILLINOIS

SHEET #  
16 OF 17  
JOB #  
21207BG8



CONTRACT #	SECTION	COUNTY	TOTAL SHEETS	SHEET NO.
95941	22-00038-00-SW	MOULTRIE	17	17
		ILLINOIS		

BY	DATE	REVISION	ISSUED FOR
NMS	06/14/2023	GEOMETRICS REVIEW	

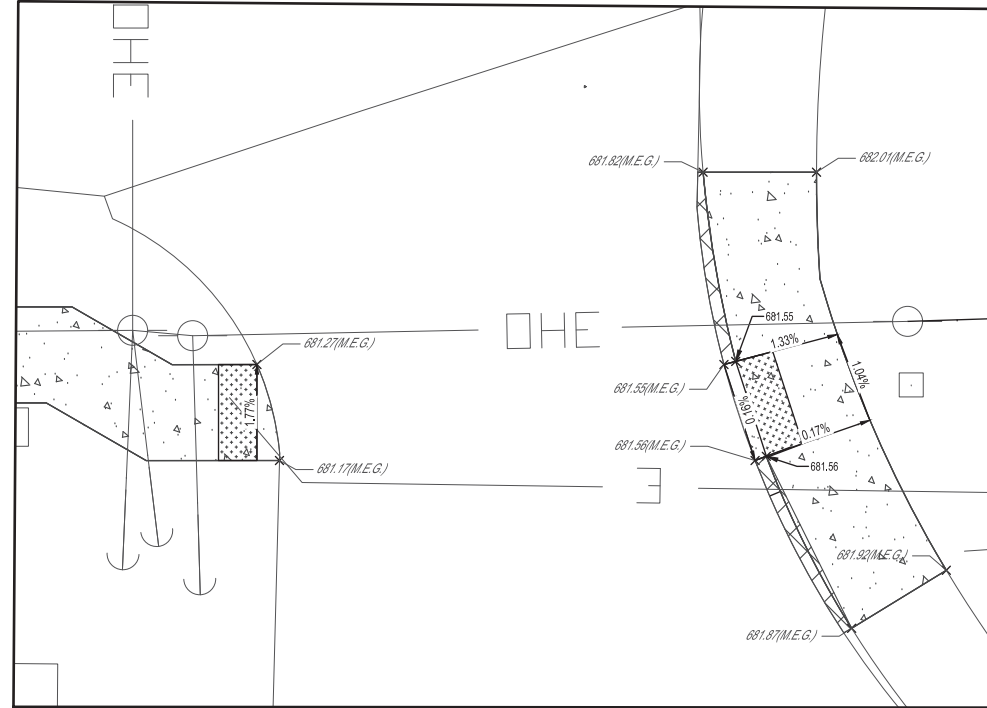

**INTERSECTION DETAIL L**  
SCALE 5:1

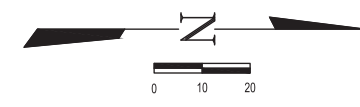
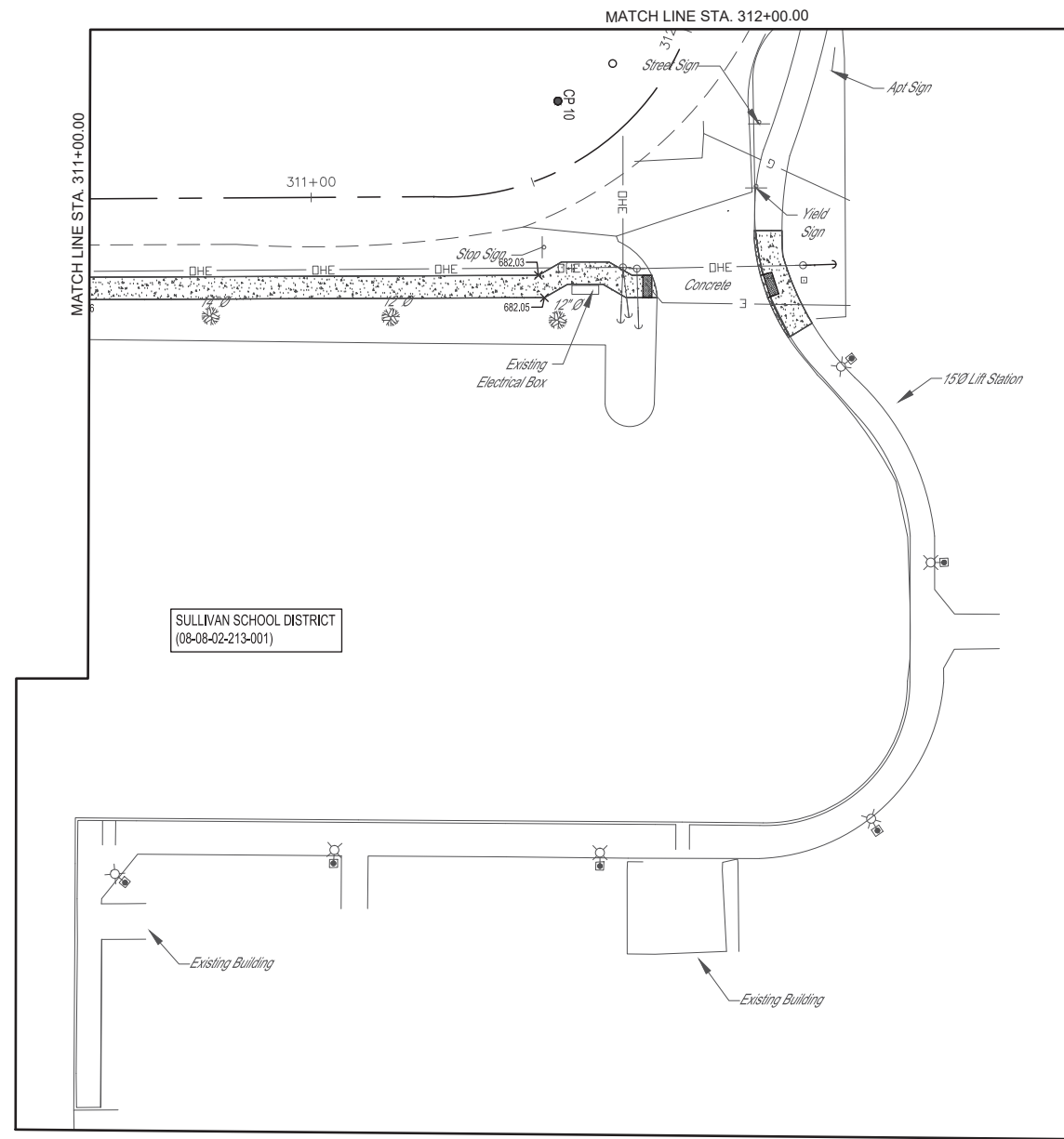

**LEGEND**

- PCC 4" SIDEWALK
- ADA DETECTABLE WARNING PANEL
- AGGREGATE BASE COURSE
- B.6-24 CURB AND GUTTER
- PCC 6" SIDEWALK
- PCC DRIVEWAY PAVEMENT

FIELD BOOK	818
DRAWN BY	MJH
CHECKED BY	LRB
FILE LOCATION	S:\2023\2207BGS\DWG\SIDEWALK.DWG
SAVE DATE	9/20/23 11:05

**MILANO & GRUNLOH ENGINEERS, LLC**  
114 W. WASHINGTON AVE. | PO BOX 897  
EFFINGHAM, IL 62401  
Phone: (217) 347-7262 | (800) 677-2714  
Email: mgeengineers@mgeengineers.com  
Web: www.mgeengineers.com  
Design Firm # 184-003108



SIDEWALK PLANS 300+00.00-310+50.00  
SAFE ROUTES TO SCHOOL  
22-00038-00-SW  
SULLIVAN, ILLINOIS