

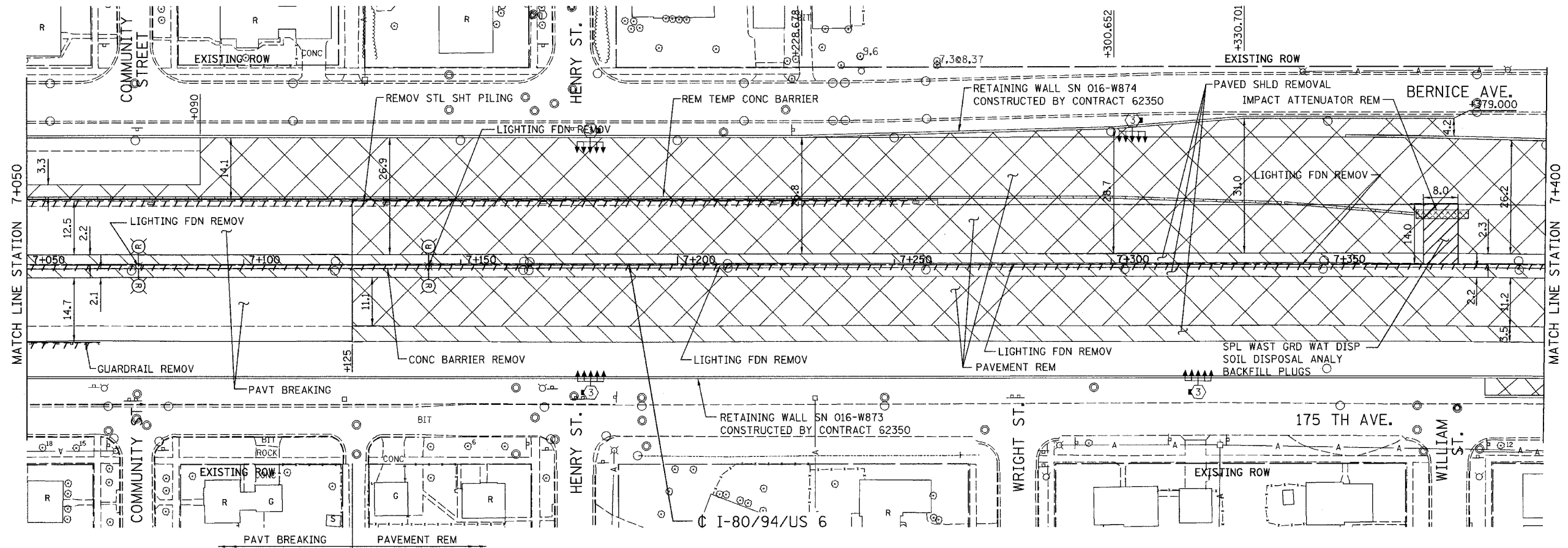



ALL DIMENSIONS IN METERS EXCEPT PAV  
ITEMS AND UNLESS NOTED OTHERWISE

F.A.I. RTE. 80/94	SECTION 2626.2-R-2	COUNTY COOK/LAKE	TOTAL SHEETS 1207	SHEET NO. 50
STA. 7+050		TO STA. 7+400		
FED. ROAD DIST. NO. CONTRACT NO. 62114		ILLINOIS FED. AID PROJECT INDOT DES. NO. 0100987		

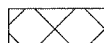
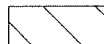

EXISTING LEGEND:

-  LIGHT POLE REMOVAL (BY CONTRACT 62664)
-  PAVEMENT REMOVAL
-  PAVED SHOULDER REMOVAL
-  APPROACH SLAB REMOVAL

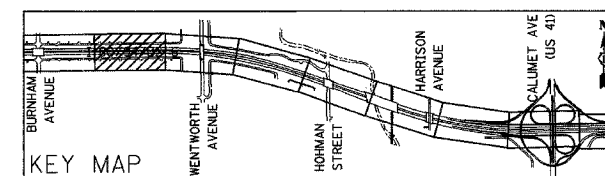

REVISIONS	
NAME	DATE

ILLINOIS DEPARTMENT OF TRANSPORTATION  
I-80/94/US 6  
KINGERY-BORMAN EXPRESSWAY  
BURNHAM ROAD TO US 41  
**EXISTING PLAN**

**STA. 7+050 TO STA. 7+400**

SCALE 1:500  
DATE 07/05

DRAWN BY ACE/CAD  
CHECKED BY TAE

