

ALL DIMENSIONS IN METERS EXCEPT PAVEMENT ELEVATIONS AND UNLESS NOTED OTHERWISE

F.A.I. RTE.	SECTION	COUNTY	TOTAL SHEETS	SHEET NO.
80/94	2626.2-R-2	COOK/LAKE	1207	132
STA.	TO STA.			
FED. ROAD DIST. NO.	ILLINOIS	FED. AID PROJECT		
CONTRACT NO. 62114	INDOT DES. NO. 0100987			

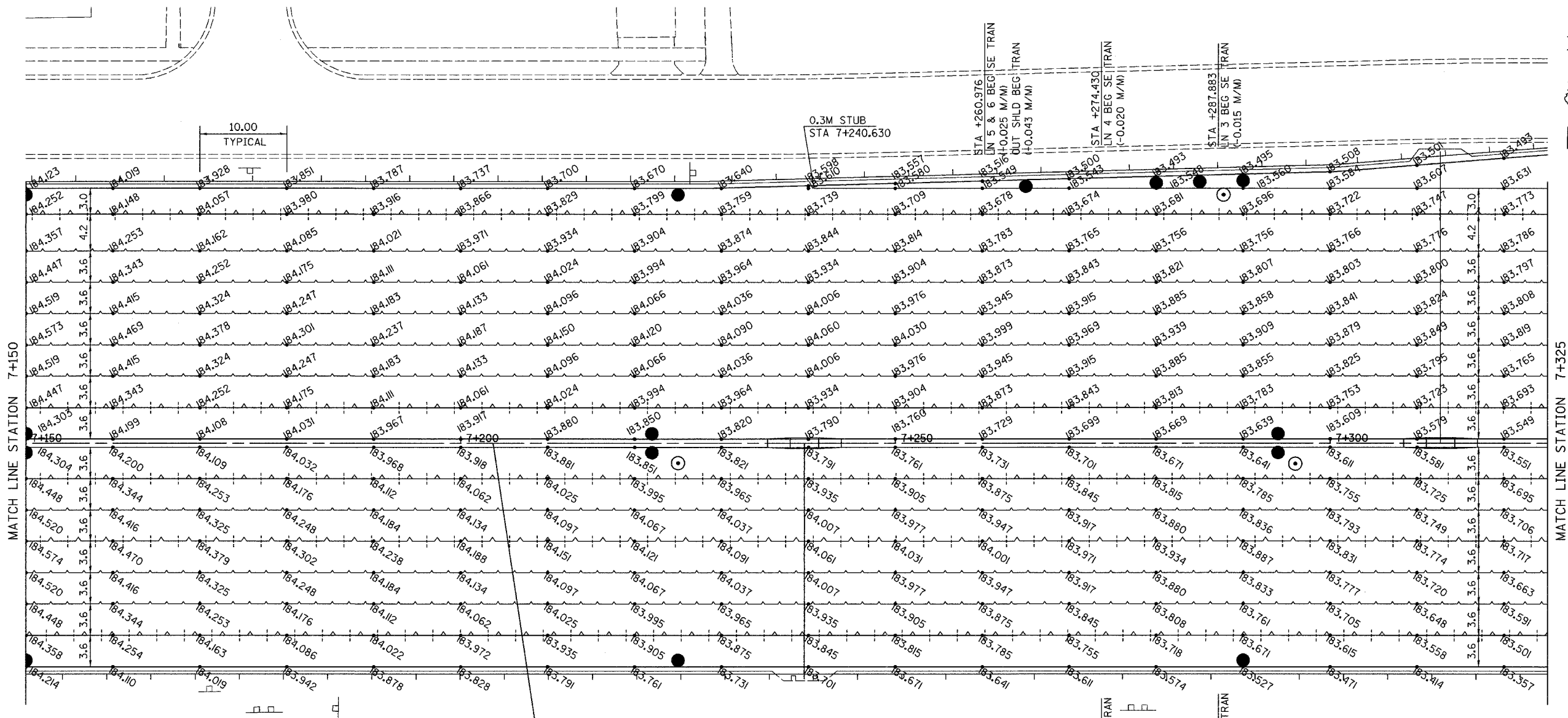

**LEGEND**

- PAVEMENT ELEVATION (METERS)
- LONGITUDINAL JOINT
- LONGITUDINAL CONSTRUCTION JOINT
- PAVEMENT SWALE
- EXISTING PAVEMENT BY CONTRACT 62113

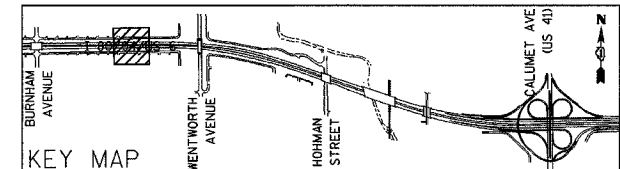

REVISIONS	
NAME	DATE

ILLINOIS DEPARTMENT OF TRANSPORTATION  
**I-80/94/US 6 (KINGERY EXPRESSWAY)**  
 BURNHAM ROAD TO US 41 (CALUMET AVE)  
**PAVEMENT JOINTS AND ELEVATIONS**  
**I-80/94/US 6**  
**STA 7+150 TO STA 7+325**  
 SCALE 1:250 DRAWN BY ACE/CAD  
 DATE 07/05 CHECKED BY TAE