

ALL DIMENSIONS IN METERS EXCEPT PAY ITEMS AND UNLESS NOTED OTHERWISE

F.A.I. RTE.	SECTION	COUNTY	TOTAL SHEETS	SHEET NO.
80/94	2626.2-R-2	COOK/LAKE	1207	133
STA.	TO STA.			
FED. ROAD DIST. NO.	ILLINOIS FED. AID PROJECT			
CONTRACT NO. 62114	INDOT DES. NO. 0100987			

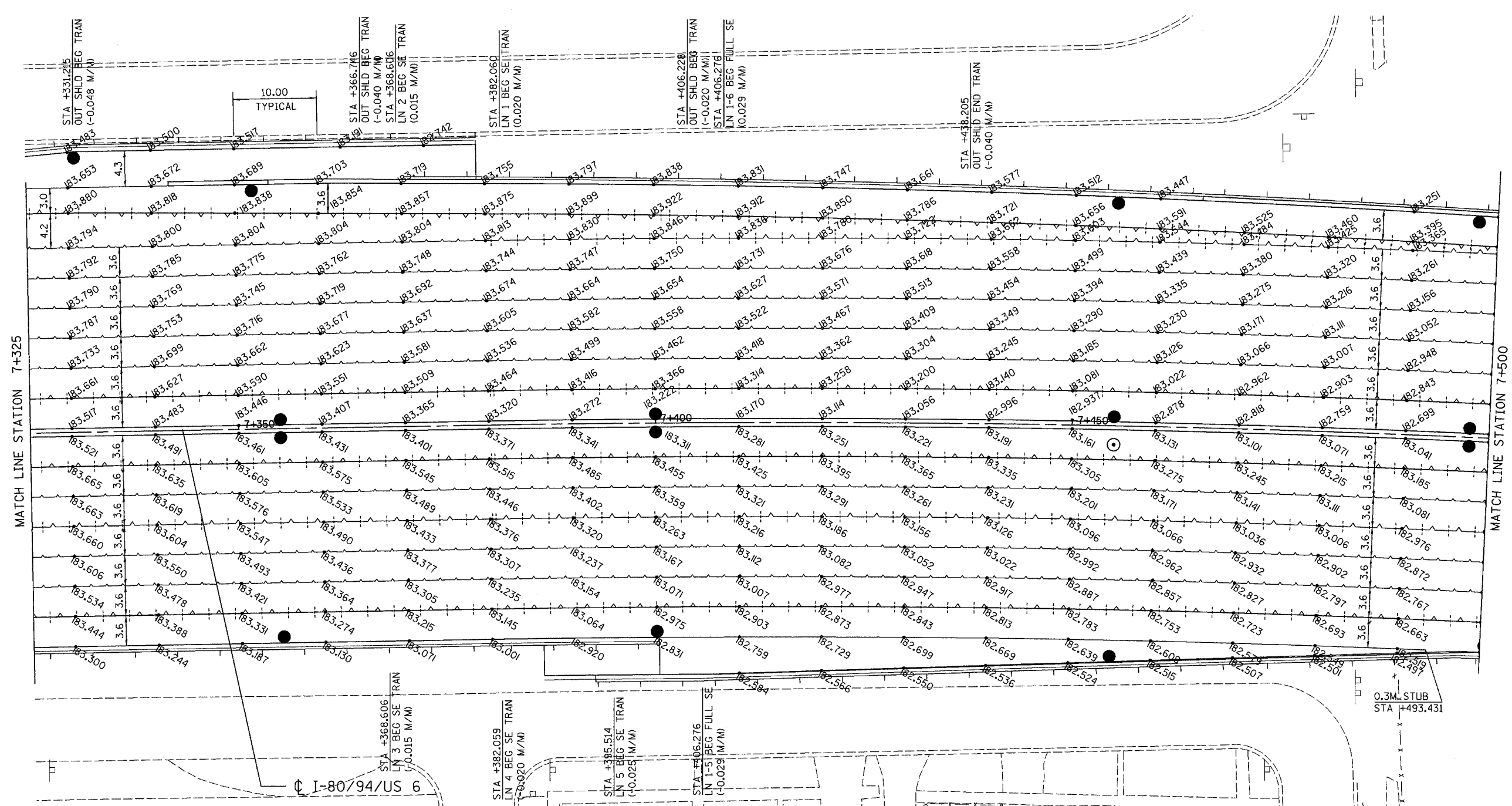

LEGEND

- xxx.xxx PAVEMENT ELEVATION (METERS)
- +—+— LONGITUDINAL JOINT
- +—+— LONGITUDINAL CONSTRUCTION JOINT
- - - - - PAVEMENT SWALE
- ▨ EXISTING PAVEMENT BY CONTRACT 62113

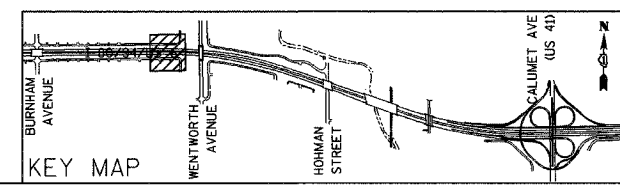

REVISIONS	
NAME	DATE

ILLINOIS DEPARTMENT OF TRANSPORTATION
 I-80/94/US 6 (KINGERY EXPRESSWAY)
 BURNHAM ROAD TO US 41 (CALUMET AVE)
PAVEMENT JOINTS AND ELEVATIONS
I-8094US 6
STA 7+325 TO STA 7+500
 SCALE 1:250 DRAWN BY ACE/CAD
 DATE 07/05 CHECKED BY TAE

AMERICAN
 CONSULTING ENGINEERS