

F.A.I. 80/94 (KINGERY EXPRESSWAY) BORING LOCATION  
 ILLINOIS DEPARTMENT OF TRANSPORTATION, COOK COUNTY  
 HORIZ. SCALE: 1"=100'  
 VERT. SCALE: 1"=10'  
 DRAWN BY: J.E.S.  
 CHECKED BY: L.L.  
 Wang Engineering, Inc. 145 Main Street  
 Lombard, IL 60148  
 Geo-Environmental Engineers 630-953-9928  
 BASED ON DRAWINGS PREPARED BY AMERICAN CONSULTING ENGINEERS 255-06-04

DATE: 09/03  
 BY: J.E.S.  
 CHECKED BY: L.L.  
 APPROVED BY: J.E.S.  
 FINAL SURVEY PLOTTED  
 NO. 1 BOOK 116 PLAT 111  
 AREA: 10.00 AC.  
 DATE: 09/03  
 BY: J.E.S.  
 CHECKED BY: L.L.  
 APPROVED BY: J.E.S.

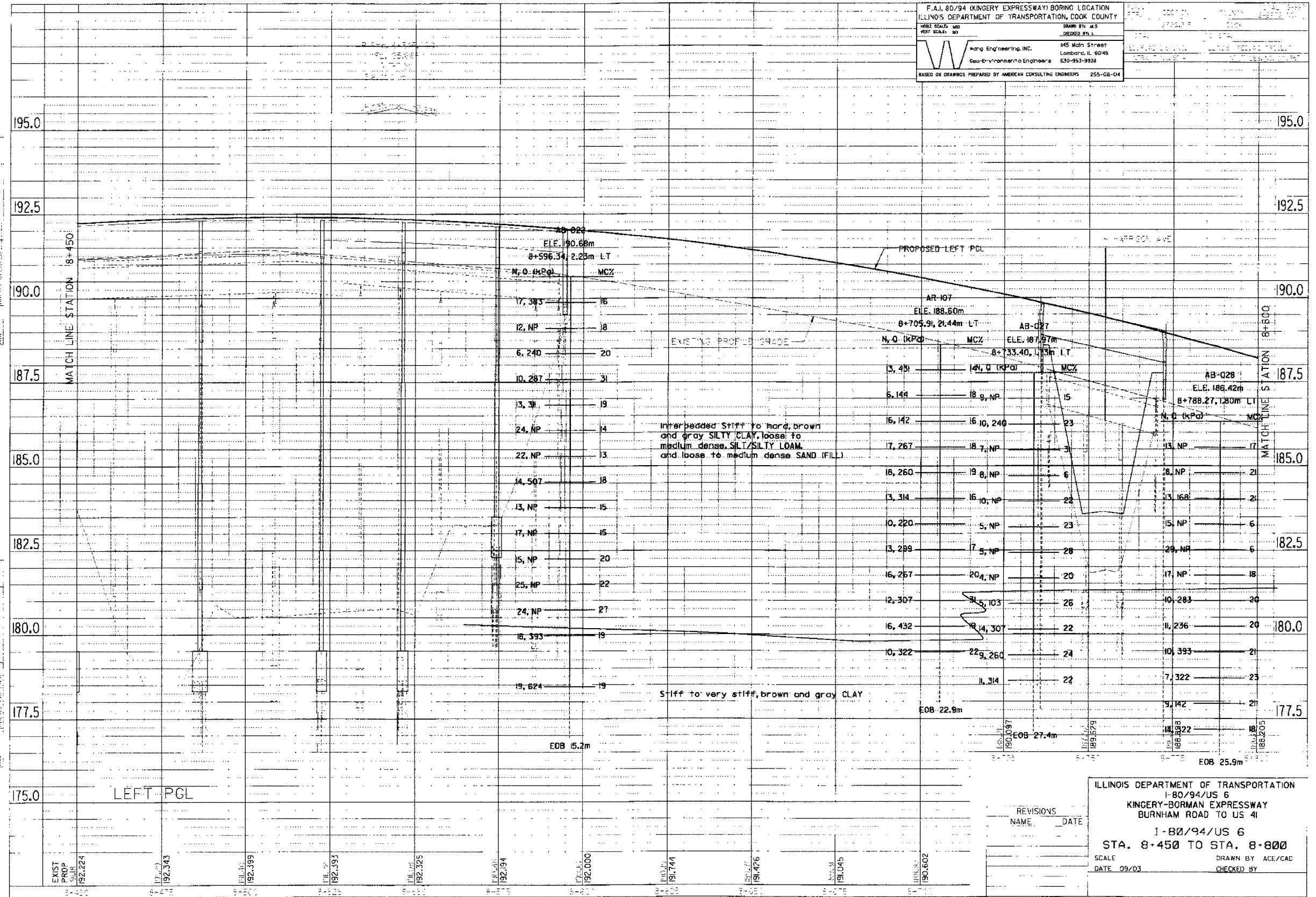

ILLINOIS DEPARTMENT OF TRANSPORTATION  
 I-80/94/US 6  
 KINGERY-BORMAN EXPRESSWAY  
 BURNHAM ROAD TO US 41  
 I-80/94/US 6  
 STA. 8+450 TO STA. 8+800  
 SCALE: 1"=100'  
 DATE: 09/03  
 DRAWN BY: ACE/CAD  
 CHECKED BY: J.E.S.