

ALL DIMENSIONS IN METERS EXCEPT PAY ITEMS AND UNLESS NOTED OTHERWISE

F.A.I. RTE.	SECTION	COUNTY	TOTAL SHEETS	SHEET NO.
80/94	2626.2-R-2	COOK/LAKE	1207	190
STA.	TO STA.			
FED. ROAD DIST. NO.	ILLINOIS	FED. AID PROJECT		
CONTRACT NO. 62114	INDOT DES. NO. 0100987			

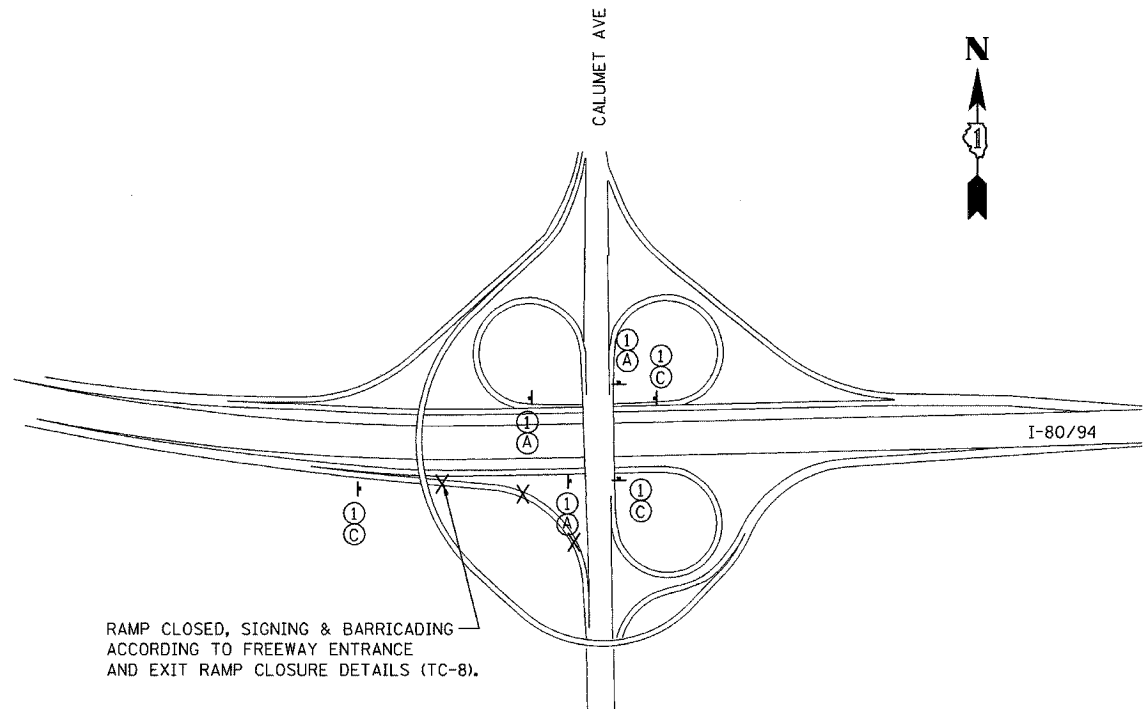

RAMP CLOSED, SIGNING & BARRICADING ACCORDING TO FREEWAY ENTRANCE AND EXIT RAMP CLOSURE DETAILS (TC-8).

600 mm X 300 mm
BLACK ON ORANGE (TYP)

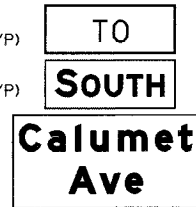

900 mm X 600 mm
BLACK ON ORANGE

①



600 mm X 600 mm
STD SHIELD

②

750 mm X 375 mm
BLACK ON ORANGE

750 mm X 375 mm
BLACK ON ORANGE

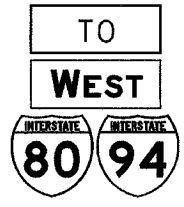

900 mm X 900 mm
STD SHIELDS

③

525 mm X 325 mm (TYP)
(USE 750 mm X 450 mm WITH ALL SIGN ③)

BLACK ON ORANGE



Ⓐ



Ⓑ



Ⓒ



Ⓓ

STAGE 1
I-80/94 EB TO CALUMET AVE SB
RAMP CLOSURE SIGNING

NOTE: SIGNS PAID FOR AS "TEMPORARY INFORMATION SIGNING"

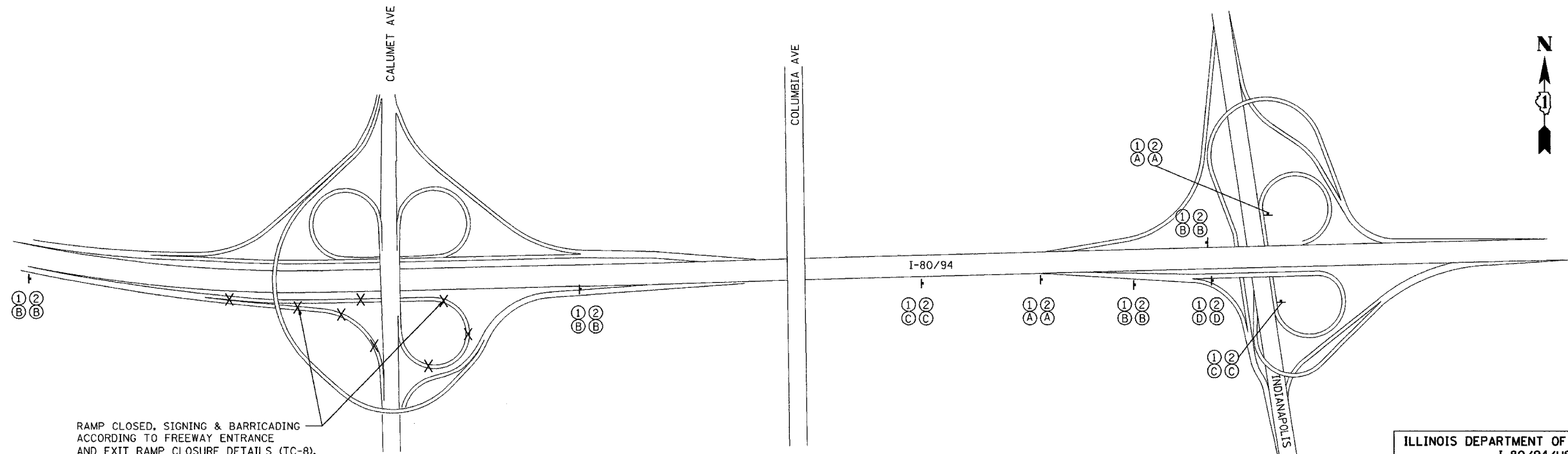

RAMP CLOSED, SIGNING & BARRICADING ACCORDING TO FREEWAY ENTRANCE AND EXIT RAMP CLOSURE DETAILS (TC-8).

STAGE 1
I-80/94 EB TO CALUMET AVE (US 41) NB & SB
RAMP CLOSURE SIGNING

REVISIONS	
NAME	DATE

ILLINOIS DEPARTMENT OF TRANSPORTATION
I-80/94/US 6
KINGERY-BORMAN EXPRESSWAY
BURNHAM ROAD TO US 41
MAINTENANCE OF TRAFFIC
DETOUR SIGNING

SCALE NTS
DATE 07/05

DRAWN BY ACE/CAD
CHECKED BY TAE

AMERICAN
CONSULTING ENGINEERS