

ALL DIMENSIONS IN METERS EXCEPT PAY ITEMS AND UNLESS NOTED OTHERWISE

F.A.I. RTE.	SECTION	COUNTY	TOTAL SHEETS	SHEET NO.
80/94	2626.2-R-2	COOK/LAKE	1207	355
STA.	TO STA.			
FED. ROAD DIST. NO.	ILLINOIS FED. AID PROJECT			
CONTRACT NO. 62114	INDOT DES. NO. 0100987			

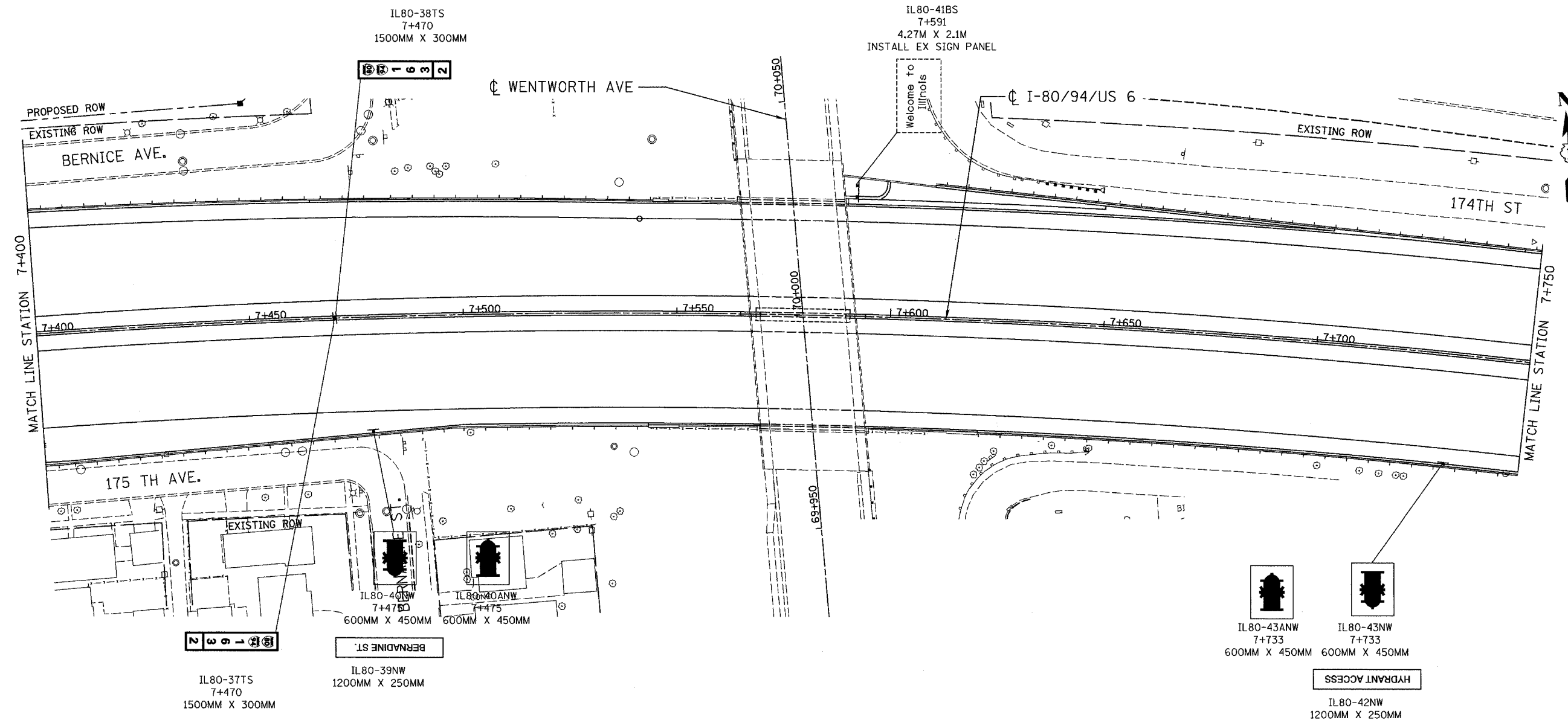

NOTE:  
THE BANDING OF SIGNS TO THE OVERHEAD SIGN STRUCTURE SUPPORTS SHALL BE INCLUDED IN THE COST FOR SIGN PANELS.

ILLINOIS DEPARTMENT OF TRANSPORTATION  
I-80/94/US 6  
KINGERY-BORMAN EXPRESSWAY  
BURNHAM ROAD TO US 41  
**SIGNING PLAN**

STA. 7+400 TO STA. 7+750  
SCALE 1:500  
DATE 07/05  
DRAWN BY ACE/CAD  
CHECKED BY TAE

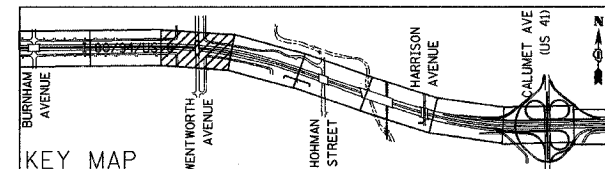

REVISIONS	
NAME	DATE