

F.A.I. RTE.	SECTION	COUNTY	TOTAL SHEETS	SHEET NO.
80/94	2626.2-R-2	COOK/LAKE	1207	417
STA.		TO STA.		
FED. ROAD DIST. NO.		ILLINOIS FED. AID PROJECT		
CONTRACT NO. 62114		INDOT DES. NO. 0100987		

**GENERAL NOTES**

- All radii 5 mm unless noted.

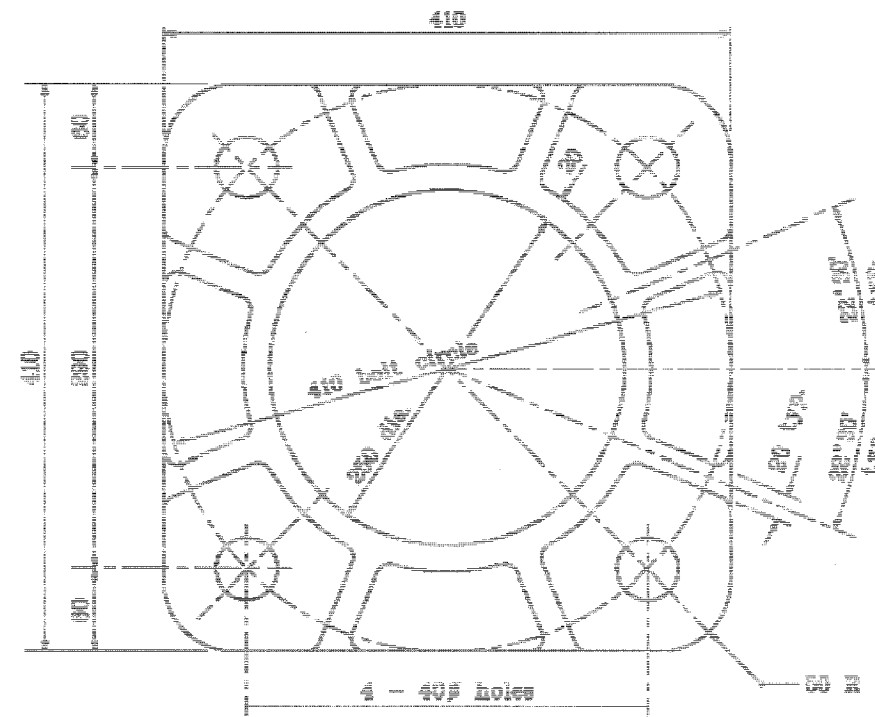

**PLAN**

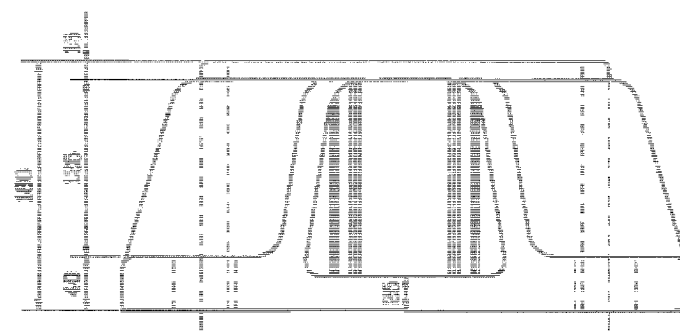

**ELEVATION**

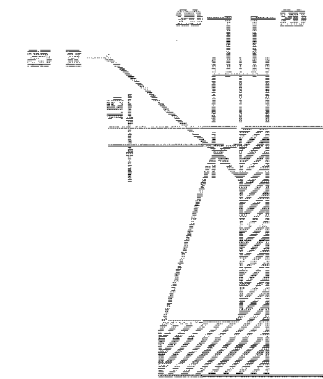

**TYP. DETAIL OF RIB**

All dimensions are in mm unless otherwise specified.

INDIANA DEPARTMENT OF TRANSPORTATION

SIGN STRUCTURE TRUSS

DETAILS

MARCH 2002

STANDARD DRAWING NO. 302-SNOH-03

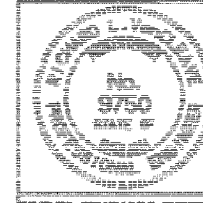

/s/ Richard L. VanCleave 3-20-02  
DESIGN STANDARD ENGINEER DEPT

/s/ Richard K. Smuler 3-07-02  
CHIEF HIGHWAY ENGINEER DEPT