

**Benchmarks:**  chiseled into the top of the Northwest wingwall of Wentworth Avenue over I-80/94; Elev. = 187.427

**Existing Structure:** S.N. 016-0809 built as Wentworth Avenue Grade Separation over Tri-State Superhighway, F.A. Route 122, Sec. 2626.1-HB, by the State of Illinois Division of Highways in 1948. The four span structure, 63.2 m Back to Back of Abutments, consists of a 19.5 m wide R.C. deck supported by continuous I Beams supported by concrete piers and abutments. The contractor shall remove the existing structure as required and replace it with a two span wide flange superstructure on reinforced concrete abutments and pier. Stage construction shall be used to maintain a single northbound traffic lane in Stage I, and two traffic lanes (one each direction) in Stage II.

No Salvage

**NOTE:** All dimensions are in millimeters (mm) except as noted

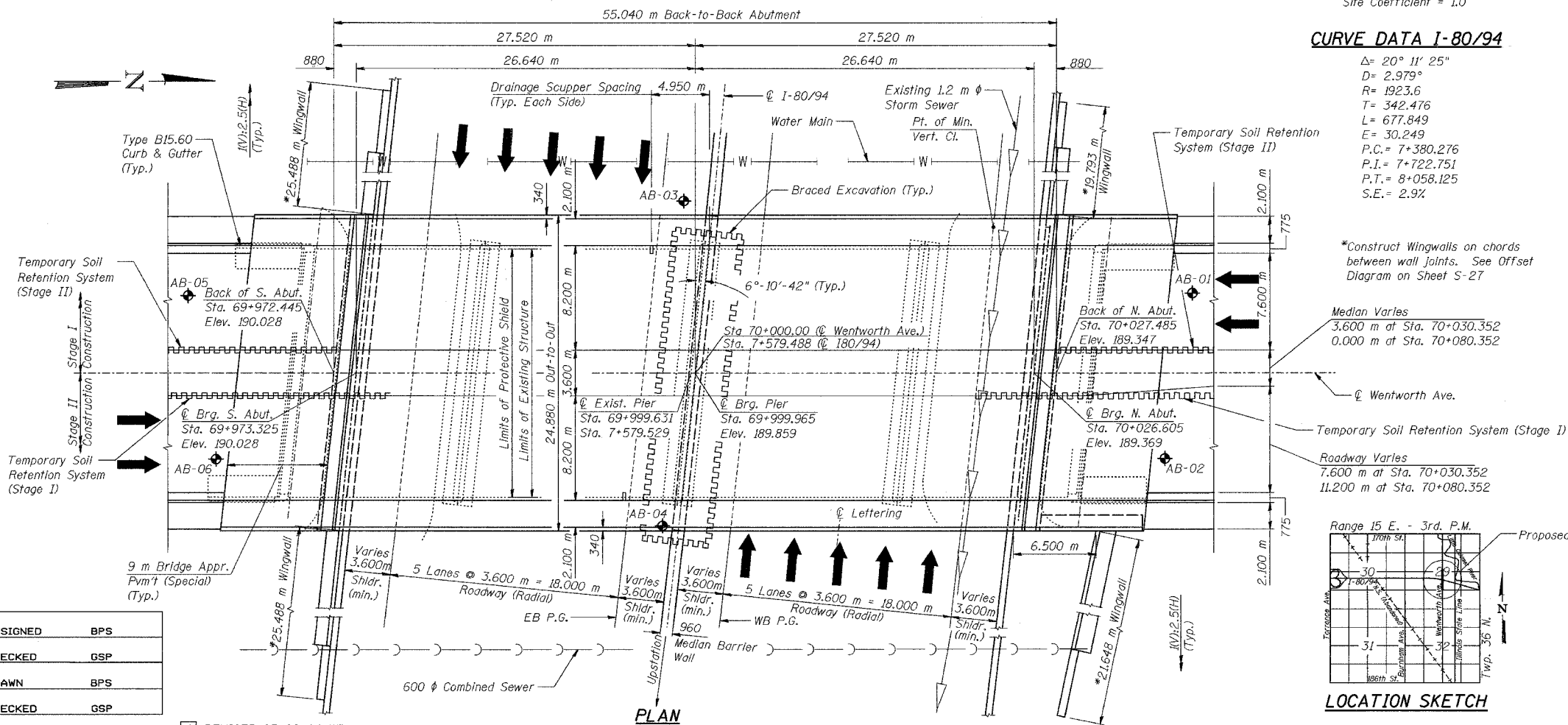
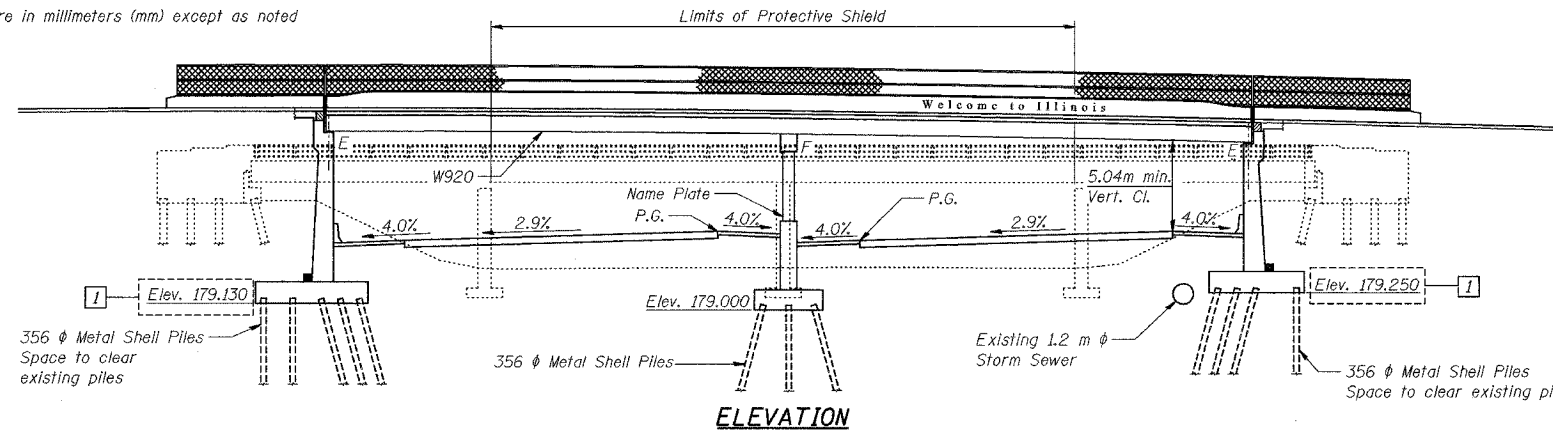

DESIGNED	BPS
CHECKED	GSP
DRAWN	BPS
CHECKED	GSP

REVISD 03-29-04 KFA

STATION 7+579.488  
BUILT 20\_\_ BY  
STATE OF ILLINOIS  
FAI 80/94 SEC 2626.1B  
LOADING MS18  
STR. NO. 016-2790

**NAME PLATE**  
See Std. 515001  
See Sheet S-29 for Location

**LOADING MS18**  
Allow 2.4 kN/m<sup>2</sup> for future wearing surface

**DESIGN STRESSES**  
FIELD UNITS  
f'c = 24 MPa  
fy = 400 MPa (Reinf.)  
fy = 345 MPa (Struct. M270M Grade 345)  
fy = 250 MPa (Struct. M270M Grade 250)

**DESIGN SPECIFICATIONS**  
1996 AASHTO with 1997 thru 2000 and 2002 Interims

**SEISMIC DATA**  
Seismic Performance Category (SPC) = A  
Bedrock Acceleration Coefficient (A) = 0.04g  
Site Coefficient = 1.0

**CURVE DATA I-80/94**

Δ = 20° 11' 25"  
D = 2.979°  
R = 1923.6  
T = 342.476  
L = 677.849  
E = 30.249  
P.C. = 7+380.276  
P.T. = 7+722.751  
P.T. = 8+058.125  
S.E. = 2.9%

\*Construct Wingwalls on chords between wall joints. See Offset Diagram on Sheet S-27

Median Varies  
3.600 m at Sta. 70+030.352  
0.000 m at Sta. 70+080.352

Temporary Soil Retention System (Stage I)  
Roadway Varies  
7.600 m at Sta. 70+030.352  
11.200 m at Sta. 70+080.352

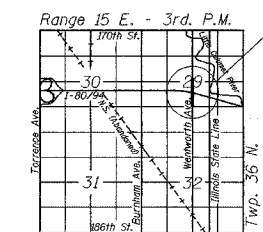

LOCATION SKETCH

ROUTE NO.	SECTION	COUNTY	SHEET	DATE	SHEET NO. S-1
F.A.I. 80/94	0808.18	COOK	1207	545	35 SHEETS
CONTRACT No. 62114					

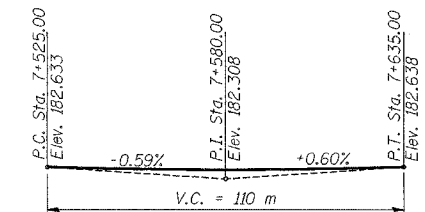

PROFILE GRADE I-80/94 WB

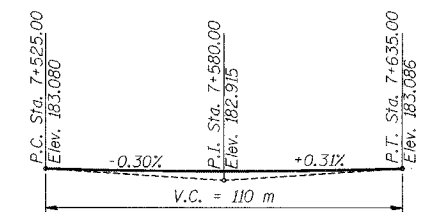

PROFILE GRADE I-80/94 EB

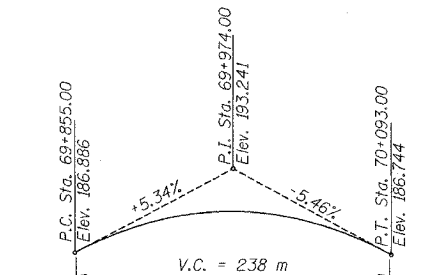

PROFILE GRADE WENTWORTH AVE.



GARY S. POWELL, S.E.  
IL. LIC. NO. 081-004771  
EXP \_\_\_\_\_  
DATE \_\_\_\_\_

ILLINOIS DEPARTMENT OF TRANSPORTATION  
F.A.I. ROUTE 80/94 (KINGERY EXPRESSWAY)  
UNDER WENTWORTH AVE  
GENERAL PLAN  
SECTION 2626.1B  
COOK COUNTY  
STATION 7+579.488  
STRUCTURE NO. 016-2790  
DATE 07/05



FOR INFORMATION ONLY