

THE FOLLOWING ITEMS SHALL BE REMOVED BY THE CONTRACTOR AND SHALL BE DISPOSED OF BY THEM OUTSIDE THE RIGHT-OF-WAY AT THEIR EXPENSE. THE SALVAGE VALUE OF THE REMOVED EQUIPMENT SHALL BE REFLECTED IN THE CONTRACT BID PRICE.

- 3 EACH SIGNAL HEAD, 2-FACE, 3-SECTION
- 4 EACH SIGNAL HEAD, 1-FACE, 3 SECTION
- 4 EACH PEDESTRIAN SIGNAL HEAD, 1-FACE
- 1 EACH TRAFFIC SIGNAL POST
- 4 EACH PEDESTRIAN PUSH-BUTTON

THE FOLLOWING EXISTING TRAFFIC SIGNAL EQUIPMENT SHALL BE REMOVED BY THE CONTRACTOR, SHALL REMAIN THE PROPERTY OF THE STATE AND SHALL BE DELIVERED BY THE CONTRACTOR TO THE STATE'S TRAFFIC SIGNAL MAINTENANCE FACILITY AS PER THE TRAFFIC SIGNAL SPECIFICATIONS.

- 1 EACH CONTROLLER AND CABINET COMPLETE

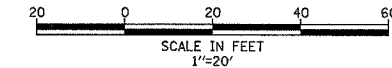

F.A.U. RTE.	SECTION	COUNTY	TOTAL SHEETS	SHEET NO.
1332	2004-022TS	COOK	20	14
STA.		TO STA.		
FED. ROAD DIST. NO.		ILLINOIS FED. AID PROJECT		
CONTRACT NO. 62741		EXIST. R.		

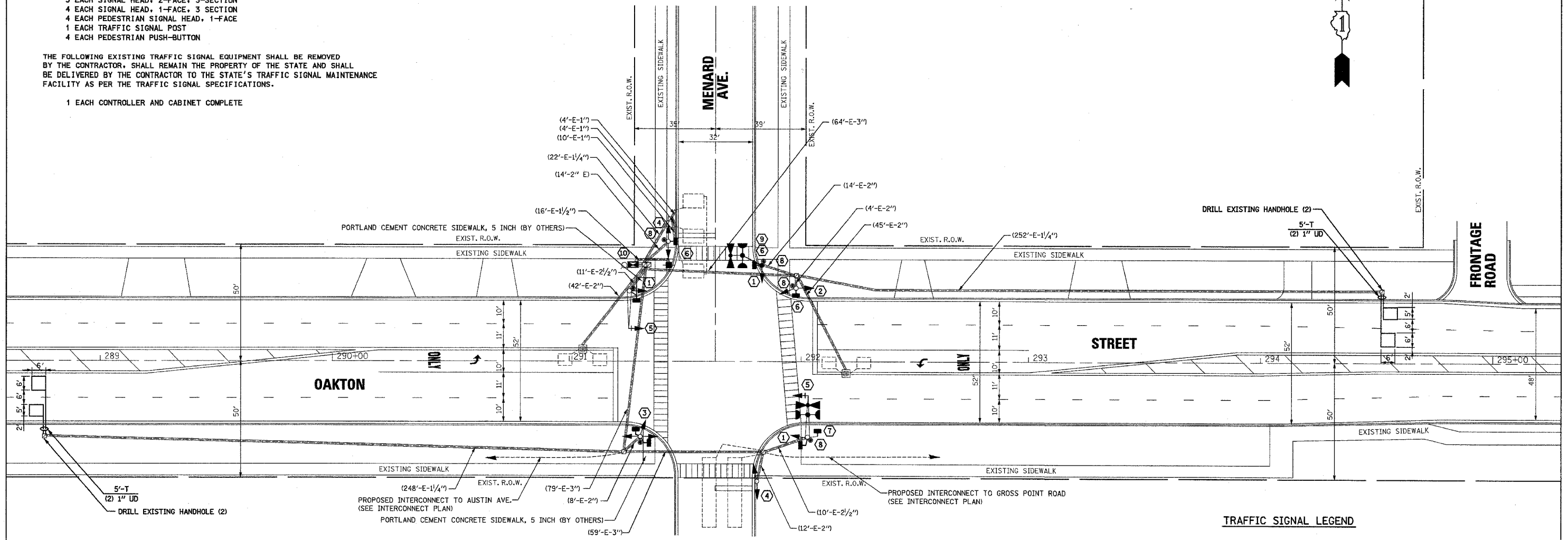

- CONSTRUCTION NOTES:**
- 1 REMOVE EXISTING 8" SIGNAL HEAD, 1-FACE, 3-SECTION, BRACKET MOUNTED, INSTALL NEW 12" SIGNAL HEAD, LED, 1-FACE, 3-SECTION, BRACKET MOUNTED.
 - 2 REMOVE EXISTING SIGNAL HEAD, 2-FACE, 1-3 SECTION, 1-5, SECTION, BRACKET MOUNTED, INSTALL NEW SIGNAL HEAD, LED, 2-FACE, 1-3 SECTION, 1-5, SECTION, BRACKET MOUNTED.
 - 3 REMOVE EXISTING SIGNAL HEAD, 3-FACE, 2-3 SECTION, 1-5 SECTION, BRACKET MOUNTED. INSTALL NEW SIGNAL HEAD, LED, 3-FACE, 2-3 SECTION, 1-5 SECTION, BRACKET MOUNTED.
 - 4 REMOVE EXISTING 8" SIGNAL HEAD, 2-FACE, 3-SECTION, BRACKET MOUNTED, INSTALL NEW 12" SIGNAL HEAD, LED, 2-FACE, 3-SECTION, BRACKET MOUNTED.
 - 5 REMOVE EXISTING SIGNAL HEAD, 1-FACE, 5-SECTION, MAST ARM MOUNTED. INSTALL NEW SIGNAL HEAD, LED, 1-FACE, 5-SECTION, MAST ARM MOUNTED.
 - 6 REMOVE EXISTING PEDESTRIAN SIGNAL HEAD, 1-FACE, BRACKET MOUNTED, INSTALL NEW PEDESTRIAN SIGNAL HEAD, LED, 1-FACE, BRACKET MOUNTED.
 - 7 REMOVE EXISTING PEDESTRIAN SIGNAL HEAD, 1-FACE, BRACKET MOUNTED, INSTALL NEW PEDESTRIAN SIGNAL HEAD, LED, 2-FACE, BRACKET MOUNTED.
 - 8 REMOVE EXISTING PEDESTRIAN PUSH-BUTTON. INSTALL NEW PEDESTRIAN PUSH-BUTTON.
 - 9 REMOVE EXISTING TRAFFIC SIGNAL POST, 16 FT. INSTALL NEW TRAFFIC SIGNAL POST, 18 FT.
 - 10 REMOVE EXISTING CONTROLLER AND CABINET. INSTALL NEW CONTROLLER AND TYPE IV CABINET, RE-USE EXISTING FOUNDATION.
 - 11 THE CONTRACTOR SHALL BE REQUIRED TO MAINTAIN THE OPERATION OF THE TRAFFIC SIGNALS DURING THE ENTIRE PROJECT.

		PROPOSED	EXISTING		
CONTROLLER				EMERGENCY VEHICLE LIGHT DETECTOR	
SERVICE INSTALLATION				CONFIRMATION BEACON	
SIGNAL HEAD				SIGNAL HEAD OPTICALLY PROGRAMMED	
SIGNAL HEAD WITH BACKPLATE				CONDUIT SPLICE	
SIGNAL HEAD, PEDESTRIAN				WOOD POLE	
SIGNAL POST				RACEWAY FOR MAGNETIC DETECTOR, TYPE I OR TYPE II	
MAST ARM ASSEMBLY AND POLE, STEEL				VEHICLE DETECTOR, NON COMPENSATED MAGNETIC TYPE	
MAST ARM ASSEMBLY AND POLE, ALUMINUM				RAILROAD CONTROL CABINET	
COMBINATION MAST ARM ASSEMBLY AND POLE, STEEL WITH LUMINAIRE				TELEPHONE CONNECTION	
UNIT DUCT				ILLUMINATED SIGN "NO LEFT TURN"	
COMMON TRENCH				ILLUMINATED SIGN "NO RIGHT TURN"	
HANDHOLE				MICROWAVE VEHICLE SENSOR	
HEAVY DUTY HANDHOLE				ILLUMINATED SIGN	
DOUBLE HANDHOLE					
G.S. CONDUIT IN TRENCH (T) OR PUSHED (P)					
PEDESTRIAN PUSHBUTTON DETECTOR					
DETECTOR LOOP					
CAST IRON JUNCTION BOX					

SETON ENGINEERING
CONSULTING SERVICE CORPORATION
 CIVIL ENGINEERS
 19 S. BOTHWELL STREET
 PALATINE, ILLINOIS 60067
 VOICE: 847-776-7200 FAX: 847-776-7239
SETON PROJECT # 2004070-001-006

REVISIONS	
NAME	DATE

ILLINOIS DEPARTMENT OF TRANSPORTATION
 TRAFFIC SIGNAL
 MODIFICATION AND
 REMOVAL PLAN
 OAKTON STREET AT MENARD AVENUE
 MORTON GROVE, ILLINOIS

SCALE: 1"=20'
 DATE 09-20-2004
 DRAWN BY BR
 DESIGNED BY VO
 CHECKED BY TJM