

F.A.U. RTE.	SECTION	COUNTY	TOTAL SHEETS	SHEET NO.
1332	2004-022TS	COOK	20	19
STA.		TO STA.		
FED. ROAD DIST. NO.		ILLINOIS FED. AID PROJECT		
CONTRACT NO. 62741				

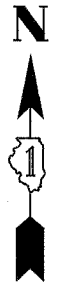

MATCH LINE STA. 280+00  
SEE SHEET 1 OF 2

MATCH LINE STA. 295+00  
SEE BELOW LEFT

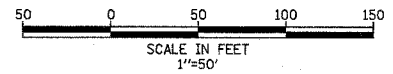
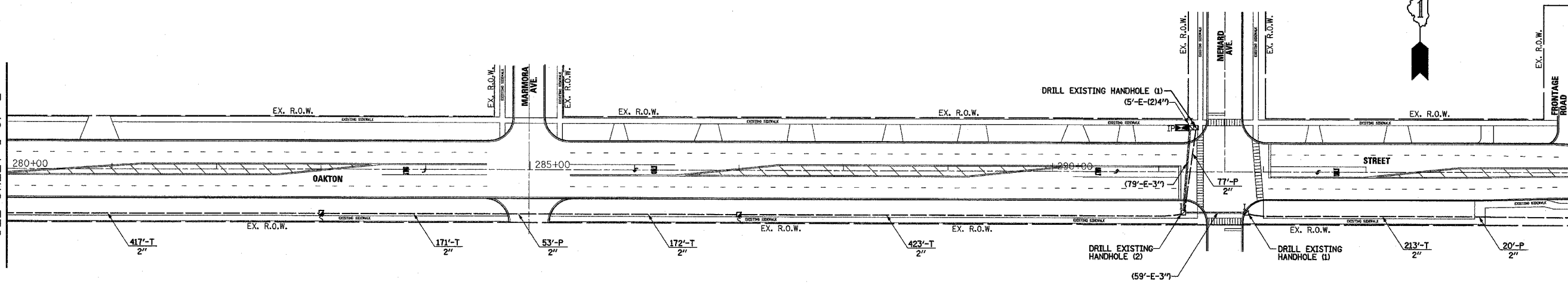

INTERCONNECT PLAN LEGEND

	PROPOSED	EXISTING
CONTROLLER		
HANDHOLE		
DOUBLE HANDHOLE		
HEAVY DUTY HANDHOLE		
G.S. CONDUIT IN TRENCH (T) OR PUSHED (P)		
DETECTOR LOOP		
UNIT DUCT		
SYSTEM		
INTERSECTION		
TELEPHONE CONNECTION		

MATCH LINE STA. 295+00  
SEE ABOVE RIGHT

STA. 310+00  
END OF PROJECT

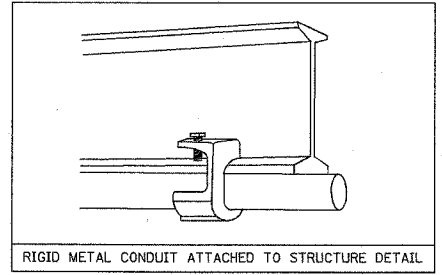
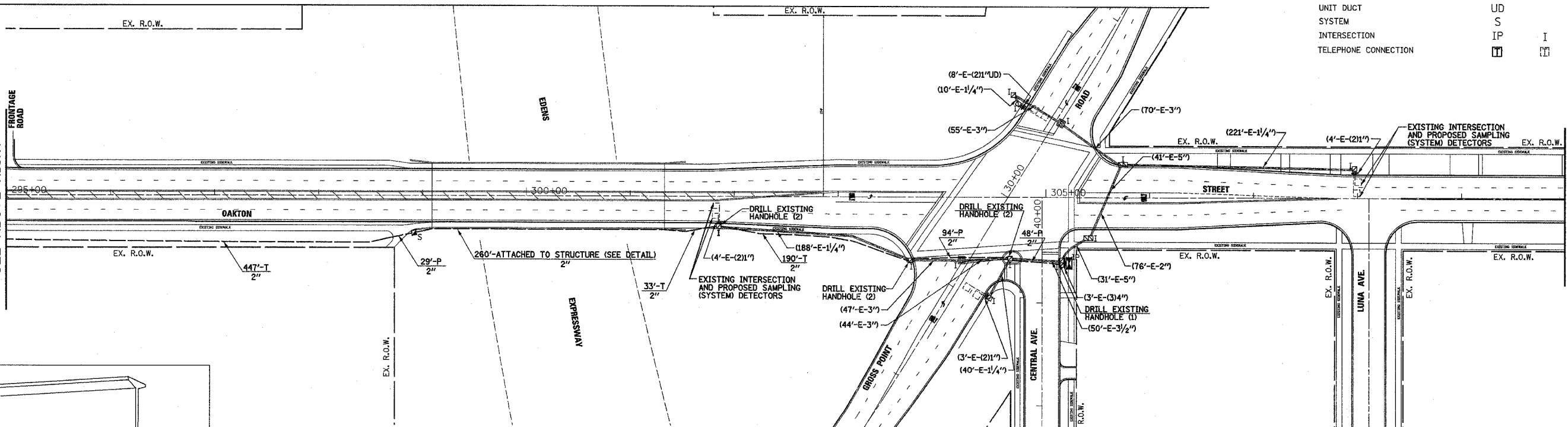

**SETON ENGINEERING**  
SERVICE CORPORATION  
CIVIL ENGINEERS  
19 S. BOTHWELL STREET  
PALATINE, ILLINOIS 60067  
VOICE 847-776-7200 FAX 847-776-7239  
SETON PROJECT # 2002001-200-204

REVISIONS	
NAME	DATE

ILLINOIS DEPARTMENT OF TRANSPORTATION  
**INTERCONNECT PLAN**  
OAKTON AVENUE  
FROM AUSTIN AVENUE TO GROSS POINT ROAD  
MORTON GROVE, IL  
SHEET 2 OF 2  
SCALE: 1" = 50'  
DATE 09-20-2004  
DRAWN BY BR  
DESIGNED BY VO  
CHECKED BY TJM