

F. A. RT.	SECTION	COUNTY	TOTAL SHEETS	SHEET NO.
VAR.	2004-090 I	VARIOUS	13	7
STA.	TO STA.			
FED. ROAD DIST. NO.	BLANKS	FED. AID PROJECT		

CONTRACT NO. 62830

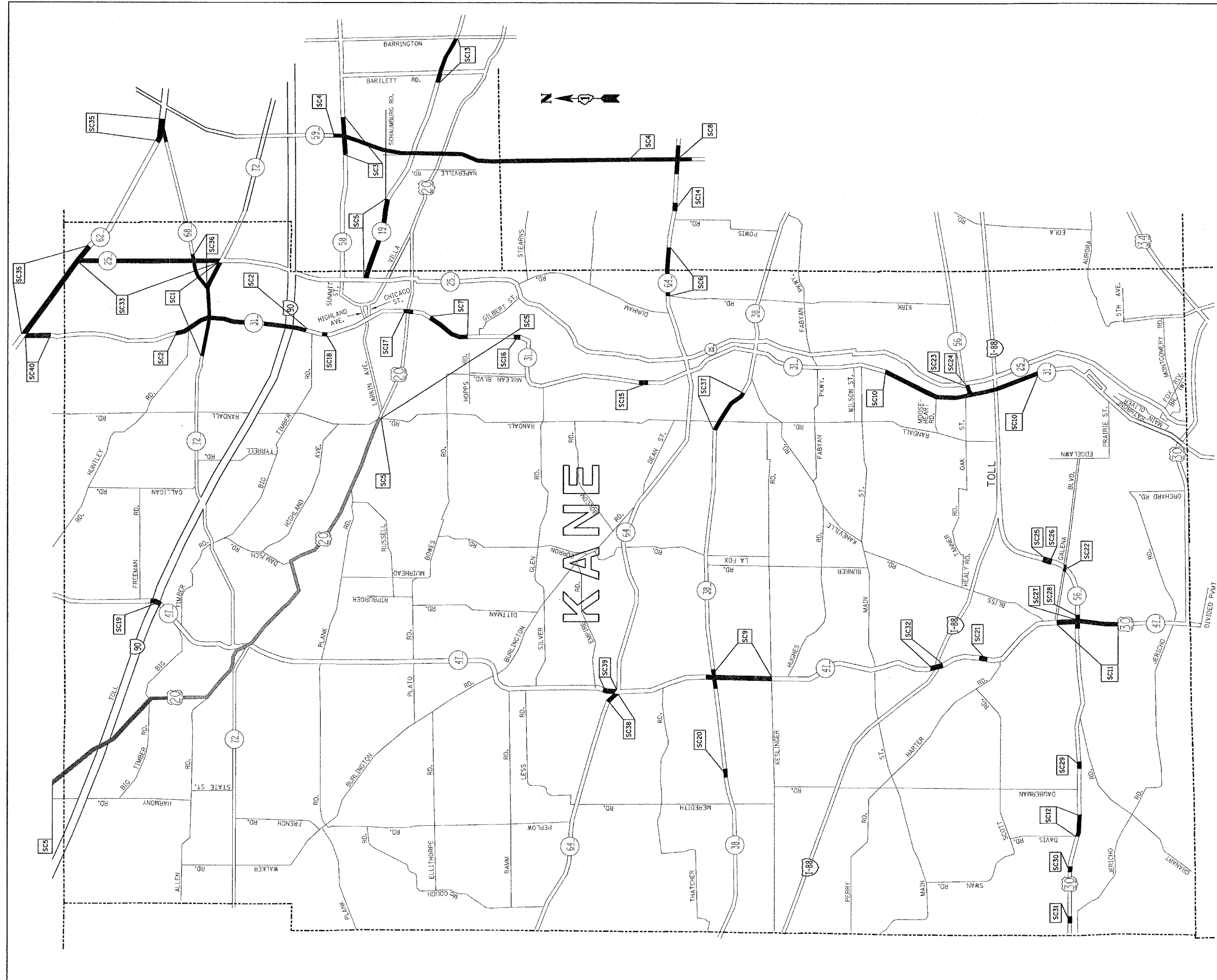

TEAM SECTION
ST. CHARLES

KEY LOCATIONS
SC1 - SC39

- DISTRICT NO. 1
- STATE HIGHWAYS & EXPRESSWAYS WITHIN STATE JURISDICTION (EXCEPT TOLLWAYS)
 - STATE HIGHWAYS & EXPRESSWAYS TO BE CLEANED
 - FUTURE HIGHWAYS
 - VARIOUS AGENCIES HIGHWAYS

ILLINOIS DEPARTMENT OF TRANSPORTATION

ARTERIAL CLEANING
LOCATION MAP
KANE COUNTY
ST. CHARLES TEAM SECTIONS

REVISIONS	
NAME	DATE

SCALE: 1"=1.5 MILES
DATE: 10/17/2005

DRAWN BY: CADD
CHECKED BY: