

STATE OF ILLINOIS
DEPARTMENT OF TRANSPORTATION

ROUTE NO.	SECTION	COUNTY	DATE	SHEET	SHEET NO. 3 14 SHEETS
FAU 3578	1327 F	COOK	16	5	
FED. ROAD DIST. NO. 7	ILLINOIS	FED. AID PROJECT			

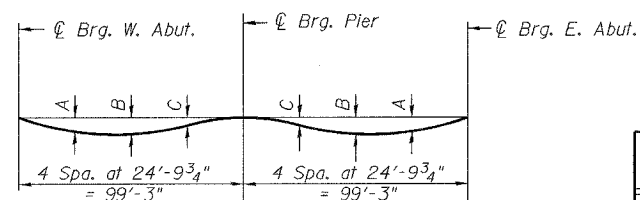

DEAD LOAD DEFLECTION DIAGRAM

(Includes weight of concrete only.)

Note:
The above deflections are not to be used in the field if the engineer is working from the grade elevations adjusted for dead load deflections as shown on sheets 4 and 5 of 14.

GIRDER NO.	DEFLECTION (in)		
	A	B	C
1	1 1/4	1 1/2	5/8
2 thru 7	3/4	7/8	3/8

TABLE OF DEAD LOAD DEFLECTIONS

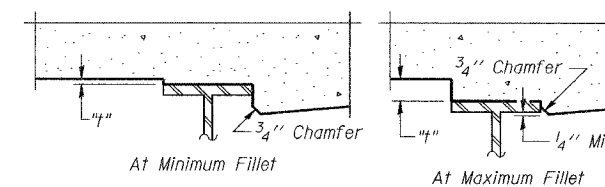
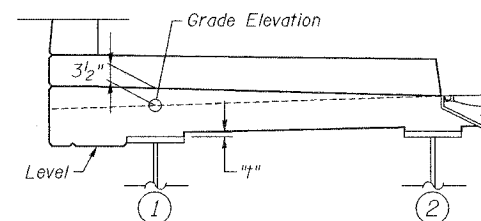

To determine "t": After all structural steel has been erected, elevations of the top flanges of the girders shall be taken at intervals shown below. These elevations subtracted from the "Theoretical Grade Elevations Adjusted for Dead Load Deflection" shown on sheets 4 and 5 of 14, minus slab thickness, equals the fillet heights "t" above top flange of girders.

FILLET HEIGHTS

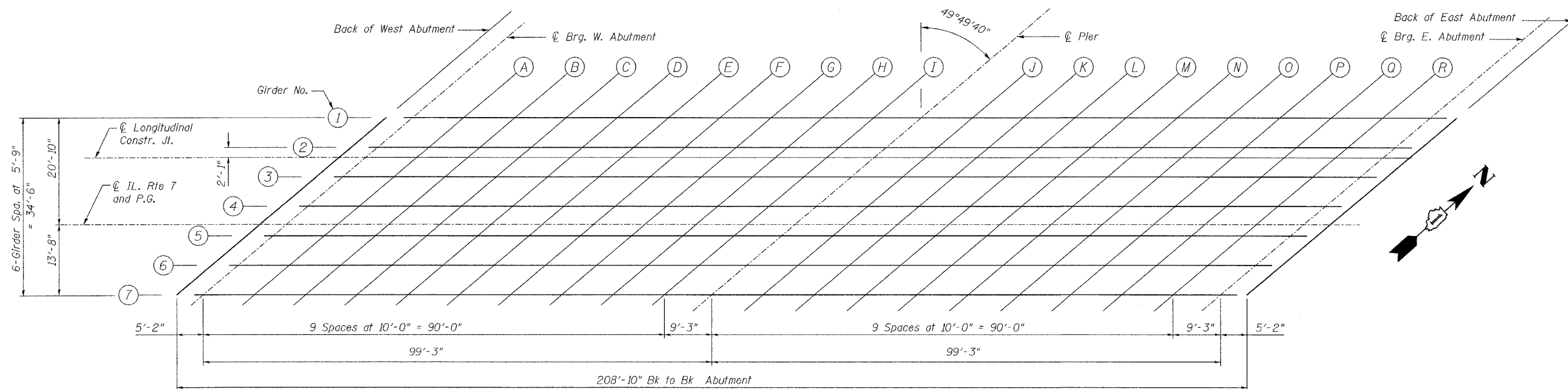

PLAN

DESIGNED	JJI
CHECKED	SRT
DRAWN	GM
CHECKED	SRT

B Bollinger, Lach & Associates, Inc.

E-S 10-22-04

FOR INFORMATION ONLY
NOT PART OF THIS CONTRACT

TOP OF SLAB ELEVATIONS
IL 7 (SOUTHWEST HIGHWAY) OVER
US 45 (LA GRANGE ROAD)
F.A.U. ROUTE 3578 SECTION 1327F
COOK COUNTY
STA. 1516+85.79
STRUCTURE NUMBER 016-2847