

F.A.P. RTE.	SECTION	COUNTY	TOTAL SHEETS	SHEET NO.
303	129K	WINNEBAGO	585	1

STATE OF ILLINOIS
DEPARTMENT OF TRANSPORTATION
DIVISION OF HIGHWAYS

**PROPOSED
HIGHWAY PLANS**

FAP ROUTE 303 (IL 173)
SECTION 129K
PROJECT HPD-ACF-0132 (128)
WINNEBAGO COUNTY
C-92-098-05



LOCATION OF SECTION INDICATED THUS: - [black rectangle] -

FOR INDEX OF SHEETS, SEE SHEET NO. 2
FOR LIST OF IDOT HIGHWAY STANDARDS, SEE SHEET NO. 2
FOR LIST OF IDOT DISTRICT - 2 STANDARDS, SEE SHEET NO. 2
FOR LIST OF ISTHA STANDARDS, SEE SHEET NO. 2

DESIGN DESIGNATION

- FAP ROUTE 303 (IL 173) - 3740(25) PRINCIPAL ARTERIAL 4.27 (B-20)
- FAI ROUTE 90 (I-90) - 7580(25) INTERSTATE 4.27 (B-20)
- RAMP A - 705(25) RAMP 4.27 (B-20)
- RAMP B - 600(25) RAMP 4.27 (B-20)
- RAMP C - 480(25) RAMP 4.27 (B-20)
- RAMP D - 860(25) RAMP 4.27 (B-20)

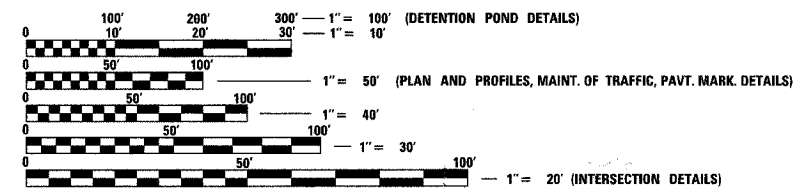

FULL SIZE PLANS HAVE BEEN PREPARED USING STANDARD ENGINEERING SCALES. REDUCED SIZED PLANS WILL NOT CONFORM TO STANDARD SCALES. IN MAKING MEASUREMENTS ON REDUCED PLANS, THE ABOVE SCALES MAY BE USED.

J.U.L.I.E.
JOINT UTILITY LOCATION INFORMATION FOR EXCAVATION
1-800-892-0123

CONTRACT NO. 64594

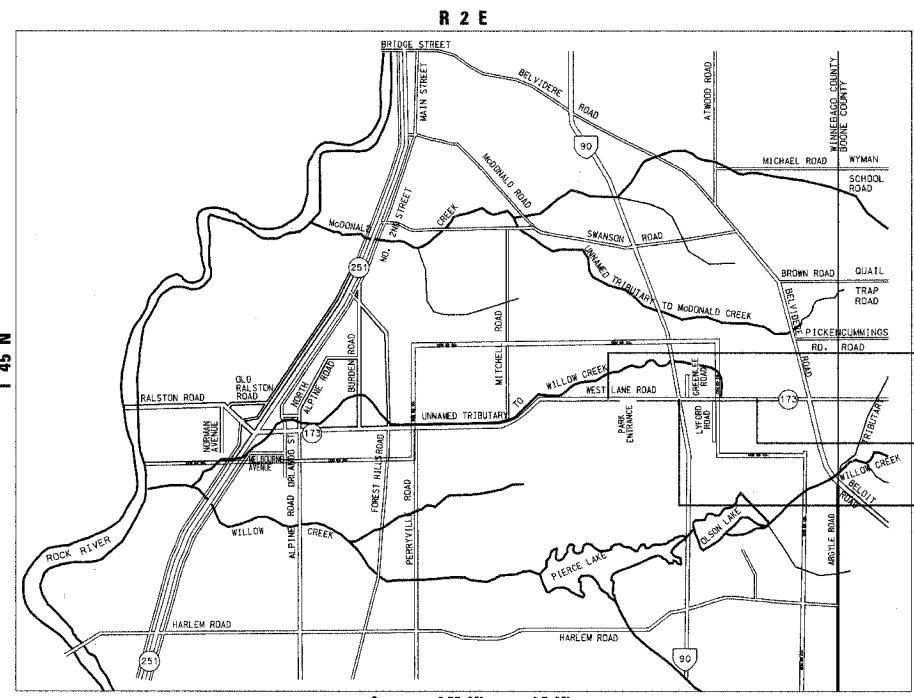

SECTION BEGINS
STA. 142 + 32.87

SECTION ENDS
STA. 231 + 14.10

SN 101-9964 (NB)/SN 101-9963 (SB)
STA. 192 + 56.09 IL 173 /
STA. 443 + 73.62 I-90
CONSISTS OF REMOVING AND REPLACING
THE EXISTING STRUCTURES NO. 101-9905 (NB)
AND 101-9906 (SB) WITH TWO-TWO-SPAN,
PPC COMPOSITE BEAM STRUCTURES ON
SPILL-THRU ABUTMENTS WITH 61' (NB)
AND 74'6" (SB) CLEAR ROADWAY WIDTHS,
AND RELATED ROADWAY WORK

GROSS LENGTH OF IMPROVEMENT = 1.68 MILES
NET LENGTH OF IMPROVEMENT = 1.68 MILES



Jamal Grainawi 9/15/05
JAMAL GRAINAWI
IL REGISTRATION #081-005161
PARSONS BRINCKERHOFF
SHEETS 180-226

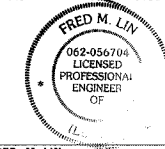

Fred M. Lin 9/15/05
FRED M. LIN
IL REGISTRATION #062-056704
LIN ENGINEERING LTD.
SHEETS 117-129, 142-145, 301-306



Patrick D. Stewart 9/15/05
PATRICK D. STEWART
IL REGISTRATION #062-046612
MCCLURE ENGINEERING ASSOC. INC.
SHEETS 1-58, 69-116, 130-141, 146-153, 227-232, 263-300, 307-585

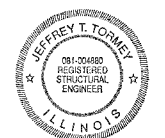

Jeffrey A. Torney 9/15/05
JEFFREY A. TORNEY
IL REGISTRATION #081-004880
MCCLURE ENGINEERING ASSOC. INC.
SHEETS 281 & 282

MCC McClure Engineering Associates, Inc.
7282 Argus Drive
(815) 398-2332
Rockford, Illinois 61107
FAX (815) 398-2496

PR 100 YEARS
230 West Monroe Street
Suite 350
Chicago, Illinois
60606
(312) 782-8150

LE LIN ENGINEERING, LTD.
608 Citadel Drive
(630) 323-5168
Westmont, IL 60559

STATE OF ILLINOIS
DEPARTMENT OF TRANSPORTATION
DIVISION OF HIGHWAYS
SUBMITTED September 16, 2005
Shawn J. Menden
DEPUTY DIRECTOR OF HIGHWAYS, REGION ENGINEER
October 14, 2005
Mike Hine
ENGINEER OF DESIGN AND ENVIRONMENT
October 14, 2005
Eric E. Harn
Deputy DIRECTOR OF HIGHWAYS, CHIEF ENGINEER

**PRINTED BY THE AUTHORITY
OF THE STATE OF ILLINOIS**

PROJECT ENGINEER: BOB WAGNER (815) 284-5358
McClure Engineering: PATRICK D. STEWART (815) 398-2332
LIAISON ENGINEER: SAMEER ABDULLAH (815) 284-5935