

F.A.P. RTE.	SECTION	COUNTY	TOTAL SHEETS	SHEET NO.
303	129K	WINNEBAGO	585	81
STA. 466+00 TO STA. 481+00		ILLINOIS FED. AID PROJECT		

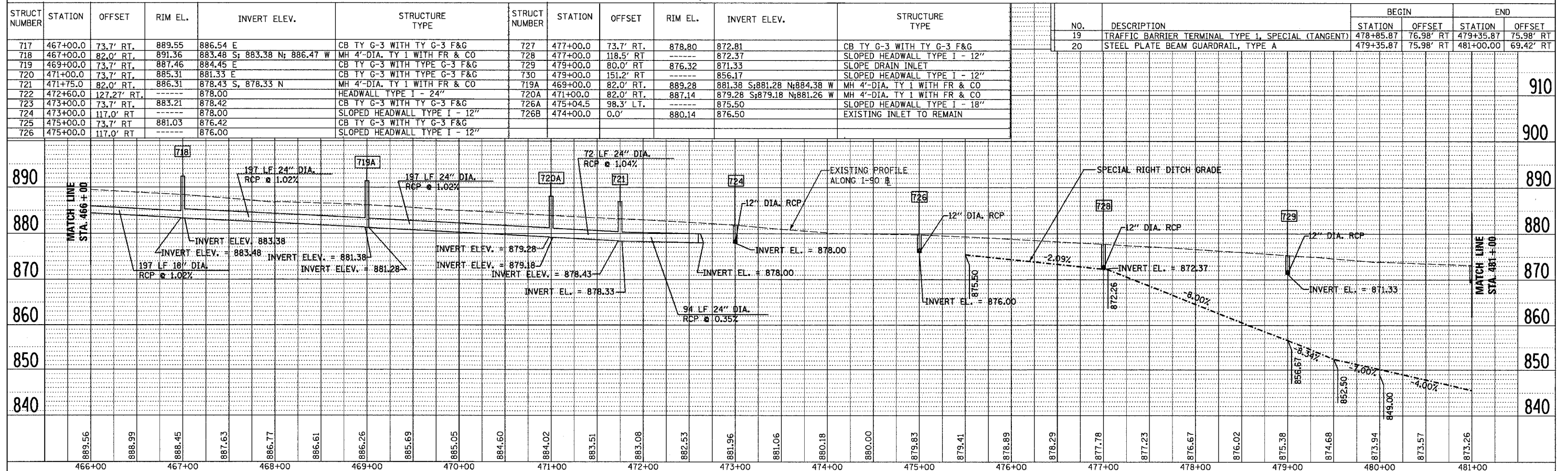
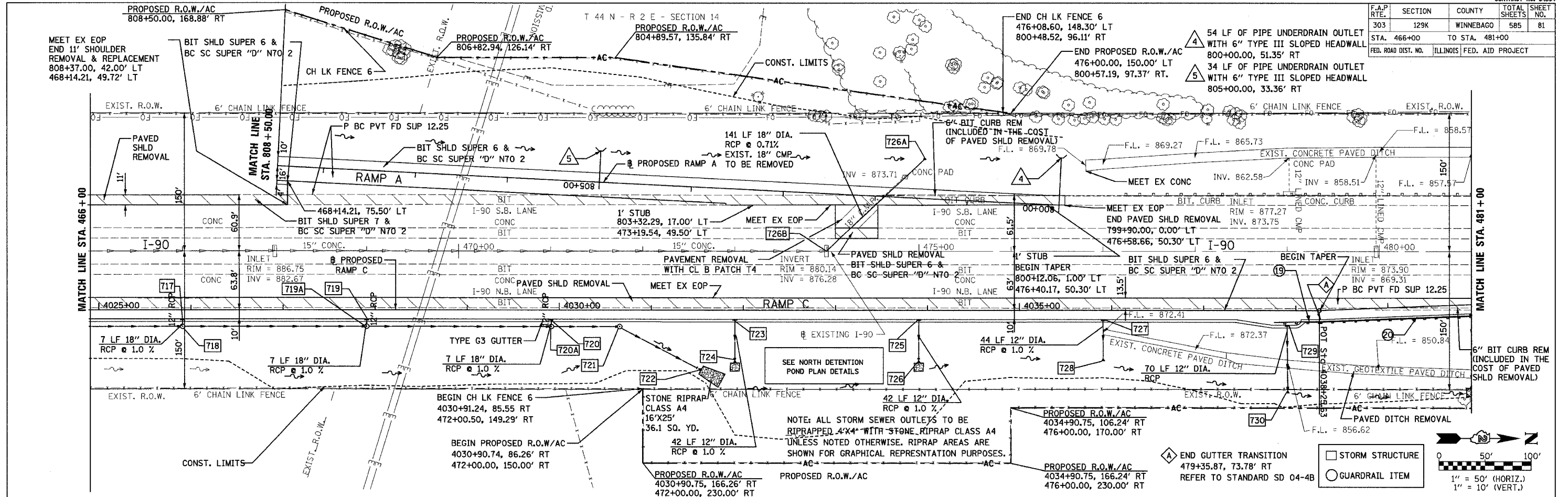

STRUCT NUMBER	STATION	OFFSET	RIM EL.	INVERT ELEV.	STRUCTURE TYPE
717	467+00.0	73.7' RT.	889.55	886.54 E	CB TY G-3 WITH TY G-3 F&G
718	467+00.0	82.0' RT.	891.36	883.48 S; 883.38 N; 886.47 W	MH 4'-DIA. TY 1 WITH FR & CO
719	469+00.0	73.7' RT.	887.46	884.45 E	CB TY G-3 WITH TYPE G-3 F&G
720	471+00.0	73.7' RT.	885.31	881.33 E	CB TY G-3 WITH TYPE G-3 F&G
721	471+75.0	82.0' RT.	886.31	878.43 S, 878.33 N	MH 4'-DIA. TY 1 WITH FR & CO
722	472+60.0	127.2' RT.	878.00	---	HEADWALL TYPE I - 24"
723	473+00.0	73.7' RT.	883.21	878.42	CB TY G-3 WITH TY G-3 F&G
724	473+00.0	117.0' RT.	878.00	---	SLOPED HEADWALL TYPE I - 12"
725	475+00.0	73.7' RT.	881.03	876.42	CB TY G-3 WITH TY G-3 F&G
726	475+00.0	117.0' RT.	---	876.00	SLOPED HEADWALL TYPE I - 12"

NO.	DESCRIPTION	STATION	OFFSET	STATION	OFFSET
19	TRAFFIC BARRIER TERMINAL TYPE 1, SPECIAL (TANGENT)	478+85.87	76.98' RT	479+35.87	75.98' RT
20	STEEL PLATE BEAM GUARDRAIL, TYPE A	479+35.87	75.98' RT	481+00.00	69.42' RT

DATE: \_\_\_\_\_  
 BY: \_\_\_\_\_  
 CHECKED: \_\_\_\_\_  
 DATE: \_\_\_\_\_

DATE: \_\_\_\_\_  
 BY: \_\_\_\_\_  
 CHECKED: \_\_\_\_\_  
 DATE: \_\_\_\_\_