

F.A.P. RTE.	SECTION	COUNTY	TOTAL SHEETS	SHEET NO.
303	129K	WINNEBAGO	585	82
STA. 481+00		TO STA. 482+47.91		
FED. ROAD DIST. NO.		ILLINOIS FED. AID PROJECT		

T 44 N - R 2 E - SECTION 14

DATE: _____
 BY: _____
 CHECKED: _____
 APPROVED: _____

DATE: _____
 BY: _____
 CHECKED: _____
 APPROVED: _____

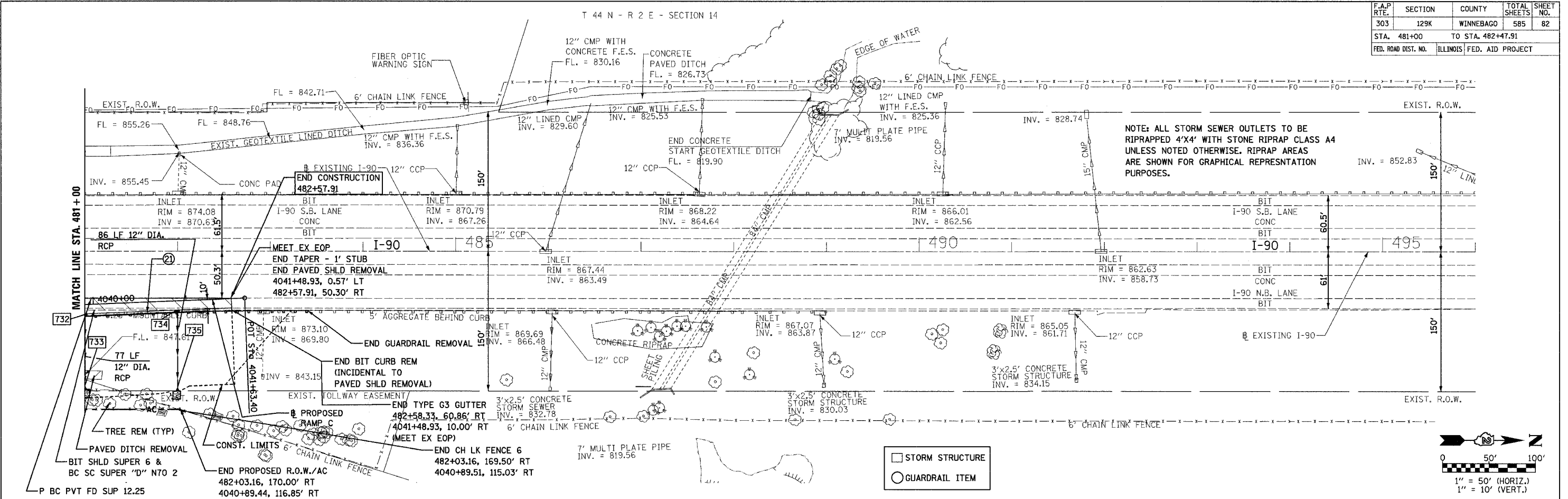

NOTE: ALL STORM SEWER OUTLETS TO BE RIPRAPPED 4'x4' WITH STONE RIPRAP CLASS A4 UNLESS NOTED OTHERWISE. RIPRAP AREAS ARE SHOWN FOR GRAPHICAL REPRESENTATION PURPOSES.

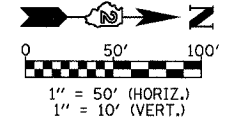

STRUCT NUMBER	STATION	OFFSET	RIM EL.	INVERT ELEV.	STRUCTURE TYPE	BEGIN		END			
						STATION	OFFSET	STATION	OFFSET		
						21	STEEL PLATE BEAM GUARDRAIL, TYPE A	481+00.00	69.42' RT	483+40.37	63.75' RT
732	481+00.0	67.2' RT	874.50	869.51	SLOPE DRAIN INLET						
733	481+00.0	146.1' RT	874.50	845.00	SLOPED HEADWALL TYPE I - 12"						
734	482+00.0	62.4' RT	873.60	868.60	SLOPE DRAIN INLET						
735	482+00.0	149.8' RT	873.60	841.00	SLOPED HEADWALL TYPE I - 12"						
											900
											890
											880
											870
											860
											850
											840
											830
	481+00		873.26								
	482+00		872.91								
	483+00		872.50								
	484+00		872.04								
	485+00		871.57								
	486+00		870.89								
	487+00		870.20								
	488+00		869.65								
	489+00		869.18								
	490+00		868.28								
	491+00		867.66								
	492+00		867.50								
	493+00		867.32								
	494+00		866.82								
	495+00		866.38								
	496+00		865.97								
			865.59								
			865.15								
			864.76								
			864.39								
			863.99								
			863.29								
			862.68								
			862.74								
			862.80								
			862.50								
			862.25								
			861.85								
			861.54								
			861.21								
			860.88								