

F.A.P. RTE.	SECTION	COUNTY	TOTAL SHEETS	SHEET NO.
303	I29K	WINNEBAGO	585	100
STA.	TO STA.			
FED. ROAD DIST. NO.	ILLINOIS	FED. AID PROJECT		

# MAINTENANCE OF TRAFFIC DETAILS – IL 173 AND ROCK CUT STATE PARK ENTRANCE

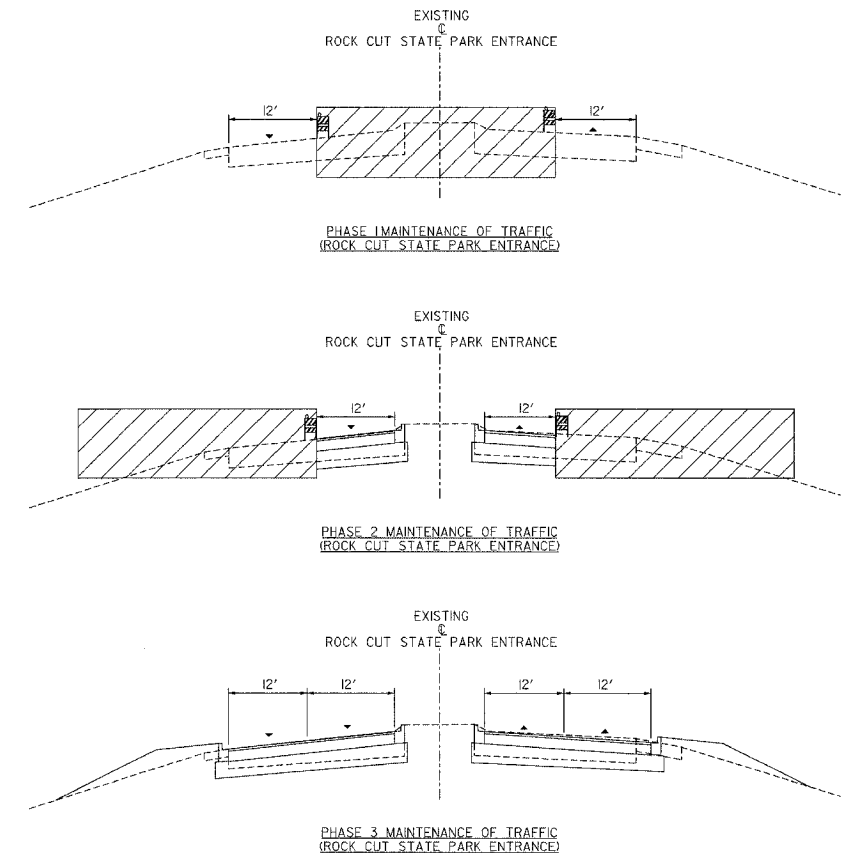
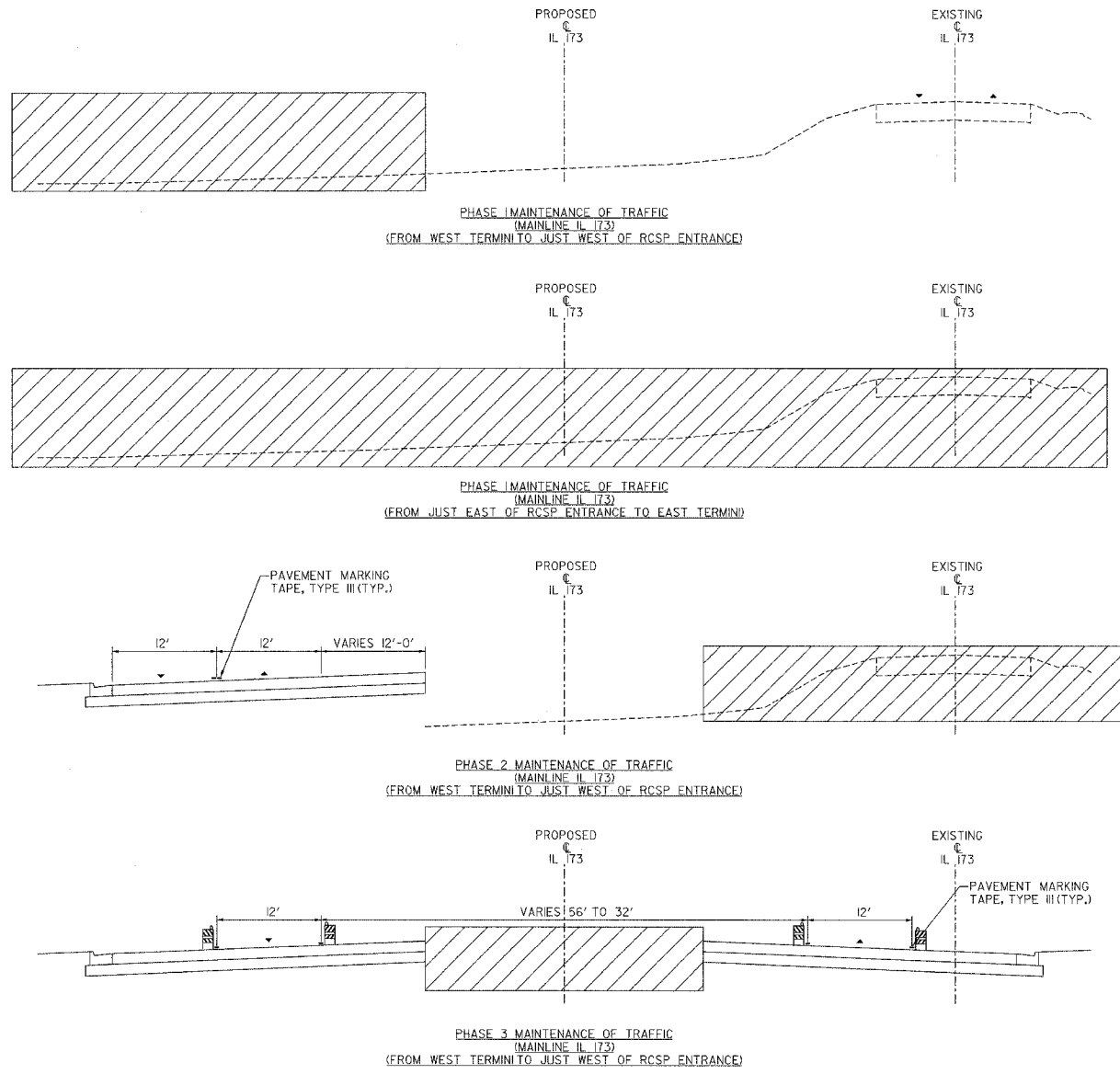

**KEY**  
 - DIRECTION OF TRAFFIC  
 - WORK ZONE

**NOTES:**  
 1. ALL TEMPORARY LANE STRIPING TO BE 4 INCHES WIDE.  
 2. ITEMS SHOWN WITH DOTTED LINES ARE EXISTING.

- IL 173 AND ROCK CUT STATE PARK ENTRANCE STAGING NOTES:**
- PHASE I**
- CLOSE IL 173 BETWEEN IMMEDIATELY EAST OF ROCK CUT STATE PARK ENTRANCE AND AT BELVIDERE ROAD.
  - CONSTRUCT ALL LANES AND MEDIAN FROM EAST OF PARK ENTRANCE TO EAST END OF PROJECT.
  - CONSTRUCT NEW WESTBOUND LANES FROM WEST END OF PROJECT TO PARK ENTRANCE.
  - CONSTRUCT NEW MEDIAN AND CENTER LANES FOR THE PARK ENTRANCE.
  - REMOVE SMALL ISLAND ON EAST SIDE OF PARK ENTRANCE AND PLACE TEMPORARY PAVEMENT.
  - PLACE TEMPORARY PAVEMENT (RUN-AROUND) AT WEST END OF PROJECT AND AT PARK ENTRANCE (BETWEEN NEW AND EXISTING IL 173 PAVEMENT).
- PHASE II**
- REROUTE IL 173 TRAFFIC ONTO NEW WESTBOUND LANES BETWEEN WEST END OF PROJECT AND PARK ENTRANCE.
  - CONSTRUCT NEW EASTBOUND LANES FROM WEST END OF PROJECT TO PARK ENTRANCE.
  - CONSTRUCT OUTER LANES FOR THE PARK ENTRANCE.
- PHASE III**
- REROUTE IL 173 TRAFFIC TO ONE LANE EACH DIRECTION ON THE OUTSIDE OF THE NEW WESTBOUND AND EASTBOUND LANES.
  - CONSTRUCT MEDIAN FROM WEST END OF PROJECT TO PARK ENTRANCE.

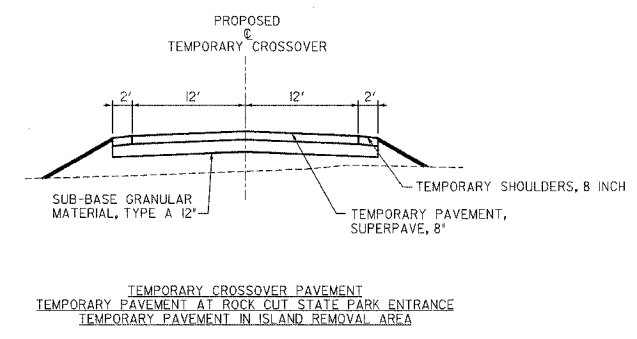

**TEMPORARY CROSSOVER PAVEMENT**  
 TEMPORARY PAVEMENT AT ROCK CUT STATE PARK ENTRANCE  
 TEMPORARY PAVEMENT IN ISLAND REMOVAL AREA

STRUCTURAL DESIGN INFORMATION - FLEXIBLE PAVEMENT	
TEMPORARY PAVEMENT - IL 173	
STRUCTURAL DESIGN TRAFFIC: IL 173	YEAR: 2015
Pv=270	SU=21 MU=9
PERCENT OF STRUCTURAL TRAFFIC IN DESIGN LANE: P=50% S=50% M=50%	
TRAFFIC FACTOR: Actual TF=0.0024	Minimum TF=0.50
AC Type=20	AC Mixture Temp.=76.3 F
AC Mixture Modulus=650.0 KSI	Design Strain = 130 Micro strain
AC Grade: Binder=PG64-22	Surface=PG64-22
Flexible Pavement Thickness= 8'	Binder= 6'
Surface=2'	
Sub grade Support Rating: POOR	

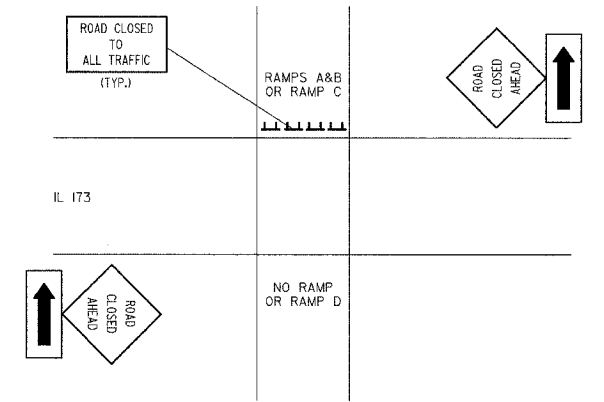

DETAIL OF RAMP CLOSURE  
 IN ACCORDANCE WITH  
 DISTRICT 2 STANDARD 40.1g

REVISIONS		ILLINOIS DEPARTMENT OF TRANSPORTATION
NAME	DATE	
		<b>MAINTENANCE OF TRAFFIC DETAILS –                      IL 173 AND ROCK CUT                      STATE PARK ENTRANCE</b>

VERT. N/A  
 SCALE: HORIZ. N/A  
 DATE: SEPTEMBER 14, 2005  
 DRAWN BY: KRL  
 CHECKED BY: PDS