

F.A.P. RTE.	SECTION	COUNTY	TOTAL SHEETS	SHEET NO.
303	I29K	WINNEBAGO	585	103
STA.	TO STA.			
FED. ROAD DIST. NO.	ILLINOIS	FED. AID PROJECT		

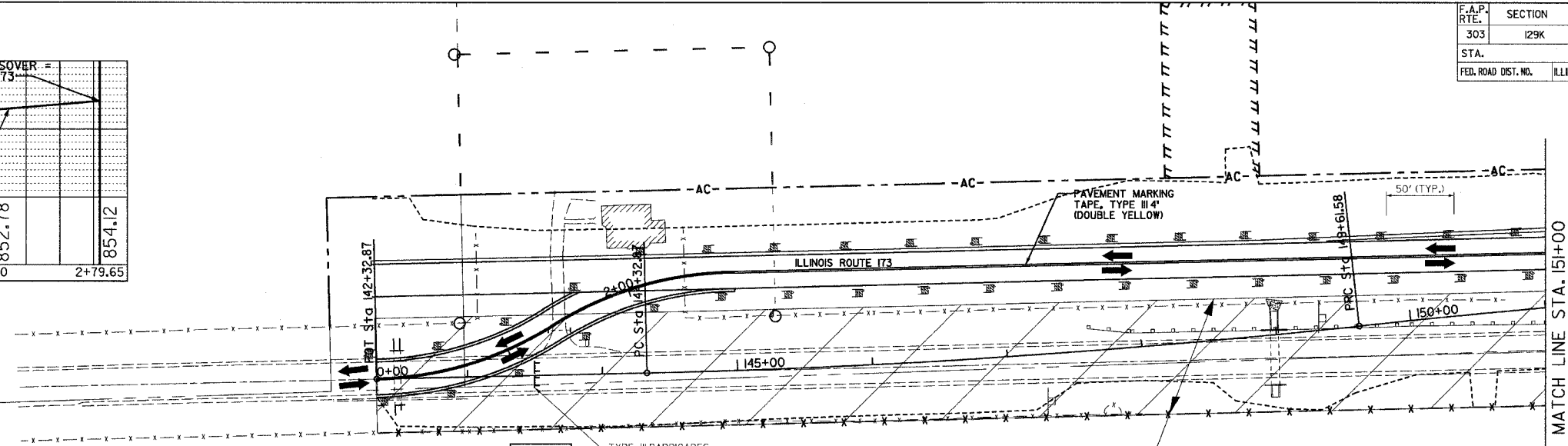

CROSSOVER ADVANCE WARNING SIGNS TO BE PLACED PER IDOT STD 701331-02

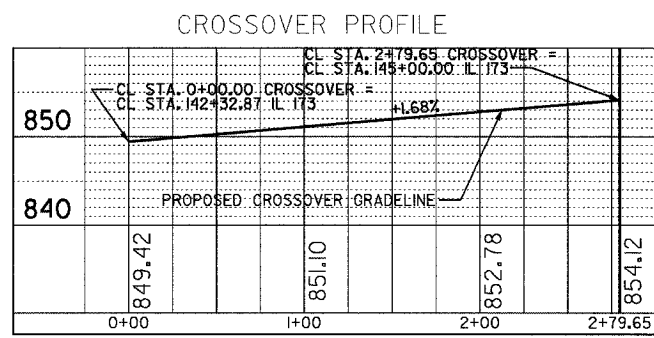
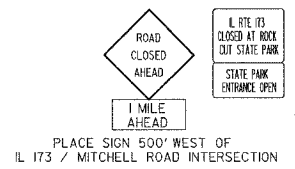

CURVE DATA	CURVE DATA
PI STA. = 0+70.30	PI STA. = 2+07.99
I = 30° 49' 31"	I = 31° 02' 03" (LT)
D = 22° 28' 08"	D = 22° 28' 08"
R = 255'	R = 255'
T = 70.30'	T = 70.80'
L = 137.9'	L = 138.12'
E = 9.5'	E = 9.65'
e = N/C	e = N/C
P.C. STA. = 0+00.00	P.C. STA. = 1+37.19
P.T. STA. = 1+37.19	P.T. STA. = 2+75.31

- WORK TO BE PERFORMED IN PHASE 2:
1. CONTINUE CONSTRUCTION EAST OF ROCK CUT STATE PARK ENTRANCE.
 2. CONSTRUCT EASTBOUND IL 173 LANES WEST OF ROCK CUT STATE PARK ENTRANCE.
 3. REMOVE WEST ISLAND AT ROCK CUT STATE PARK ENTRANCE.
 4. CONSTRUCT OUTSIDE LANES ON ROCK CUT STATE PARK ENTRANCE.



- LEGEND:**
- WORK ZONE
 - TRAFFIC MOVEMENT
 - DRUMS / TYPE II BARRICADES WITH STEADY BURN LIGHTS
 - TEMPORARY CONCRETE BARRIER
 - PRECAST BARRIER WITH "BRIDGE OUT" SIGN

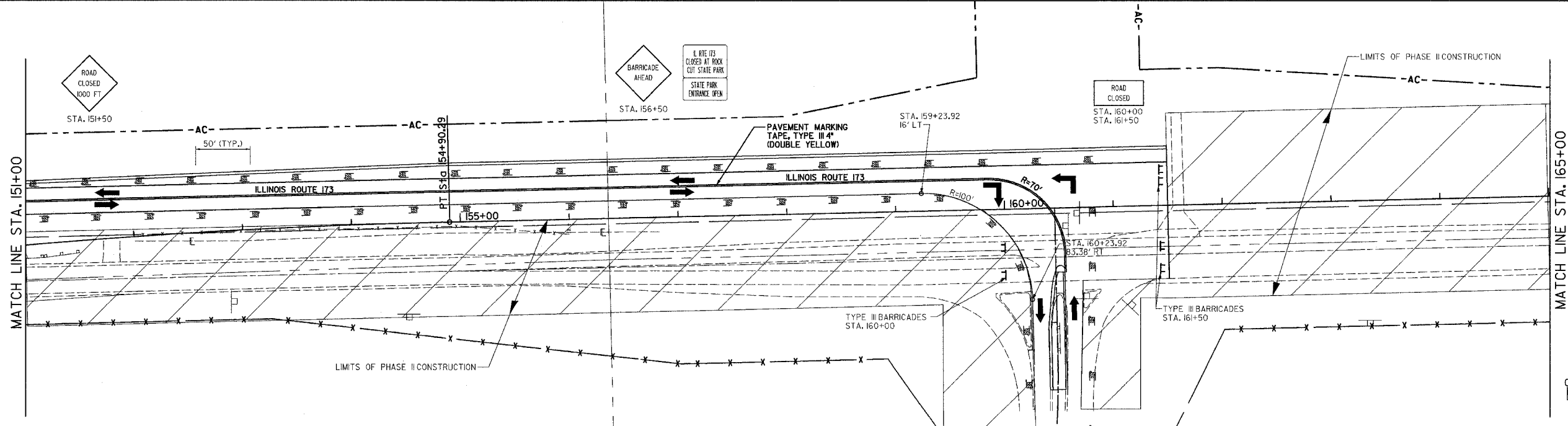

- LEGEND:**
- WORK ZONE
 - TRAFFIC MOVEMENT
 - DRUMS / TYPE II BARRICADES WITH STEADY BURN LIGHTS
 - TEMPORARY CONCRETE BARRIER
 - PRECAST BARRIER WITH "BRIDGE OUT" SIGN

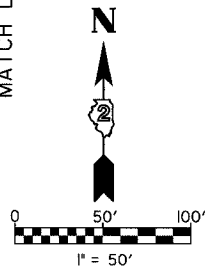

REVISIONS	
NAME	DATE

ILLINOIS DEPARTMENT OF TRANSPORTATION

MAINTENANCE OF TRAFFIC IL 173 PHASE 2

SCALE: VERT. N/A
 HORIZ. 1" = 50'
 DATE: SEPTEMBER 14, 2005

DRAWN BY: KRL
 CHECKED BY: PDS