

F.A.P. RTE.	SECTION	COUNTY	TOTAL SHEETS	SHEET NO.
303	I29K	WINNEBAGO	585	115
STA.		TO STA.		
FED. ROAD DIST. NO.		ILLINOIS FED. AID PROJECT		

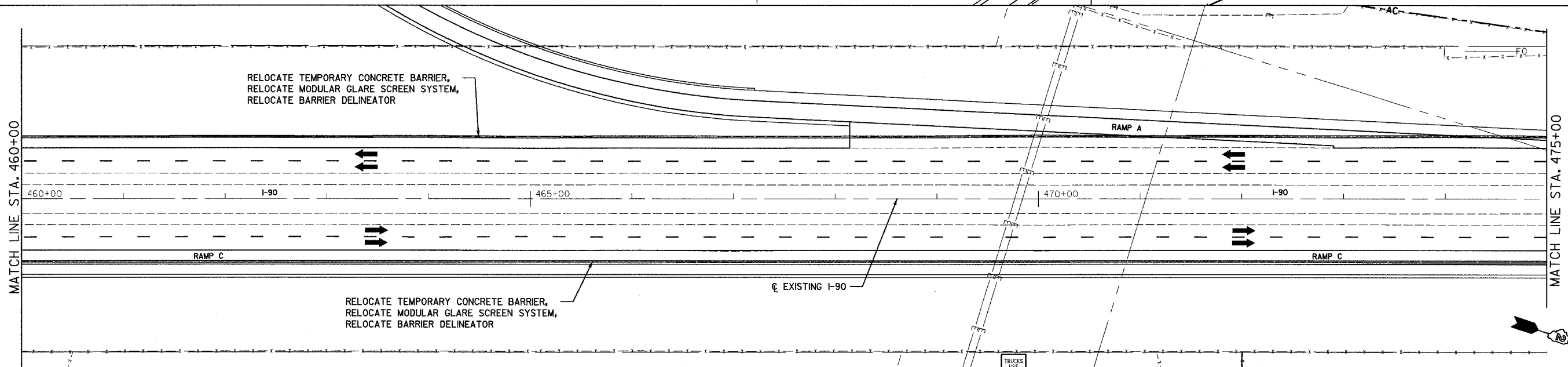

- LEGEND:**
- WORK ZONE
  - TRAFFIC MOVEMENT
  - DRUMS / TYPE II BARRICADES WITH STEADY BURN LIGHTS
  - TEMPORARY CONCRETE BARRIER
  - PRECAST BARRIER WITH 'BRIDGE OUT' SIGN
  - TEMP. INERTIAL CRASH CUSHION SYSTEM PER STD. SD 03-108 9 MODULES FOR 45 MPH POSTED SPEED

TRUCKS USE LEFT LANE  
R4-5 (SPECIAL)  
NB LOCATION STA 470+00 LT&RT  
SB LOCATION STA 470+00 LT&RT

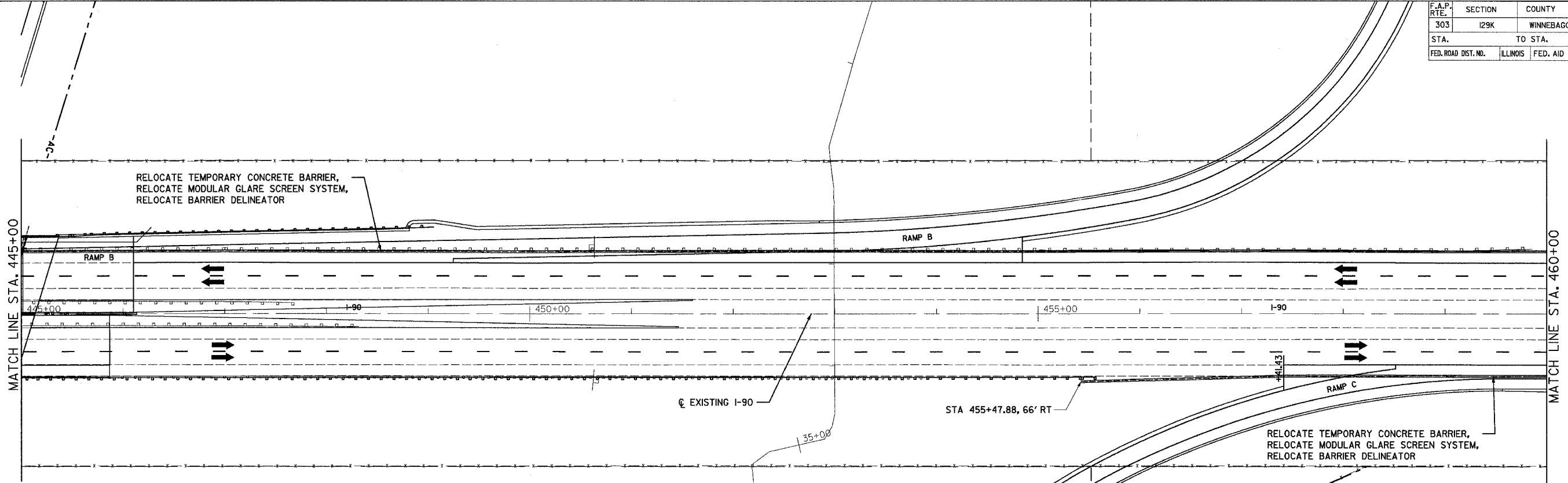
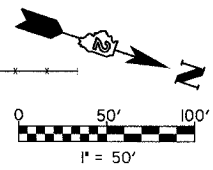

REVISIONS	
NAME	DATE

ILLINOIS DEPARTMENT OF TRANSPORTATION

**MAINTENANCE OF TRAFFIC  
I-90  
PHASE 3**

SCALE: VERT. N/A  
HORIZ. 1" = 50'  
DATE: SEPTEMBER 14, 2005

DRAWN BY: KRL  
CHECKED BY: PDS