

F.A.P. RTE.	SECTION	COUNTY	TOTAL SHEETS	SHEET NO.
303	129K	WINNEBAGO	585	132
STA. 142+32.87		TO STA. 156+00		
FED. ROAD DIST. NO.	ILLINOIS	FED. AID PROJECT		

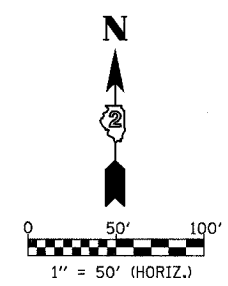
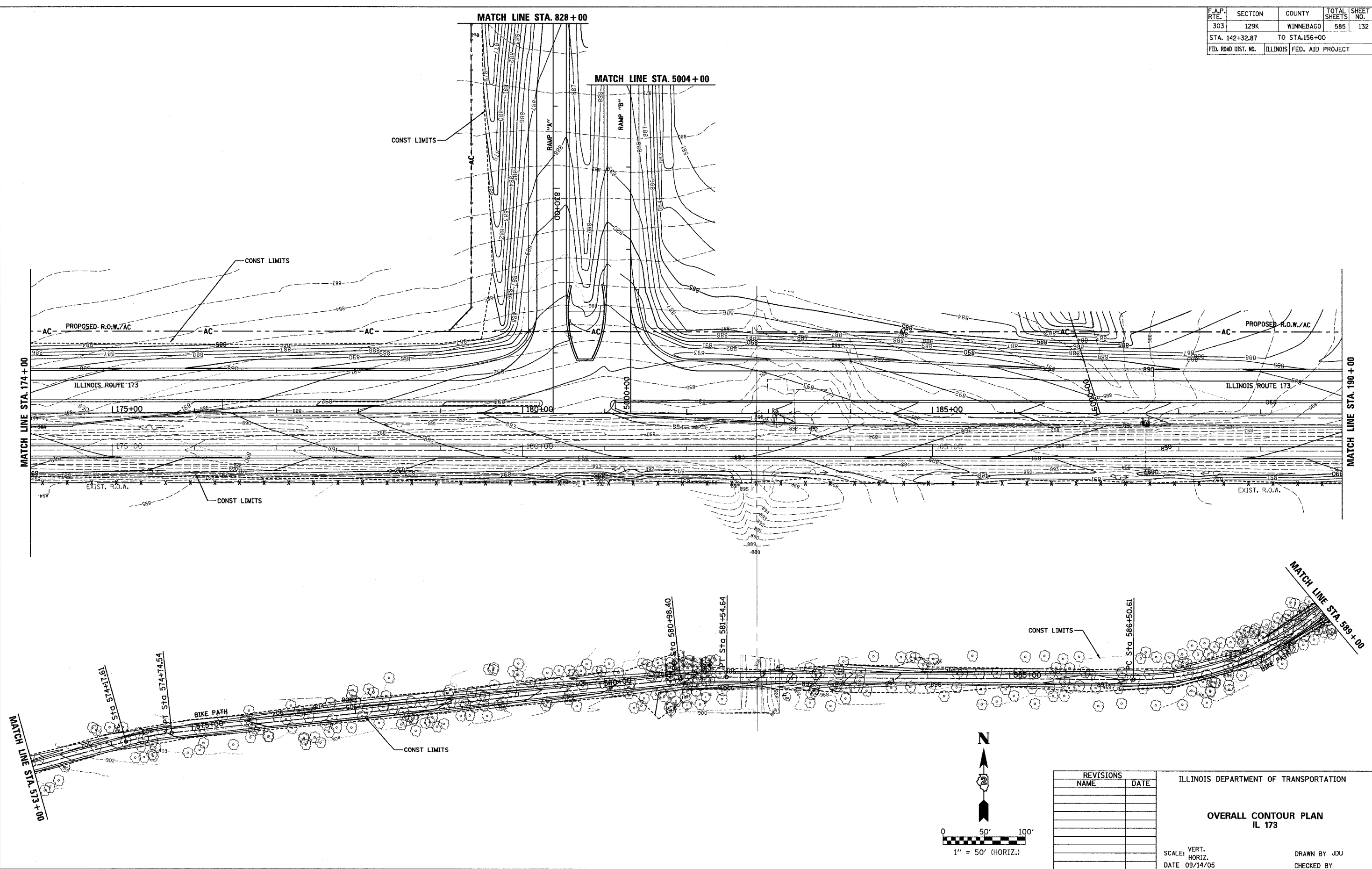

REVISIONS	
NAME	DATE

ILLINOIS DEPARTMENT OF TRANSPORTATION

**OVERALL CONTOUR PLAN
IL 173**

SCALE: VERT. 1" = 20'
HORIZ. 1" = 50' (HORIZ.)

DATE 09/14/05

DRAWN BY JDU
CHECKED BY

**OVERALL CONTOUR PLAN, ILLINOIS ROUTE 173,
STA. STA. 156+00 TO 174+00**