

F.A.P. RTE.	SECTION	COUNTY	TOTAL SHEETS	SHEET NO.
303	129K	WINNEBAGO	585	143
STA.	TO STA.			
FED. ROAD DIST. NO.	ILLINOIS	FED. AID PROJECT		

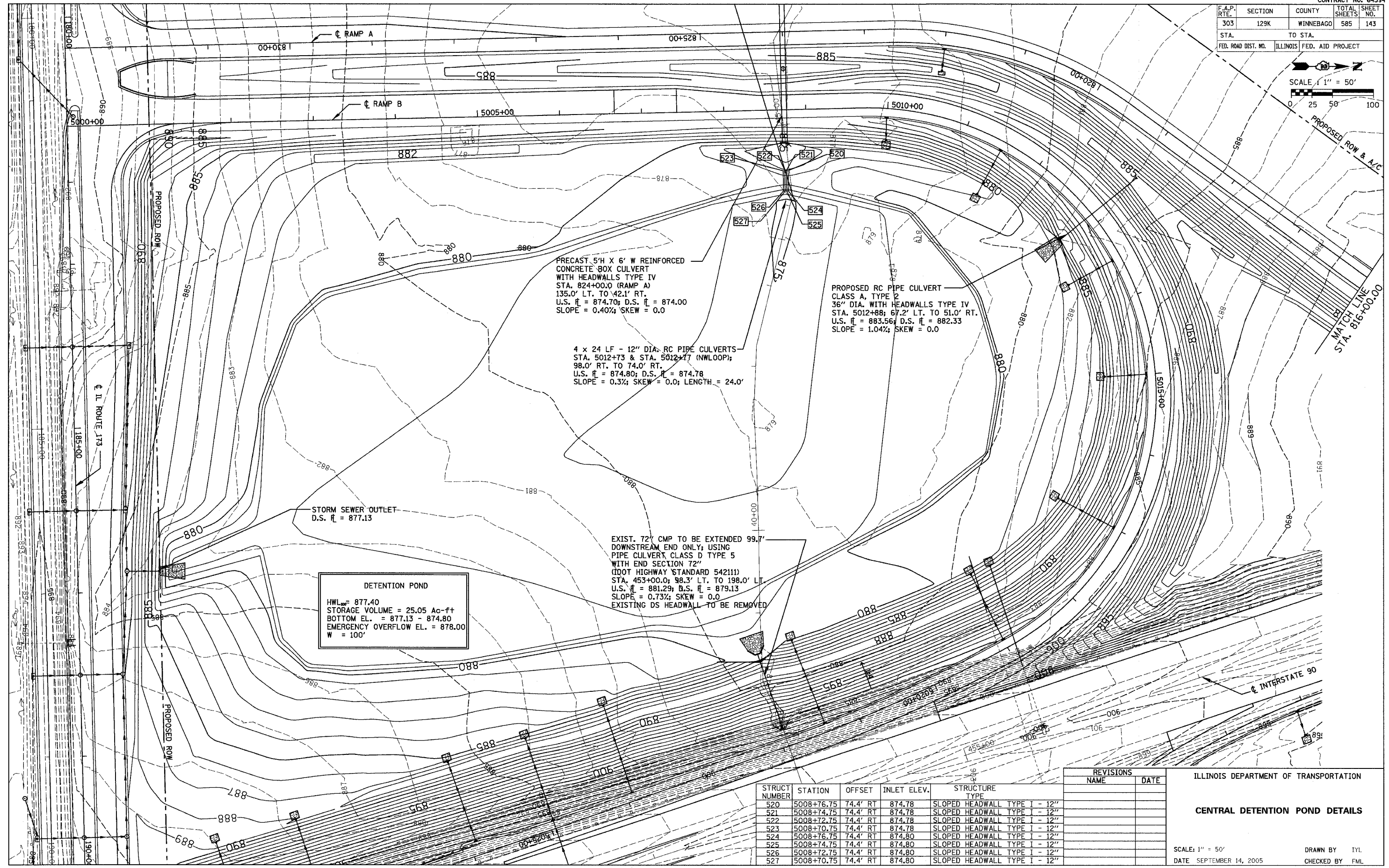
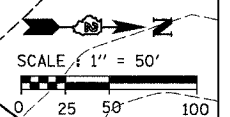

PRECAST 5'H X 6' W REINFORCED CONCRETE BOX CULVERT WITH HEADWALLS TYPE IV STA. 824+00.0 (RAMP A) 135.0' LT. TO 42.1' RT. U.S. \bar{H} = 874.70; D.S. \bar{H} = 874.00 SLOPE = 0.40%; SKEW = 0.0

PROPOSED RC PIPE CULVERT CLASS A, TYPE 2 36" DIA. WITH HEADWALLS TYPE IV STA. 5012+88; 67.2' LT. TO 51.0' RT. U.S. \bar{H} = 883.56; D.S. \bar{H} = 882.33 SLOPE = 1.04%; SKEW = 0.0

4 x 24 LF - 12" DIA. RC PIPE CULVERTS STA. 5012+73 & STA. 5012+77 (NW LOOP); 98.0' RT. TO 74.0' RT. U.S. \bar{H} = 874.80; D.S. \bar{H} = 874.78 SLOPE = 0.3%; SKEW = 0.0; LENGTH = 24.0'

STORM SEWER OUTLET D.S. \bar{H} = 877.13

DETENTION POND
 HWL₁₀₀ = 877.40
 STORAGE VOLUME = 25.05 Ac-ft
 BOTTOM EL. = 877.13 - 874.80
 EMERGENCY OVERFLOW EL. = 878.00
 W = 100'

EXIST. 72" CMP TO BE EXTENDED 99.7' DOWNSTREAM END ONLY; USING PIPE CULVERT CLASS D TYPE 5 WITH END SECTION 72" (DOT HIGHWAY STANDARD 542111) STA. 453+00.0; 98.3' LT. TO 198.0' LT. U.S. \bar{H} = 881.29; D.S. \bar{H} = 879.13 SLOPE = 0.73%; SKEW = 0.0
 EXISTING DS HEADWALL TO BE REMOVED

STRUCT. NUMBER	STATION	OFFSET	INLET ELEV.	STRUCTURE TYPE
520	5008+76.75	74.4' RT	874.78	SLOPED HEADWALL TYPE I - 12"
521	5008+74.75	74.4' RT	874.78	SLOPED HEADWALL TYPE I - 12"
522	5008+72.75	74.4' RT	874.78	SLOPED HEADWALL TYPE I - 12"
523	5008+70.75	74.4' RT	874.78	SLOPED HEADWALL TYPE I - 12"
524	5008+76.75	74.4' RT	874.80	SLOPED HEADWALL TYPE I - 12"
525	5008+74.75	74.4' RT	874.80	SLOPED HEADWALL TYPE I - 12"
526	5008+72.75	74.4' RT	874.80	SLOPED HEADWALL TYPE I - 12"
527	5008+70.75	74.4' RT	874.80	SLOPED HEADWALL TYPE I - 12"

REVISIONS	
NAME	DATE

ILLINOIS DEPARTMENT OF TRANSPORTATION
CENTRAL DETENTION POND DETAILS
 SCALE: 1" = 50'
 DATE: SEPTEMBER 14, 2005
 DRAWN BY: IYL
 CHECKED BY: FML