

F.A.I. RTE.	SECTION	COUNTY	TOTAL SHEETS	SHEET NO.
*	I29 K	WINNEBAGO	585	156
STA.		TO STA.		
FED. ROAD DIST. NO.	ILLINOIS	FED. AID PROJECT		
190/ IL 173				

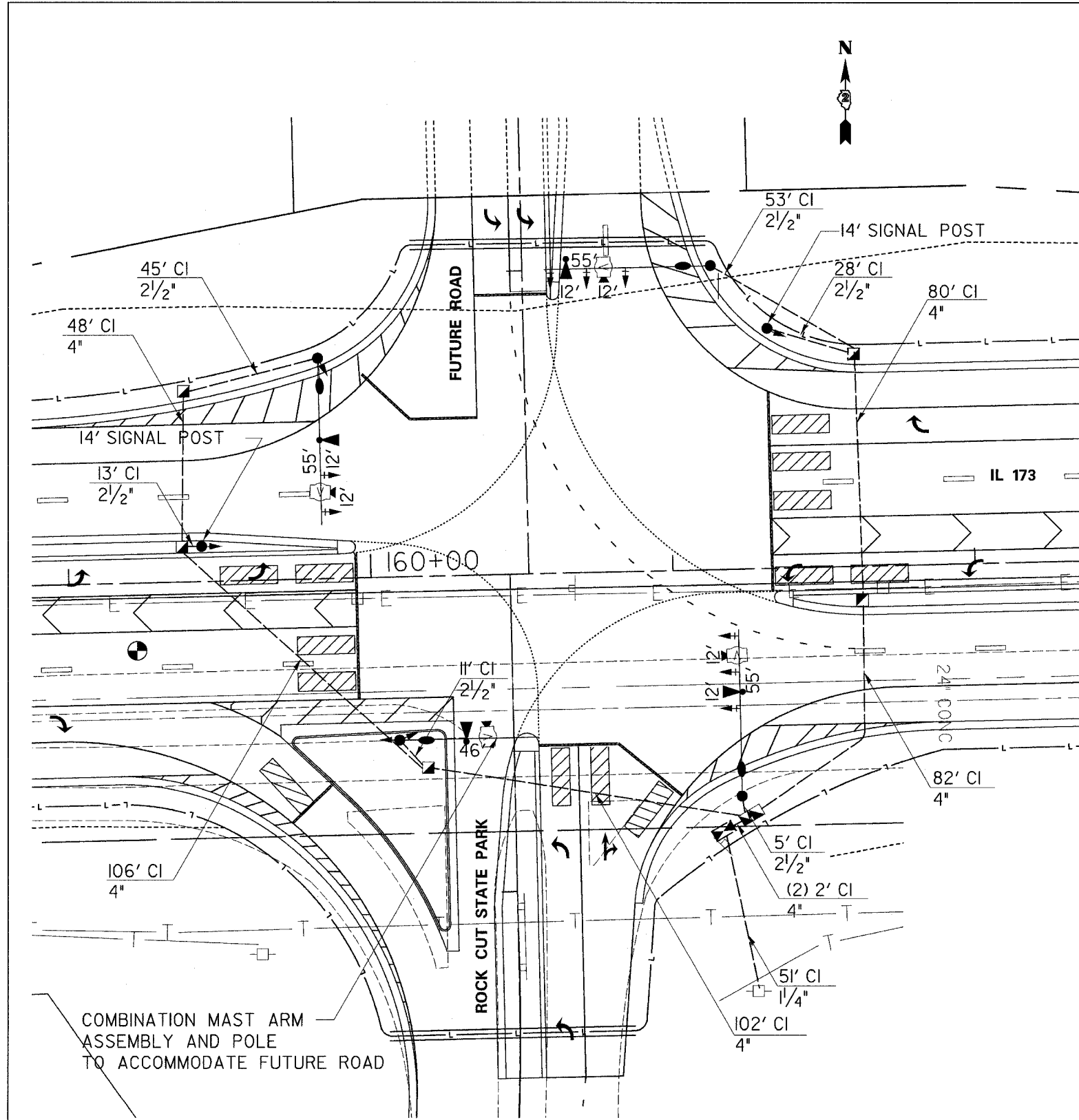

1. THE MOUNTING HEIGHT FOR THE LUMINARIES SHALL BE 35' 0" TENON MOUNTED WITH AN 8' HORIZONTAL ARM
 2. ALL TRAFFIC SIGNAL MAST ARM ASSEMBLIES (STANDARD, COMBINATION OR DUAL) MUST BE DESIGNED FOR THE LOADING SHOWN ON THE HIGHWAY STANDARDS OR THESE SIGNAL PLANS, WHICHEVER IS GREATER.

LEGEND

- CONTROLLER
- ALUMINUM MAST ARM ASSEMBLY AND POLE
- STEEL MAST ARM ASSEMBLY AND POLE
- SIGNAL HEAD AND POST
- SIGNAL HEAD WITH BACKPLATE
- PEDESTRIAN HEAD
- PEDESTRIAN PUSHBUTTON
- HANDHOLE
- JUNCTION BOX
- HEAVY-DUTY HANDHOLE
- DOUBLE HANDHOLE
- LUMINAIRE
- CONDUIT INSTALLED, NON-METALLIC
UPPER NUMERAL INDICATES LENGTH
CI INDICATES CONDUIT INSTALLED, NON-METALLIC
WHETHER PUSHED OR TRENCHED
LOWER NUMERAL INDICATES SIZE OF CONDUIT
- MINIMUM VIDEO DETECTION ZONES

COMBINATION MAST ARM ASSEMBLY AND POLE TO ACCOMMODATE FUTURE ROAD

REVISIONS		ILLINOIS DEPARTMENT OF TRANSPORTATION
NAME	DATE	
		DRAWN BY CHECKED BY

SCALE: VERT.
HORIZ.
DATE

TRAFFIC SIGNALS

PLOT DATE * DATE *
FILE NAME * FILE *
USER NAME * USER *