

STATE OF ILLINOIS
DEPARTMENT OF TRANSPORTATION

ROUTE NO.	SECTION	COUNTY	SHEET	SHEET
303	129k	WINNEBAGO	585	207
F. A. P.		ILLINOIS FED. AID PROJECT-		
CONTRACT NO. 64594				

SHEET NO. S28
OF SHEETS S47

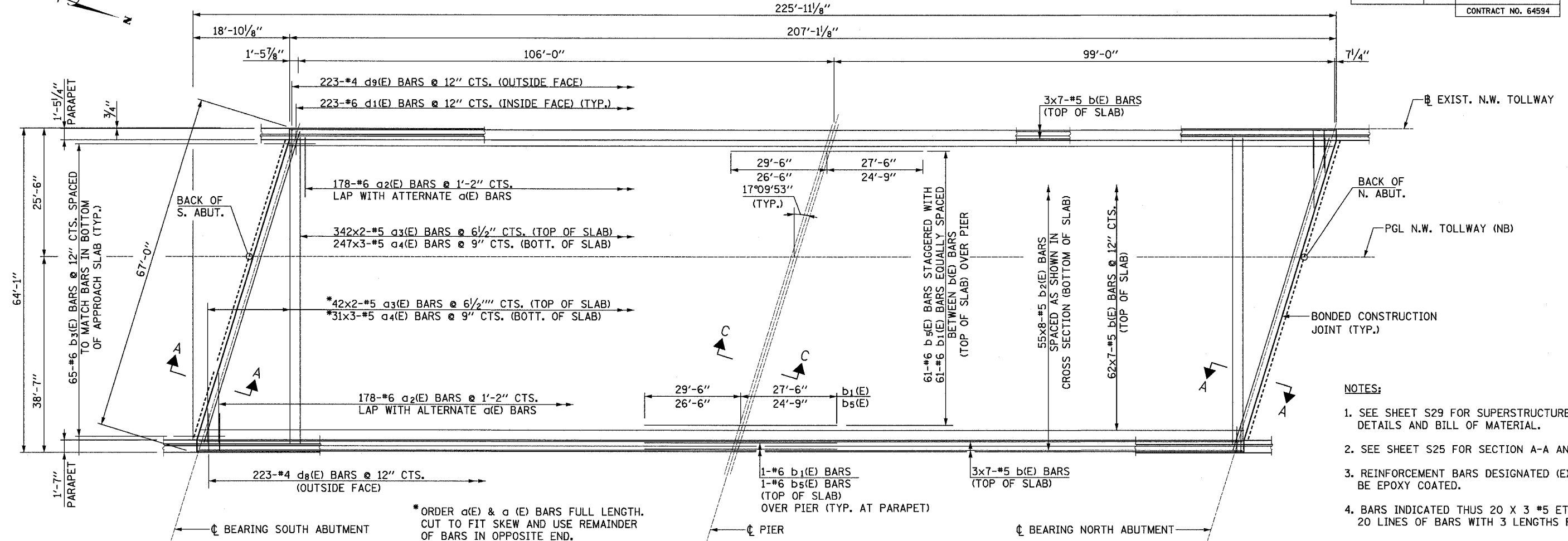

DECK PLAN

- NOTES:
- SEE SHEET S29 FOR SUPERSTRUCTURE DETAILS AND BILL OF MATERIAL.
 - SEE SHEET S25 FOR SECTION A-A AND C-C.
 - REINFORCEMENT BARS DESIGNATED (E) SHALL BE EPOXY COATED.
 - BARS INDICATED THUS 20 X 3 #5 ETC. INDICATES 20 LINES OF BARS WITH 3 LENGTHS PER LINE.

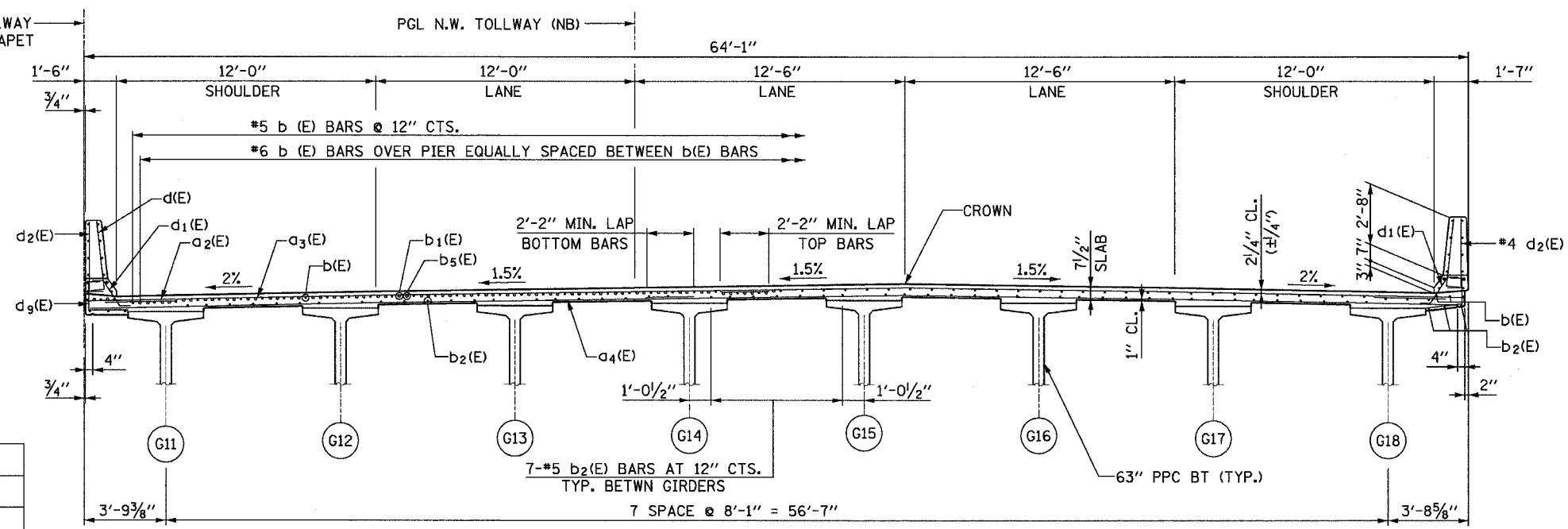

CROSS SECTION
(LOOKING NORTH)

DESIGNED	JIG
CHECKED	QA
DRAWN	DCP
CHECKED	JIG

DECK PLAN & CROSS SECTION (NB)
N.W. TOLLWAY
OVER IL 173 (F.A.P. ROUTE 303)
SECTION 129K
WINNEBAGO COUNTY
STATION 443+73.62
S.N. 101-9963 (SB) & 101-9964 (NB)
TOLLWAY S.N. 703 (NB) & 704 (SB)



\$\$\$DGNSS
\$\$\$PRFSS