

F.A.P. RTE.	SECTION	COUNTY	TOTAL SHEETS	SHEET NO.
303	I29K	WINNEBAGO	585	279
STA.		TO STA.		
FED. ROAD DIST. NO.	ILLINOIS	FED. AID PROJECT		

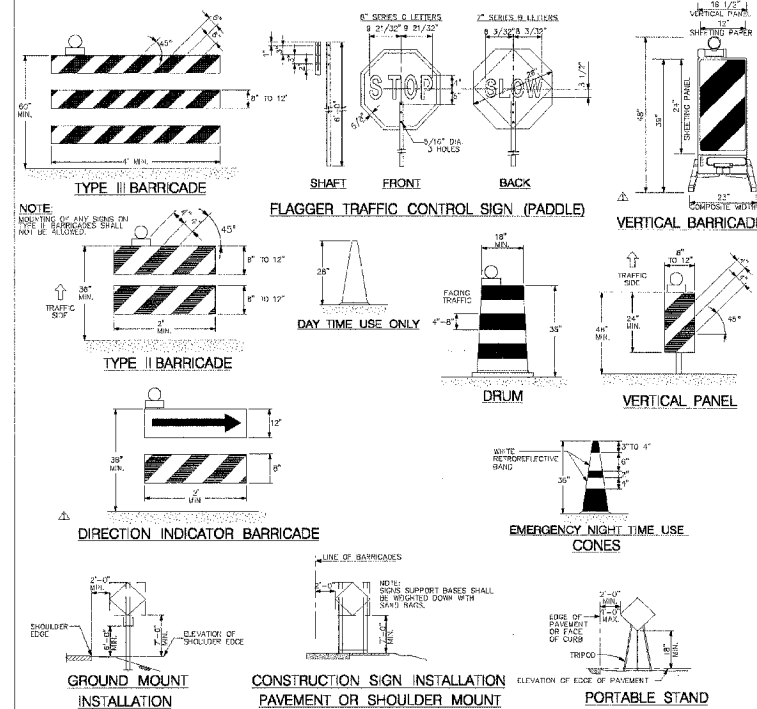

GENERAL NOTES:

- UNLESS OTHERWISE NOTED, TYPE A REFLECTIVE SHEETING SHALL BE USED FOR TYPE II BARRICADES, DRUMS AND VERTICAL PANELS.
- ONLY NON-METALLIC DRUMS OR TYPE II BARRICADES SHALL BE USED FOR LOW TRAFFIC VOLUMES. THESE DEVICES SHALL NOT BE INTERFERED WITH BY INDIVIDUAL STORES OR BOXES. CONES MAY BE USED FOR SHORT TERM CLOSURES (FROM SUNRISE TO 1 HOUR BEFORE SUNSET). VERTICAL PANELS ARE TO BE USED AS SHOWN ON THE PLANS OR SPECIFIED BY THE ENGINEER. TYPE II BARRICADES ARE TO BE USED FOR ROAD CLOSURES AND SHALL NOT BE USED FOR DELINEATION OR CHANNELIZATION.
- ALL HEIGHTS SHOWN ARE MEASURED ABOVE THE PAVEMENT SURFACE. DEVICES PLACED ADJACENT TO A TRAFFIC LANE IN AN EXHAUSTED AREA 3 FEET OR MORE FROM THE EDGE SHALL HAVE LEGS EXTENDED TO PROVIDE THE DESIRED HEIGHT ABOVE THE PAVEMENT AS SHOWN.
- ALL BARRICADES AND VERTICAL PANELS SHALL HAVE ALTERNATING REFLECTORIZED WHITE AND REFLECTORIZED ORANGE STRIPES PLACED OVER THE ENTIRE SURFACE AS SHOWN AT 45° TO THE FACE OF EACH PART. ALL TYPE II BARRICADES SHALL BE PLACED ON BOTH SIDES OF THE TRAFFIC APPROACHES FROM EITHER DIRECTION. VERTICAL PANELS PLACED ON THE OUTSIDE OF CURVES SHALL BE STRIPPED ON BOTH SIDES.
- DRUMS SHALL BE NON-METALLIC AND HAVE ALTERNATING REFLECTORIZED ORANGE AND REFLECTORIZED WHITE HORIZONTAL CIRCUMFERENTIAL STRIPES AS SHOWN. THESE STRIPES SHALL BE PLACED OVER THE ENTIRE SURFACE OF EACH DRUM. THE STRIPES SHALL BE NOT LESS THAN 2 IN. WIDE AND ALL CIRCUMFERENTIAL PORTIONS OF THE DRUM SHALL BE STRIPPED. ALL TYPE II BARRICADES SHALL BE STRIPPED ON BOTH SIDES OF THE TRAFFIC APPROACHES FROM EITHER DIRECTION. VERTICAL PANELS PLACED ON THE OUTSIDE OF CURVES SHALL BE STRIPPED ON BOTH SIDES.
- FRAMES FOR TYPE II BARRICADES SHALL BE NON-METALLIC, PROVIDE A STABLE STRUCTURE AND HAVE THE FOLLOWING DIMENSIONS: 4" TYPICAL CORNER, THE PROVISIONAL COLOR FOR NON-REFLECTORIZED BARRICADE COMPONENTS SHALL BE ORANGE OR WHITE.
- TYPE II BARRICADES SHALL NOT HAVE ANY VERTICAL OR SLANTING SUPPORTS HEAVIER THAN 1/2" X 1/2" LAMINAR OR 2" X 2" STEEL ANGLES WITH 1/2" NOT BE CREDITED ON TYPE II BARRICADES.
- MINIMUM HEIGHT SHALL BE 7' FOR 24" HIGH CORNERS WITH A MINIMUM OF 60 PERCENT OF THE TOTAL HEIGHT IN THE BASE.
- BARRICADES MAY BE IDENTIFIED WITH A LEGEND THAT DOES NOT EXCEED ONE HIGH IN HEIGHT ON A NON-REFLECTIVE SURFACE IN A LOCATION NOT VISIBLE TO TRAFFIC.
- HEIGHTS OF CONCRETE, STONE OR BRICK WILL NOT BE ALLOWED AND ALL HEIGHTS OTHER THAN SHOWN MUST BE IDENTIFIED WITH A LEGEND AS CLOSE TO THE CLOSURE AS POSSIBLE. NO HEIGHTS WILL BE ALLOWED ON THE TOP RAIL OF BARRICADES. SIGNPOSTS MAY BE PLACED ON THE BARRICADES LEGS OVER THE STRIPPED BOTTOM SURFACE TO IDENTIFY THE CLOSURE FROM THE BARRICADE. SIGNPOSTS SHALL BE IDENTIFIED WITH A LEGEND SO THAT THE SIGN IS AT LEAST 18" BELOW THE TOP OF THE BARRICADE.
- WARNING LIGHTS ON BARRICADES, DRUMS OR VERTICAL PANELS SHALL BE MOUNTED ABOVE THE TOP OF THE DEVICE TO THE SIDE OR IN THE CENTER. LIGHTS SHALL NOT OBSCURE ANY REFLECTORIZED PORTION OF THE DEVICE.
- VERTICAL PANELS MAY BE EITHER PORT MOUNTED FRAME SUPPORTED OR ATTACHED TO THE TOP OF A BARRIER. PORT MOUNTED PANELS SHALL BE FINELY ATTACHED TO LIGHT PROTECTIVE COLOR FOR NON-REFLECTORIZED BARRICADE COMPONENTS SHALL BE ORANGE OR WHITE.
- THE "STOP" FACE SHALL CONSIST OF WHITE LETTERS AND BORDER ON A RED REFLECTORIZED BACKGROUND. THE "SLOW" FACE SHALL CONSIST OF BLACK LETTERS AND BORDER ON A LUMINOUS (ORANGE REFLECTORIZED BACKGROUND). AREAS OUTSIDE THE BORDER SHALL BE LIGHT BLUE OR BLACK. ALL CHARACTERS AND LETTERS SHALL MEET APPLICABLE FEDERAL STANDARDS.
- THE LEFT HAND CORNER OF THE SIGNPOSTS SHALL BE A CORNER LOCATED 90 DEGREES FROM THE BOTTOM OF THE SIGNPOST. THE PORTION OF THE SIGN WITHIN THE SIGN FACE SHALL BE BLACK.
- THE SIGN BASE MATERIAL SHALL BE 3/8" THICK RIBBED ALUMINUM. THE SIGN SHALL BE ATTACHED TO THE STAFF WITH 1/2" RESISTANT HARDWARE.
- THE SIGN SHALL BE SURVEYED BY THE CONTRACTOR AND SHALL BE USED BY THE FLAGGER IN THE PLACE OF OTHER SIGNPOSTS.
- CONSTRUCTION SIGNS MOUNTED FOR SHORT TERM CLOSURES, LESS THAN 12 HOURS, MAY BE IDENTIFIED WITH A LEGEND AS SHOWN. CONSTRUCTION SIGNS MOUNTED FOR NIGHTTIME OR MOUNTED LONGER THAN A SHORT TERM CLOSURE SHALL BE GROUND, PAVEMENT OR SHOULDER MOUNTED.
- MOUNTING OF ANY SIGNS ON TYPE II BARRICADES SHALL NOT BE ALLOWED.
- ALL NOT DEVICES AND SIGN SUPPORTS SHALL BE IDENTIFIED AS MEETING THE REQUIRED TEST LEVEL OF M-80 PER REPORT 350.

APPROVED: [Signature]	DATE: 5-28-2004	CTE ENGINEERS CORPORATE ENGINEERING DESIGNERS, INC.	THE ILLINOIS STATE TOLL HIGHWAY AUTHORITY 3700 DOWNER AVENUE DOWNERS GROVE, ILLINOIS 60515	REVISION	STANDARD SD 04-10A	DRAWING NO.
				NO. DATE DESCRIPTION	STAMPED	01
				ALL	PROTECTIVE DEVICES	

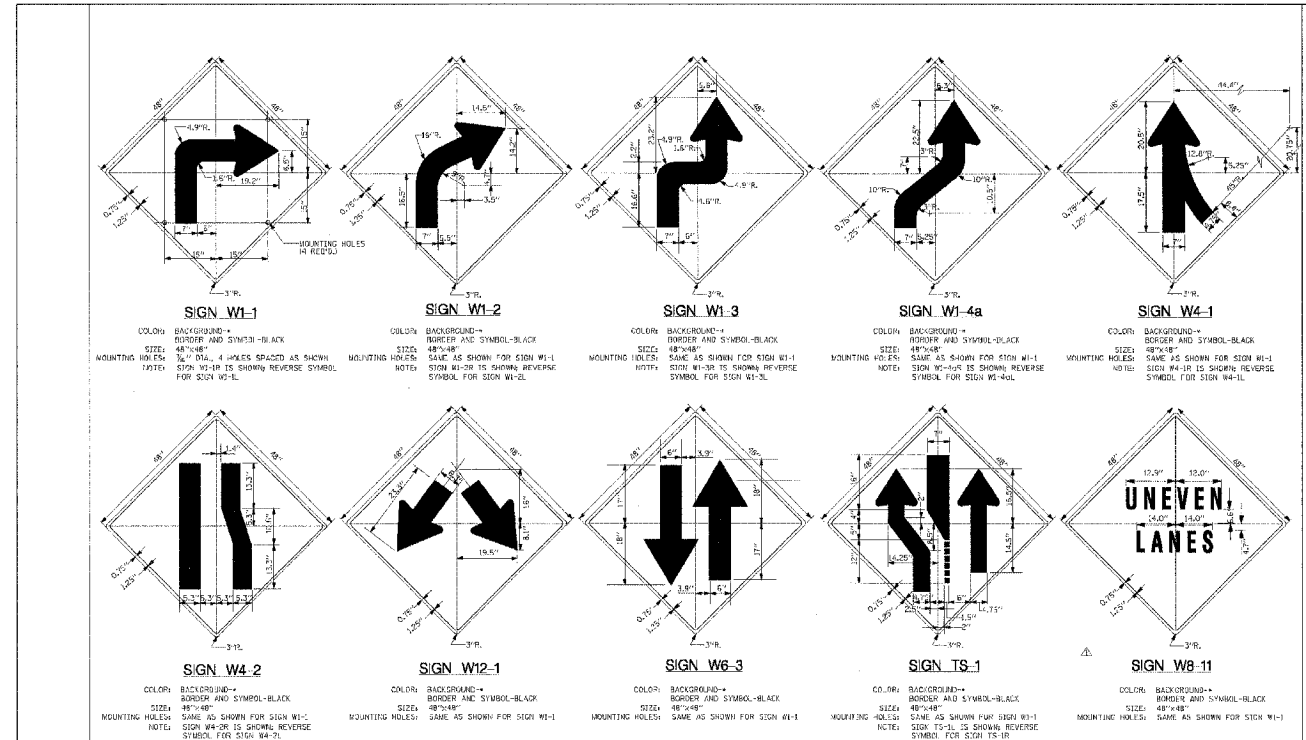

APPROVED: [Signature]	DATE: 5-21-2001	CTE ENGINEERS CORPORATE ENGINEERING DESIGNERS, INC.	THE ILLINOIS STATE TOLL HIGHWAY AUTHORITY 3700 DOWNER AVENUE DOWNERS GROVE, ILLINOIS 60515	REVISION	STANDARD SD 03-15A	DRAWING NO.
				NO. DATE DESCRIPTION	CONSTRUCTION SIGNS I	01

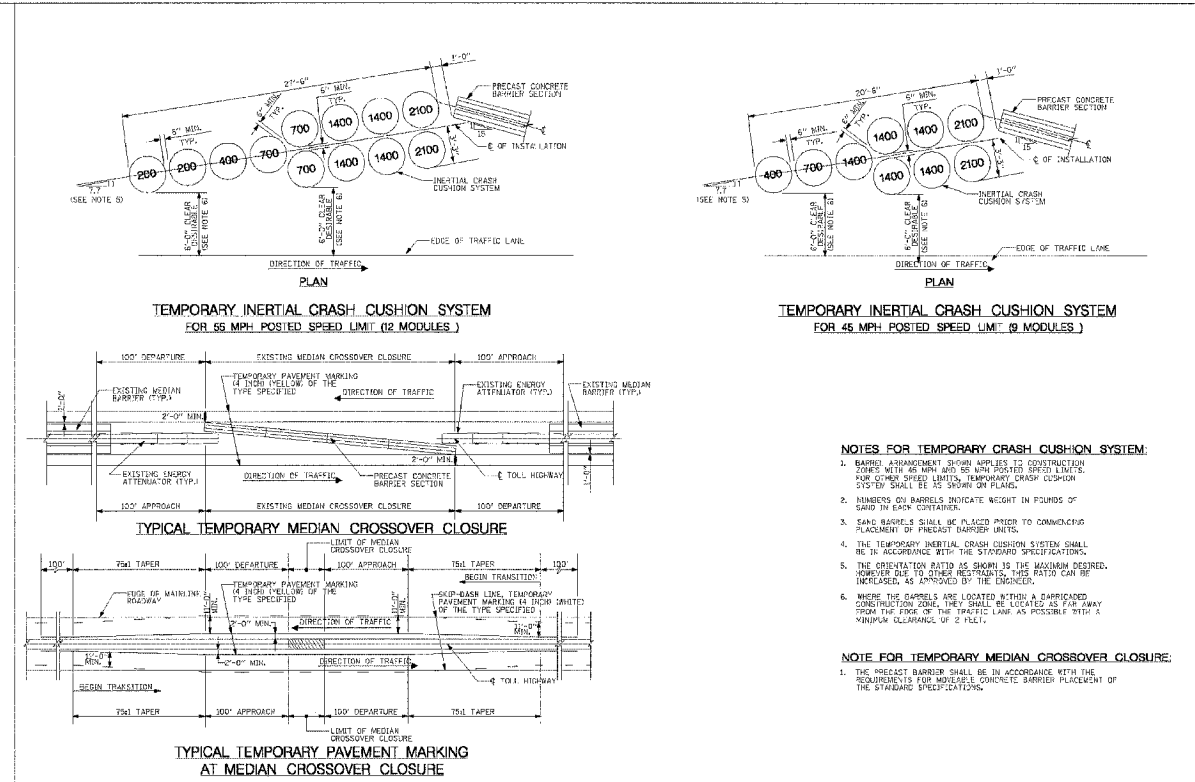

- NOTES FOR TEMPORARY CRASH CUSHION SYSTEM:**
- BARRIERS ARRANGEMENT SHOWN APPLIES TO CONSTRUCTION ZONE WITH 45 MPH AND 60 MPH POSTED SPEED LIMITS. FOR OTHER SPEED LIMITS, TEMPORARY CRASH CUSHION SYSTEM SHALL BE AS SHOWN ON PLANS.
 - NUMBERS OF BARRELS INDICATE WEIGHT IN POUNDS OF SAID IN EACH CONTAINER.
 - SAID BARRELS SHALL BE PLACED PRIOR TO COMMENCING PLACEMENT OF PRECAST BARRIER SECTIONS.
 - THE TEMPORARY INERTIAL CRASH CUSHION SYSTEM SHALL BE IN ACCORDANCE WITH THE STANDARD SPECIFICATIONS.
 - THE CONSTRUCTION RATIO AS SHOWN IS THE MAXIMUM PERMITTED. HOWEVER DUE TO OTHER RESTRAINTS, THIS RATIO CAN BE DECREASED AS INDICATED BY THE ENGINEER.
 - WHERE THE BARRELS ARE LOCATED WITHIN A DEDICATED CONSTRUCTION ZONE, THEY SHALL BE LOCATED AS FAR AWAY FROM THE EDGE OF THE TRAFFIC LANE AS POSSIBLE WITH A MINIMUM CLEARANCE OF 2 FEET.
- NOTE FOR TEMPORARY MEDIAN CROSSOVER CLOSURE:**
- THE PRECAST BARRIER SHALL BE IN ACCORDANCE WITH THE REQUIREMENTS FOR MODULAR CONCRETE BARRIER PLACEMENT OF THE STANDARD SPECIFICATIONS.

APPROVED: [Signature]	DATE: 11-03-2003	CTE ENGINEERS CORPORATE ENGINEERING DESIGNERS, INC.	THE ILLINOIS STATE TOLL HIGHWAY AUTHORITY 3700 DOWNER AVENUE DOWNERS GROVE, ILLINOIS 60515	REVISION	STANDARD SD 03-10B	DRAWING NO.
				NO. DATE DESCRIPTION	CRASH CUSHION SYSTEMS AND MEDIAN CROSSOVER CLOSURE DETAILS	E2

REVISIONS		ILLINOIS DEPARTMENT OF TRANSPORTATION
NAME	DATE	
		ISTHA STANDARDS
		SCALE: VERT. N/A HORIZ. N/A DATE: SEPTEMBER 14, 2005
		DRAWN BY: KRL
		CHECKED BY: PDS