

F.A.P. RTE.	SECTION	COUNTY	TOTAL SHEETS	SHEET NO.
303	129K	WINNEBAGO	585	299
STA.		TO STA.		
FED. ROAD DIST. NO.		ILLINOIS FED. AID PROJECT		

TYPICAL MEDIAN CROSSOVER CLOSURE (WITH EMERGENCY OPENING)

GENERAL NOTES

WOOD POSTS, CABLE, AND SIGN SUPPORTS SHALL BE IN ACCORDANCE WITH SECTION 634 & 636 OF THE STANDARD SPECIFICATIONS FOR ROAD AND BRIDGE CONSTRUCTION.
THE PANELS SHALL BE ANCHORED TO THE (3/8) CABLE IN SUCH A MANNER SO THEY CANNOT SLIDE ALONG THE CABLE.

THE REFLECTIVE SHEETING USED FOR THE PANELS SHALL MEET THE REQUIREMENTS OF ARTICLE 1084.02 OF THE STANDARD SPECIFICATIONS FOR ROAD & BRIDGE CONSTRUCTION AND SHALL BE ON BOTH SIDES.

ALL PANELS SHALL HAVE ALTERNATING REFLECTORIZED WHITE & RED STRIPES SLOPING DOWNWARD AT 45° TOWARD THE SIDE ON WHICH TRAFFIC WILL PASS AND ON BOTH SIDES OF PANEL. THE DRILLING OF 75 (3) AND 100 (4) HOLES SHALL BE INCIDENTAL TO THE MEDIAN CLOSURE.

THIS WORK SHALL BE PAID FOR AT THE CONTRACT UNIT PRICE EACH FOR MEDIAN CLOSURE.

ALL DIMENSIONS ARE IN MILLIMETERS (INCHES) UNLESS OTHERWISE NOTED.

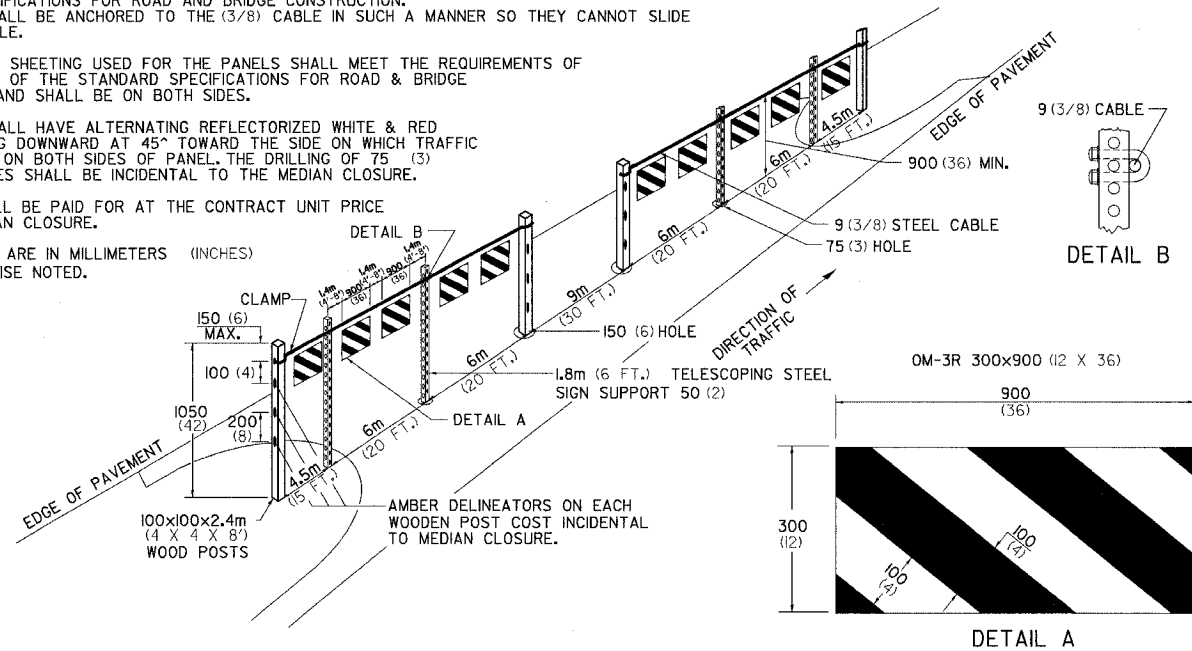

TYPICAL MEDIAN CROSSOVER CLOSURE (WITH EMERGENCY OPENING) 87.4

REVISED 10-15-04

DRAIN FOR AGGREGATE BASES IN URBAN AREAS

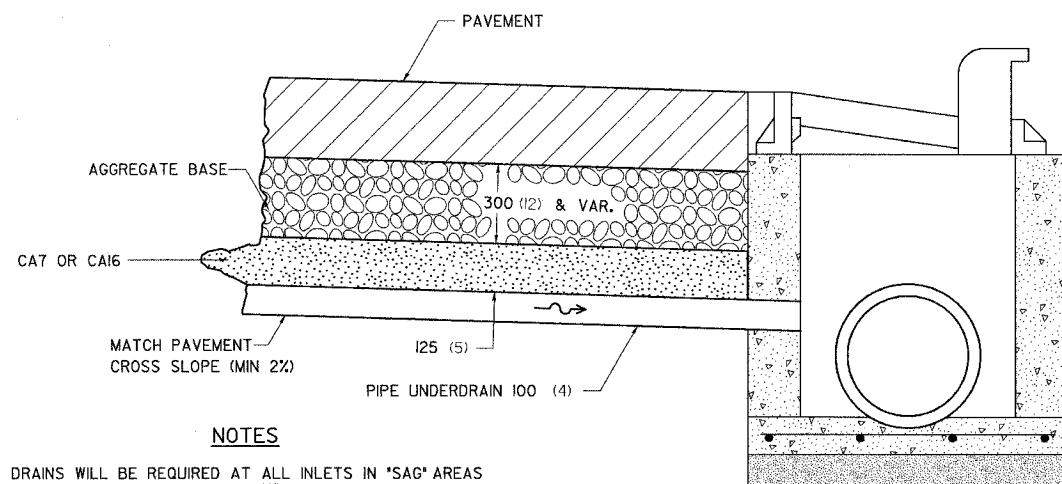

NOTES

DRAINS WILL BE REQUIRED AT ALL INLETS IN 'SAG' AREAS AND AS INDICATED IN THE PLANS.

THIS WORK SHALL BE COMPLETED ACCORDING TO SECTION 601 OF THE STANDARD SPECIFICATIONS.

THIS WORK WILL BE PAID FOR AT THE CONTRACT UNIT PRICE PER METER (FOOT) FOR PIPE UNDERDRAINS OF THE DIAMETER SPECIFIED WHICH PRICE SHALL INCLUDE THE CAT OR CA16 AND THE CONNECTION TO THE INLET.

ALL DIMENSIONS ARE IN MILLIMETERS (INCHES) UNLESS OTHERWISE NOTED.

PLOT DATE = 04/15/04
FILE NAME = 041504.DWG
SCALE = 1/8" = 1'-0"
REFERENCE = 041504

DRAIN FOR AGGREGATE BASES IN URBAN AREAS 88.4

THREE CENTER CURVE DATA

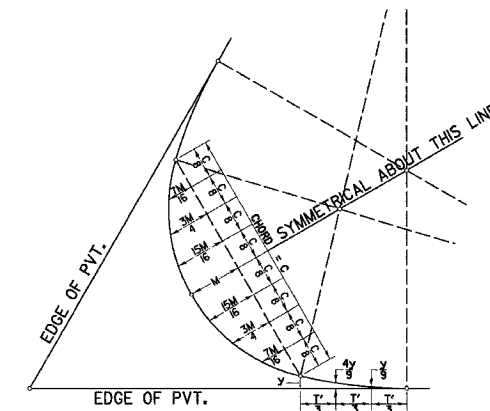

FIELD LAYOUT METHOD

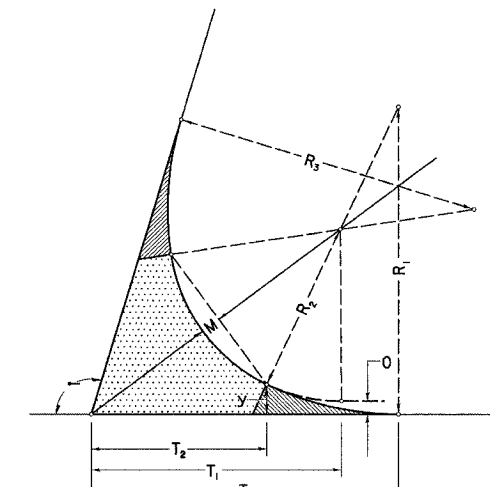

FOR SYMMETRICAL CURVES

SYMMETRICAL CURVES

CURVE #									
R ₁									
R ₂									
R ₃									
O									
I									
T									
T ₁									
T ₂									
T'									
Y									
4y									
g									
y									
M									
15M									
16									
3M									
4									
7M									
16									
C									

ALL DIMENSIONS ARE IN MILLIMETERS (INCHES) UNLESS OTHERWISE NOTED.

TWO CENTER CURVE DATA

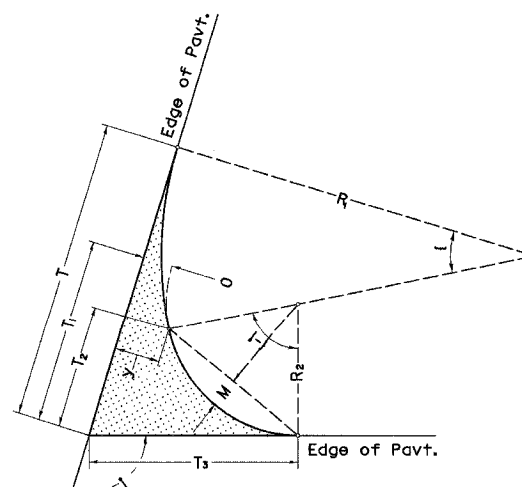

TWO CENTER CURVES

LOCATION	RCSP		RAMP A/B		RAMP C	LYFORD ROAD		LYFORD ROAD NORTH	
	SW	SE	NW	NE	NE	SW	SE	NW	NE
R ₁	110	110	375	375	200	250	350	350	250
R ₂	85	50	60	60	70	55	60	60	55
O	12	12	12	12	12	12	12	12	12
I	92°38'41.7"	84°49'38.5"	89°59'59.9"	90°00'00.0"	90°00'00.0"	88°21'48.3"	88°21'48.3"	90°00'00.0"	90°00'00.0"
T	11.09	80.59	146.12	146.12	124.55	120.46	140.53	142.56	122.35
T ₁	87.53	44.59	60.00	60.00	70.00	53.11	57.97	60.00	55.00
T ₂	16.45	14.59	43.60	43.60	40.63	34.11	40.89	42.92	36.00
T ₃	101.29	57.73	72.00	72.00	82.00	65.46	70.32	72.00	67.00
Y	53.95	22.00	14.29	14.29	18.46	15.38	14.48	14.48	15.38
4y	23.98	9.78	6.35	6.35	8.21	6.84	6.44	6.44	6.84
g	5.99	2.44	1.59	1.59	2.05	1.71	1.61	1.61	1.71
M	3.56	4.32	12.12	12.12	11.02	9.45	11.40	11.91	9.89
15M	3.34	4.05	11.37	11.37	10.34	8.86	10.69	11.17	9.27
16	2.67	3.24	9.09	9.09	8.27	7.08	8.55	8.93	7.42
7M	1.56	1.89	5.30	5.30	4.82	4.13	4.99	5.21	4.33
16									
C	48.68	40.64	72.33	72.33	75.42	61.64	70.38	71.77	62.93

TWO AND THREE CENTER CURVE DATA 92.2