

F.A.P. RTE.	SECTION	COUNTY	TOTAL SHEETS	SHEET NO.
303	129K	WINNEBAGO	585	420
STA. 441+54.30	TO STA. 441+73.60			
FED. ROAD DIST. NO.	ILLINOIS	FED. AID PROJECT		

BY	DATE
SURVEYED	
NOTE BOOK	
NO.	

BY	DATE
SURVEYED	
NOTE BOOK	
NO.	

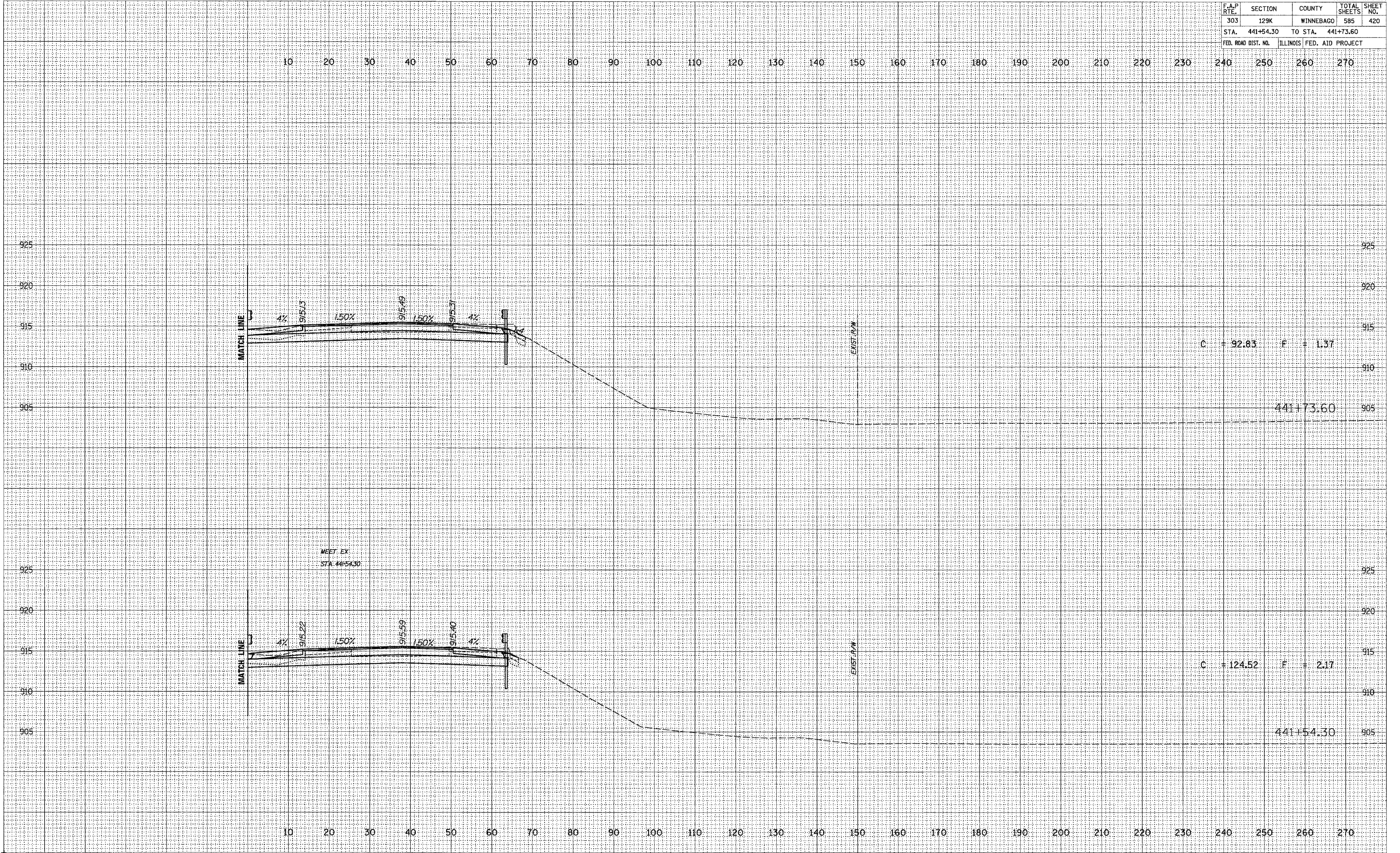

C = 92.83 F = 1.37

441+73.60

MEET EX
STA. 441+54.30

C = 124.52 F = 2.17

441+54.30